

NO. OF COPIES RECEIVED	
DISTRIBUTION	
SANTA FE	<input checked="" type="checkbox"/>
FILE	<input checked="" type="checkbox"/>
U.S.G.S.	<input checked="" type="checkbox"/>
LAND OFFICE	<input checked="" type="checkbox"/>
OPERATOR	<input checked="" type="checkbox"/>

RECEIVED BY
JUL 03 1984
O.C.D.
ARTESIAN OFFICE

A. Indicate Type of Lease
STATE ☒ FEE ☐
B. State Oil & Gas Lease No.

APPLICATION FOR PERMIT TO DRILL, DEEPEN, OR PLUG BACK

4. Type of Work
a. Type of Well
DRILL ☒ DEEPEN ☐ PLUG BACK ☐
OIL WELL ☒ GAS WELL ☐ OTHER ☐
SINGLE ZONE ☒ MULTIPLE ZONE ☐

7. Unit Agreement Name
8. Farm or Lease Name
State HL 1

5. Name of Operator
Tenneco Oil Company ✓

9. Well No.
3

6. Address of Operator
7990 IH 10 West; San Antonio, TX 78230

10. Field and Pool, or Wildcat Undesign.
Leo Queen So. (Grayburg)

11. Location of Well
UNIT LETTER B LOCATED 1980 660 FEET FROM THE East North LINE
AND 660 FEET FROM THE North LINE OF SEC. 1 TWP. 19S RGE. 29E NMPM

12. County
Eddy

19. Proposed Depth 2900	19A. Formation Grayburg	20. Rotary or C.T. Rotary
21. Elevations (show whether DF, RT, etc.) 3423 GL	21A. Kind & Status Plug. Bond Blanket	21B. Drilling Contractor
22. Approx. Date Work will start 15 July 1984		

PROPOSED CASING AND CEMENT PROGRAM

SIZE OF HOLE	SIZE OF CASING	WEIGHT PER FOOT	SETTING DEPTH	SACKS OF CEMENT	EST. TOP
12 1/4	8 5/8	24 lbs.	300'	190	Surf.
7 7/8	5 1/2	14.5 lbs.	2900'	427	Surf.

1. Construct suitable location. Reserve pits, working pits, rat hole, mouse hole, cellar may be provided by operator or drilling contractor, and will be determined in conjunction with selection of drilling contractor/rig.
2. MIRU. Drill 12 1/4" hole to 300' +/- . BHA: Slick
3. CCM to run casing. SLM out of hole. Set 8 5/8" casing in full compression at 300 +/- . Run casing, cement and centralize.
4. WOC 12 hours. Cut off 8 5/8" casing. Install (See Note #1) wellhead. test well to 680 psi (1/2 of csg. collapse strength for SOW heads).

APPROVAL VALID FOR 180 DAYS
PERMIT EXPIRES 1-5-85
UNLESS DRILLING UNDERWAY.

WOC time/8 Hrs. Continued on back of page.

ABOVE SPACE DESCRIBE PROPOSED PROGRAM; IF PROPOSAL IS TO DEEPEN OR PLUG BACK, GIVE DATA ON PRESENT PRODUCTIVE ZONE AND PROPOSED NEW PRODUCTIVE ZONE. GIVE BLOWOUT PREVENTER PROGRAM, IF ANY.

I hereby certify that the information above is true and complete to the best of my knowledge and belief.

Signed [Signature] Title Drilling Engineer Date 28 June 1984

(This space for State Use)

APPROVED BY [Signature] TITLE OIL AND GAS INSPECTOR DATE JUL 05 1984

CONDITIONS OF APPROVAL, IF ANY:

Post a Rd
18-10-16-16
7-6-84

5. NU following BOPE: 3M Double Ram BOPE (pipe on BTM. - Blinds on top) Test to 1500 PSIG when testing casing.
6. PU 7 7/8 bit and following BHA: Slick RIH to top of float collar. Test casing to 1000 psi for 30 minutes. Test is satisfactory if pressure does not decrease more than 10% of test pressure by end of test. Record test on IADC Report and include details in daily drilling report to TOC SWD. Insure compliance with State of NM Rule 107 before testing and drilling out.
7. Drill 7 7/8" hole to +/- 2900. Log, core, as outlined in step 8 and per GE.
8. Will shoot sidewall cores in the Penrose @ 2463'.
9. RIH w/DP and bit to TD. CCM to run 5 1/2" casing, or to P & A. If well is to be P & A'd, RIH open - ended and set cement plugs in accordance with regulatory agency instructions. Also, if P & A's, set EZSV-type cement retainer approximately 50' above last casing show and place 50 sacks of cement below and above retainer.
10. If not P & A'd, set 5 1/2" production casing at 2900'. Run casing, cement and centralize. Fill casing every 20 joints while running in hole. Set full casing weight on slips. Check float equipment operation.
11. C.O. casing. ND BOPE and install (See Note 2 below) tubing head. Test to 1500 psi. NU dry hole tree. Release rig.

NOTES: 1. 8 5/8" x 11" 3M SOW csg. head w/2 - 2" LPO, 1-solid bull plug & 1-3M ball valve.

2. 11" x 7 1/16" 3M tbg. head w/2 - 2" LPO, 1-solid bull plug & 1-3M ball valve.

0903Z

N MEXICO OIL CONSERVATION COMMISS
WELL LOCATION AND ACREAGE DEDICATION PLAT

Form C-102
 Supersedes C-128
 Effective 1-1-65

All distances must be from the outer boundaries of the Section.

Operator Tenneco Oil Co.			Lease State HL 1		Well No. 3
Unit Letter B	Section 1	Township 19 South	Range 29 East	County Eddy	
Actual Footage Location of Well: 1980 feet from the East line and 660 feet from the North line					
Ground Level Elev. 3423	Producing Formation Grayburg		Pool Leo Queen, So. (Grayburg) Undesig.	Dedicated Acreage: 40 Acres	

1. Outline the acreage dedicated to the subject well by colored pencil or hatchure marks on the plat below.
2. If more than one lease is dedicated to the well, outline each and identify the ownership thereof (both as to working interest and royalty).
3. If more than one lease of different ownership is dedicated to the well, have the interests of all owners been consolidated by communitization, unitization, force-pooling, etc?

☐ Yes ☐ No If answer is "yes," type of consolidation _____

If answer is "no," list the owners and tract descriptions which have actually been consolidated. (Use reverse side of this form if necessary.) _____

No allowable will be assigned to the well until all interests have been consolidated (by communitization, unitization, forced-pooling, or otherwise) or until a non-standard unit, eliminating such interests, has been approved by the Commission.

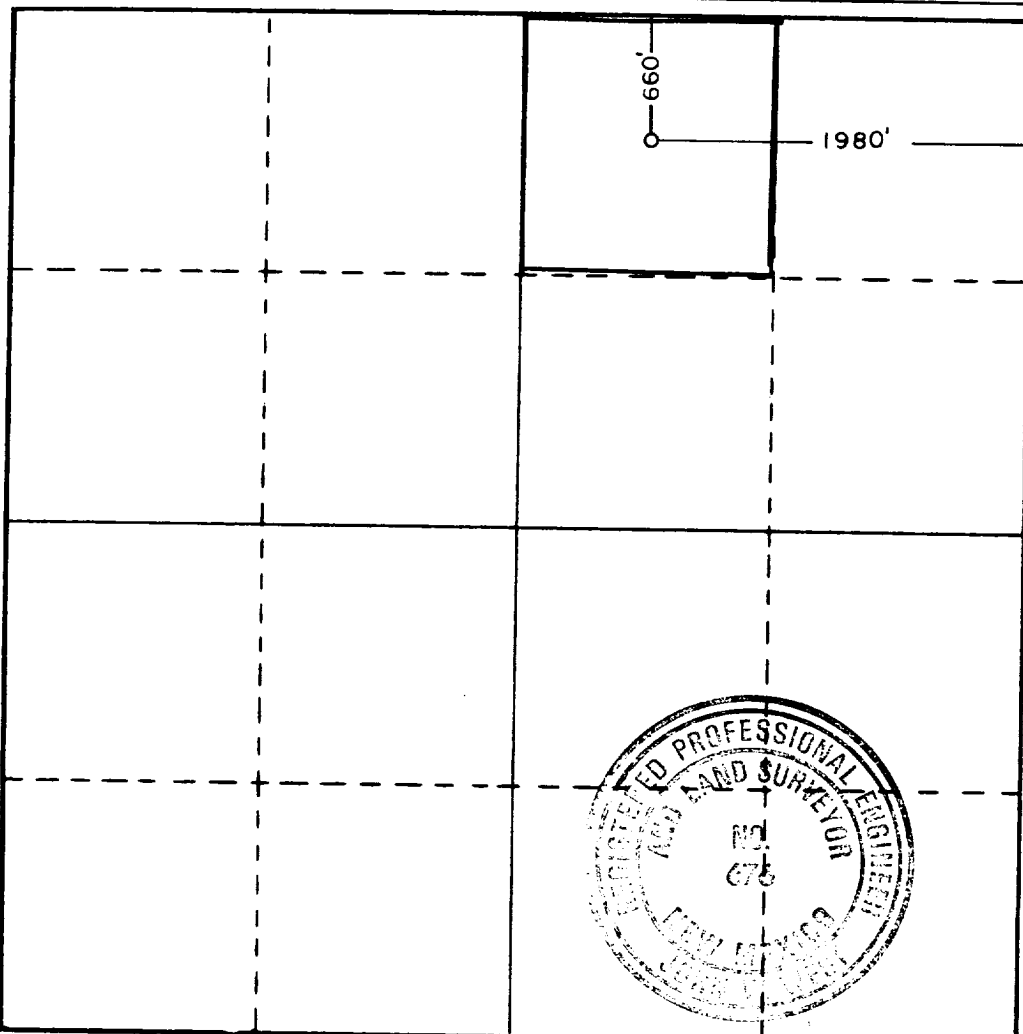

CERTIFICATION

I hereby certify that the information contained herein is true and complete to the best of my knowledge and belief.

Name *Ladell Collier*

Position
Geological Engineer

Company
Tenneco Oil Company

Date
28 June 1984

I hereby certify that the well location shown on this plat was plotted from field notes of actual surveys made by me or under my supervision, and that the same is true and correct to the best of my knowledge and belief.

June 6, 1984

Date Surveyed

Registered Professional Engineer and/or Land Surveyor

John W. West

Certificate No. **JOHN W. WEST, 676**
RONALD J. EIDSON, 3239



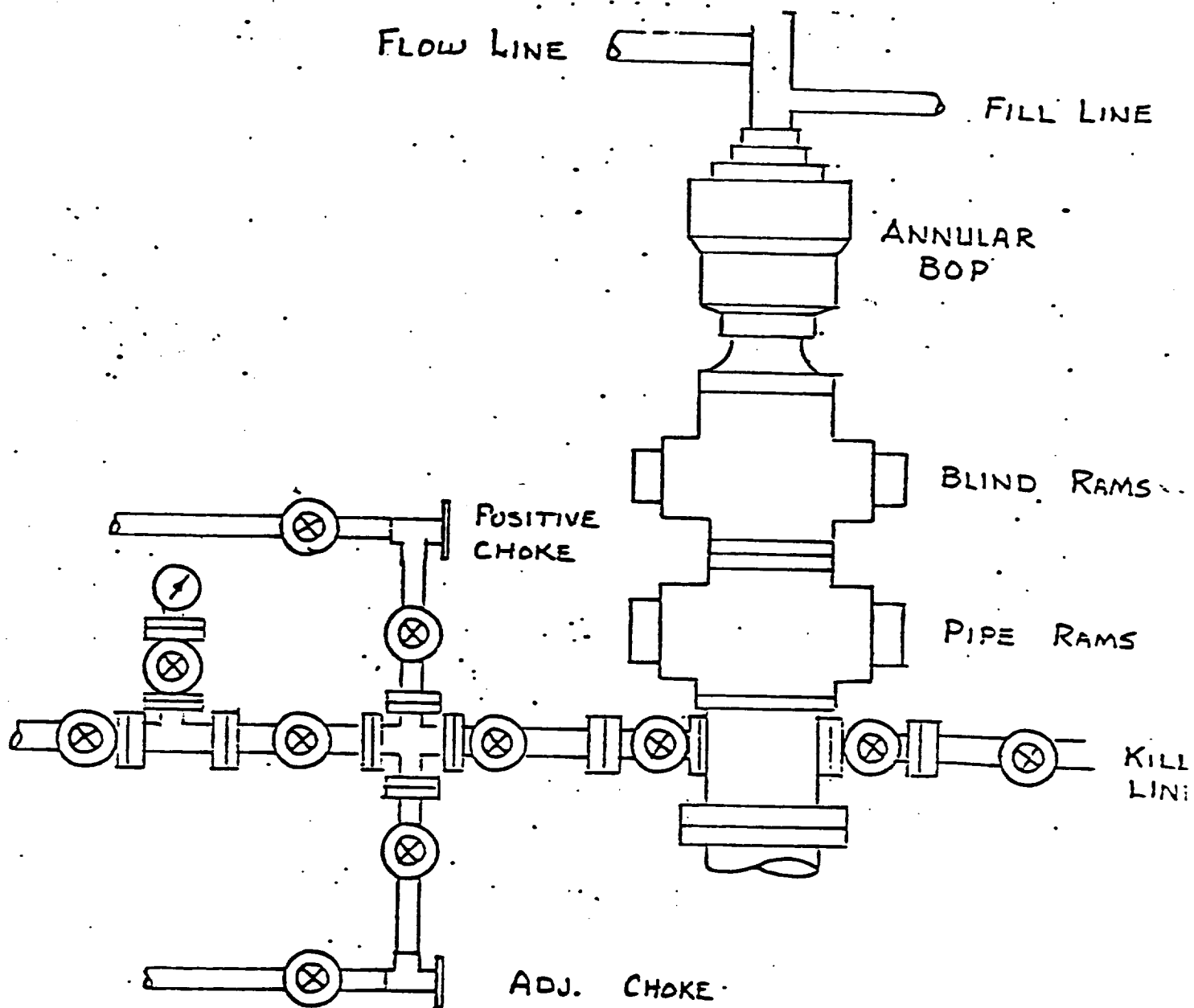

This is to be 3000 psi wp, which is adequate, that will be used on the 11" and 7 7/8" hole. This is the minimum possible BOP stack that will be used. Tenneco may choose to use more equipment and higher pressure.