

Operator Yates Petroleum Corporation		Lease Triangle Ranch "AAB" State		
Unit Letter B	Section 24	Township 19S	Range 23E	County Eddy

Actual Footage Location of Well:				
990	feet from the North	line and	1980	feet from the East
Ground Level Elev. 3833'	Producing Formation Permo Penn	Pool Wildcat Permo Penn	Dedicated Acreage: 320 Acres	

1. Outline the acreage dedicated to the subject well by colored pencil or hatchure marks on the plat below.
2. If more than one lease is dedicated to the well, outline each and identify the ownership thereof (both as to working interest and royalty).
3. If more than one lease of different ownership is dedicated to the well, have the interests of all owners been consolidated by communitization, unitization, force-pooling, etc?

☐ Yes ☐ No If answer is "yes," type of consolidation _____

If answer is "no," list the owners and tract descriptions which have actually been consolidated. (Use reverse side of this form if necessary.) _____

No allowable will be assigned to the well until all interests have been consolidated (by communitization, unitization, forced-pooling, or otherwise) or until a non-standard unit, eliminating such interests, has been approved by the Division.

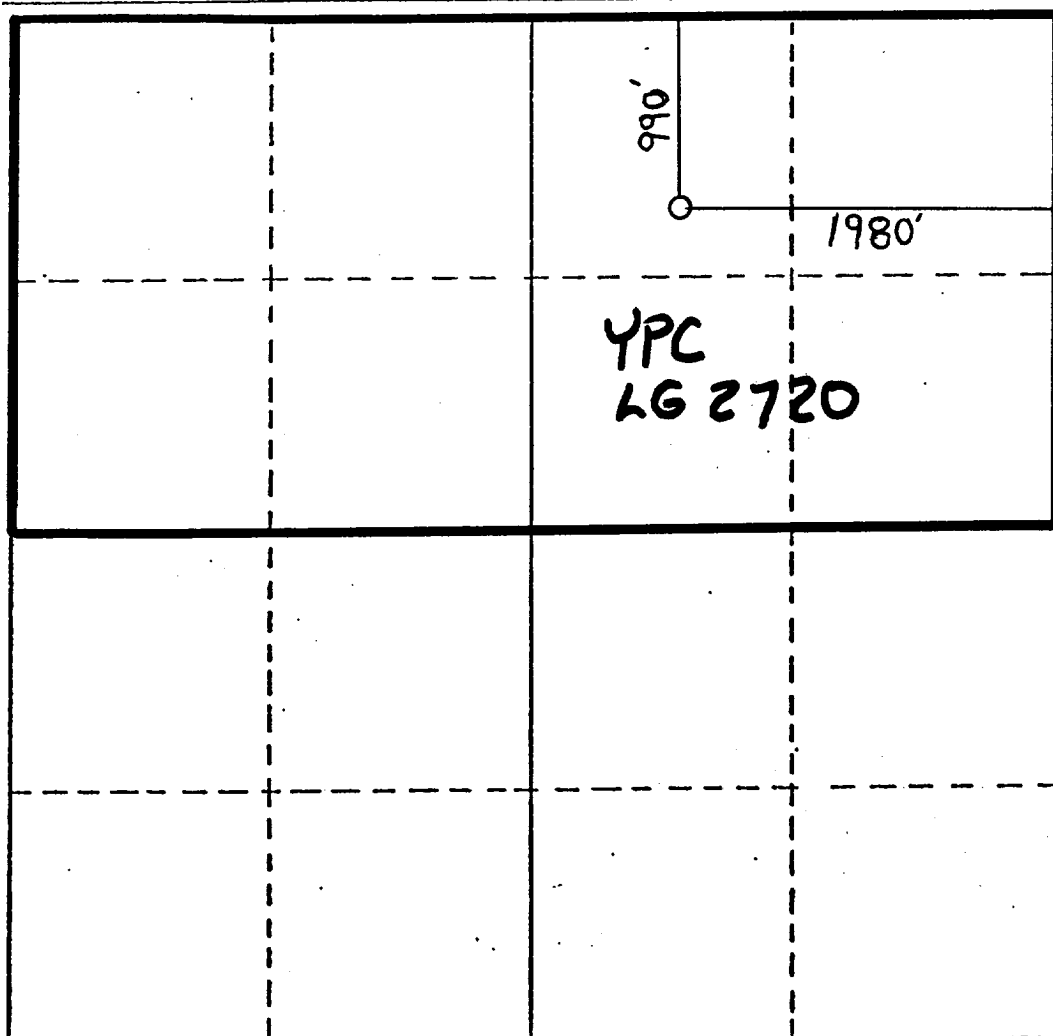

CERTIFICATION

I hereby certify that the information contained herein is true and complete to the best of my knowledge and belief.

Name *Cy Cowan*
Cy Cowan

Position
Regulatory Agent

Company
Yates Petroleum Corporation

Date
July 23, 1985

I hereby certify that the well location shown on this plat was plotted from field notes of actual surveys made by me or under my supervision, and that the same is true and correct to the best of my knowledge and belief.

SEE ORIGINAL PLAT

Date Surveyed
dated August 7, 1984

Registered Professional Engineer
and/or Land Surveyor

Certificate No.

