

NEW MEXICO OIL CONSERVATION COMMISSION
WELL LOCATION AND ACREAGE DEDICATION PLAT

FEB 4 1985

Form O-102
Supersedes O-128
Effective 1-1-65

O. C. D.

All distances must be from the outer boundaries of the Section

ARTESIA, OFFICE

Operator CHAMA PETROLEUM CO.			Lease CHAMA & ANDERSON COM			Well No. 1		
Lot Letter B	Section 10	Township 20 SOUTH	Range 25 EAST	County EDDY				
Actual Footage Location of Well: 660 feet from the NORTH line and 1980 feet from the EAST line								
Ground Level Elev. 3404.3	Producing Formation MORROW - PENN		Pool CEMETARY MORROW			Dedicated Acreage: 320 Acres		

1. Outline the acreage dedicated to the subject well by colored pencil or hachure marks on the plat below.
2. If more than one lease is dedicated to the well, outline each and identify the ownership thereof (both as to working interest and royalty).
3. If more than one lease of different ownership is dedicated to the well, have the interests of all owners been consolidated by communitization, unitization, force-pooling, etc?

☐ Yes ☒ No If answer is "yes," type of consolidation Will be communitized upon completion

If answer is "no," list the owners and tract descriptions which have actually been consolidated. (Use reverse side of this form if necessary.) _____

No allowable will be assigned to the well until all interests have been consolidated (by communitization, unitization, forced-pooling, or otherwise) or until a non-standard unit, eliminating such interests, has been approved by the Commission.

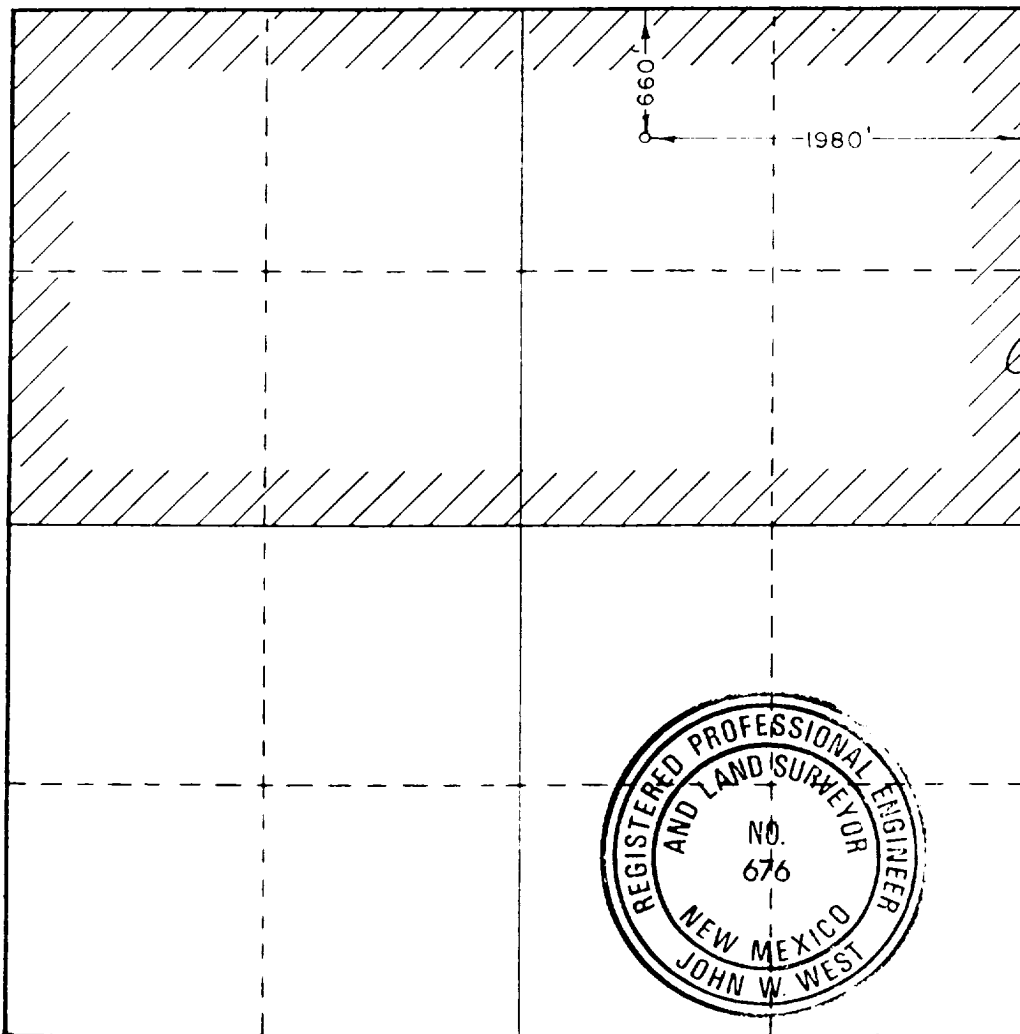

CERTIFICATION

I hereby certify that the information contained herein is true and complete to the best of my knowledge and belief.

Name John W. West

Position
AGENT

Company
CHAMA PETROLEUM CO.

Date
FEBRUARY 2, 1985

I hereby certify that the well location shown on this plat was plotted from field notes of actual surveys made by me or under my supervision, and that the same is true and correct to the best of my knowledge and belief.

Date Surveyed
FEBRUARY 2, 1985

Registered Professional Engineer and/or Land Surveyor

John W. West
Certificate No. JOHN W. WEST, 676
RONALD J. EIDSON 3239