

Exxon Lse. No. _____
State Lse. No. _____
Federal Lse. No. _____

NEW MEXICO OIL CONSERVATION COMMISSION
WELL LOCATION AND ACREAGE DEDICATION PLAT

Form C-102
Supersedes C-128
Effective 1-1-65

All distances must be from the outer boundaries of the Section.

Operator Exxon Corporation ✓			Lease N.M. "ES" STATE COM.			Well No. 1		
Letter 0	Section 7	Township 19S	Range 24E	County EDDY				
Actual Footage Location of Well: 660 feet from the South line and 1980 feet from the East line								
Ground Level Elev. 3814'		Producing Formation Permian Permian			Pool Wolfcamp		Dedicated Acreage: 319.49 Acres	

1. Outline the acreage dedicated to the subject well by colored pencil or hachure marks on the plat below.
2. If more than one lease is dedicated to the well, outline each and identify the ownership thereof (both as to working interest and royalty).
3. If more than one lease of different ownership is dedicated to the well, have the interests of all owners been consolidated by communitization, unitization, force-pooling, etc?

☐ Yes ☐ No If answer is "yes," type of consolidation _____

If answer is "no," list the owners and tract descriptions which have actually been consolidated. (Use reverse side of this form if necessary.) _____
No allowable will be assigned to the well until all interests have been consolidated (by communitization, unitization, forced-pooling, or otherwise) or until a non-standard unit, eliminating such interests, has been approved by the Commission.

RECEIVED BY
NOV 12 1985
O. C. D.
ARTESIA, OFFICE

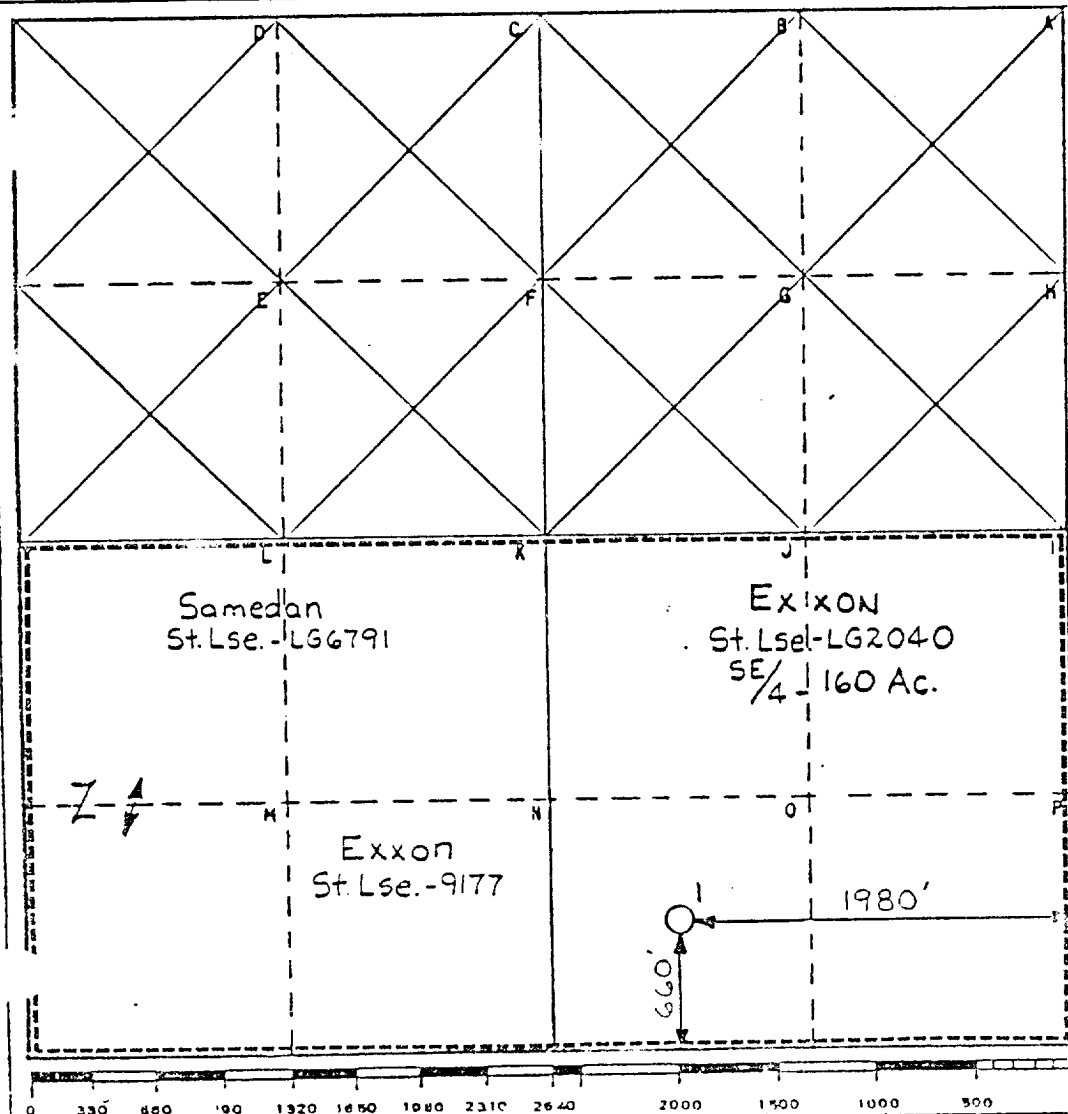

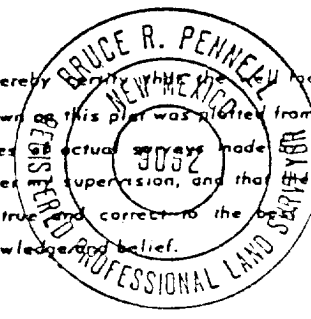
CERTIFICATION	
I hereby certify that the information contained herein is true and complete to the best of my knowledge and belief.	
Name <i>Melba Knippling</i>	Position UNIT HEAD
Company Exxon Corporation Box 1600 Midland, Texas	
Date 4-24-85	
I hereby certify that the location shown on this plat was plotted from field notes of actual surveys made by me or under my supervision, and that the same is true and correct to the best of my knowledge and belief.	
	
Date Surveyed 12-19-84	
Registered Professional Engineer and/or Land Surveyor <i>Bruce R. Penney</i>	
Certificate No. 9062	