

All Distances must be from the outer boundaries of the Section.

Operator Coquina Oil Corp.		Lease Pan Canadian B		Well No. 3
Unit Letter A	Section 34	Township 19 South	Range 25 East	County Eddy
Actual Footage Location of Well 660 feet from the North line and 785 feet from the East line				
Ground Level Elev. 3502	Producing Formation yes	Pool Coquina Oil Corp.	Dedicated Acreage 40 Acres	

1. Outline the acreage dedicated to the subject well by colored pencil or hatchure marks on the plat below.

2. If more than one lease is dedicated to the well, outline each and identify the ownership thereof (both as to working interest and royalty).

3. If more than one lease of different ownership is dedicated to the well, have the interests of all owners been consolidated by communitization, unitization, force-pooling, etc?

☐ Yes ☐ No If answer is "yes," type of consolidation _____

If answer is "no," list the owners and tract descriptions which have actually been consolidated. (Use reverse side of this form if necessary.) _____

No allowable will be assigned to the well until all interests have been consolidated (by communitization, unitization, forced-pooling, or otherwise) or until a non-standard unit, eliminating such interests, has been approved by the Division

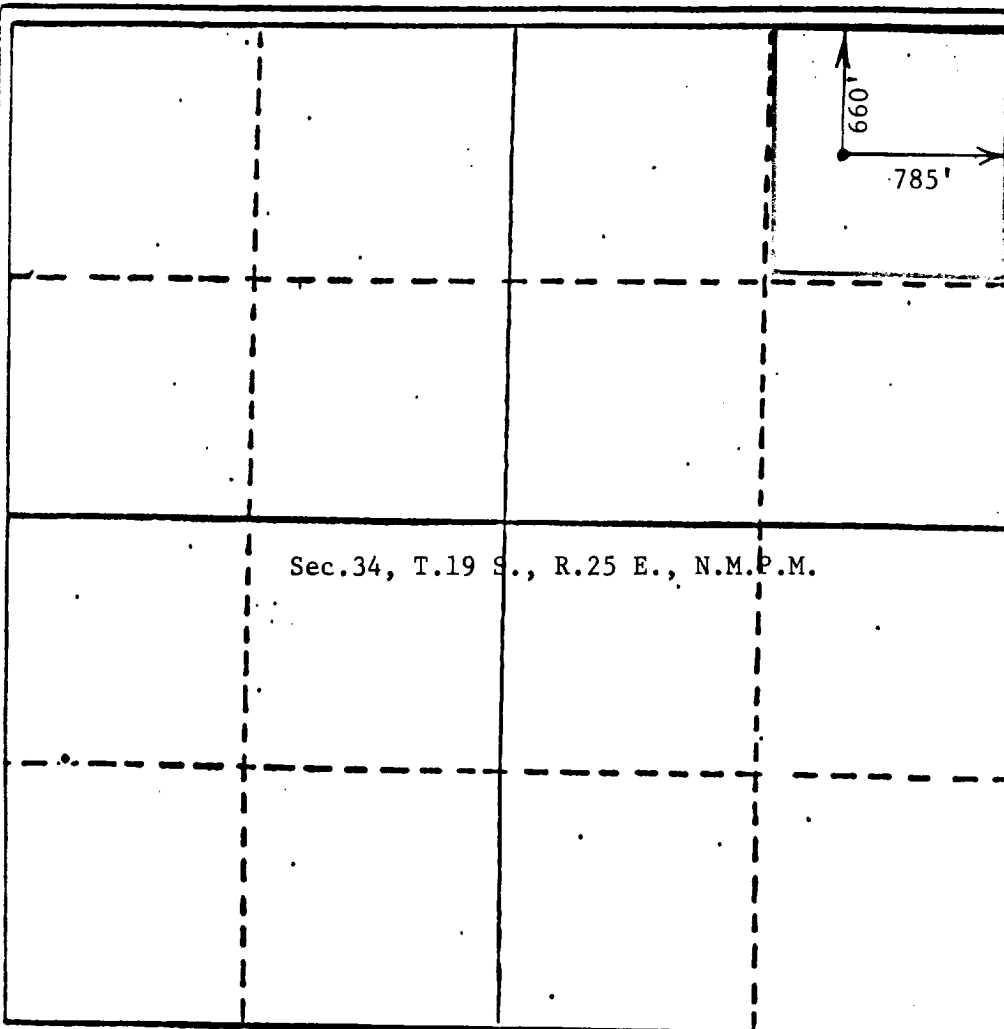

CERTIFICATION	
I hereby certify that the information contained herein is true and complete to the best of my knowledge and belief.	
Name John Taylor	
Position Sup't.	
Company Coquina Oil Corp.	
Date 6-7-85	
I hereby certify that the well location shown on this plat was plotted from field notes of actual surveys made by me or under my supervision, and that the same is true and correct to the best of my knowledge and belief.	
Date Surveyed April 25, 1985	
Registered Professional Engineer and/or Land Surveyor John D. Jaques, P.E. & L.S.	
Certificate No. 6290	