

Submit to Appropriate
District Office
State Lease -- 6 copies
Fee Lease -- 5 copies

State of New Mexico
Energy, Minerals and Natural Resources Department

Form C-101
Revised 1-1-89

clsf +
dp

OIL CONSERVATION DIVISION

DISTRICT I
P.O. Box 1980, Hobbs, NM 88240

P.O. Box 2088
Santa Fe, New Mexico 87504-2088

DISTRICT II
P.O. Drawer DD, Artesia, NM 88210

DISTRICT III
1000 Rio Brazos Rd., Aztec, NM 87410

API NO. (assigned by OCD on New Wells)
30-015-25337

5. Indicate Type of Lease
STATE ☒ FEE ☐

6. State Oil & Gas Lease No.
LG 6459

APPLICATION FOR PERMIT TO DRILL, DEEPEN, OR PLUG BACK

1a. Type of Work:

DRILL ☐ RE-ENTER ☐ DEEPEN ☐ PLUG BACK ☐

b. Type of Well:

OIL WELL ☐ GAS WELL ☐ OTHER ☐

SINGLE ZONE ☒ RECEIVED MULTIPLE ZONE ☐

7. Lease Name or Unit Agreement Name

Agave AAJ State

2. Name of Operator

YATES PETROLEUM CORPORATION

8. Well No.

2

3. Address of Operator

105 South 4th St., Artesia, NM 88210

9. Pool name or Wildcat

Undesignated

4. Well Location

Unit Letter K : 1980 Feet From The South ARTESIA, OFFICE and 1980 Feet From The West Line

Section 32 Township 19S Range 24E NMPM Eddy County

10. Proposed Depth
9010'

11. Formation
Wolfcamp

12. Rotary or C.T.
Pulling Unit

13. Elevations (Show whether DF, RT, GR, etc.)
3826' GR

14. Kind & Status Plug. Bond
Blanket

15. Drilling Contractor
-

16. Approx. Date Work will start
When approved

17.

PROPOSED CASING AND CEMENT PROGRAM

SIZE OF HOLE	SIZE OF CASING	WEIGHT PER FOOT	SETTING DEPTH	SACKS OF CEMENT	EST. TOP
17 1/2"	13-3/8"	54.5#	376'	850 sx (in place)	
11"	8-5/8"	24#	1175'	850 sx (in place)	
7-7/8"	7"	20#	1600'	125 sx (in place)	
6-1/8"	4 1/2"	11.6#	9002'	1075 sx (in place)	

Well is presently completed in Cisco perforations 6738-56' and is depleted. Propose to set CIBP at 6700' with cement cap and recompleate in Wolfcamp at 6307-21', 6346-48'. Weill stimulate as needed for production.

APPROVAL VALID FOR 180 DAYS
PERMIT EXPIRES 2/2/90
UNLESS DRILLING UNDERWAY

IN ABOVE SPACE DESCRIBE PROPOSED PROGRAM: IF PROPOSAL IS TO DEEPEN OR PLUG BACK, GIVE DATA ON PRESENT PRODUCTIVE ZONE AND PROPOSED NEW PRODUCTIVE ZONE. GIVE BLOWOUT PREVENTER PROGRAM, IF ANY.

I hereby certify that the information above is true and complete to the best of my knowledge and belief.

SIGNATURE Juanita Goodlett TITLE Production Supervisor DATE 7-28-89
TYPE OR PRINT NAME Juanita Goodlett TELEPHONE NO. 505/748-1471

(This space for State Use)

ORIGINAL SIGNED BY

APPROVED BY STATE ENGINEER TITLE STATE ENGINEER DATE AUG 1 1989

CONDITIONS OF APPROVAL, IF ANY:

Submit to Appropriate
District Office
State Lease - 4 copies
Fee Lease - 3 copies

State of New Mexico
Energy, Minerals and Natural Resources Department

Form C-102
Revised 1-1-89

OIL CONSERVATION DIVISION

P.O. Box 2088
Santa Fe, New Mexico 87504-2088

DISTRICT I
P.O. Box 1980, Hobbs, NM 88240

DISTRICT II
P.O. Drawer DD, Artesia, NM 88210

DISTRICT III
1000 Rio Brazos Rd., Aztec, NM 87410

WELL LOCATION AND ACREAGE DEDICATION PLAT

All Distances must be from the outer boundaries of the section

Operator YATES PETROLEUM CORPORATION			Lease AGAVE AAJ STATE		Well No. 2
Unit Letter K	Section 32	Township 19 South	Range 24 East	County Eddy	NMPM
Actual Footage Location of Well: 1980 feet from the South line and 1980 feet from the West line					
Ground level Elev. 3826'	Producing Formation Wolfcamp		Pool Undesignated		Dedicated Acreage: 320 Acres

1. Outline the acreage dedicated to the subject well by colored pencil or hachure marks on the plat below.
2. If more than one lease is dedicated to the well, outline each and identify the ownership thereof (both as to working interest and royalty).
3. If more than one lease of different ownership is dedicated to the well, have the interest of all owners been consolidated by communitization, unitization, force-pooling, etc.?
☐ Yes ☐ No If answer is "yes" type of consolidation _____
If answer is "no" list the owners and tract descriptions which have actually been consolidated. (Use reverse side of this form if necessary). _____
No allowable will be assigned to the well until all interests have been consolidated (by communitization, unitization, forced-pooling, or otherwise) or until a non-standard unit, eliminating such interest, has been approved by the Division.

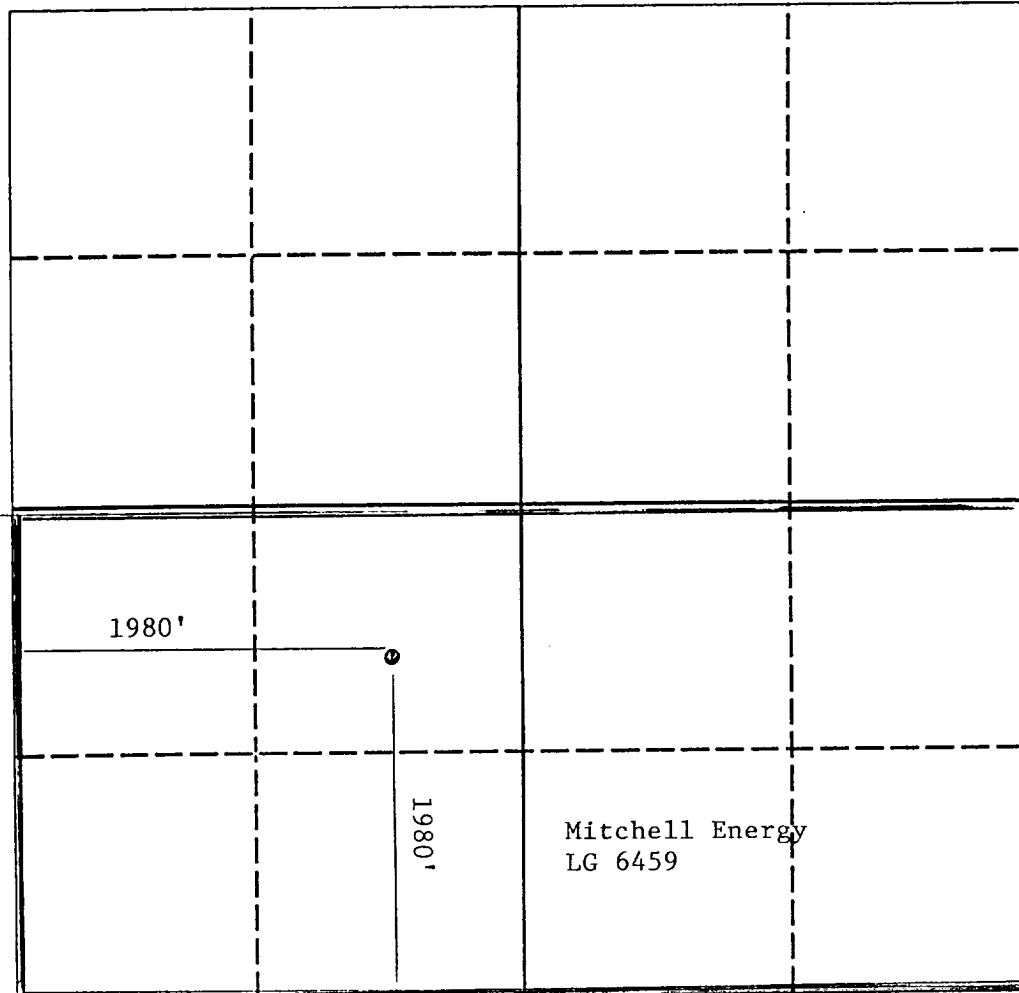

OPERATOR CERTIFICATION

I hereby certify that the information contained herein is true and complete to the best of my knowledge and belief.

Signature
Juanita Goodlett
Printed Name
Juanita Goodlett
Position
Production Supervisor
Company
Yates Petroleum Corporation
Date
7-28-89

SURVEYOR CERTIFICATION

I hereby certify that the well location shown on this plat was plotted from field notes of actual surveys made by me or under my supervision, and that the same is true and correct to the best of my knowledge and belief.

Date Surveyed
REFER TO ORIGINAL PLAT
Signature & Seal of
Professional Surveyor

Certificate No.

