

Submit to Appropriate
District Office
State Lease - 6 copies
Fee Lease - 5 copies
DISTRICT I
P.O. Box 1980, Hobbs, NM 88240

DISTRICT II
P.O. Drawer DD, Artesia, NM 88210

DISTRICT III
1000 Rio Brazos Rd., Aztec, NM 87410

State of New Mexico
Energy, Minerals and Natural Resources Department

OIL CONSERVATION DIVISION

P.O. Box 20880 - 4 '89
Santa Fe, New Mexico 87504-2088

O. C. D.
ARTESIA, OFFICE

Form C-105
Revised 1-1-89

CLF
BWM
ST
BWM

WELL API NO. 30-015-25337
5. Indicate Type of Lease STATE <input checked="" type="checkbox"/> FEE <input type="checkbox"/>
6. State Oil & Gas Lease No. LG 6459

WELL COMPLETION OR RECOMPLETION REPORT AND LOG

1a. Type of Well: OIL WELL <input type="checkbox"/> GAS WELL <input checked="" type="checkbox"/> DRY <input type="checkbox"/> OTHER RECOMPLETION	7. Lease Name or Unit Agreement Name Agave AAJ State
b. Type of Completion: NEW WELL <input type="checkbox"/> WORK OVER <input type="checkbox"/> DEEPEN <input type="checkbox"/> PLUG BACK <input type="checkbox"/> DIFF RESVR <input type="checkbox"/> OTHER	8. Well No. 2
2. Name of Operator YATES PETROLEUM CORPORATION (505) 748-1471	9. Pool name or Wildcat Undesignated Abo
3. Address of Operator 105 South 4th St., Artesia, NM 88210	

4. Well Location Unit Letter K : 1980 Feet From The South Line and 1980 Feet From The West Line Section 32 Township 19S Range 24E NMPM Eddy County
--

10. Date Spudded 8-3-89	11. Date T.D. Reached -	12. Date Compl. (Ready to Prod.) 9-9-89	13. Elevations (DF & RKB, RT, GR, etc.) 3826' GR	14. Elev. Casinghead
15. Total Depth 9010'	16. Plug Back T.D. 4698'	17. If Multiple Compl. How Many Zones?	18. Intervals Drilled By Rotary Tools Cable Tools Pulling Unit	
19. Producing Interval(s), of this completion - Top, Bottom, Name 3913-4661' Abo				20. Was Directional Survey Made No
21. Type Electric and Other Logs Run None for Recompletion				22. Was Well Cored No

23. CASING RECORD (Report all strings set in well)					
CASING SIZE	WEIGHT LB/FT.	DEPTH SET	HOLE SIZE	CEMENTING RECORD	AMOUNT PULLED
13-3/8"	54.5#	376'	17 1/2"	850 sx (in place)	
8-5/8"	24#	1175'	11"	850 sx (in place)	
7"	20#	1600'	7-7/8"	125 sx (in place)	
4 1/2"	11.6#	9002'	6-1/8"	1075 sx (in place)	

24. LINER RECORD					25. TUBING RECORD		
SIZE	TOP	BOTTOM	SACKS CEMENT	SCREEN	SIZE	DEPTH SET	PACKER SET
					2-3/8"	3885'	3885'

26. Perforation record (interval, size, and number) 3913-4661' w/52 .42" Holes	27. ACID, SHOT, FRACTURE, CEMENT, SQUEEZE, ETC.	
	DEPTH INTERVAL	AMOUNT AND KIND MATERIAL USED
	3913-4661'	w/9500g. 20% NEFE acid.

28. PRODUCTION							
Date First Production 9-9-89		Production Method (Flowing, gas lift, pumping - Size and type pump) Flowing				Well Status (Prod. or Shut-in) SIWOPLC	
Date of Test 9-9-89	Hours Tested 4	Choke Size 1/2"	Prod'n For Test Period	Oil - Bbl. -	Gas - MCF 483	Water - Bbl. -	Gas - Oil Ratio -
Flow Tubing Press. 450	Casing Pressure Pkr	Calculated 24-Hour Rate	Oil - Bbl. -	Gas - MCF 2900	Water - Bbl. -	Oil Gravity - API - (Corr.) -	

29. Disposition of Gas (Sold, used for fuel, vented, etc.) Vented - Will be sold	Test Witnessed By Harvey Apple
---	-----------------------------------

30. List Attachments None for recompletion

31. I hereby certify that the information shown on both sides of this form is true and complete to the best of my knowledge and belief			
Signature <i>Juanita Goodlett</i>	Printed Name Juanita Goodlett	Title Production Supvr	Date 10-2-89

INSTRUCTIONS

This form is to be filed with the appropriate District Office of the Division not later than 20 days after the completion of any newly-drilled or deepened well. It shall be accompanied by one copy of all electrical and radio-activity logs run on the well and a summary of all special tests conducted, including drill stem tests. All depths reported shall be measured depths. In the case of directionally drilled wells, true vertical depths shall also be reported. For multiple completions, Items 25 through 29 shall be reported for each zone. The form is to be filed in quintuplicate except on state land, where six copies are required. See Rule 1105.

INDICATE FORMATION TOPS IN CONFORMANCE WITH GEOGRAPHICAL SECTION OF STATE

Southeastern New Mexico

Northwestern New Mexico

Southeastern		Lower		Ojo		Penn.	
T. Anhy		T. Canyon	7422	T. Ojo Alamo		T. Penn. "B"	
T. Salt		T. Strawn Mkr	8234	T. Kirtland-Fruitland		T. Penn. "C"	
B. Salt		T. Atoka		T. Pictured Cliffs		T. Penn. "D"	
T. Yates		T. Miss		T. Cliff House		T. Leadville	
T. 7 Rivers		T. Devonian		T. Menefee		T. Madison	
T. Queen		T. Silurian		T. Point Lookout		T. Elbert	
T. Grayburg		T. Montoya		T. Mancos		T. McCracken	
T. San Andres		T. Simpson		T. Gallup		T. Ignacio Otzte	
T. Glorieta		T. McKee		Base Greenhorn		T. Granite	
T. Paddock		T. Ellenburger		T. Dakota		T.	
T. Blinberry		T. Gr. Wash		T. Morrison		T.	
T. Tubb		T. Delaware Sand		T. Todilto		T.	
T. Drinkard		T. Bone Springs		T. Entrada		T.	
T. Abo	3762	T. Morrow Clastic	8695	T. Wingate		T.	
T. Wolfcamp Lwr	5052	T. Chester	8930	T. Chinle		T.	
T. Penn		T.		T. Permian		T.	
T. Cisco (Bough C)	6522	T.		T. Penn "A"		T.	

OIL OR GAS SANDS OR ZONES

No. 1, from.....to.....
No. 2, from.....to.....
No. 3, from.....to.....
No. 4, from.....to.....

IMPORTANT WATER SANDS

Include data on rate of water inflow and elevation to which water rose in hole.

No. 1, from.....to.....feet.....
No. 2, from.....to.....feet.....
No. 3, from.....to.....feet.....

LITHOLOGY RECORD (Attach additional sheet if necessary)

From	To	Thickness in Feet	Lithology	From	To	Thickness in Feet	Lithology
			REFER TO ORIGINAL COMPLETION.				

MEXICO OIL CONSERVATION COMM. JUN
WELL LOCATION AND ACREAGE DEDICATION PLAT

Form C-102
Supersedes C-128
Effective 1-1-65

All distances must be from the outer boundaries of the Section.

Operator YATES PETROLEUM CORP.			Lease AGAVE AAJ STATE		Well No. 2
Unit Letter K	Section 32	Township 19 SOUTH	Range 24 EAST	County EDDY	
Actual Footage Location of Well: 1980 feet from the SOUTH line and 1980 feet from the WEST line					
Ground Level Elev. 3826	Producing Formation MORROW P/S		Pool UNDE S MORROW P/S	Dedicated Acreage: 320 Acres	

1. Outline the acreage dedicated to the subject well by colored pencil or hachure marks on the plat below.
2. If more than one lease is dedicated to the well, outline each and identify the ownership thereof (both as to working interest and royalty).
3. If more than one lease of different ownership is dedicated to the well, have the interests of all owners been consolidated by communitization, unitization, force-pooling, etc?

☐ Yes ☐ No If answer is "yes," type of consolidation _____

If answer is "no," list the owners and tract descriptions which have actually been consolidated. (Use reverse side of this form if necessary.) _____

No allowable will be assigned to the well until all interests have been consolidated (by communitization, unitization, forced-pooling, or otherwise) or until a non-standard unit, eliminating such interests, has been approved by the Commission.

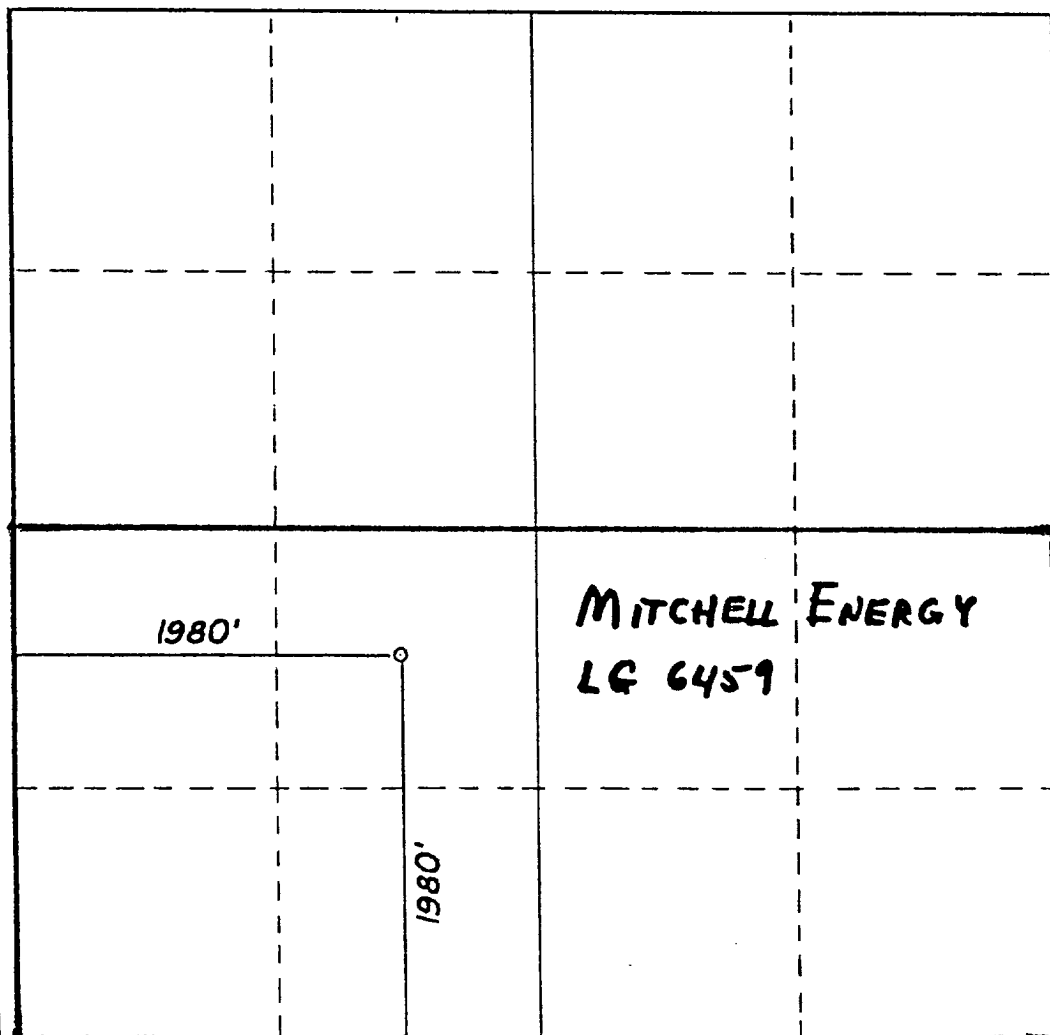

CERTIFICATION

I hereby certify that the information contained herein is true and complete to the best of my knowledge and belief.

Clifton May

Name

Clifton May

Position

Regulatory Agent

Company

Yates Petroleum Corporation

Date

July 19, 1985

I hereby certify that the well location shown on this plat was plotted from field notes of actual surveys made by me or under my supervision, and that the same is true and correct to the best of my knowledge and belief.

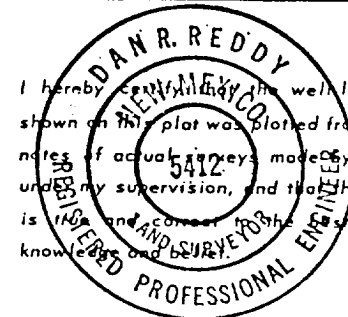

Date Surveyed

JULY 18, 1985

Registered Professional Engineer and/or Land Surveyor

Dan R. Reddy

Certificate No.

NM PE and LS #5412

