

UNITED STATES  
DEPARTMENT OF THE INTERIOR  
BUREAU OF LAND MANAGEMENT

APPLICATION FOR PERMIT TO DRILL, DEEPEN, OR PLUG BACK

1a. TYPE OF WORK

DRILL ☒

DEEPEN ☐

PLUG BACK ☐

b. TYPE OF WELL

OIL  
WELL ☒

GAS  
WELL ☐

OTHER

SINGLE  
ZONE ☐

MULTIPLE  
ZONE ☒

2. NAME OF OPERATOR

Siete Oil and Gas Corporation ✓

3. ADDRESS OF OPERATOR

Post Office Box 2523, Roswell, NM 88201

4. LOCATION OF WELL (Report location clearly and in accordance with any State requirements.)\*  
At surface

2040' FSL & 920' FWL, NW/4 SW/4, Unit Letter L

At proposed prod. zone  
same

14. DISTANCE IN MILES AND DIRECTION FROM NEAREST TOWN OR POST OFFICE\*

14.50 miles Southeast of Loco Hills, New Mexico

15. DISTANCE FROM PROPOSED\*  
LOCATION TO NEAREST  
PROPERTY OR LEASE LINE, FT.  
(Also to nearest drlg. unit line, if any)

360'

16. NO. OF ACRES IN LEASE

1160'

17. NO. OF ACRES ASSIGNED  
TO THIS WELL

40

18. DISTANCE FROM PROPOSED LOCATION\*  
TO NEAREST WELL, DRILLING, COMPLETED,  
OR APPLIED FOR, ON THIS LEASE, FT.

690'

19. PROPOSED DEPTH

4500'

20. ROTARY OR CABLE TOOLS

Rotary

21. ELEVATIONS (Show whether DF, RT, GR, etc.)

3692' GR

22. APPROX. DATE WORK WILL START\*

January 4, 1986

23. PROPOSED CASING AND CEMENTING PROGRAM

SIZE OF HOLE	SIZE OF CASING	WEIGHT PER FOOT	SETTING DEPTH	QUANTITY OF CEMENT
12 1/4"	8 5/8"	24.0#	400'	400 sxs (circulate)
7 7/8"	5 1/2"	15.5#	4500'	2,200 sxs (circulate)

Selectively perforate and treat pay zones.

Attachments:

Survey Plat (C-102)  
Supplemental Drilling Data  
Surface Use Plan

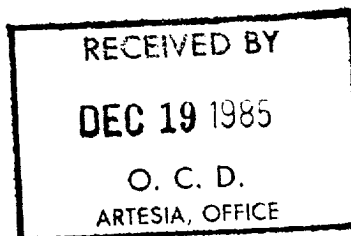

Posted API,  
IDI-NC  
12-27-85

IN ABOVE SPACE DESCRIBE PROPOSED PROGRAM: If proposal is to deepen or plug back, give data on present productive zone and proposed new productive zone. If proposal is to drill or deepen directionally, give pertinent data on subsurface locations and measured and true vertical depths. Give blowout preventer program, if any.

24.

SIGNED

TITLE President

DATE 12/16/85

(This space for Federal or State office use)

PERMIT NO.

APPROVAL DATE

APPROVED BY

TITLE

DATE 12-18-85

CONDITIONS OF APPROVAL, IF ANY:

APPROVAL SUBJECT TO  
GENERAL REQUIREMENTS AND  
SPECIAL STIPULATIONS

\*See Instructions On Reverse Side

NEW MEXICO OIL CONSERVATION COMMISSION  
WELL LOCATION AND ACREAGE DEDICATION PLAT

Form C-100  
Supersedes C-128  
Effective 1-1-65

All distances must be from the outer boundaries of the Section

Operator <b>Siete Oil &amp; Gas Corporation</b>		Lease <b>Blackhawk Federal</b>		Well No. <b>3</b>
Unit Letter <b>L</b>	Section <b>24</b>	Township <b>18 South</b>	Range <b>31 East</b>	County <b>Eddy</b>
Actual Fracture Location of Well: <b>2040</b> feet from the <b>South</b> line and <b>920</b> feet from the <b>West</b> line				
Ground Level Elev. <b>3692</b>	Producing Formation <b>Green</b>	Pool <b>Shugart</b>	Dedicated Acreage <b>40</b>	

1. Outline the acreage dedicated to the subject well by colored pencil or hatchure marks on the plat below.
2. If more than one lease is dedicated to the well, outline each and identify the ownership thereof (both as to working interest and royalty).
3. If more than one lease of different ownership is dedicated to the well, have the interests of all owners been consolidated by communitization, unitization, force-pooling, etc?

☐ Yes ☐ No If answer is "yes," type of consolidation \_\_\_\_\_

If answer is "no," list the owners and tract descriptions which have actually been consolidated. (Use reverse side of this form if necessary.) \_\_\_\_\_

No allowable will be assigned to the well until all interests have been consolidated (by communitization, unitization, forced-pooling, or otherwise) or until a non-standard unit, eliminating such interests, has been approved by the Commission.

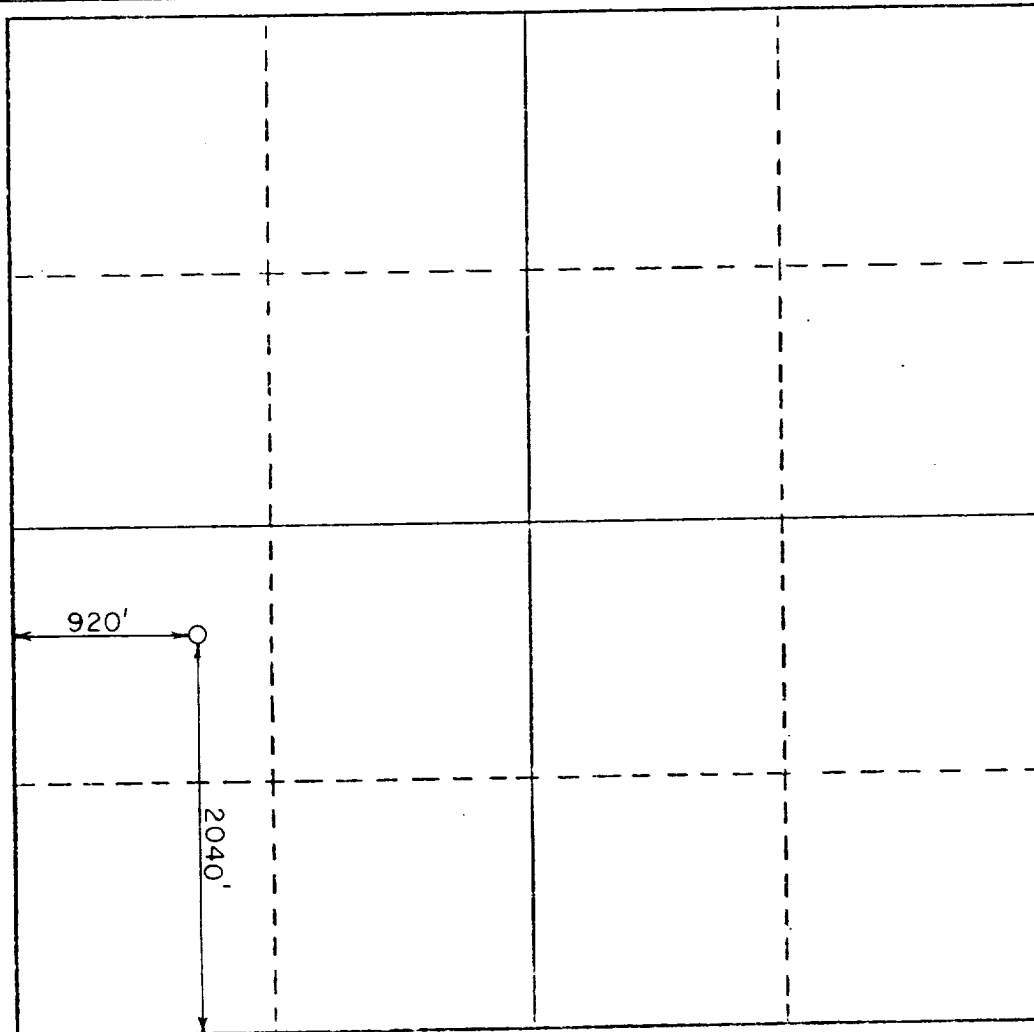

CERTIFICATION

I hereby certify that the information contained herein is true and complete to the best of my knowledge and belief.

Name Billy G. Underwood, JR.  
Position President  
Company Siete Oil & Gas Corporation  
Date December 16, 1985

I hereby certify that the well location shown on this plat was plotted from field notes of actual surveys made by me or under my supervision, and that the same is true and correct to the best of my knowledge and belief.

Date Surveyed December 10, 1985  
P. R. Patton  
Registered Professional Engineer  
and/or Land Surveyor

8112  
Certificate No.

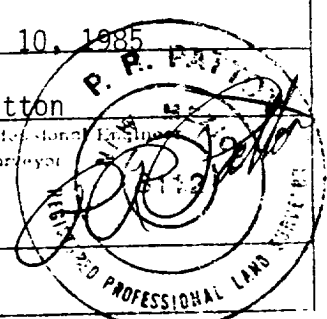

# Flow Line



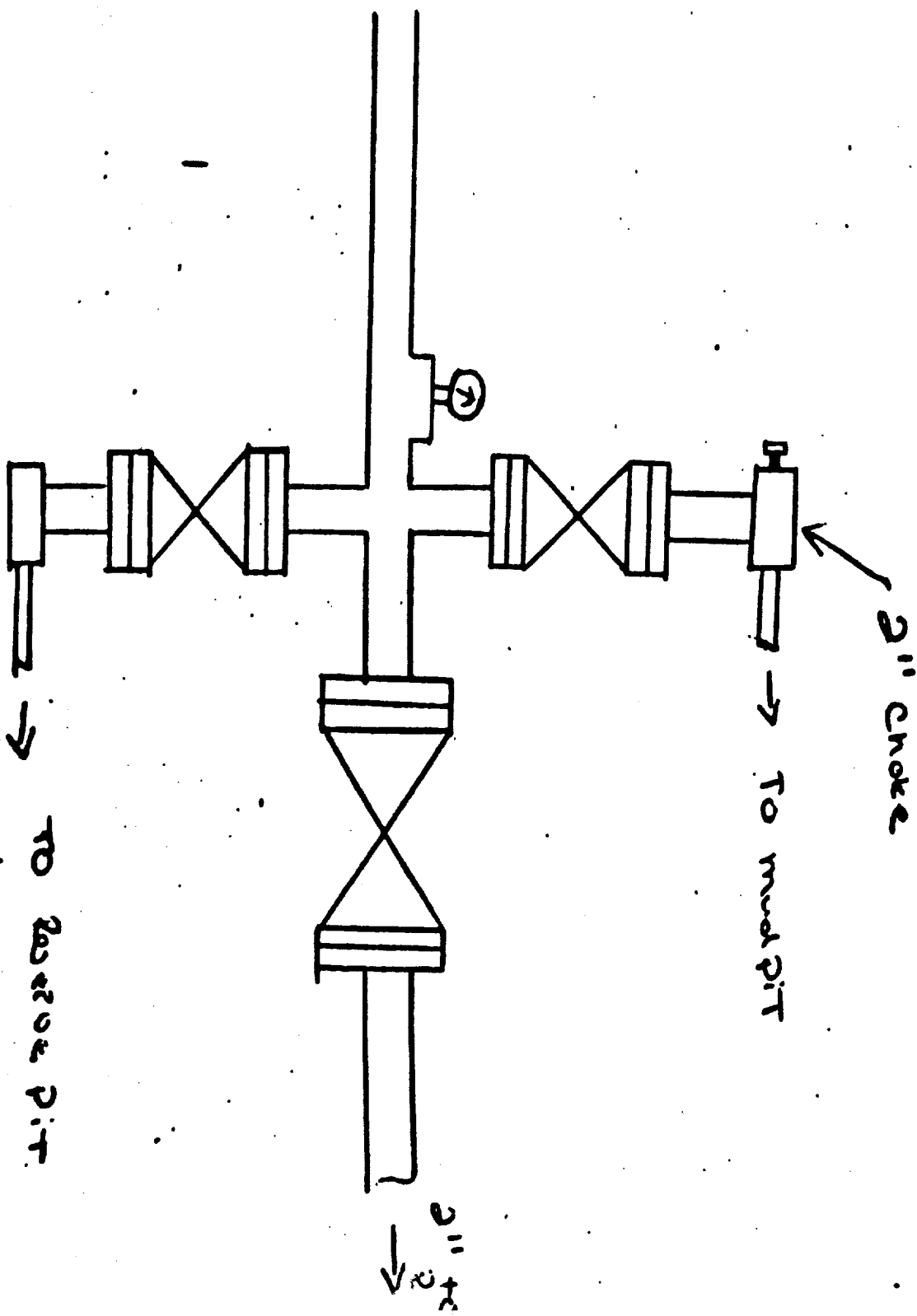

Accumulator

Gate operand,  
80 gal. reservoir

1484el lines 1  
P. 20 Rams 4 B1:  
Rams

SUPPLEMENTAL DRILLING DATA  
SIETE OIL AND GAS CORPORATION  
Blackhawk Federal #3  
2040' FSL & 920' FWL  
Section 24: T18S, R31E  
Eddy County, New Mexico  
Lease Number - LC 065680

The following items supplement "Onshore Oil and Gas Order No. 1:

1. The geologic surface is quaternary.
2. The estimated geological marker tops:

Yates	2340'	Seven Rivers	2530'
Queen	3500'	Penrose	3740'
Grayburg	3940'	Premier	4065'
San Andres	4115'		

3. Estimated depths to water, oil or gas:

Water: 200'  
Oil or Gas: 3505'

4. Proposed casing program:

<u>Size</u>	<u>Interval</u>	<u>Weight</u>	<u>Grade</u>	<u>Joint</u>	<u>New or Used</u>
8 5/8"	0 - 400'	24#	J-55	S.T.&.C.	New
5 1/2"	0 - 4500'	15.5#	J-55	S.T.&.C.	New

5. Pressure Control Equipment: The blowout preventer will be a double ram type preventer. A sketch is attached.

6. Mud Program:

0 - 400': Native mud adding gel and lime for sufficient viscosity to insure clean hole for running casing.  
400' - 4500': Drill out with native becoming brine at 4200' add starch and salt gel to maintain a viscosity of 32-38, mud weight 9.8 - 10.0, viscosity at T.D. 40.0.

7. Auxiliary Equipment: A kelly cock will be installed on the rig floor while drilling operations are in progress.

8. Testing, Logging and Coring Programs: Possible drillstem tests and/or coring is not planned.

Logging: Compensated Neutron - Formation Density - Gamma Ray - Caliper  
Dual Laterolog - RXO

9. No abnormal pressures or temperature zones are anticipated.

10. Anticipated starting date: Commence drilling operations January 4, 1986.



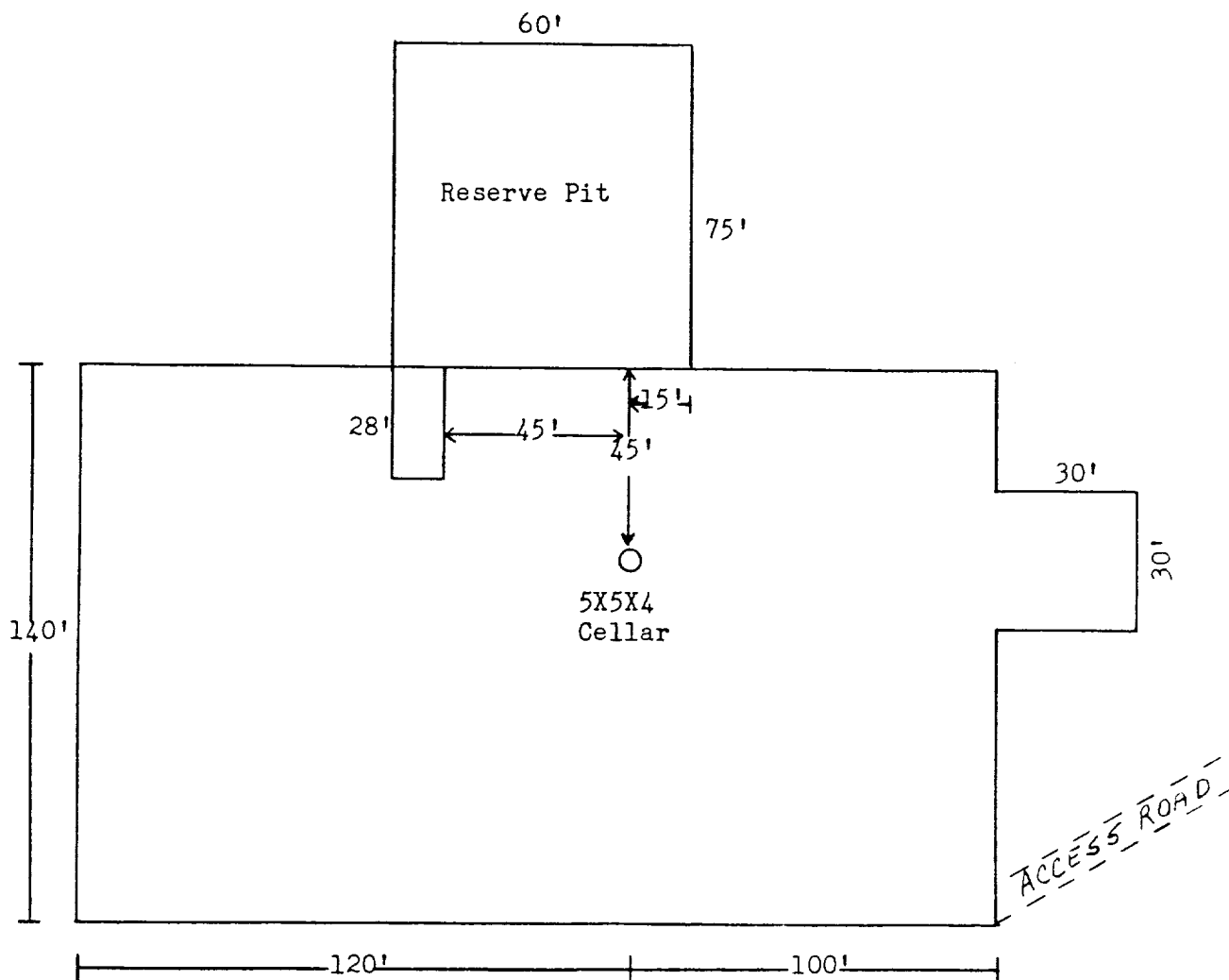

L&M Drilling Rig No. 1

Exhibit 'D'  
Siete Oil & Gas Corporation  
Blackhawk Federal #3  
2040' FSL & 920' FWL  
Sec. 24, T18S, R31E  
Eddy County, N.M.