

30-015-25655

| | |
|------------------------|--|
| NO. OF COPIES RECEIVED | |
| DISTRIBUTION | |
| SANTA FE | |
| FILE | |
| U.S.G.S. | |
| LAND OFFICE | |
| OPERATOR | |

RECEIVED BY DO. BO. 2088
SANTA FE, NEW MEXICO 87501
SEP 24 1986
O. C. D.
ARTESIA, OFFICE

5A. Indicate Type of Lease

STATE ☒ FEE ☐

5. State Oil & Gas Lease No.

LG 4171

APPLICATION FOR PERMIT TO DRILL, DEEPEN, OR PLUG BACK

1a. Type of Work

DRILL ☒

DEEPEN ☐

PLUG BACK ☐

b. Type of Well

OIL WELL ☒

GAS WELL ☐

OTHER

SINGLE ZONE ☐

MULTIPLE ZONE ☐

2. Name of Operator

Fred. Pool Drilling, Inc.

3. Address of Operator

P.O. Box 1393, Roswell, N.M. 88201

4. Location of Well

UNIT LETTER D LOCATED 990 FEET FROM THE North LINE

AND 990 FEET FROM THE West LINE OF SEC. 1 TWP. 19S RGE. 29E NMPM

7. Unit Agreement Name

8. Farm or Lease Name

PJ State "A"

9. Well No.

1

10. Field and Pool or Wildcat

Turkey Track - S-28-6-514
Artesia Oil Pool

12. County

Eddy

19. Proposed Depth

3500'

19A. Formation

San Andres

20. Rotary or C.T.

Rotary

21. Elevations (show whether DF, RT, etc.)

3420'

21A. Kind & Status Plug. Bond

Blanket

21B. Drilling Contractor

L & M

22. Approx. Date Work will start

Oct. 5, 1986

23.

PROPOSED CASING AND CEMENT PROGRAM

| SIZE OF HOLE | SIZE OF CASING | WEIGHT PER FOOT | SETTING DEPTH | SACKS OF CEMENT | EST. TOP |
|--------------|----------------|-----------------|---------------|-----------------|----------|
| 12 1/4" | 8 /58 | 24# | approx. 350' | 300 sx | - |
| 7 7/8 | 5 1/2 | 15.5# | approx. 3500' | 600 sx | - |

L & M Drilling Company Rig #2 with a 10" Space Saver
Blowout Preventer will be used.

APPROVAL VALID FOR 180 DAYS
PERMIT EXPIRES 3-24-87
UNLESS DRILLING UNDERWAY

IN ABOVE SPACE DESCRIBE PROPOSED PROGRAM; IF PROPOSAL IS TO DEEPEN OR PLUG BACK, GIVE DATA ON PRESENT PRODUCTIVE ZONE AND PROPOSED NEW PRODUCTIVE ZONE. GIVE BLOWOUT PREVENTER PROGRAM, IF ANY.

I hereby certify that the information above is true and complete to the best of my knowledge and belief.

Signed [Signature] Title President Date Sept. 23, 1986

(This space for State Use)

Original Signed By
Mike Williams

Oil & Gas Inspector

SEP 24 1986

APPROVED BY _____ DATE _____

CONDITIONS OF APPROVAL, IF ANY:

**NEW MEXICO OIL CONSERVATION COMMISSION
WELL LOCATION AND ACREAGE DEDICATION PLAT**

Form C-102
Supersedes C-124
Effective 1-1-65

All distances must be from the outer boundaries of the Section.

| | | | | | |
|--|--|---|----------------------------|---------------------------------------|----------------------|
| Operator FRED POOL DRILLING INC. | | | Lease PJ State A | | Well No. 1 |
| Unit Letter D | Section 1 | Township 19 South | Range 29 East | County Eddy | |
| Actual Footage Location of Well: <div style="display: flex; justify-content: space-between;"> 990 feet from the North line and 990 feet from the West line </div> | | | | | |
| Ground Level Elev. 3420. | Producing Formation San Andres | Pool Turkey Track - San O-G, or Artesia Oil Pool | | Dedicated Acreage: 40 Acres | |

1. Outline the acreage dedicated to the subject well by colored pencil or hatchure marks on the plat below.
2. If more than one lease is dedicated to the well, outline each and identify the ownership thereof (both as to working interest and royalty).
3. If more than one lease of different ownership is dedicated to the well, have the interests of all owners been consolidated by communitization, unitization, force-pooling, etc?

☐ Yes ☐ No If answer is "yes," type of consolidation _____

If answer is "no," list the owners and tract descriptions which have actually been consolidated. (Use reverse side of this form if necessary.) _____

No allowable will be assigned to the well until all interests have been consolidated (by communitization, unitization, forced-pooling, or otherwise) or until a non-standard unit, eliminating such interests, has been approved by the Commission.

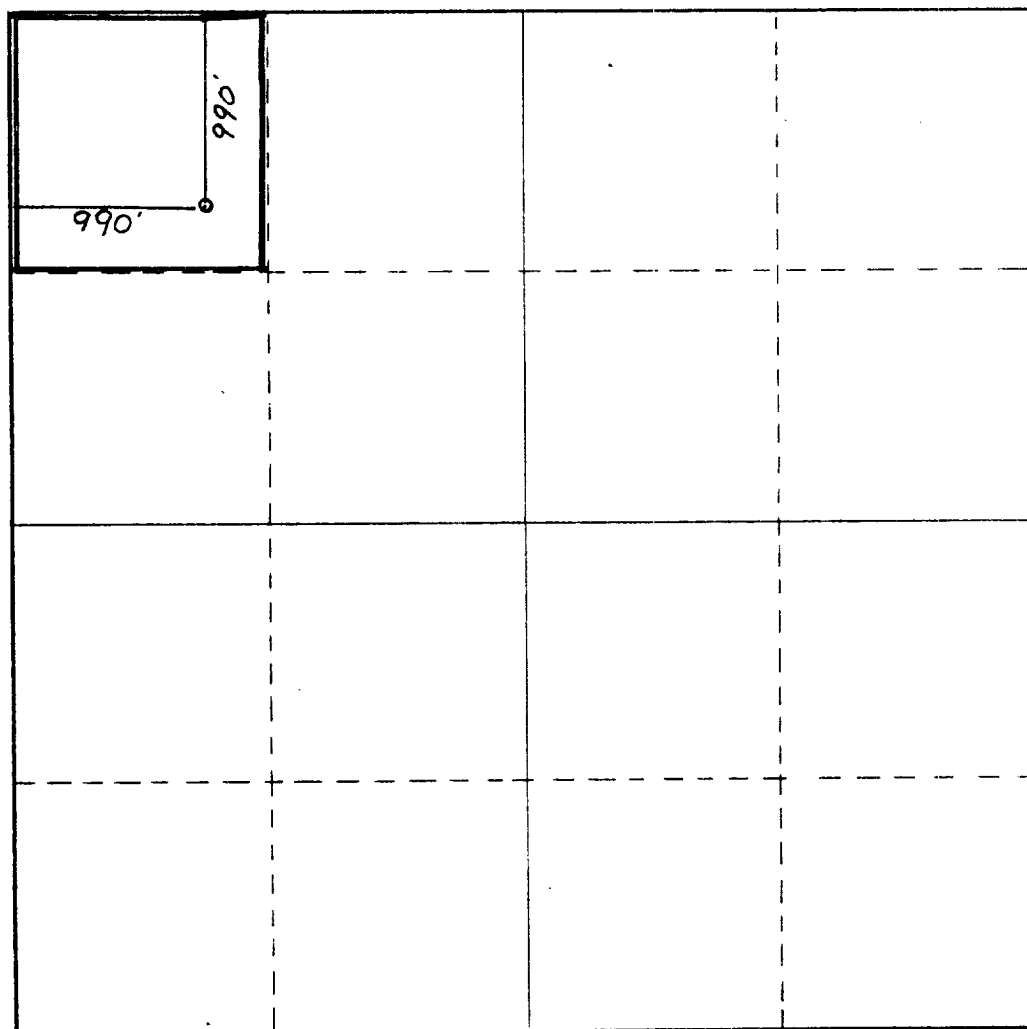

CERTIFICATION

I hereby certify that the information contained herein is true and complete to the best of my knowledge and belief.

Fred Pool, Jr.

Name _____
 Position **President**
 Company **Fred Pool Drilling Inc**

Date **September 23, 1986**
[Signature]

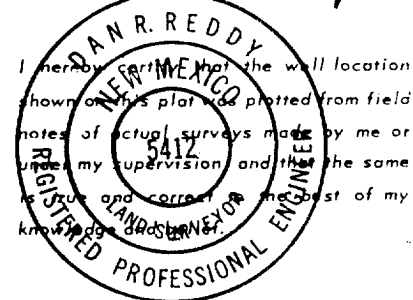

Date Surveyed
September 16, 1986
 Registered Professional Engineer
 and/or Land Surveyor

[Signature: Dan R. Reddy]
 Certificate No. _____
NM PE&LS NO. 5412

0 330 660 990 1320 1650 1980 2310 2640 2000 1500 1000 500 0