

NO. OF COPIES RECEIVED	
DISTRIBUTION	
SANTA FE	<input checked="" type="checkbox"/>
FILE	<input checked="" type="checkbox"/>
U.S.G.S.	<input checked="" type="checkbox"/>
LAND OFFICE	<input checked="" type="checkbox"/>
OPERATOR	<input checked="" type="checkbox"/>

RECEIVED BY

NOV -7 1986

5A. Indicate Type of Lease
STATE ☒ FEE ☐
5. State Oil & Gas Lease No.
V-1576 V-1776

APPLICATION FOR PERMIT TO DRILL, DEEPEN, OR PLUG BACK

1a. Type of Work
b. Type of Well DRILL ☒ DEEPEN ☐ PLUG BACK ☐
OIL WELL ☐ GAS WELL ☒ OTHER ☐ SINGLE ZONE ☐ MULTIPLE ZONE ☐
2. Name of Operator
Santa Fe Energy Operating Partners, L.P.
3. Address of Operator
500 W. Illinois, Suite 500, Midland, TX 79701
4. Location of Well UNIT LETTER F LOCATED 1980 FEET FROM THE West LINE
AND 1980 FEET FROM THE North LINE OF SEC. 36 TWP. 19S RGE. 29E NMPM
12. County
Eddy
19. Proposed Depth
12,100'
19A. Formation
Morrow
20. Rotary or C.T.
Rotary
21. Elevations (Show whether DF, RT, etc.)
3332.2' GL
21A. Kind & Status Plug. Bond
Blanket - current
21B. Drilling Contractor
To be determined
22. Approx. Date Work will start
As soon as possible

23.

PROPOSED CASING AND CEMENT PROGRAM

SIZE OF HOLE	SIZE OF CASING	WEIGHT PER FOOT	SETTING DEPTH	SACKS OF CEMENT	EST. TOP
17 1/2	13 3/8	48.0	350'	370'	Surface
12 1/4	8 5/8	32.0	3250'	1500'	Surface
7 7/8	5 1/2	17.0 & 20.0	12100'	600'	8000'

Move on location & rig up. Drill 17 1/2" hole to 350'. Run 13 3/8" casing and cement with 488 cu.ft. Class C cement containing 2% CaCl₂. Wait on cement until 500 psi compressive strength is obtained. Nipple up diverter system consisting of 1 bag type preventer and rotating head. Test casing to 600 psi. Drill 12 1/4" hole to 3250'. Run 8 5/8" casing. Cement with 2200 cu.ft. 65/35 Class C poz containing 0.25% per sk flocele followed by 396 cu.ft. Class C containing 2% CaCl₂. Wait on cement until 500 psi compressive strength obtained. Nipple up 5000 psi double ram BOP with hydrill. Test casing to 1500 psi. Drill 7 7/8" hole to 12,100'. Either plug and abandon or run 5 1/2" casing and cement with sufficient Class H to cover possible producing zones.

APPROVAL VALID FOR 180 DAYS
PERMIT EXPIRES 5/12/87
UNLESS DRILLING UNDERWAY

IN ABOVE SPACE DESCRIBE PROPOSED PROGRAM; IF PROPOSAL IS TO DEEPEN OR PLUG BACK, GIVE DATA ON PRESENT PRODUCTIVE ZONE AND PROPOSED NEW PRODU-
TIVE ZONE. GIVE BLOWOUT PREVENTER PROGRAM, IF ANY.

I hereby certify that the information above is true and complete to the best of my knowledge and belief.

Signed Michael R. Bruton Title Senior Drilling Engineer Date 11-5-86

(This space for State Use)

APPROVED BY Daniel Moore TITLE Biologist DATE 11/12/86

CONDITIONS OF APPROVAL, IF ANY:

Notify N.M.O.C.C. in sufficient
time to witness cementing
the 8 5/8" casing

NE MEXICO OIL CONSERVATION COMMISSIC
WELL LOCATION AND ACREAGE DEDICATION PLAT

Form C-102
Supersedes C-128
Effective 1-1-65

All distances must be from the outer boundaries of the Section.

Operator Santa Fe Energy Operating Partners L.P.			Lease Parkway State 36 <u>State</u>		Well No. 1
Unit Letter F	Section 36	Township 19 South	Range 29 East	County Eddy	
Actual Footage Location of Well: 1980 feet from the North line and 1980 feet from the West line					
Ground Level Elev. 3332.2	Producing Formation Morrow	Pool Undes. Morrow		Dedicated Acreage: 320 Acres	

1. Outline the acreage dedicated to the subject well by colored pencil or hachure marks on the plat below.
2. If more than one lease is dedicated to the well, outline each and identify the ownership thereof (both as to working interest and royalty).
3. If more than one lease of different ownership is dedicated to the well, have the interests of all owners been consolidated by communitization, unitization, forced-pooling, or otherwise?

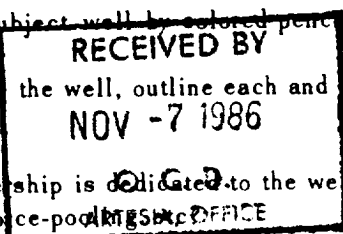

☒ Yes ☐ No If answer is "yes," type of consolidation Communitization

If answer is "no," list the owners and tract descriptions which have actually been consolidated. (Use reverse side of this form if necessary.)

No allowable will be assigned to the well until all interests have been consolidated (by communitization, unitization, forced-pooling, or otherwise) or until a non-standard unit, eliminating such interests, has been approved by the Commission.

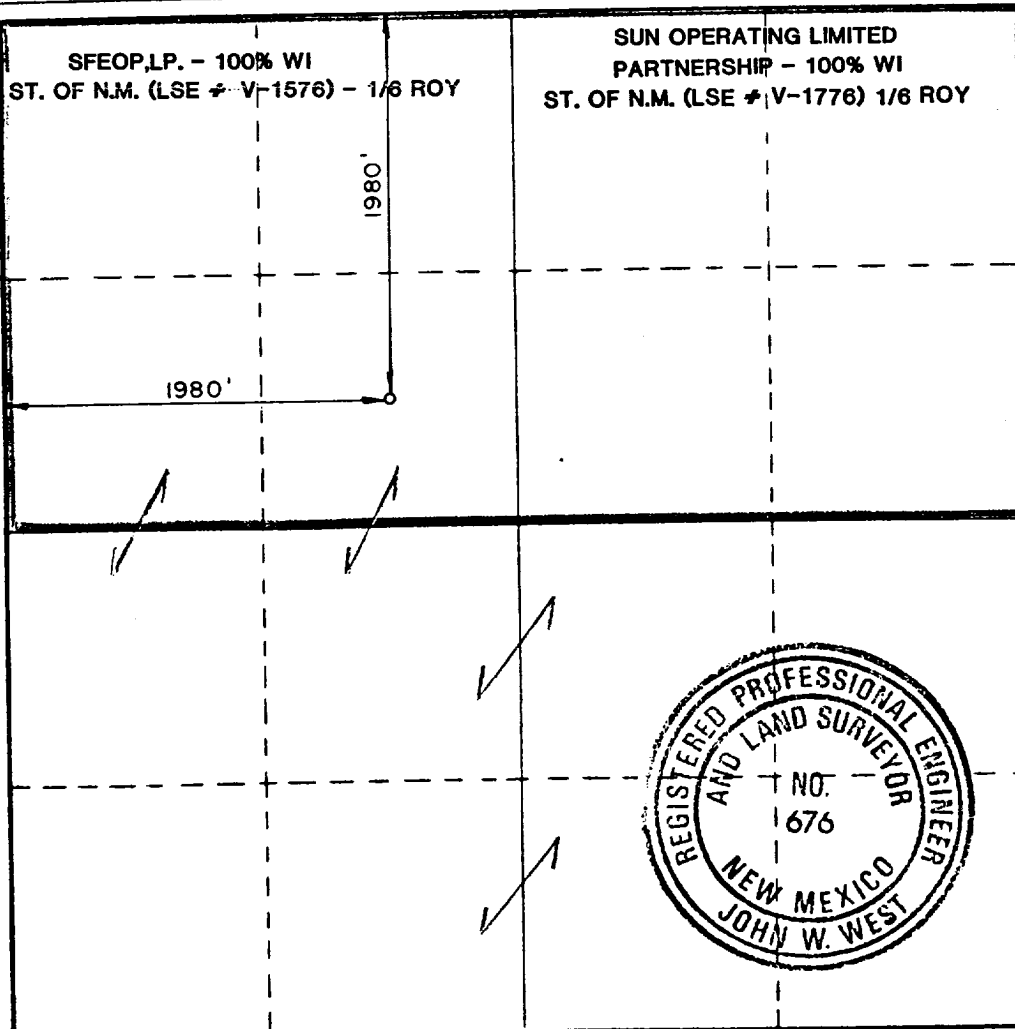

CERTIFICATION

I hereby certify that the information contained herein is true and complete to the best of my knowledge and belief.

Name
Michael R. Buttrick
Position
Senior Drilling Engineer
Company
Santa Fe Energy Operating Partners, L.P.
Date
November 6, 1986

I hereby certify that the well location shown on this plat was plotted from field notes of actual surveys made by me or under my supervision, and that the same is true and correct to the best of my knowledge and belief.

Date Surveyed
October 15, 1986
Registered Professional Engineer and/or Land Surveyor
John W. West

Certificate No. JOHN W. WEST, 676
RONALD J. EIDSON, 3239