

30-015-25728

Form 3160-3  
(November 1983)  
(formerly 9-331C)SUBMIT IN TRIPLICATE\*  
(Other instructions on  
reverse side)Form approved.  
Budget Bureau No. 1004-0136  
Expires August 31, 1985UNITED STATES  
DEPARTMENT OF THE INTERIOR  
BUREAU OF LAND MANAGEMENT

## APPLICATION FOR PERMIT TO DRILL, DEEPEN, OR PLUG BACK

1a. TYPE OF WORK <b>DRILL</b> <input checked="" type="checkbox"/> <b>DEEPEN</b> <input type="checkbox"/> <b>PLUG BACK</b> <input type="checkbox"/>		5. LEASE DESIGNATION AND SERIAL NO. LC-029389-a	
b. TYPE OF WELL OIL WELL <input checked="" type="checkbox"/> GAS WELL <input type="checkbox"/> OTHER <input type="checkbox"/>		6. IF INDIAN, ALLOTTEE OR TRIBE NAME	
2. NAME OF OPERATOR ARCO Oil and Gas Co. /		7. UNIT AGREEMENT NAME	
3. ADDRESS OF OPERATOR P.O. Box 1610, Midland, TX 79702		8. FARM OR LEASE NAME Baish Federal	
4. LOCATION OF WELL (Report location clearly and in accordance with any State requirements.) At surface 660' FNL & 1980' FEL (Unit letter B) ARTESIA, OFFICE		9. WELL NO. #2	
14. DISTANCE IN MILES AND DIRECTION FROM NEAREST TOWN OR POST OFFICE* 8 miles Southeast of Loco Hills, New Mexico		10. FIELD AND POOL, OR WILDCAT N. Shugart (Bone Springs)	
15. DISTANCE FROM PROPOSED* LOCATION TO NEAREST PROPERTY OR LEASE LINE, FT. (Also to nearest drg. unit line, if any) 660' FNL		11. SEC., T., R., N., OR S.E. AND SURVEY OR AREA Sec. 9-18S-31E	
16. NO. OF ACRES IN LEASE 440		12. COUNTY OR PARISH Eddy	
17. NO. OF ACRES ASSIGNED TO THIS WELL 40		13. STATE NM	
18. PROPOSED DEPTH 8900'		19. ROTARY OR CABLE TOOLS Rotary	
20. APPROX. DATE WORK WILL START* ASAP		21. ELEVATIONS (Show whether DP, RT, GR, etc.) GR 3717.4'	

23. PROPOSED CASING AND CEMENTING PROGRAM				
SIZE OF HOLE	SIZE OF CASING	WEIGHT PER FOOT	SETTING DEPTH	QUANTITY OF CEMENT
17-1/2"	13-3/8"	54.5# K-55	680'	650 sx Circ
11"	8-5/8"	24# K-55	2150'	800 sx Circ
7-7/8"	5-1/2"	17# K-55	8900'	1700 sx TOC @ 1500'
		17# N-80		

Propose to drill a North Shugart (Bone Springs) development well and test for commercial production.

Blowout preventor program attached.

IN ABOVE SPACE DESCRIBE PROPOSED PROGRAM: If proposal is to deepen or plug back, give data on present productive zone and proposed new productive zone. If proposal is to drill or deepen directionally, give pertinent data on subsurface locations and measured and true vertical depths. Give blowout preventor program, if any.

24. SIGNED Sam Day TITLE Drilling Engineer DATE 2-5-87  
(This space for Federal or State office use)

PERMIT NO. Orig. Sub. Under 100' APPROVAL DATE 2-17-87  
APPROVED BY John A. [illegible] TITLE \_\_\_\_\_ DATE 2-17-87  
CONDITIONS OF APPROVAL, IF ANY:

\*See Instructions On Reverse Side

Title 18 U.S.C. Section 1001 makes it a crime for any person knowingly and willfully to make to any department or agency of the United States any false, fictitious or fraudulent statements or representations or to knowingly submit any false information.

NEW MEXICO OIL CONSERVATION COMMISSION  
WELL LOCATION AND ACREAGE DEDICATION PLAT

Form O-128  
Supersedes O-128  
Effective 1-1-65

All distances must be from the outer boundaries of the Section.

ARCO OIL AND GAS COMPANY ✓			Lease BALSH FEDERAL		Well No. 2
Section B	Section 1	Township 18 SOUTH	Range 31 EAST	County EDDY	
Direction of Well					
180°		feet from the NORTH line and	1980	feet from the EAST line	
Producing Formations	Bone Springs			Producing Formation	North Shugart - ES
Estimated Acreage	40 Acres				

- Outline the acreage dedicated to the subject well by colored pencil or hachure marks on the plat below.
- If more than one lease is dedicated to the well, outline each and identify the ownership thereof (both as to working interest and royalty).
- If more than one lease of different ownership is dedicated to the well, have the interests of all owners been consolidated by communitization, unitization, force-pooling, etc?

Yes ☐ No ☐ If answer is "yes," type of consolidation

If answer is "no," list the owners and tract descriptions which have been consolidated (Use reverse side of this form if necessary.)

No allowable will be assigned to the well until all interests have been consolidated by communitization, unitization, force-pooling, or otherwise or until a non-standard unit, eliminating such interests, has been approved by the Commission.

RECEIVED BY

FEB 19 1987

O. C. B.  
ARTESIA, OFFICE

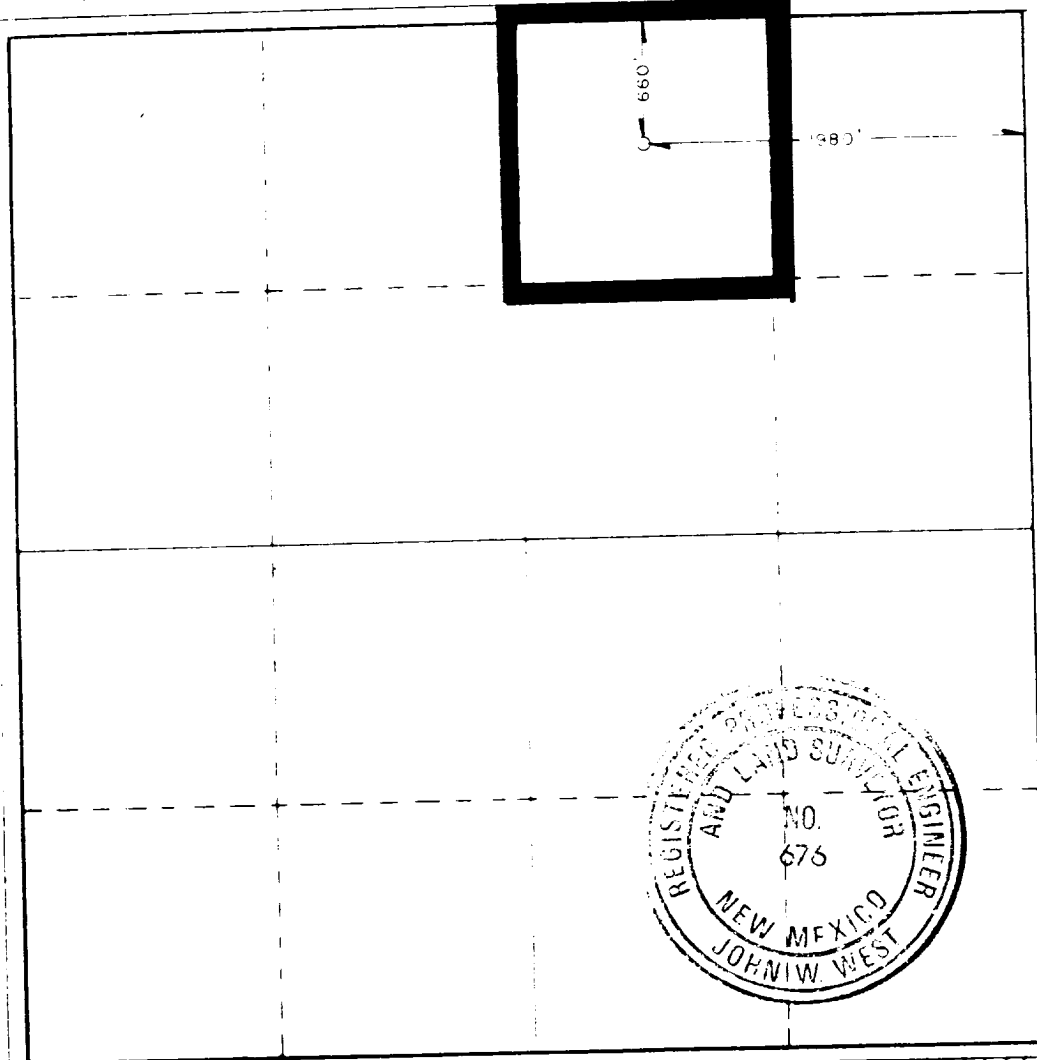

CERTIFICATION

I hereby certify that the information contained herein is true and complete to the best of my knowledge and belief.

*Ernest Ray*

Drilling Engineer

ARCO Oil and Gas Co.

2-5-87

I hereby certify that the well location shown on this plat was plotted from field notes of actual surveys made by me or under my supervision, and that the same is true and correct to the best of my knowledge and belief.

Date Surveyed  
JANUARY 24, 1986

Registered Professional Engineer  
and Land Surveyor

*John W. West*

Certificate No. JOHN W. WEST, 676  
RONALD J. EIDSON, 3239

ARCO Oil & Gas  
3000 psi WP BOP Stack  
SR<sub>0</sub>A

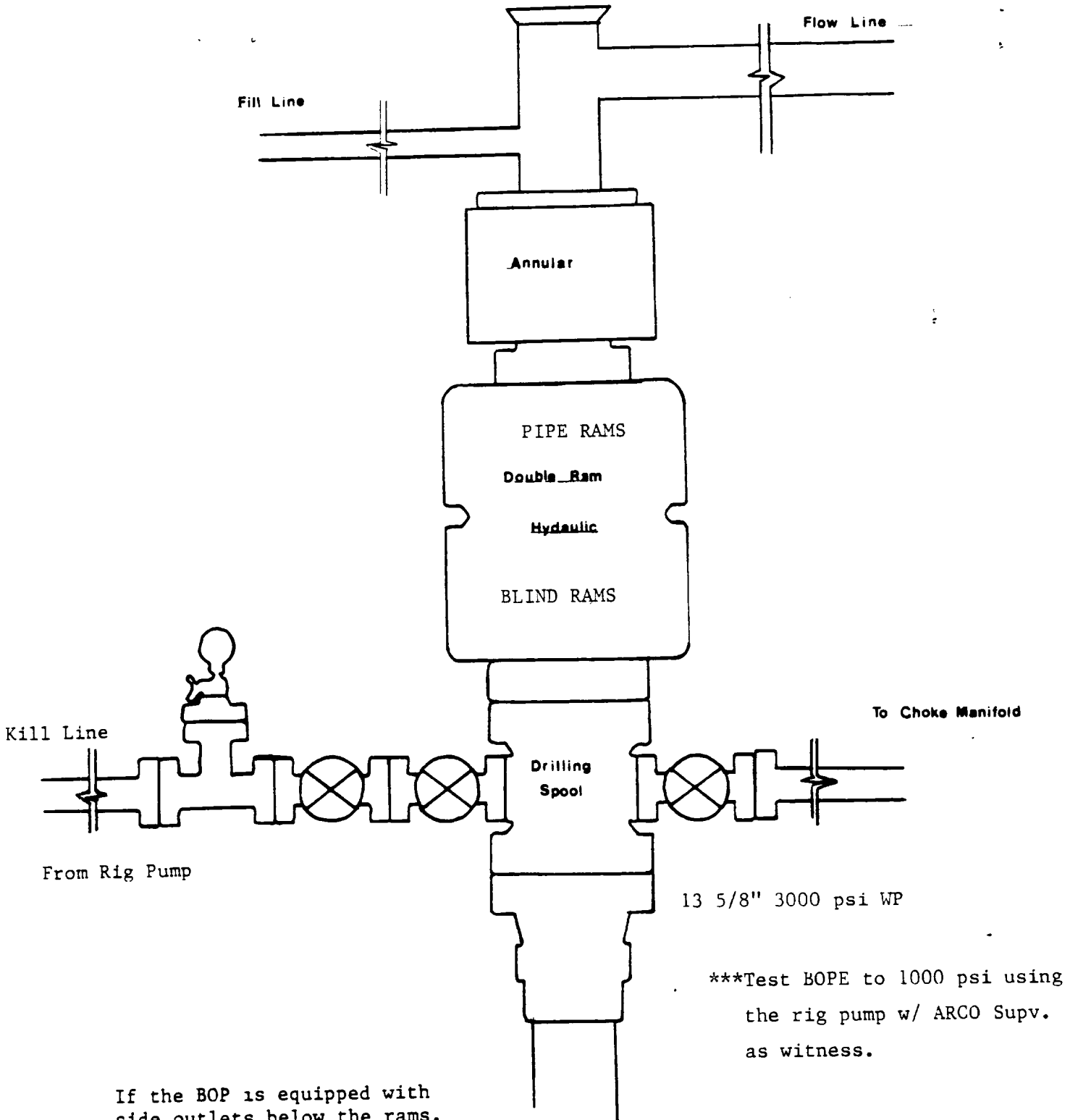

If the BOP is equipped with side outlets below the rams, a spool is not required.

ARCO Oil & Gas  
3000psi WP Choke Manifold

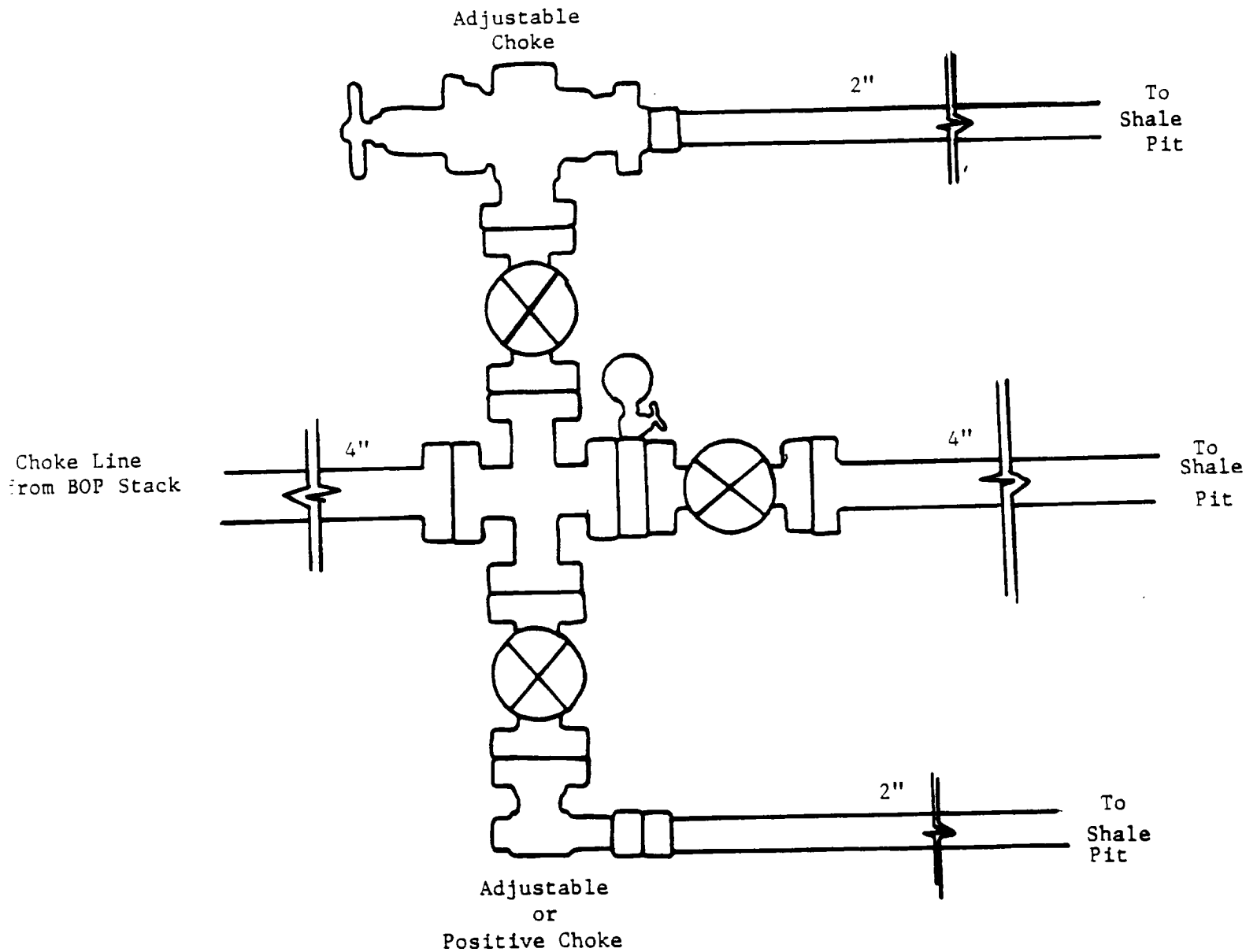

ARCO Oil & Gas  
5000 psi WP BOP Stack  
SR<sub>g</sub> A

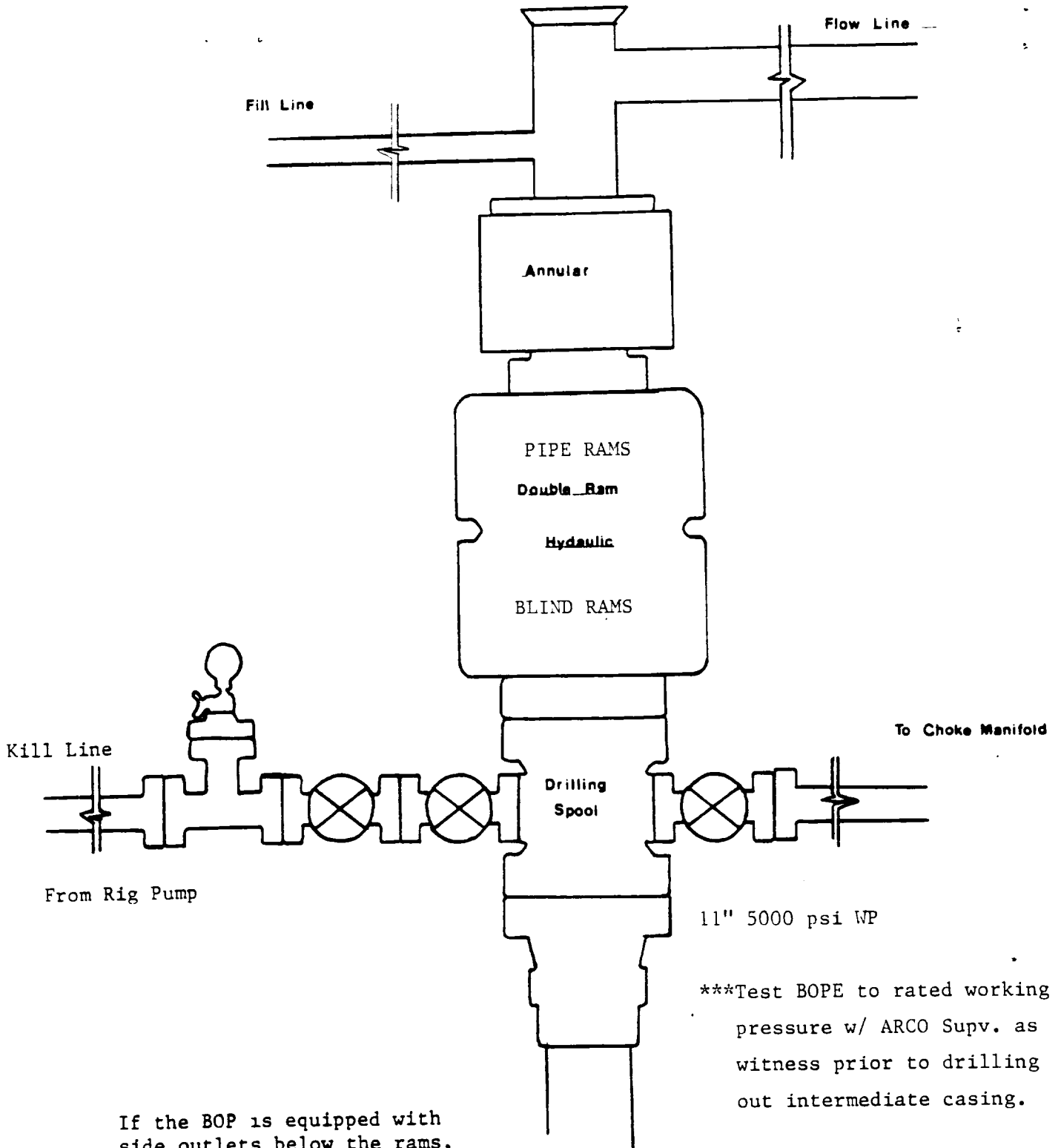

If the BOP is equipped with side outlets below the rams, a spool is not required.

ARCO Oil & Gas  
5000psi WP Choke Manifold

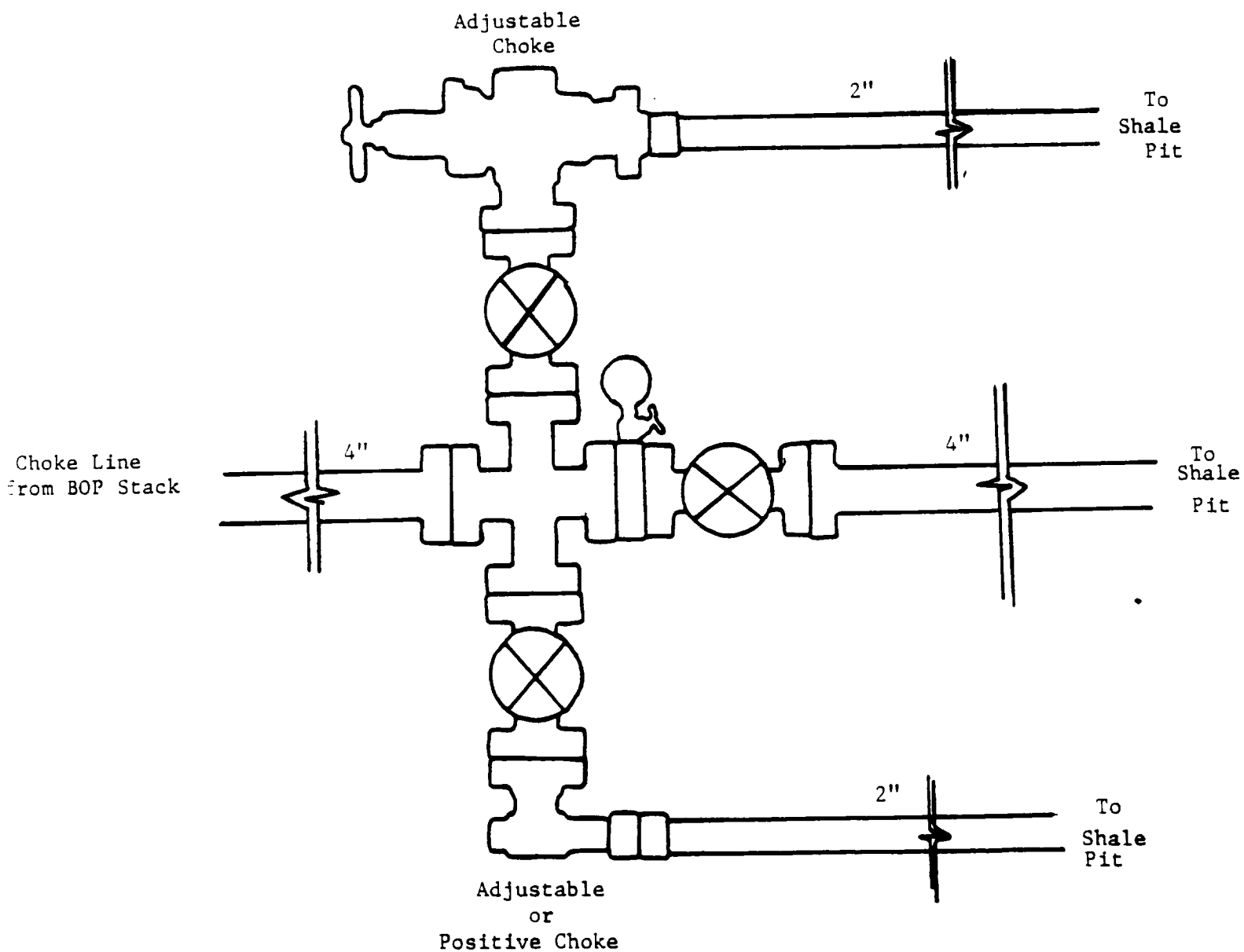

To supplement USGS Form 3160-3 " Application for Permit to Drill, Deepen or Plugback", the following additional information is submitted to comply with USGS Order NTL-6.

Operator: ARCO Oil and Gas Company

Lease & Well No: Baish Federal #2

Location: Unit Letter B  
Section 9, T-18-S, R-31-E  
Eddy County, New Mexico

Lease, New Mexico LC - 029389-a

Development well X Exploratory well \_\_\_\_\_

1. See Well Location and Acreage Dedication Plat Form C-102.
2. See Form 3160-3 for elevation above sea level of unprepared location.
3. The geologic name of the surface formation is: Querecho Plains Aeolian material with loose sandy loams and commonly harbor calcareous gravels.
4. The type of drilling tools and associated equipment to be utilized will be: Rotary
5. The proposed drilling depth will be 8900'.
6. The estimated tops of important geologic markers are:

TOS	690'	Queen	3170'
BOS	2000'	San Andres	4200'
Yates	2100'	Bone Springs	5500'
7. The estimated depths at which anticipated water, oil, gas or other mineral bearing formations are expected to be encountered are:

Bone Springs Sand 7900' Oil
8. The proposed casing program including the size, grade and weight-per-foot of each string has been indicated on Form 3160-3. All strings of casing will be: New X Used \_\_\_\_\_.
9. See Form 3160-3 for amount of cement.

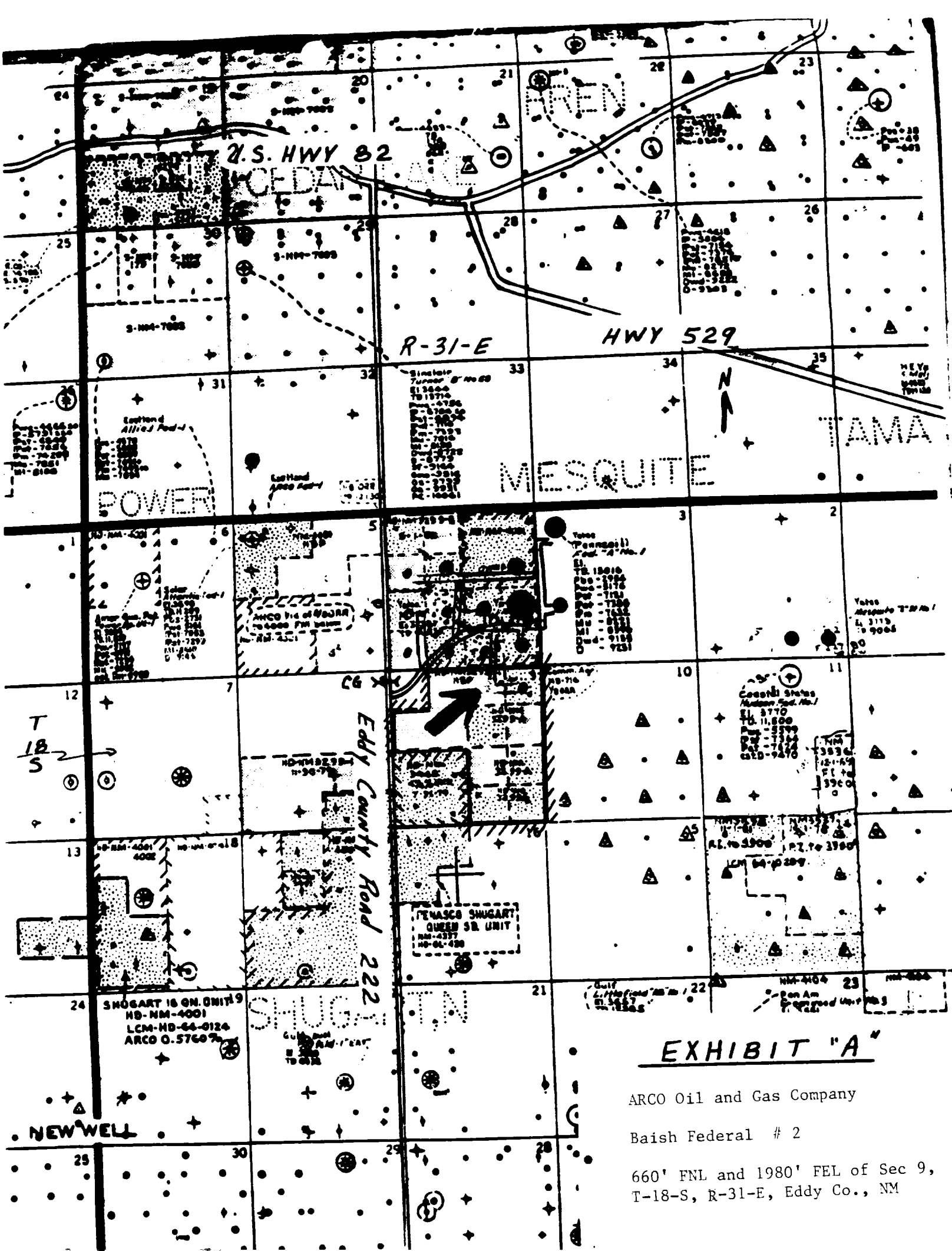

## EXHIBIT "A"

ARCO Oil and Gas Company

Baish Federal # 2

660' FNL and 1980' FEL of Sec 9,  
T-18-S, R-31-E, Eddy Co., NM



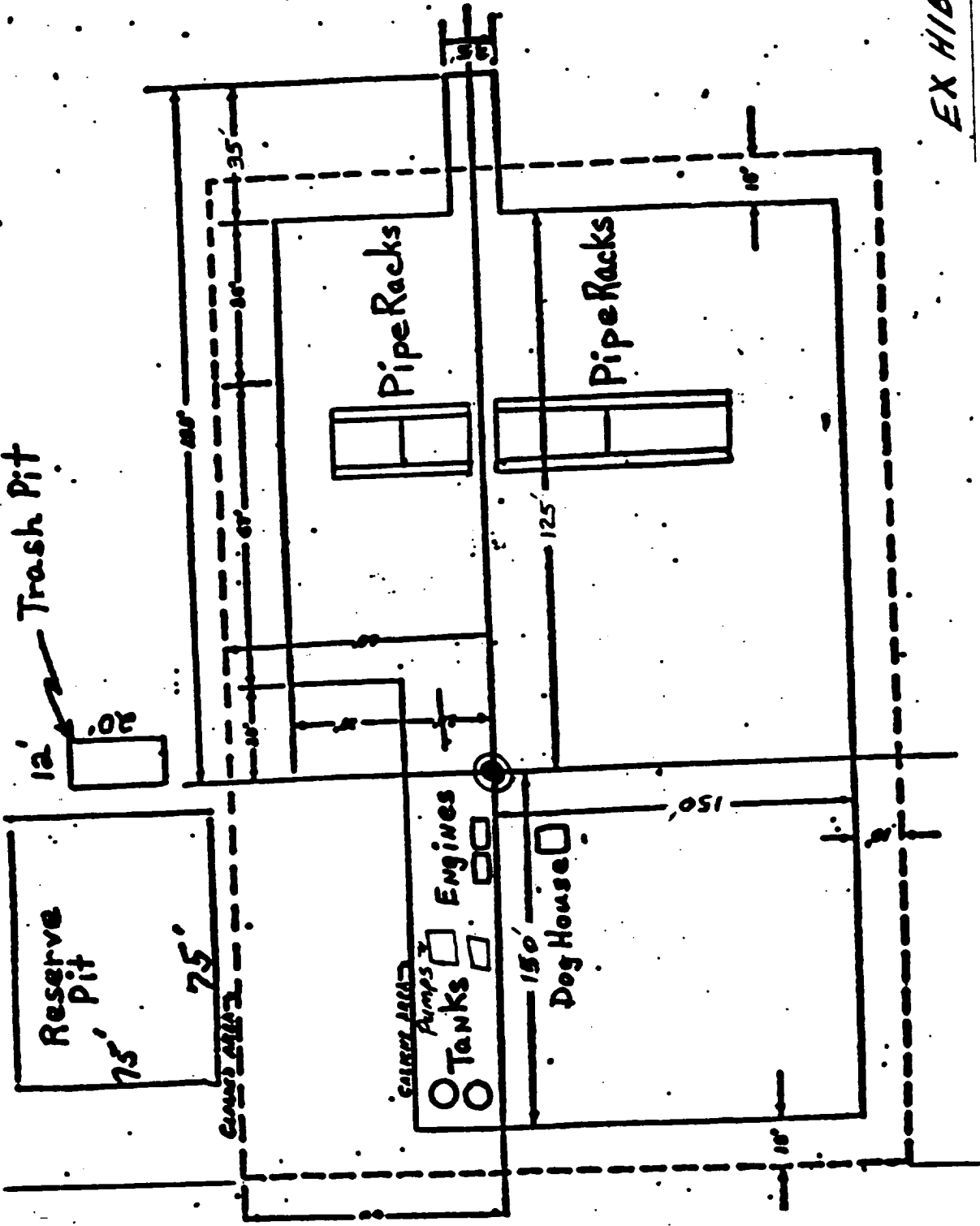

# EXHIBIT "D"

ARCO Oil and Gas Company  
 Baish Federal # 2  
 660' FNL & 198Q' FEL of sec. 9,  
 T-18-S, R-31-E, Eddy Co., NM