

**MEXICO OIL CONSERVATION COMMISSION  
WELL LOCATION AND ACREAGE DEDICATION PLAT**

Form C-102  
Supersedes C-128  
Effective 1-1-65

All distances must be from the outer boundaries of the Section.

Operator <b>Yates Petroleum Corporation</b>			Lease <b>Dagger ZW</b>		Well No. <b>1</b>
Unit Letter <b>K</b>	Section <b>30</b>	Township <b>19S</b>	Range <b>25E</b>	County <b>Eddy</b>	
Actual Footage Location of Well: <b>1980'</b> <b>South</b> line and <b>1980</b> <b>West</b> line					
Ground Level Elev. <b>3564 GL</b>	Producing Formation <b>CISCO-CANYON</b>		Pool <b>UNDES North Dagger Draw Upper Penn</b>		Dedicated Acreage: <b>160</b> Acres

- Outline the acreage dedicated to the subject well by colored pencil or hachure marks on the plat below.
- If more than one lease is dedicated to the well, outline and identify the ownership thereof (both as to working interest and royalty).
- If more than one lease of different ownership is dedicated to the well, have the interests of all owners been consolidated by communitization, unitization, force-pooling, etc?  
☐ Yes    ☒ No    If answer is "yes," type of consolidation:

**RECEIVED BY**  
**AUG 11 1987**  
**O. C. D.**  
**ARTESIA, OFFICE**

If answer is "no," list the owners and tract descriptions which have actually been consolidated. (Use reverse side of this form if necessary.)

No allowable will be assigned to the well until all interests have been consolidated (by communitization, unitization, forced-pooling, or otherwise) or until a non-standard unit, eliminating such interests, has been approved by the Commission.

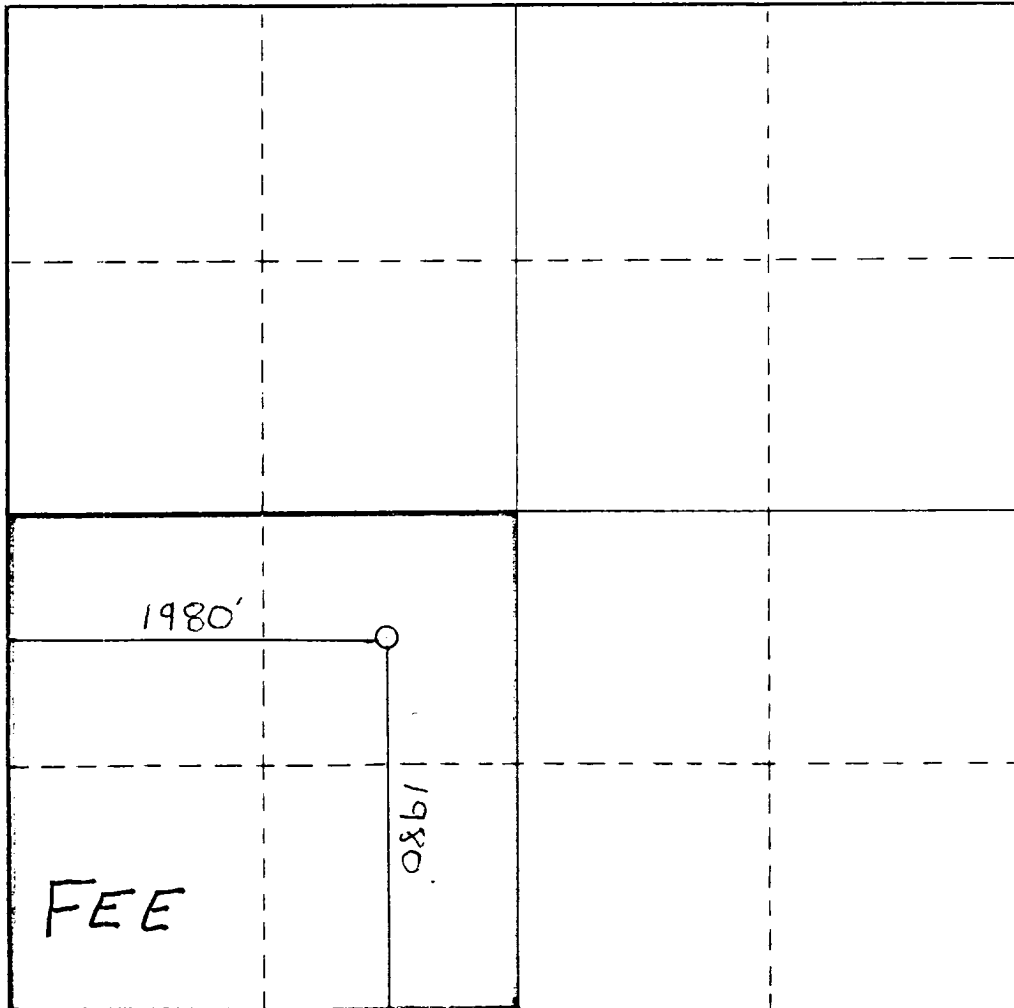

**CERTIFICATION**

I hereby certify that the information contained herein is true and complete to the best of my knowledge and belief.

**Clifton R. May**

Name  
**Clifton R. May**

Position  
**Regulatory Agent**

Company  
**Yates Petroleum Corporation**

Date  
**August 11, 1987**

Date Surveyed  
**August 10, 1987**

Registered Professional Engineer  
and/or Land Surveyor

**Dan R. Reddy**  
Certificate No.  
**NM PE&LS NO. 5412**

0 330 660 990 1320 1650 1980 2310 2640 2000 1500 1000 500 0