

APR 12 '88

O. C. D.  
ARTESIA, OFFICE

30-015-25905  
Form C-101  
Revised 10-1-78

NO. OF COPIES RECEIVED	
DISTRIBUTION	
SANTA FE	<input checked="" type="checkbox"/>
FILE	<input checked="" type="checkbox"/>
U.S.G.S.	<input checked="" type="checkbox"/>
LAND OFFICE	<input checked="" type="checkbox"/>
OPERATOR	<input checked="" type="checkbox"/>

5A. Indicate Type of Lease  
STATE ☐ FEE ☒  
5. State Oil & Gas Lease No.

APPLICATION FOR PERMIT TO DRILL, DEEPEN, OR PLUG BACK

1a. Type of Work b. Type of Well OIL WELL <input checked="" type="checkbox"/> GAS WELL <input type="checkbox"/> OTHER <input type="checkbox"/> SINGLE ZONE <input type="checkbox"/> MULTIPLE ZONE <input type="checkbox"/>		7. Unit Agreement Name	
2. Name of Operator Yates Petroleum Corporation		8. Farm or Lease Name Roy AET	
3. Address of Operator 105 South Fourth Street - Artesia, NM 88210		9. Well No. 1	
4. Location of Well UNIT LETTER N LOCATED 660 FEET FROM THE South LINE AND 1980 FEET FROM THE West LINE OF SEC. 8 TWP. 19S RGE. 25E NMPM		10. Field and Pool, or Wildcat Und. N. Dagger Draw Upper Penn	
11. Elevations (show whether DF, KT, etc.) 3559.0' GR		12. County Eddy	
21A. Kind & Status Plug. Bond Blanket		19. Proposed Depth 8100'	
21B. Drilling Contractor Moranco Drilling		19A. Formation Cisco Canyon	
22. Approx. Date Work will start ASAP		20. Rotary or C.T. ASAP	

PROPOSED CASING AND CEMENT PROGRAM

SIZE OF HOLE	SIZE OF CASING	WEIGHT PER FOOT	SETTING DEPTH	SACKS OF CEMENT	EST. TOP
14-3/4"	9-5/8"	36# J-55	Approx. 1150'	950 sacks	Circulate
8-3/4"	7"	20# & 23# S-95 and N-80	TD	400 sacks	

We propose to drill and test the Cisco Canyon and intermediate formations. Approximately 1150' of surface casing will be set and cement circulated to shut off gravel and cavings. If commercial, production casing will be ran and cemented with adequate cover, perforated and stimulated as needed for production.

MUD PROGRAM: FW gel/LCM to 1150', cut brine to 7500', starch/driskpak to TD

BOP PROGRAM: BOP's will be installed on 9-5/8" casing and tested daily

POST 10-1  
NL & API  
4-15-88  
180  
10/13/88  
UNDERWAY

IN ABOVE SPACE DESCRIBE PROPOSED PROGRAM; IF PROPOSAL IS TO DEEEN OR PLUG BACK, GIVE DATA ON PRESENT PRODUCTIVE ZONE AND PROPOSED NEW PRODUCTIVE ZONE. GIVE BLOWOUT PREVENTER PROGRAM, IF ANY.

I hereby certify that the information above is true and complete to the best of my knowledge and belief.

Signed Cy Cowan Title Permit Agent Date April 12, 1988

(This space for State Use)  
Original Signed By  
Mike Williams  
APPROVED BY Oil & Gas Inspector TITLE DATE APR 13 1988

CONDITIONS OF APPROVAL, IF ANY:

Notify HILCO of completion

9 5/8 casing

**NEW MEXICO OIL CONSERVATION COMMISSION  
WELL LOCATION AND ACREAGE DEDICATION PLAT**

Form C-102  
Supersedes C-128  
Effective 1-1-65

All distances must be from the outer boundaries of the Section.

Operator <b>Yates Petroleum Corporation</b>				Lease <b>ROY "AET"</b>		Well No. <b>1</b>
Unit Letter <b>N</b>	Section <b>8</b>	Township <b>19 South</b>	Range <b>25 East</b>	County <b>Eddy</b>		
Actual Footage Location of Well: <b>1980</b> feet from the <b>West</b> line and <b>660</b> feet from the <b>South</b> line						
Ground Level Elev. <b>3559.0</b>	Producing Formation <b>CISCO CANYON</b>		Pool <b>UNDERS N. DAEGER DRAW UPPER PENN</b>		Dedicated Acreage: <b>160</b> Acres	

1. Outline the acreage dedicated to the subject well by colored pencil or hachure marks on the plat below.
2. If more than one lease is dedicated to the well, outline each and identify the ownership thereof (both as to working interest and royalty).
3. If more than one lease of different ownership is dedicated to the well, have the interests of all owners been consolidated by communitization, unitization, force-pooling, etc?  
☐ Yes    ☒ No    If answer is "yes," type of consolidation \_\_\_\_\_

If answer is "no," list the owners and tract descriptions which have actually been consolidated. (Use reverse side of this form if necessary.) \_\_\_\_\_

No allowable will be assigned to the well until all interests have been consolidated (by communitization, unitization, forced-pooling, or otherwise) or until a non-standard unit, eliminating such interests, has been approved by the Commission.

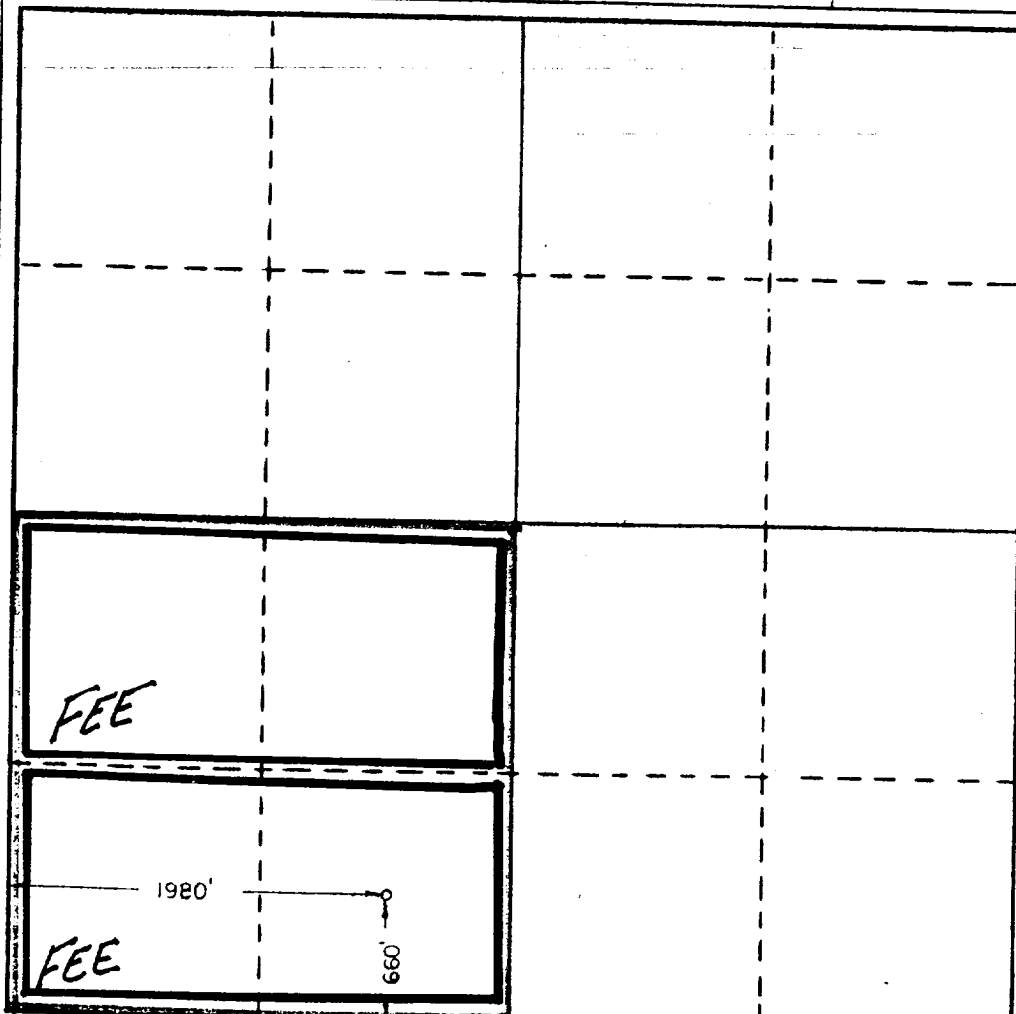

**CERTIFICATION**

I hereby certify that the information contained herein is true and complete to the best of my knowledge and belief.

*Cy Cowan*  
Name

Cy Cowan

Position

Permit Agent

Company

Yates Petroleum Corporation

Date

April 12, 1988

I hereby certify that the well location shown on this plat was plotted from field notes of actual surveys made by me or under my supervision, and that the same is true and correct to the best of my knowledge.

Date Signed

**HERSCHEL  
4/27/88 JONES**

Registered Professional Engineer  
and/or Land Surveyor

*[Signature]*  
Certificate No.

3640

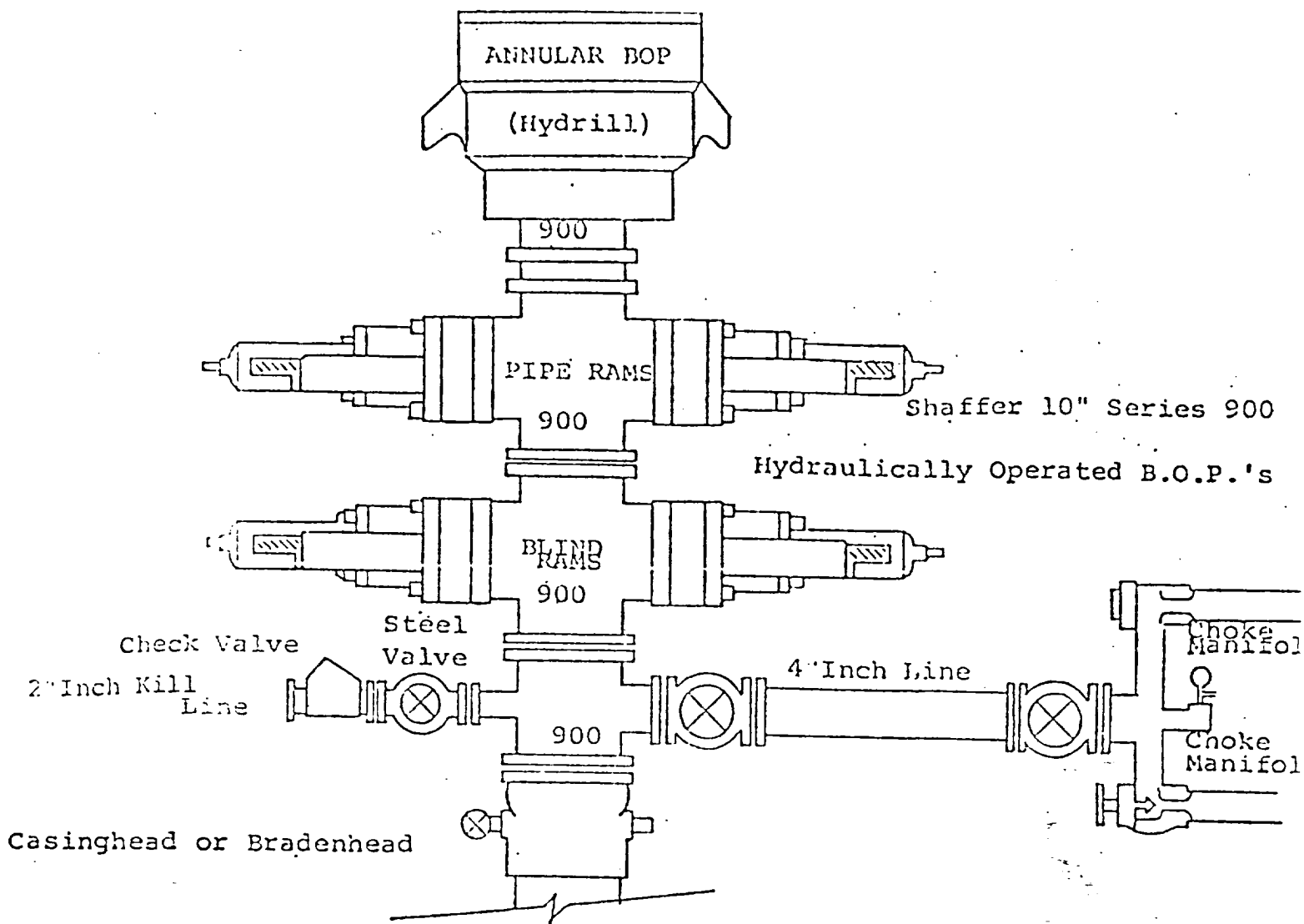

THE FOLLOWING CONSTITUTE MINIMUM BLOWOUT PREVENTER REQUIREMENTS

1. All preventers to be hydraulically operated with secondary manual control installed prior to drilling out from under casing.
2. Choke outlet to be a minimum of 2" diameter.
3. Kill line to be of all steel construction of 2" minimum diameter.
4. All connections from operating manifolds to preventers to be all steel. hole or tube a minimum of one inch in diameter.
5. The available closing pressure shall be at least 15% in excess of that required with sufficient volume to operate the B.O.P.'s.
6. All connections to and from preventer to have a pressure rating equivalent to that of the B.O.P.'s.
7. Inside blowout preventer to be available on rig floor.
8. Operating controls located a safe distance from the rig floor.
9. Hole must be kept filled on trips below intermediate casing.
10. D. P. float must be installed and used below zone of first gas intrusion