

NO. OF COPIES RECEIVED	
DISTRIBUTION	
SANTA FE	<input checked="" type="checkbox"/>
FILE	<input checked="" type="checkbox"/>
U.S.G.S.	<input checked="" type="checkbox"/>
LAND OFFICE	<input checked="" type="checkbox"/>
OPERATOR	<input checked="" type="checkbox"/>

NEW MEXICO OIL CONSERVATION COMMISSION

RECEIVED

30-015-25925  
Form C-101  
Revised 1-1-65

MAY 24 '88

O. C. D.  
SANTIA OFFICE

5A. Indicate Type of Lease STATE <input checked="" type="checkbox"/> FEE <input type="checkbox"/>
5. State Oil & Gas Lease No. V.B. - 0060
7. Unit Agreement Name
8. Farm or Lease Name Boyd State 26M
9. Well No. 1
10. Field and Pool, or Wildcat Wildcat MORROW
12. County Eddy
19. Proposed Depth 9900'
19A. Formation Morrow
20. Rotary or C.T. Rotary
21. Elevation (Show whether DT, RT, etc.) 3472 GR.
21A. Kind & Status Plug, Bond Blanket
21B. Drilling Contractor Peterson Drilling
22. Approx. Date Work will start 5-28-88

APPLICATION FOR PERMIT TO DRILL, DEEPEN, OR PLUG BACK

1a. Type of Work b. Type of Well OIL WELL <input type="checkbox"/> GAS WELL <input checked="" type="checkbox"/> OTHER <input type="checkbox"/> 2. Name of Operator Nearburg Producing Company 3. Address of Operator P.O. Box 31405, Dallas, TX 75231 4. Location of Well UNIT LETTER <u>M</u> LOCATED <u>1200</u> FEET FROM THE <u>South</u> LINE AND <u>750</u> FEET FROM THE <u>West</u> LINE OF SEC. <u>26</u> T4N. <u>19</u> R4E. <u>25E.</u> NMPM	5. Type of Well DRILL <input checked="" type="checkbox"/> DEEPEN <input type="checkbox"/> PLUG BACK <input type="checkbox"/> SINGLE ZONE <input checked="" type="checkbox"/> MULTIPLE ZONE <input type="checkbox"/>
--	---

PROPOSED CASING AND CEMENT PROGRAM

SIZE OF HOLE	SIZE OF CASING	WEIGHT PER FOOT	SETTING DEPTH	SACKS OF CEMENT	EST. TOP
* 17 1/2" & 12 1/4"	8 5/8	24	1350	1700	Circulate
7 7/8"	4 1/2	11.60	9900		

Not to be used in sufficient  
time to witness cementing  
the 13 3/8" + 8 5/8" casing

Propose to drill the well to evaluate the Morrow Formation. After reaching T.D., logs will be run and casing set if evaluation is positive. Perforate, test, and stimulate as necessary to establish production. B.O.P Program attached. Gas is not dedicated.

Unorthodox location case scheduled for June 8, 1988. Case 9405

\*We plan to drill a 17 1/2" hole to equal 350'. If hole conditions permit we will then drill a 12 1/4" hole from 350' - 1350' and run 8 5/8" casing and circulate cement. If hole conditions do not allow us to drill on from 350', we will run 13 3/8" to 350' and drill a 12 1/4" hole to 1350' and run and cement 8 5/8" casing. (O.K. per Mike Williams 5/23/88)

POST 10-1  
NLS  
5-24-PP

IN ABOVE SPACE DESCRIBE PROPOSED PROGRAM: IF PROPOSAL IS TO DEEPEN OR PLUG BACK, GIVE DATA ON PRESENT PRODUCTIVE ZONE AND PROPOSED NEW PRODUCTIVE ZONE. GIVE BLOWOUT PREVENTER PROGRAM, IF ANY.

I hereby certify that the information above is true and complete to the best of my knowledge and belief.

Signed T.R. McDonald Title Engineering Manager Date 5/23/88

(This space for State Use)

Original Signed By

APPROVED BY Mike Williams TITLE Inspector DATE MAY 26 1988  
CONDITIONS OF APPROVAL NSL Approval

NEW MEXICO OIL CONSERVATION COMMISSION  
WELL LOCATION AND ACREAGE DEDICATION PLAT

Form C-102  
Supersedes C-128  
Effective 1-1-65

All distances must be from the outer boundaries of the Section

Operator Nearburg Production Co.			Lease Boyd State 26 M		Well No. 1
Tract Letter M	Section 26	Township 19 South	Range 25 East	County Elddy	
Actual Footage Location of Well: 1200 feet from the south line and 750 feet from the West line					
Ground Level Elev. 3472.0	Producing Formation Morrow		Pool Wildcat Morrow	Dedicated Acreage 320.00 Acres	

1. Outline the acreage dedicated to the subject well by colored pencil or hatchure marks on the plat below.
2. If more than one lease is dedicated to the well, outline each and identify the ownership thereof (both as to working interest and royalty).
3. If more than one lease of different ownership is dedicated to the well, have the interests of all owners been consolidated by communitization, unitization, force-pooling, etc?

☒ Yes ☐ No If answer is "yes," type of consolidation Communitization

If answer is "no," list the owners and tract descriptions which have actually been consolidated (Use reverse side of this form if necessary.)

No allowable will be assigned to the well until all interests have been consolidated (by communitization, unitization, forced-pooling, or otherwise) or until a non-standard unit, eliminating such interests, has been approved by the Commission.

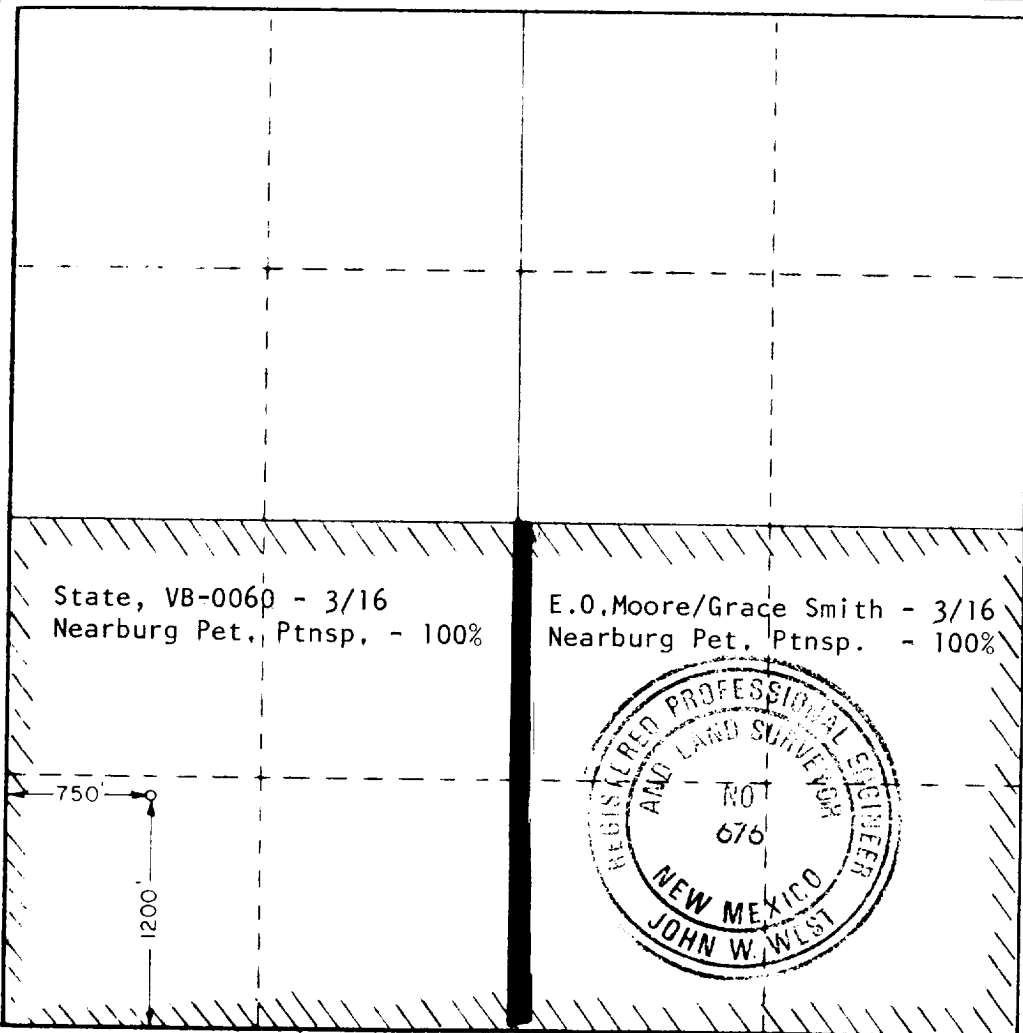

CERTIFICATION

I hereby certify that the information contained herein is true and complete to the best of my knowledge and belief.

*Kathie Craft*

Name

Kathie Craft

Position

Land Administrator

Company

Nearburg Producing Co.

Date

May 23, 1988

I hereby certify that the well location shown on this plat was plotted from field notes of actual surveys made by me or under my supervision, and that the same is true and correct to the best of my knowledge and belief.

Date Surveyed

May 18, 1988

Registered Professional Engineer and/or Land Surveyor

Certificate No. JOHN W. WEST, 676

RONALD J. EIDSON, 3239

BLOWOUT PREVENTER SKETCH  
Nearburg Producing Company

Boyd State 26M-1

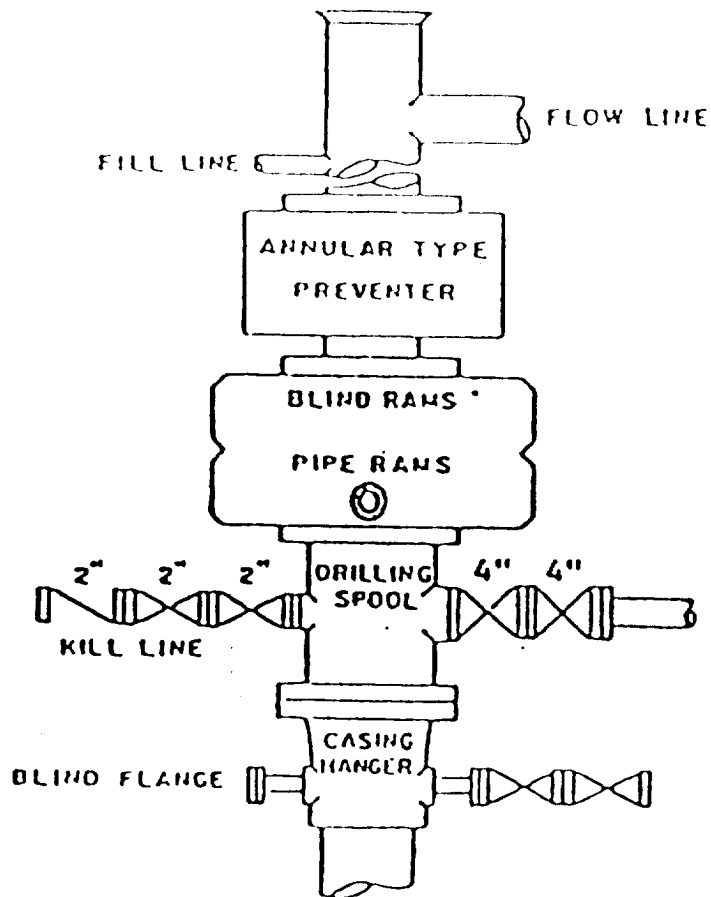

900 SERIES