

**NEW MEXICO OIL CONSERVATION COMMISSION
WELL LOCATION AND ACREAGE DEDICATION PLAT**

Form C-102
Supersedes C-128
Effective 1-1-85

All distances must be from the outer boundaries of the Section.

Operator Yates Petroleum Corporation				Lease State "CO" Com.		Well No. 3
Unit Letter D	Section 36	Township 19S	Range 24E	County Eddy		
Actual Footage Location of Wells <div style="display: flex; justify-content: space-between;"> 700 West 660 North </div>						
Ground Level Elev. 3619.5	Producing Formation CISCO CANYON		Tract N. DALLAR DRAW UPPER PENN		Dedicated Acreage 160 Acres	

1. Outline the acreage dedicated to the subject well by colored pencil or hatchure marks on the plat below.
2. If more than one lease is dedicated to the well, outline each and identify the ownership thereof (both as to working interest and royalty).
3. If more than one lease of different ownership is dedicated to the well, have the interests of all owners been consolidated by communitization, unitization, force-pooling, etc?

☒ Yes ☐ No If answer is "yes," type of consolidation COMMUNITIZATION

If answer is "no," list the owners and tract descriptions which have actually been consolidated. (Use reverse side of this form if necessary.)

No allowable will be assigned to the well until all interests have been consolidated (by communitization, unitization, forced-pooling, or otherwise) or until a non-standard unit, eliminating such interests, has been approved by the Commission.

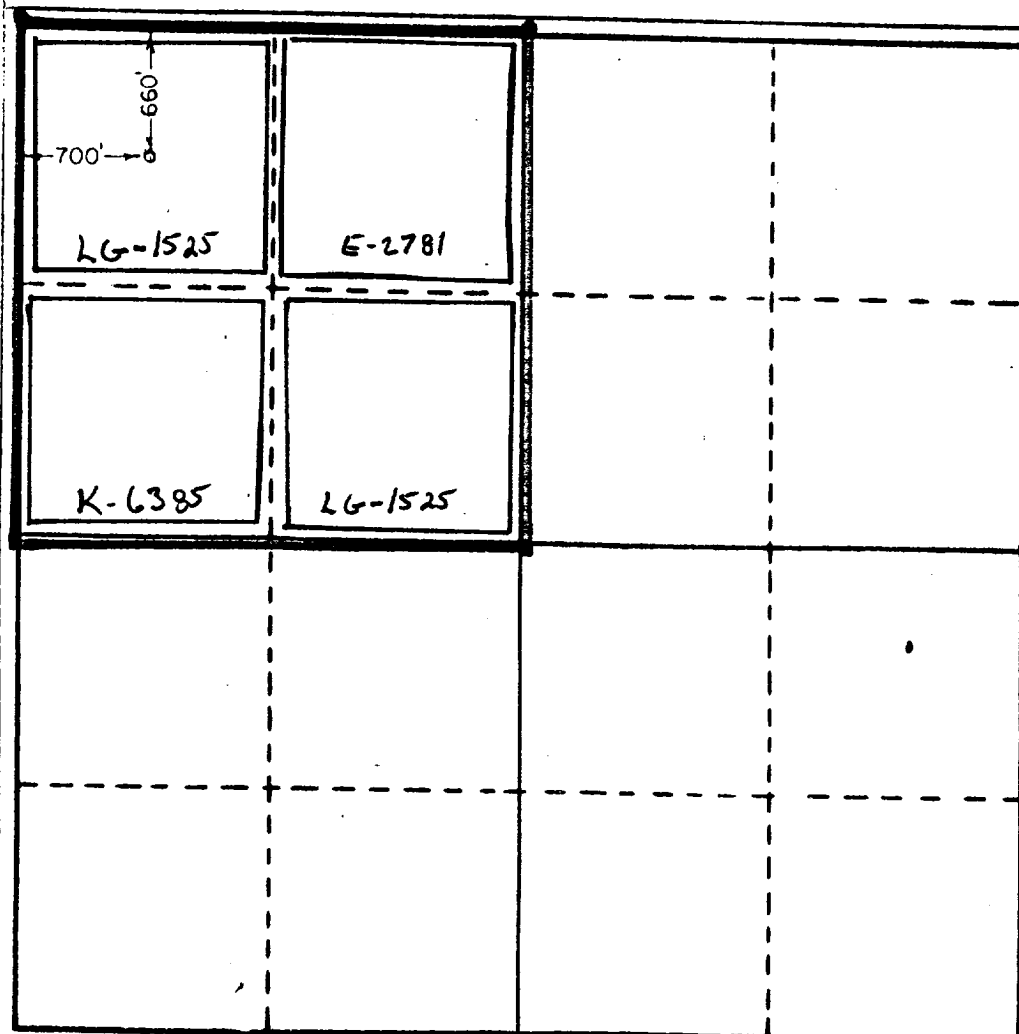

CERTIFICATION

I hereby certify that the information contained herein is true and complete to the best of my knowledge and belief.

Ken Beardemphl

Name
Ken Beardemphl

Position
Landman

Company
Yates Petroleum Corporation

Date
May 24, 1988

I hereby certify that the well location shown on this plat was plotted from field notes of actual surveys made by me or under my supervision, and that the same is true to the best of my knowledge.

Date
5/26/88

Professional Registration Number and/or License Number
3640

[Signature]

Certificate No **3640**

