

NEW MEXICO OIL CONSERVATION COMMISSION
WELL LOCATION AND ACREAGE DEDICATION AT

Supersedes C-128
Effective 1-1-65

All distances must be from the outer boundaries of the Section

Lessor Santa Fe Energy Operating Partners Ltd.			Lessee Lusk 15 Fed. Com.		Well No. 1
Tract Letter P	Section 15	Township 19 South	Range 31 East	County Eddy County	
Actual Section Location of Well: 660 feet from the South line and 660 feet from the East line					
Ground Level Elev. 3539.0	Producing Formation Strawn	Pool Lusk Strawn	Dedicated Acreage: 160 Acres		

1. Outline the acreage dedicated to the subject well by colored pencil or hatchure marks on the plat below.
2. If more than one lease is dedicated to the well, outline each and identify the ownership thereof (both as to working interest and royalty).
3. If more than one lease of different ownership is dedicated to the well, have the interests of all owners been consolidated by communitization, unitization, force-pooling etc?

☒ Yes ☐ No If answer is "yes," type of consolidation Communitization

If answer is "no," list the owners and tract descriptions which have actually been consolidated. (Use reverse side of this form if necessary.)

No allowable will be assigned to the well until all interests have been consolidated (by communitization, unitization, forced-pooling, or otherwise) or until a non-standard unit, eliminating such interests, has been approved by the Commission.

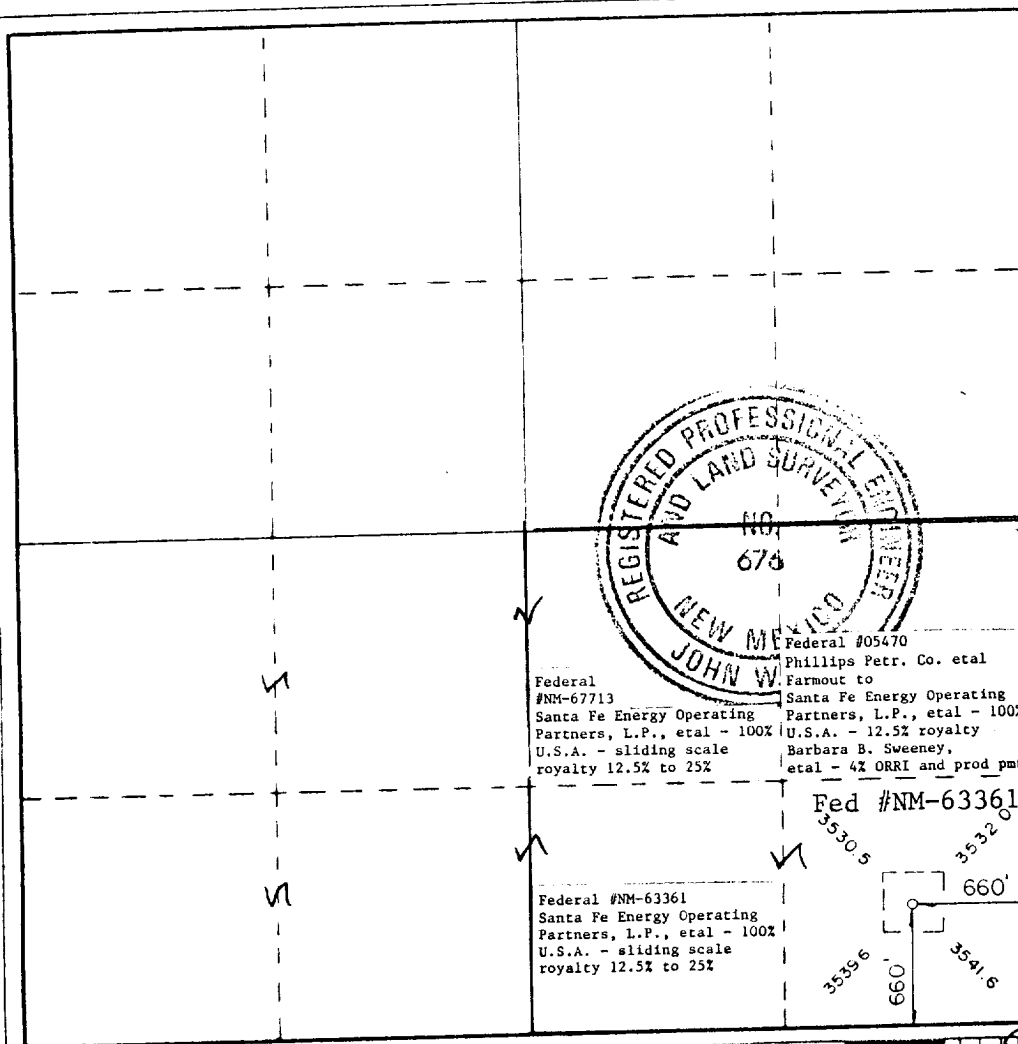

CERTIFICATION

I hereby certify that the information contained herein is true and complete to the best of my knowledge and belief.

Michael R. Burton
Name

Michael R. Burton

Position

Sr. Drilling Engineer

Company Santa Fe Energy Operating Partners, L.P.

Date

5-13-88

I hereby certify that the well location shown on this plat was plotted from field notes of actual surveys made by me or under my supervision, and that the same is true and correct to the best of my knowledge and belief.

Date Surveyed
May 6, 1988

Registered Professional Engineer and/or Land Surveyor

John W. West

Certificate No. JOHN W. WEST, 676
RONALD J. EIDSON, 3239