

UNITED STATES  
DEPARTMENT OF THE INTERIOR  
BUREAU OF LAND MANAGEMENT

SUBMIT IN TRIPLICATE  
(Other instruction  
verse side)

Budget Bureau No. 1004-  
Expires August 31, 1985

SUNDRY NOTICES AND REPORTS ON WELLS

(Do not use this form for proposals to drill or to deepen or plug back to a different reservoir.  
Use "APPLICATION FOR PERMIT" for such proposals.)

RECEIVED

1. ☐ OIL WELL ☐ GAS WELL ☒ OTHER

2. NAME OF OPERATOR  
Yates Petroleum Corporation

3. ADDRESS OF OPERATOR  
105 South Fourth Street - Artesia, NM 88210

4. LOCATION OF WELL (Report location clearly and in accordance with any State requirements.  
See also space 17 below.)  
At surface  
2310' FSL & 750' FWL

14. PERMIT NO. 15. ELEVATIONS (Show whether DF, RT, GR, etc.)  
32' 4' GR

5. LEASE DESIGNATION AND SERIAL  
NM-30629

6. IF INDIAN, ALLOTTEE OR TRIBE NAME

7. UNIT AGREEMENT NAME

8. FARM OR LEASE NAME  
Eastern Shore QW Federal

9. WELL NO.  
2-Y

10. FIELD AND POOL OR WILDCAT  
McMillan Upper Penn Gas

11. SEC., T., R., M., OR BLK. AND SURVEY OR AREA  
Section 8-T19S-R27E

12. COUNTY OR PARISH 13. STATE  
Eddy NM

16. Check Appropriate Box To Indicate Nature of Notice, Report, or Other Data

NOTICE OF INTENTION TO:		SUBSEQUENT REPORT OF:	
TEST WATER SHUT-OFF	<input type="checkbox"/>	WATER SHUT-OFF	<input type="checkbox"/>
FRACTURE TREAT	<input type="checkbox"/>	FRACTURE TREATMENT	<input type="checkbox"/>
SHOOT OR ACIDIZE	<input type="checkbox"/>	SHOOTING OR ACIDIZING	<input type="checkbox"/>
REPAIR WELL	<input type="checkbox"/>	(Other)	<input type="checkbox"/>
PULL OR ALTER CASING	<input type="checkbox"/>	REPAIRING WELL	<input type="checkbox"/>
MULTIPLE COMPLETION	<input type="checkbox"/>	ALTERING CASING	<input type="checkbox"/>
ABANDON*	<input type="checkbox"/>	ABANDONMENT*	<input type="checkbox"/>
CHANGE PLANS	<input type="checkbox"/>		

(Other) Skid Rig X

17. DESCRIBE PROPOSED OR COMPLETED OPERATIONS (Clearly state all pertinent details, and give pertinent dates, including estimated date of starting any proposed work. If well is directionally drilled, give subsurface locations and measured and true vertical depths for all markers and zones pertinent to this work.)\*

We propose to skid the rig 90' to the east due to a large sinkhole. The new location will be 2310' FSL & 750' FWL of Section 8-T19S-R27E.

RECEIVED  
JUL 8 11 17 AM '88  
CARLE AREA

18. I hereby certify that the foregoing is true and correct

SIGNED Rusty Pruggan TITLE Regulatory Secretary DATE July 7, 1988

(This space for Federal or State office use)

APPROVED BY \_\_\_\_\_ TITLE \_\_\_\_\_ DATE 7-19-88

CONDITIONS OF APPROVAL, IF ANY:

\*See Instructions on Reverse Side

N MEXICO OIL CONSERVATION COMMISS  
WELL LOCATION AND ACREAGE DEDICATION PLAT

Form C-102  
Supersedes C-128  
Effective 1-1-65

All distances must be from the outer boundaries of the Section.

Operator <b>YATES PETROLEUM CORPORATION</b>			Lease <b>EASTERN SHORE QW FEDERAL</b>		Well No. <b>2-Y</b>
Unit Letter <b>L</b>	Section <b>8</b>	Township <b>19S</b>	Range <b>27E</b>	County <b>EDDY</b>	
Actual Footage Location of Well:					
<b>2310</b> feet from the <b>South</b> line and		<b>750</b> feet from the <b>West</b> line			
Ground Level Elev. <b>3274'</b>	Producing Formation <b>PENN</b>	Pool <b>McMILLIAN UPPER PENN GAS</b>	Dedicated Acreage: <b>320</b> Acres		

1. Outline the acreage dedicated to the subject well by colored pencil or hachure marks on the plat below.
2. If more than one lease is dedicated to the well, outline each and identify the ownership thereof (both as to working interest and royalty).
3. If more than one lease of different ownership is dedicated to the well, have the interests of all owners been consolidated by communitization, unitization, force-pooling, etc?

☒ Yes    ☐ No    If answer is "yes," type of consolidation **COMMUNITIZATION**

If answer is "no," list the owners and tract descriptions which have actually been consolidated. (Use reverse side of this form if necessary.) \_\_\_\_\_

No allowable will be assigned to the well until all interests have been consolidated (by communitization, unitization, forced-pooling, or otherwise) or until a non-standard unit, eliminating such interests, has been approved by the Commission.

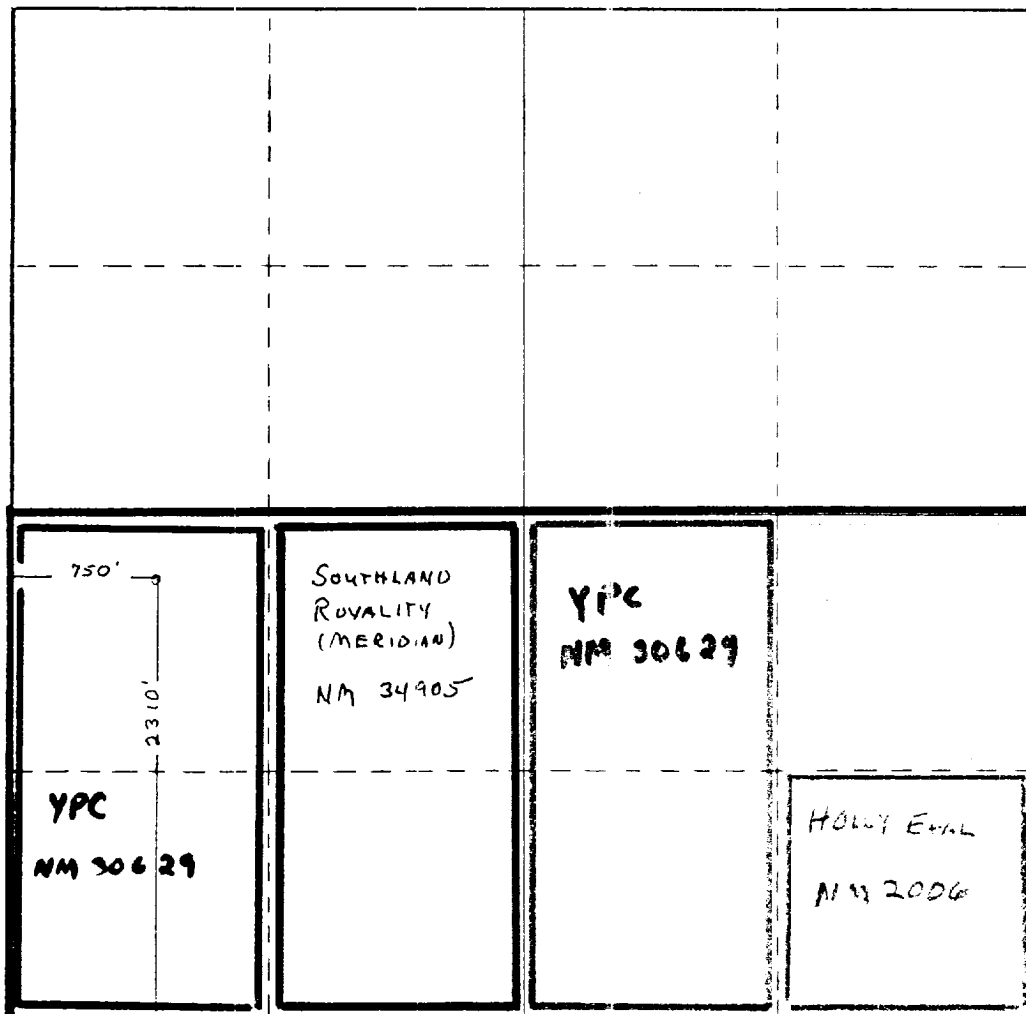

CERTIFICATION

I hereby certify that the information contained herein is true and complete to the best of my knowledge and belief.

*Clifton R. May*

Name

Clifton R. May

Position

Permit Agent

Company

Yates Petroleum Corporation

Date

July 7, 1988

I hereby certify that the well location shown on this plat was plotted from field notes of actual surveys made by me or under my supervision and that the same are true and correct to the best of my knowledge and belief.

Date Surveyed

Registered Professional Engineer and/or Land Surveyor

*Dan R. Reddy*

Certificate No.

NM PE&LS NO. 5412

UNITED STATES  
DEPARTMENT OF THE INTERIOR  
BUREAU OF LAND MANAGEMENT

APPLICATION FOR PERMIT TO DRILL, DEEPEN, OR PLUG BACK

1a. TYPE OF WORK

DRILL ☒

DEEPEN ☐

PLUG BACK ☐

b. TYPE OF WELL

OIL  
WELL ☐

GAS  
WELL ☒

OTHER

SINGLE  
ZONE ☐

RECEIVED ☐

2. NAME OF OPERATOR

Yates Petroleum Corporation

3. ADDRESS OF OPERATOR

105 South Fourth Street - Artesia, NM 88210

4. LOCATION OF WELL (Report location clearly and in accordance with any State requirements\*)

At surface

2310' FSL and 660' FWL

At proposed prod. zone

Same

14. DISTANCE IN MILES AND DIRECTION FROM NEAREST TOWN OR POST OFFICE\*

Approximately 11 miles southeast of Artesia, New Mexico

15. DISTANCE FROM PROPOSED\*

LOCATION TO NEAREST

PROPERTY OR LEASE LINE, FT.

(Also to nearest drlg. unit line, if any)

660'

18. DISTANCE FROM PROPOSED LOCATION\*

TO NEAREST WELL, DRILLING, COMPLETED,

OR APPLIED FOR, ON THIS LEASE, FT.

2000'

21. ELEVATIONS (Show whether DF, RT, GR, etc.)

3274" GR

23. PROPOSED CASING AND CEMENTING PROGRAM

SIZE OF HOLE	SIZE OF CASING	WEIGHT PER FOOT	SETTING DEPTH	QUANTITY OF CEMENT
20"	16"	75# K-55	Approx. 400'	500 sacks - circulate
14-3/4"	9-5/8"	36# K-55	" 2200'	1500 sacks - circulate
8-3/4"	7"	23# & 26# K-55 & S-95	8100'	250 sacks

We propose to drill and test the Penn and intermediate formations. Approximately 400' of surface casing will be set to shut off gravel and cavings. Intermediate casing will be run to approximately 2200'. If commercial, will run 7" casing with 600' of cement cover, will perforate and stimulate as needed for production.

MUD PROGRAM: FW gel/LCM to 2200', fresh water to 7500', starch/driskpak/KCL/salt gel to TD

BOP PROGRAM: BOP's and hydril will be installed on 9-5/8" casing and tested daily

GAS NOT DEDICATED

IN ABOVE SPACE DESCRIBE PROPOSED PROGRAM: If proposal is to deepen or plug back, give data on present productive zone and proposed new productive zone. If proposal is to drill or deepen directionally, give pertinent data on subsurface locations and measured and true vertical depths. Give blowout preventer program, if any.

24.

SIGNED

*Cy Corrao*

TITLE

Permit Agent

DATE March 23, 1988

(This space for Federal or State office use)

PERMIT NO.

APPROVAL DATE

APPROVED BY

TITLE

DATE

CONDITIONS OF APPROVAL, IF ANY:

5-18-88

\*See Instructions On Reverse Side