

CONSERVATION DIVISION

P. O. BOX 2088

SANTA FE, NEW MEXICO 87501

30-015-25991
Form C-101
Revised 10-1-78

NO. OF COPIES RECEIVED	
DISTRIBUTION	
STATE	
FILE	
U.S.G.I.	
LAND OFFICE	
OPERATOR	

SEP 26 '88

O.C.D.

NEARBY OFFICE

APPLICATION FOR PERMIT TO DRILL, DEEPEN, OR PLUG BACK

1a. Type of Work

b. Type of Well DRILL ☒ DEEPEN ☐ PLUG BACK ☐
OIL WELL ☐ GAS WELL ☒ OTHER ☐ SINGLE ZONE ☒ MULTIPLE ZONE ☐

2. Name of Operator

Nearburg Producing Company

3. Address of Operator

P. O. Box 31405, Dallas, Texas 75231-0405

4. Location of Well

UNIT LETTER A LOCATED 990 FEET FROM THE North LINE

AND 990 FEET FROM THE East LINE OF SEC. 12 TWP. 19S RCE. 25E N.M.P.M.

7. Unit Agreement Name

8. Farm or Lease Name

Rose 12A

9. Well No.

1

10. Field and Pool or Hydraulic

Ind. Four Mile Draw - Morrow

12. County

Eddy

14. Proposed Depth

9900'

16A. Formation

Morrow

20. Rotary or C.T.

Rotary

21. Elevations (Show whether D.P., K.I., etc.)

21A. Kind & Status Plug. Bond

Blanket

21B. Drilling Contractor

TOT Drilling Corp.

22. Approx. Date Work will start

9-24-88

PROPOSED CASING AND CEMENT PROGRAM

SIZE OF HOLE	SIZE OF CASING	WEIGHT PER FOOT	SETTING DEPTH	SACKS OF CEMENT	EST. TOP
17 1/2" & 12 1/4"	8 5/8	24	1350	1700	Circulate
7 7/8"	4 1/2	11.60	9900		

Propose to drill the well to evaluate the Morrow Formation. After reaching T.D., logs will be run and casing set if evaluation is positive. Perforate, test, and stimulate as necessary to establish production. B.O.P Program attached. Gas is not dedicated.

Unorthodox location case scheduled for June 8, 1988. APPROVAL VALID FOR 180 DAYS
PERMIT EXPIRES 3/26/89
UNLESS DRILLING UNDERWAY

*We plan to drill a 17 1/2" hole to equal 350'. If hole conditions permit we will then drill a 12 1/4" hole from 350' - 1350' and run 8 5/8" casing and circulate cement. If hole conditions do not allow us to drill on from 350', we will run 13 3/8" to 350' and drill a 12 1/4" hole to 1350' and run and cement 8 5/8" casing. (O.K. per Mike Williams 5/23/88)

POST ID-1

NL & API

9-30-88

4 ABOVE SPACE DESCRIBE PROPOSED PROGRAM; IF PROPOSAL IS TO DEEPEN OR PLUG BACK, GIVE DATA ON PRESENT PRODUCTIVE ZONE AND PROPOSED NEW PRODUCTIVE ZONE. GIVE BLOWOUT PREVENTER PROGRAM, IF ANY.

hereby certify that the information above is true and complete to the best of my knowledge and belief.

igned Mike Williams Title Engineering Manager

Date 9-21-88

(This space for State Use)

Original Signed By

Mike Williams

APPROVED BY

CONDITIONS OF APPROVAL, IF ANY:

Notify N.M.O.C.C. in sufficient

time to witness cementing

the 13 3/8" & 8 5/8" casing

DATE

SEP 26 1988

Pending NEL Approval

NEL R-87520

MEXICO OIL CONSERVATION COMMISSION
WELL LOCATION AND ACREAGE DEDICATION PLAT

Form C-127
Supersedes C-128
Effective 1-1-65

All distances must be from the outer boundaries of the Section

Operator Nearburg Producing Company			Lease Rose "12A"		Well No. 1
Tract Letter A	Section 12	Township 19 South	Range 25 East	County Eddy	
Actual Footage Location of Well: 990 feet from the North line and 990 feet from the East line					
Ground Level Elev. 3391.9	Producing Formation Morrow	Pool UND FORMERLY OWN MORROW 2014		Dedicated Acreage: 320 Acres	

1. Outline the acreage dedicated to the subject well by colored pencil or hatchure marks on the plat below.
2. If more than one lease is dedicated to the well, outline each and identify the ownership thereof (both as to working interest and royalty).
3. If more than one lease of different ownership is dedicated to the well, have the interests of all owners been consolidated by communitization, unitization, force-pooling, etc?

☒ Yes ☐ No If answer is "yes," type of consolidation Pooling

If answer is "no," list the owners and tract descriptions which have actually been consolidated. (Use reverse side of this form if necessary.)

No allowable will be assigned to the well until all interests have been consolidated (by communitization, unitization, forced-pooling, or otherwise) or until a non-standard unit, eliminating such interests, has been approved by the Commission.

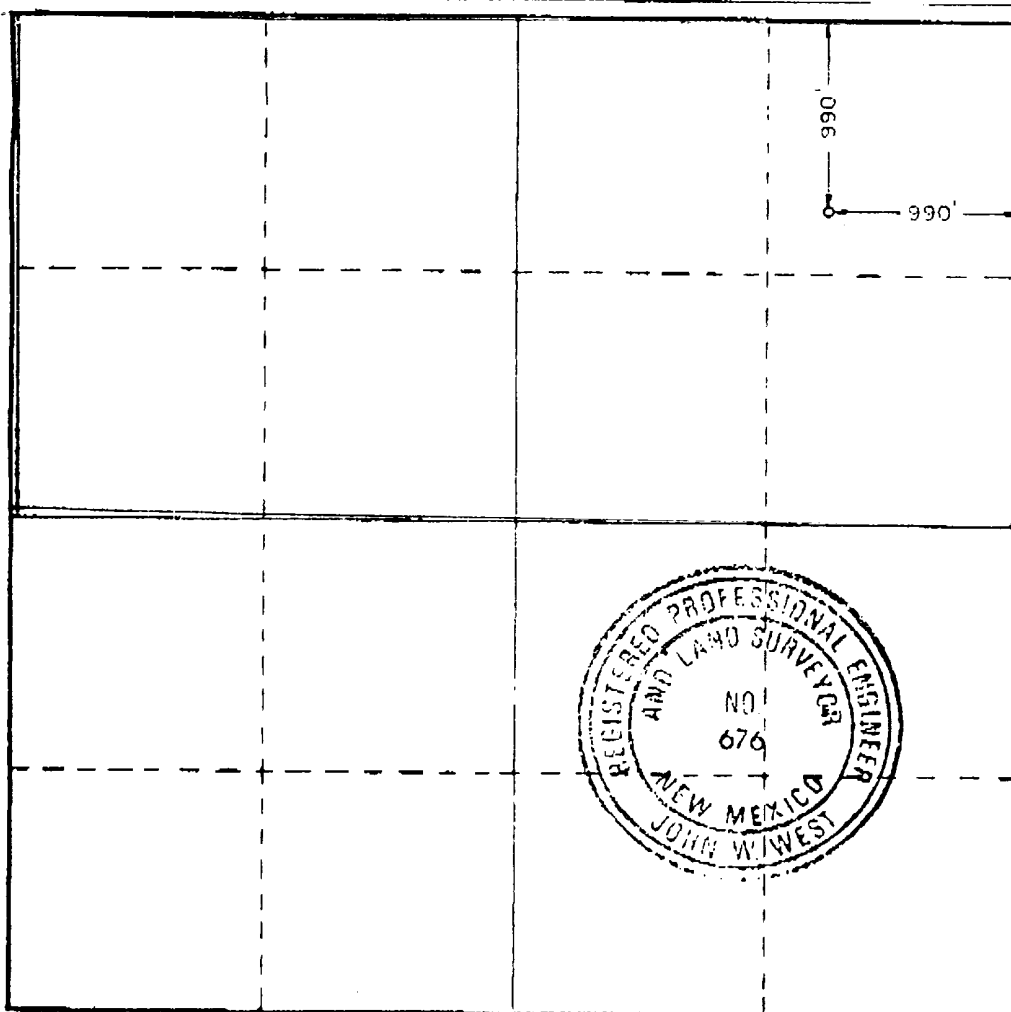

CERTIFICATION

I hereby certify that the information contained herein is true and complete to the best of my knowledge and belief.

JR/M. Daniel

Name

ENGINEERING MANAGER

Position

NEARBURG PRODUCING

Company

9/26/88

Date

I hereby certify that the well location shown on this plat was plotted from field notes of actual surveys made by me or under my supervision, and that the same is true and correct to the best of my knowledge and belief.

Date Surveyed

August 23, 1988

Registered Professional Engineer
and/or Land Surveyor

John W. West

Certificate No. JOHN W. WEST

BLOWOUT PREVENTER SKETCH
Nearburg Producing Company
ROSE 12A WELL NO. 1

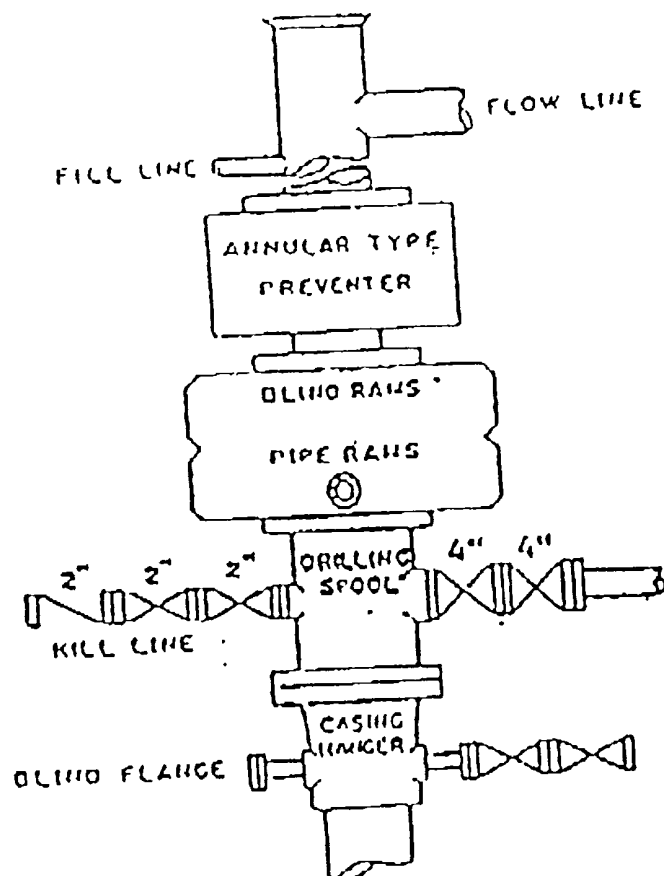

900 SERIES

IT IS THEREFORE ORDERED THAT: R-8752 APPR. 9-23-88

(1) The applicant, Nearburg Producing Company, is hereby authorized to drill a gas well at an unorthodox gas well location 990 feet from the North and East lines (Unit A) of Section 12, Township 19 South, Range 25 East, NMPM, Undesignated Boyd-Morrow Gas Pool, Eddy County, New Mexico.

(2) The applicant's alternate request for a 160-acre non-standard gas spacing and proration unit consisting of the NE/4 of said Section 12 is hereby denied.

(3) The N/2 of said Section 12 shall be dedicated to the above-described well.

(4) Jurisdiction of this cause is retained for the entry of such further orders as the Division may deem necessary.

7-26-89
Comp. neutron log density
7-22-88
Dual laterolog micro SFL
1348-9325

NSL R-8752
Appr. 9-23-88 (mm.)