

Form C-101
Revised 10-1-78

FEB 1 '89

O. C. D.

APPLICATION FOR PERMIT TO DRILL, DEEPEN, OR PLUG O. C. D.
MESA, ARIZONA

PROPOSED CASING AND CEMENT PROGRAM

We propose to drill and test the Morrow and intermediate formations. Approximately 1800' of surface casing will be set and cement circulated to shut off gravel and cavings. If commercial, production casing will be ran and cemented with adequate cover, perforated and stimulated as needed for production.

MUD PROGRAM: FW gel/LCM to 1800', cut brine to 7500', starch/drispak to TD

BOP PROGRAM: BOP's will be installed on the 8-5/8" casing and tested daily

GAS NOT DEDICATED

POST ID-1
NLA API
2-10-89

APPROVAL VALID FOR 180 DAYS
FOR ALL EQUIPMENTS 7/3/89
UNLESS DRILLING UNDERWAY

IN ABOVE SPACE DESCRIBE PROPOSED PROGRAM. IF PROPOSAL IS TO DEEREN OR PLUG BACK, GIVE DATA ON PRESENT PRODUCTIVE ZONE AND PROPOSED NEW PROD

I hereby certify that the information above is true and complete to the best of my knowledge and belief.

Signed Alvin VanSlyke Title Landman Date February 1, 1989

(This space for State Use)
Original Signed By
Mike Williams

APPROVED BY Mike Williams TITLE _____ DATE FEB 03 1989

CONDITIONS OF APPROVAL, IF ANY:

Notify DDMC CG in sufficient
time to allow ordering
the 8 5/8 casing

Submit to Appropriate
District Office
State Lease - 4 copies
Fee Lease - 3 copies

State of New Mexico
Energy, Minerals and Natural Resources Department

Form C-102
Revised 1-1-89

OIL CONSERVATION DIVISION

P.O. Box 2088
Santa Fe, New Mexico 87504-2088

DISTRICT I
P.O. Box 1980, Hobbs, NM 88240

DISTRICT II
P.O. Drawer DD, Artesia, NM 88210

DISTRICT III
1000 Rio Brazos Rd., Aztec, NM 87410

WELL LOCATION AND ACREAGE DEDICATION PLAT

All Distances must be from the outer boundaries of the section

Operator YATES PETROLEUM CORPORATION			Lease FOOT HILLS "AGH" STATE		Well No. 1
Unit Letter "O"	Section 20	Township 19 South	Range 23 East	County Eddy	

Actual Footage Location of Well: 660 feet from the South line and 2310 feet from the East line					
Ground level Elev. 4046.4	Producing Formation Morrow		Pool WILDCAT Morrow		Dedicated Acreage: 320 Acres

1. Outline the acreage dedicated to the subject well by colored pencil or hatchure marks on the plat below.
2. If more than one lease is dedicated to the well, outline each and identify the ownership thereof (both as to working interest and royalty).
3. If more than one lease of different ownership is dedicated to the well, have the interest of all owners been consolidated by communitization, unitization, force-pooling, etc.?
☐ Yes ☐ No If answer is "yes" type of consolidation _____
If answer is "no" list the owners and tract descriptions which have actually been consolidated. (Use reverse side of this form if necessary).
No allowable will be assigned to the well until all interests have been consolidated (by communitization, unitization, forced-pooling, or otherwise) or until a non-standard unit, eliminating such interest, has been approved by the Division.

OPERATOR CERTIFICATION

I hereby certify that the information contained herein is true and complete to the best of my knowledge and belief.

Signature
Ken Beard
Printed Name
KEN BEARD EPHL
Position
LAND MAN
Company
YATES PET. CORP.
Date
February 1, 1989

SURVEYOR CERTIFICATION

I hereby certify that the well location shown on this plat was plotted from field notes of actual surveys made by me or under my supervision, and that the same is true and correct to the best of my knowledge and belief.

Date Surveyed
January 1989
Signature
Professional Surveyor
HERSCHEL L. JONES
3640
Certified and Surveyed

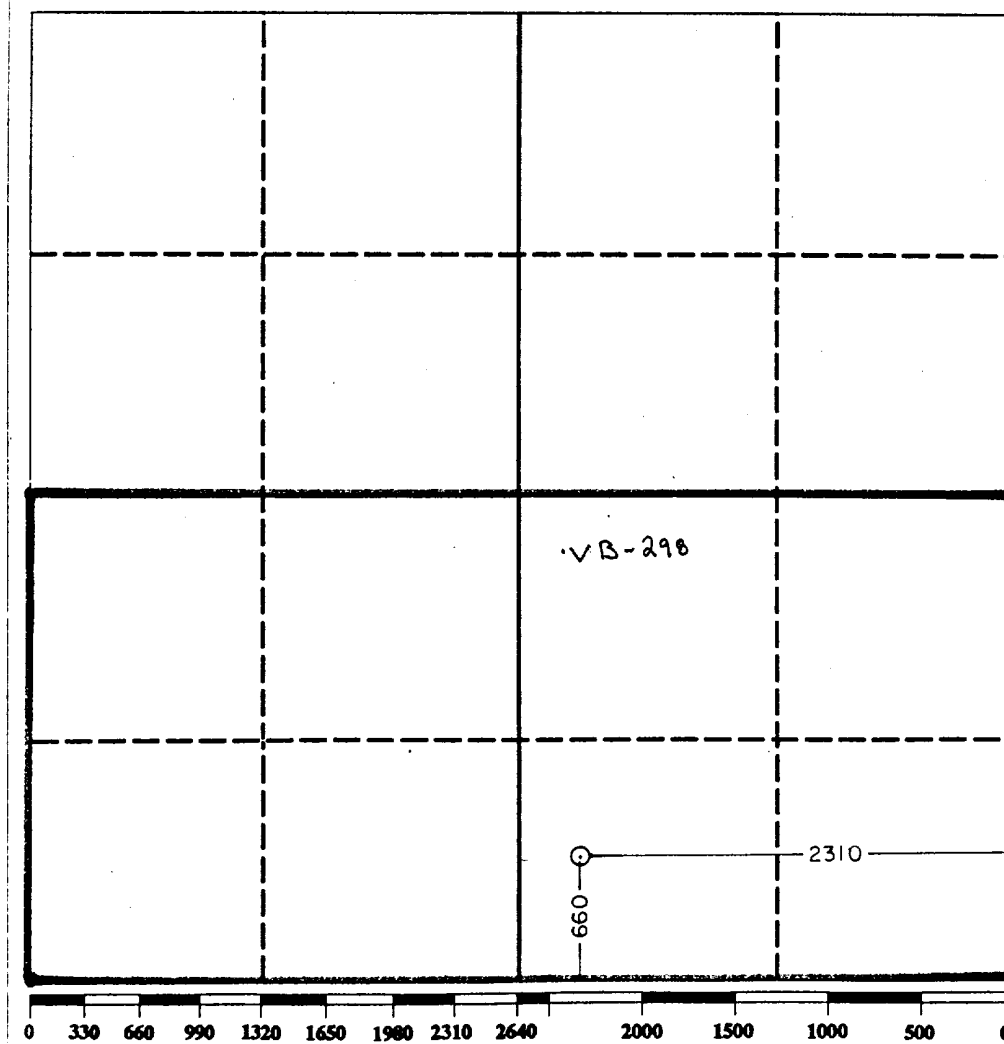

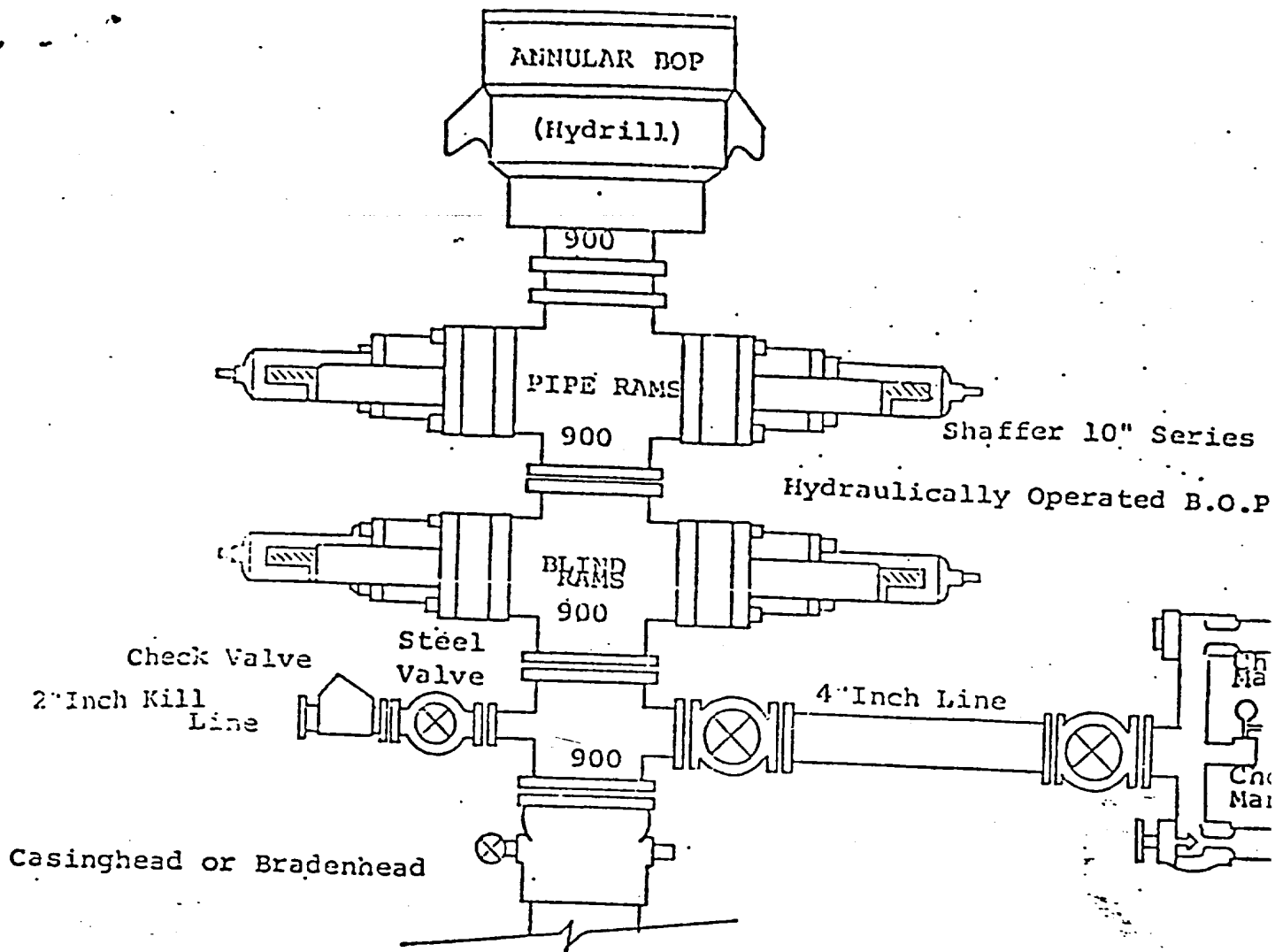

THE FOLLOWING CONSTITUTE MINIMUM BLOWOUT PREVENTER REQUIREMENTS

1. All preventers to be hydraulically operated with secondary manual control installed prior to drilling out from under casing.
2. Choke outlet to be a minimum of 2" diameter.
3. Kill line to be of all steel construction of 2" minimum diameter.
4. All connections from operating manifolds to preventers to be all steel hole or tube a minimum of one inch in diameter.
5. The available closing pressure shall be at least 15% in excess of the required with sufficient volume to operate the B.O.P.'s.
6. All connections to and from preventer to have a pressure rating equivalent to that of the B.O.P.'s.
7. Inside blowout preventer to be available on rig floor.
8. Operating controls located a safe distance from the rig floor.
9. Hole must be kept filled on trips below intermediate casing.
10. D. P. float must be installed and used below zone of first gas intrusion.

30-015-25048

2659110-0
2659130-0
2659150-0

2-25-85

DAL

1140-8608

CNL

54RF-8609