

Submit to Appropriate
District Office
State Lease - 6 copies
Fee Lease - 5 copies

State of New Mexico
Energy, Minerals and Natural Resources Department

Form C-101
Revised 1-1-89

OIL CONSERVATION DIVISION

P.O. Box 2088
Santa Fe, New Mexico 87504-2088

RECEIVED

MAY - 5 '89

O. C. D.

ARTESIA OFFICE

DISTRICT I
P.O. Box 1980, Hobbs, NM 88240

DISTRICT II
P.O. Drawer DD, Artesia, NM 88210

DISTRICT III
1000 Rio Brazos Rd., Aztec, NM 87410

API NO. (assigned by OCD on New Wells)

30-015-26115

5. Indicate Type of Lease

STATE ☒

FEE ☐

6. State Oil & Gas Lease No.

K-6385

7. Lease Name or Unit Agreement Name

Catchlaw "AGM" St. Com.

8. Well No.

#1

9. Pool name or Wildcat

Wildcat Morrow

2. Name of Operator

Yates Petroleum Corporation

3. Address of Operator

105 South Fourth, Artesia, New Mexico 88210

4. Well Location

Unit Letter C : 660 Feet From The North Line and 1980 Feet From The West Line

Section 2 Township 20S Range 24E NMPM Eddy County

10. Proposed Depth

9600'

11. Formation

Morrow

12. Rotary or C.T.

Rotary

13. Elevations (Show whether DF, RT, GR, etc.)

3663. GR

14. Kind & Status Plug. Bond

Blanket

15. Drilling Contractor

Undesignated

16. Approx. Date Work will start

ASAP

17.

PROPOSED CASING AND CEMENT PROGRAM

SIZE OF HOLE	SIZE OF CASING	WEIGHT PER FOOT	SETTING DEPTH	SACKS OF CEMENT	EST. TOP
14 3/4 "	9 5/8 "	36# J-55	Approx. 1300'	900 sacks	circulate
8 3/4 "	7 "	26# N-80 & J55	TD	as warranted	

We propose to drill and test the Morrow and intermediate formations. Approximately 1300' of surface casing will be set and cement circulated to shut off gravel and cavings. If commercial, production casing will be run and cemented with adequate cover, perforated and stimulated as needed for production.

MUD PROGRAM: ^{FW} Swagel/LCM to 1300'; FW to 4000', Cut brine to 7600', Drispak, starch to TD

BOP PROGRAM: BOP's will be installed on the 9 5/8" casing and tested daily.

GAS NOT DEDICATED:

APPROVAL VALID FOR 180 DAYS

PERMIT EXPIRES 11/8/89

UNLESS DRILLING UNDERWAY

IN ABOVE SPACE DESCRIBE PROPOSED PROGRAM: IF PROPOSAL IS TO DEEPEN OR PLUG BACK, GIVE DATA ON PRESENT PRODUCTIVE ZONE AND PROPOSED NEW PRODUCTIVE ZONE. GIVE BLOWOUT PREVENTER PROGRAM, IF ANY.

I hereby certify that the information above is true and complete to the best of my knowledge and belief.

SIGNATURE

Ken Beardemphl

TITLE Landman

DATE 5/5/89

TYPE OR PRINT NAME

Ken Beardemphl

TELEPHONE NO. 748-1471

(This space for State Use)

Original Signed By
Mike Williams

APPROVED BY

TITLE

DATE

MAY 8 1989

CONDITIONS OF APPROVAL, IF ANY:

Notify N.M.O.C.C. in sufficient
time to witness cementing

the 8 5/8 casing

**NEW MEXICO OIL CONSERVATION COMMISSION
WELL LOCATION AND ACREAGE DEDICATION PLAT**

Form C-102
Supersedes C-128
Effective 1-1-65

All distances must be from the outer boundaries of the Section.

Operator YATES PETROLEUM CORPORATION			Lease Catclaw AGM State Com		Well No. 1
Unit Letter C	Section 2	Township 20 South	Range 24 East	County Eddy County, N.M.	
Actual Footage Location of Well: <div style="display: flex; justify-content: space-between;"> 660 feet from the North line and 1980 feet from the West line </div>					
Ground Level Elev. 3663.	Producing Formation MORROW	Pool WILDCAT MORROW	Dedicated Acreage: 320 Acres		

1. Outline the acreage dedicated to the subject well by colored pencil or hachure marks on the plat below.
2. If more than one lease is dedicated to the well, outline each and identify the ownership thereof (both as to working interest and royalty).
3. If more than one lease of different ownership is dedicated to the well, have the interests of all owners been consolidated by communitization, unitization, force-pooling, etc?

☒ Yes ☐ No If answer is "yes," type of consolidation to be communitized

If answer is "no," list the owners and tract descriptions which have actually been consolidated. (Use reverse side of this form if necessary.) _____

No allowable will be assigned to the well until all interests have been consolidated (by communitization, unitization, forced-pooling, or otherwise) or until a non-standard unit, eliminating such interests, has been approved by the Commission.

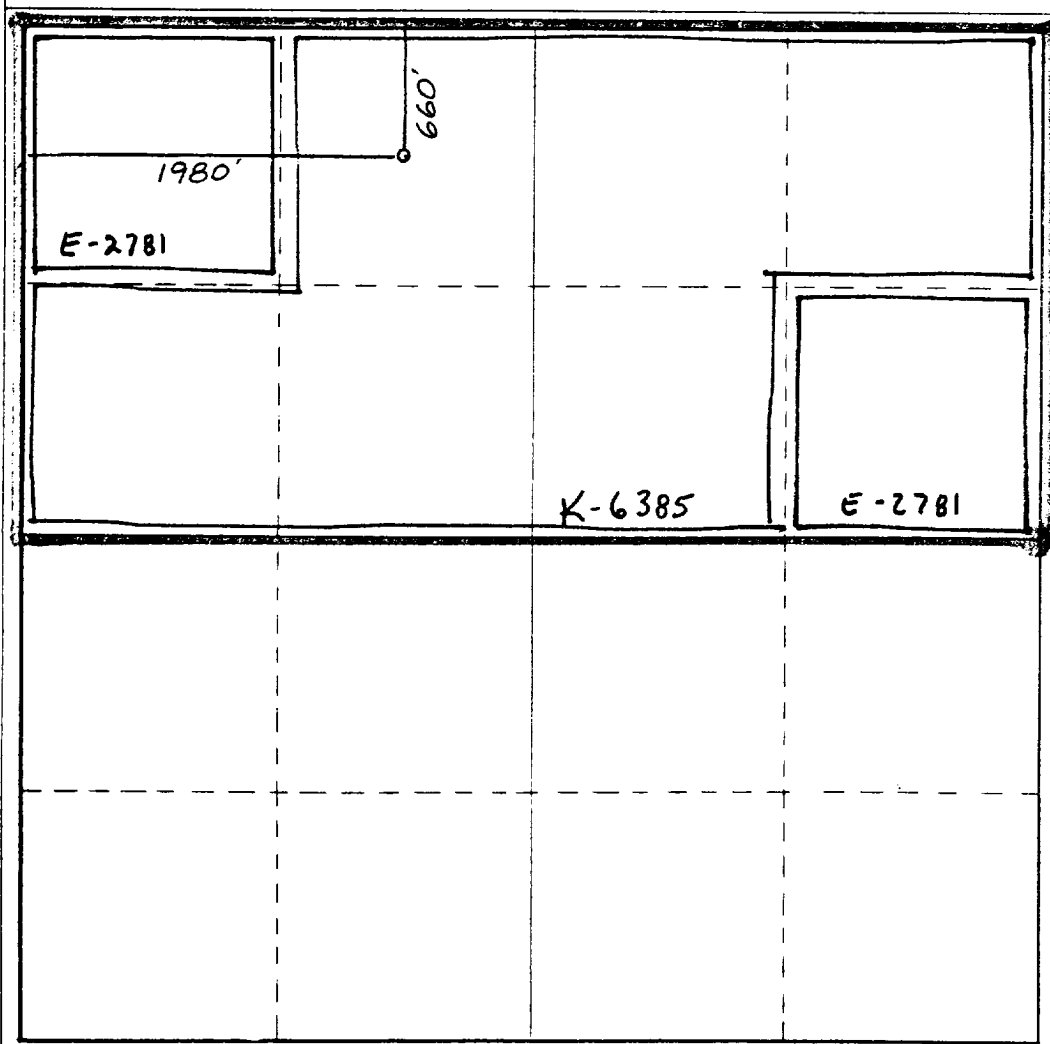

CERTIFICATION

I hereby certify that the information contained herein is true and complete to the best of my knowledge and belief.

Ker Sandberg

Name
LANDMAN
Position
Yates Pet. Corp.
Company
5-5-89
Date

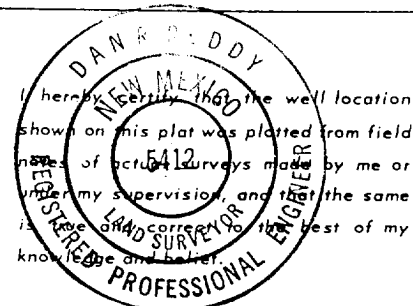

Date Surveyed
May 3, 1989
Registered Professional Engineer
and/or Land Surveyor
Dan R. Reddy
Certificate No.
NM PE&LS NO. 5412

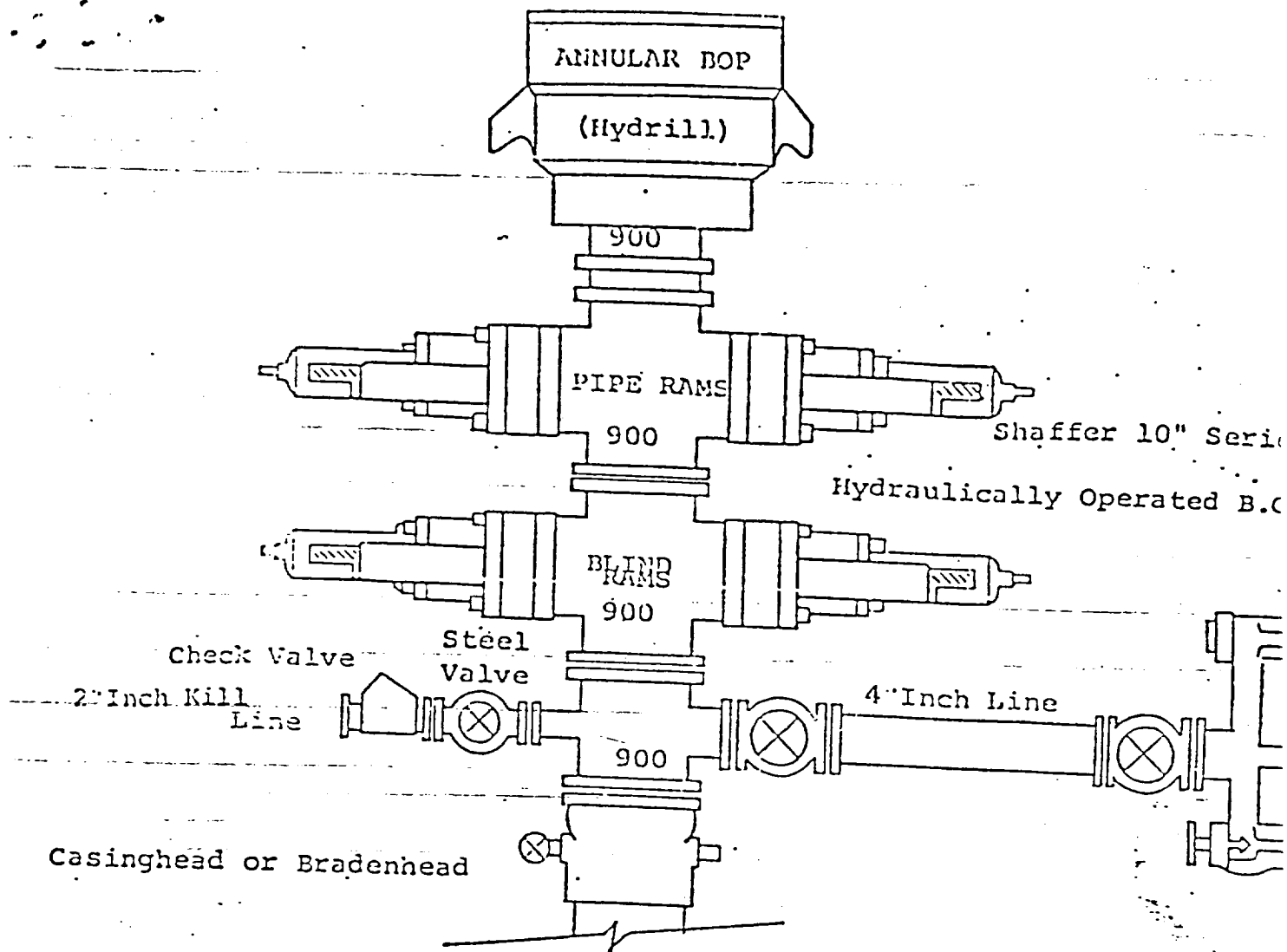

THE FOLLOWING CONSTITUTE MINIMUM BLOWOUT PREVENTER REQUIREMENTS

1. All preventers to be hydraulically operated with secondary manual installed prior to drilling out from under casing.
2. Choke outlet to be a minimum of 2" diameter.
3. Kill line to be of all steel construction of 2" minimum diameter.
4. All connections from operating manifolds to preventers to be all steel hole or tube a minimum of one inch in diameter.
5. The available closing pressure shall be at least 15% in excess of required with sufficient volume to operate the B.O.P.'s.
6. All connections to and from preventer to have a pressure rating equal to that of the B.O.P.'s.
7. Inside blowout preventer to be available on rig floor.
8. Operating controls located a safe distance from the rig floor.
9. Hole must be kept filled on trips below intermediate casing.
10. D. P. float must be installed and used below zone of first gas entry.