

UNITED STATES DEPARTMENT OF THE INTERIOR
BUREAU OF LAND MANAGEMENT 88210

APPLICATION FOR PERMIT TO DRILL, DEEPEN, OR PLUG BACK

1a. TYPE OF WORK

DRILL ☒

DEEPEN ☐

PLUG BACK ☐

b. TYPE OF WELL

OIL WELL ☒

GAS WELL ☐

OTHER

SINGLE ZONE ☐

MULTIPLE ZONE ☐

2. NAME OF OPERATOR

Harvey E. Yates Company

3. ADDRESS OF OPERATOR

P.O. Box 1933, Roswell, New Mexico 88202

AUG 16 '89

4. LOCATION OF WELL (Report location clearly and in accordance with any State requirements.)

At surface

990' FNL & 760' FEL

O. C. D.

ARTESIA, OFFICE

At proposed prod. zone

same

14. DISTANCE IN MILES AND DIRECTION FROM NEAREST TOWN OR POST OFFICE*

12 miles southeast of Loco Hills, New Mexico

15. DISTANCE FROM PROPOSED* LOCATION TO NEAREST PROPERTY OR LEASE LINE, FT.

760

16. NO. OF ACRES IN LEASE

160

17. NO. OF ACRES ASSIGNED TO THIS WELL

40

18. DISTANCE FROM PROPOSED* LOCATION TO NEAREST WELL, DRILLING, COMPLETED, OR APPLIED FOR, ON THIS LEASE, FT.

1220

19. PROPOSED DEPTH

8900

20. ROTARY OR CABLE TOOLS

Rotary

21. ELEVATIONS (Show whether DF, RT, GR, etc.)

3756.7 GL

22. APPROX. DATE WORK WILL START*

ASAP

23.

PROPOSED CASING AND CEMENTING PROGRAM

SIZE OF HOLE	SIZE OF CASING	WEIGHT PER FOOT	SETTING DEPTH	QUANTITY OF CEMENT
17 1/2	13 3/8	54.5	350	Circ to surface
12 1/4	8 5/8	32	2350	Circ to surface
7 7/8	5 1/2	17	8900	600' above pay

MUD PROGRAM:

0 - 350 FW w/paper
350 - 2350 Brine water
2350 - 8900 FW mud

IN ABOVE SPACE DESCRIBE PROPOSED PROGRAM: If proposal is to deepen or plug back, give data on present productive zone and proposed new productive zone. If proposal is to drill or deepen directionally, give pertinent data on subsurface locations and measured and true vertical depths. Give blowout preventer program, if any.

24.

SIGNED

H. M. Young

NM Young

TITLE

Drilling Superintendent

DATE

7/17/89

(This space for Federal or State office use)

PERMIT NO.

APPROVAL DATE

APPROVED BY

C. B. Sigler

TITLE

CARLSBAD RES.

DATE

8-15-89

CONDITIONS OF APPROVAL, IF ANY:

*See Instructions On Reverse Side

Title 18 U.S.C. Section 1001, makes it a crime for any person knowingly and willfully to make to any department or agency of the United States any false, fictitious or fraudulent statements or representations as to any matter within its jurisdiction.

RECEIVED

Post ID-1
8-18-89
New boo KAPZ

Submit to Appropriate
District Office
State Lease - 4 copies
Fee Lease - 3 copies

State of New Mexico
Energy, Minerals and Natural Resources Department

Form C-102
Revised 1-1-89

OIL CONSERVATION DIVISION

P.O. Box 2088
Santa Fe, New Mexico 87504-2088

DISTRICT I
P.O. Box 1980, Hobbs, NM 88240

DISTRICT II
P.O. Drawer DD, Artesia, NM 88210

DISTRICT III
1000 Rio Brazos Rd., Aztec, NM 87410

WELL LOCATION AND ACREAGE DEDICATION PLAT

All Distances must be from the outer boundaries of the section

JUL 11 1989

Operator Harvey E. Yates Company			Lease Harrison II Pool			Well No.		
Unit Letter A	Section 11	Township 1N 30E	Range 1E	County NM	Dedicated Acreage: 40 Acres			
Actual Footage Location of Well: feet from the North line and feet from the East line								
Ground level Elev. 7500		Producing Formation Bone Springs		Pool Tamano		Dedicated Acreage: 40 Acres		

- Outline the acreage dedicated to the subject well by colored pencil or hatchure marks on the plat below.
- If more than one lease is dedicated to the well, outline each and identify the ownership thereof (both as to working interest and royalty).
- If more than one lease of different ownership is dedicated to the well, have the interest of all owners been consolidated by communitization, unitization, force-pooling, etc.?
☐ Yes ☐ No If answer is "yes" type of consolidation
If answer is "no" list the owners and tract descriptions which have actually been consolidated. (Use reverse side of this form if necessary.)
No allowable will be assigned to the well until all interests have been consolidated (by communitization, unitization, forced-pooling, or otherwise) or until a non-standard unit, eliminating such interest, has been approved by the Division.

HEYCO et al
LC-062052 3754.4

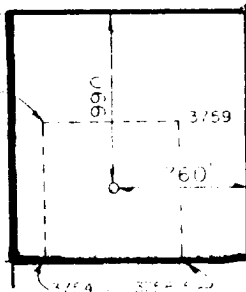

OPERATOR CERTIFICATION

I hereby certify that the information contained herein is true and complete to the best of my knowledge and belief

Signature

Printed Name

NM Young

Position

Drilling Superintendent
Company

Harvey E. Yates Company

Date

July 17, 1989

SURVEYOR CERTIFICATION

I hereby certify that the well location shown on this plat was plotted from field notes of actual surveys made by me or under my supervision, and that the same is true and correct to the best of my knowledge and belief

Date Surveyed

Signature & Seal of
Professional Surveyor

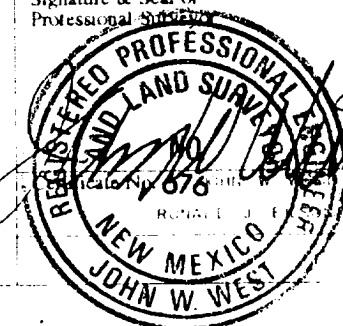

Application

HARVEY E. YATES COMPANY
Hudson 11 Federal #5
Sec. 11, T18S, R31E
Eddy County, New Mexico

In conjunction with Form 3160-3, Application for Permit to Drill the Subject well in Section 11, Township 18 South, Range 31 East, Eddy County, New Mexico, Harvey E. Yates Company submits the following ten items of pertinent information in accordance with Bureau of Land Management requirements:

1. The geologic surface formation is quaternary alluvium and bolson deposits and other surficial deposits.
2. The estimated tops of geologic markers are as follows:

Rustler	830'	Penrose	3625'
Yates	2300'	Grayburg	3907'
Seven Rivers	2720'	San Andres	4290'
Bowers	3150'	Bone Springs	5698'
Queen	3400'	TD	8900'

3. We do not anticipate finding water but have listed the formation in which we anticipate finding oil or gas.

Bone Spring 5698'

4. Proposed casing program: See Form 3160-3. HEYCO will be running some used casing when applicable.
5. Pressure control equipment: See Exhibit C. Although the rig equipment is 3M rated, this well will be a 2M PSI rating.
6. Mud program: See Form 3160-3.
7. Auxiliary equipment: Blowout preventer
8. Testing, logging and coring programs: One possible DST in the Bone Springs. No coring is anticipated. Planned logs are DLL-Micro w/GR & Caliper and CN-DEN w/GR & Caliper.
9. No abnormal pressures or temperatures are anticipated.
10. Anticipated starting date: As soon as possible.

SURFACE USE PLAN

HARVEY E. YATES COMPANY
Hudon 11, Fedal #5
Sec. 11, T18S, R31E
Eddy County, New Mexico

1. EXISTING ROADS:

Exhibit A is a portion of a New Mexico Map showing the location of the proposed well. The location is approximately 35 miles east of Artesia, New Mexico or about 12 miles southeast of Loco Hills, NM. Leave Artesia on U.S. Highway 82 and travel east to the junction of County Road 222. Turn south and travel 3.0 miles. Turn left and go east for 1.1 miles. Turn left and go north .25 miles. Turn right and go east 1.4 miles. Turn right and go south .4 of a mile. Turn left and go east on new lease road to well.

2. PLANNED ACCESS ROADS:

We plan to use the existing roads as far as possible. We will build approximately 1200 ft of new road to reach the proposed location. The running surface will be 14' wide, built with 6" of compacted caliche.

3. LOCATION OF EXISTING WELLS:

Exhibit B is a plat showing existing wells and their locations.

4. LOCATIONS OF TANK BATTERIES, ETC.:

In the event we drill a producing well, all production equipment will be located at this well site.

5. LOCATION AND TYPE OF WATER SUPPLY:

Water will be from commercial sources, either hauled or pipelined.

6. SOURCE OF CONSTRUCTION MATERIAL:

We will use caliche from the reserve pit area to build the road and location.

7. METHODS OF HANDLING WASTE DISPOSAL:

Waste will be buried in reserve pits at a depth of 36". The wellsite will be cleaned of all waste and this will be done within 30 days after completion of the well.

8. ANCILLARY FACILITIES:

None required.

9. WELLSITE LAYOUT:

- A. Exhibit D shows the relative location and dimensions of the well pad, reserve pits and major rig components.
- B. The land is relatively flat with sandy soil and sand dunes.
- C. The pad and pit area have been staked.

10. PLANS FOR RESTORATION OF THE SURFACE:

- A. After finishing drilling and/or other completion operations, all equipment and other materials not needed for further operations will be removed. Pits will be filled and the location cleaned of all trash and junk to leave the wellsite as pleasant in appearance as possible.
- B. If the proposed well is non-productive, all restoration and/or vegetation requirements of the Bureau of Land Management will be complied with and will be accomplished as quickly as possible. All pits will be filled and levelled within 90 days after abandonment.

11. OTHER INFORMATION:

- A. The surface and minerals are Federal land.
- B. The topography consists of sandy soil with native grasses, catclaw, etc. No wildlife was observed, but the usual inhabitants of this region are jackrabbits, reptiles, coyotes, etc.
- C. There are no ponds, lakes, streams or rivers in this area.
- D. An Archaeological Survey has been made and copy has been sent to your Carlsbad office. There is no evidence of any significant archaeological, historical or cultural sites in the area. Also, there are no occupied dwellings or windmills.

12. OPERATOR'S REPRESENTATIVES:

The field representatives responsible for assuring compliance with the approved surface use and operations plan are:

Micky Young
Harvey E. Yates Company
P. O. Box 1933
Roswell, New Mexico 88201
Office: 505/623-6601
Mobil: 505/624-1818 #840

Curtis Tolle
Harvey E. Yates Company
P. O. Box 1933
Roswell, New Mexico 88201
Office: 505/748-2435
Mobil: 505/624-1818 #837

13. CERTIFICATION:

I hereby certify that I, or persons under my direct supervision, have inspected the proposed drill site and access route; that I am familiar with the conditions which currently exist; that the statements made in this plan are, to the best of my knowledge, true and correct; and that the work associated with operations proposed herein will be performed by Harvey E. Yates Company and its contractors and subcontractors in conformity with this plan and the terms and conditions under which it is approved. This statement is subject to the provisions of 18 U.S.C. 1001 for the filing of a false statement.

July 17, 1989



N.M. Young
Drilling Superintendent

EXHIBIT A

Harvey E. Yates Co.
Hudson 11 Federal #35
990' FNL & 760' FEL
Sec. 11 T-18S R-31E
Eddy Co., New Mexico

Map showing the location of the Harvey E. Yates Co., Hudson 11 Federal Well No. 5
Section 11, Centre, South 1/2, NE/4NE/4 [990' FNL, 760' FEL], Eddy County, New Mexico. Open square
shows location of well pad;
MALJAMAR, NEW MEXICO, 1985.

ASC Project: 87-56.

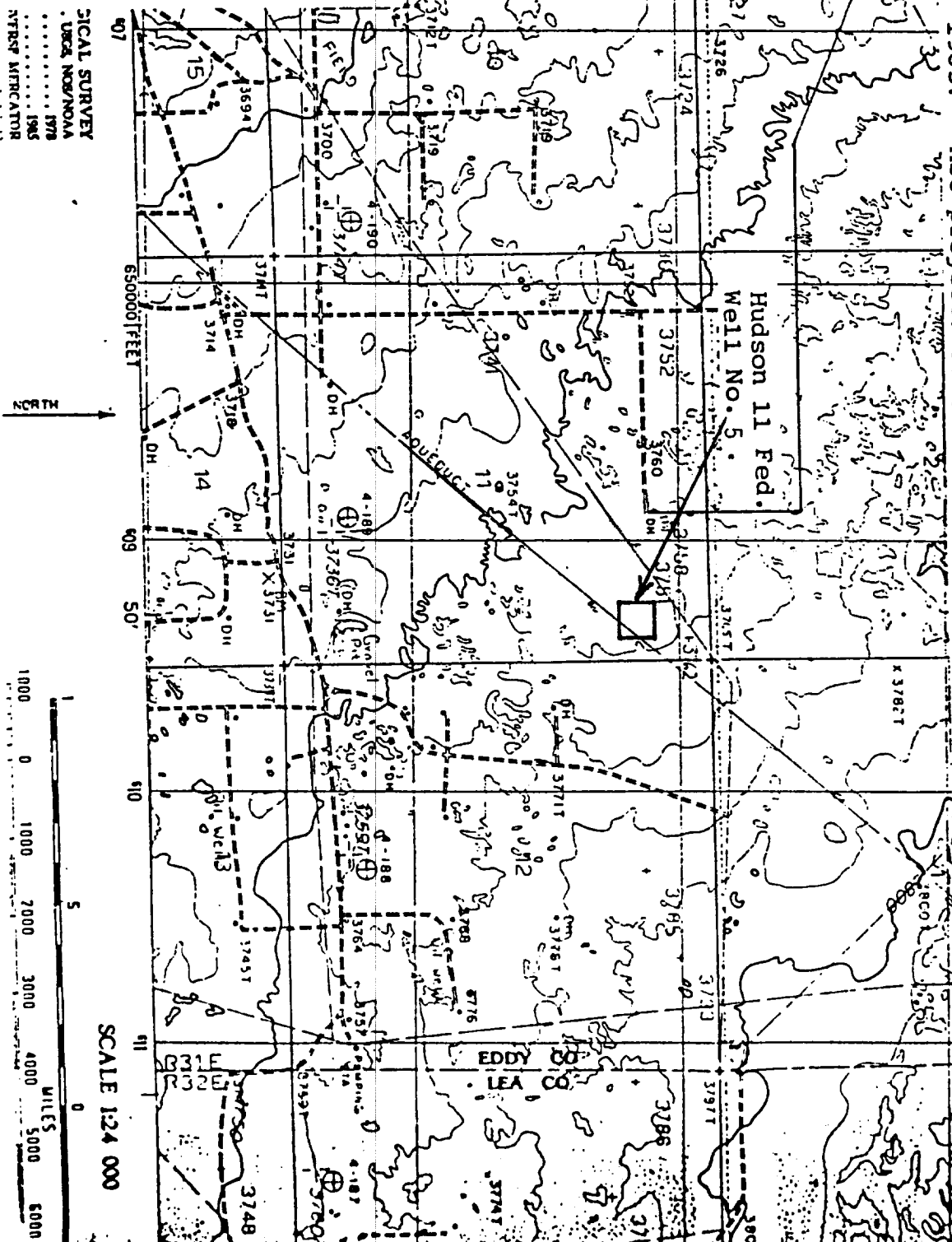

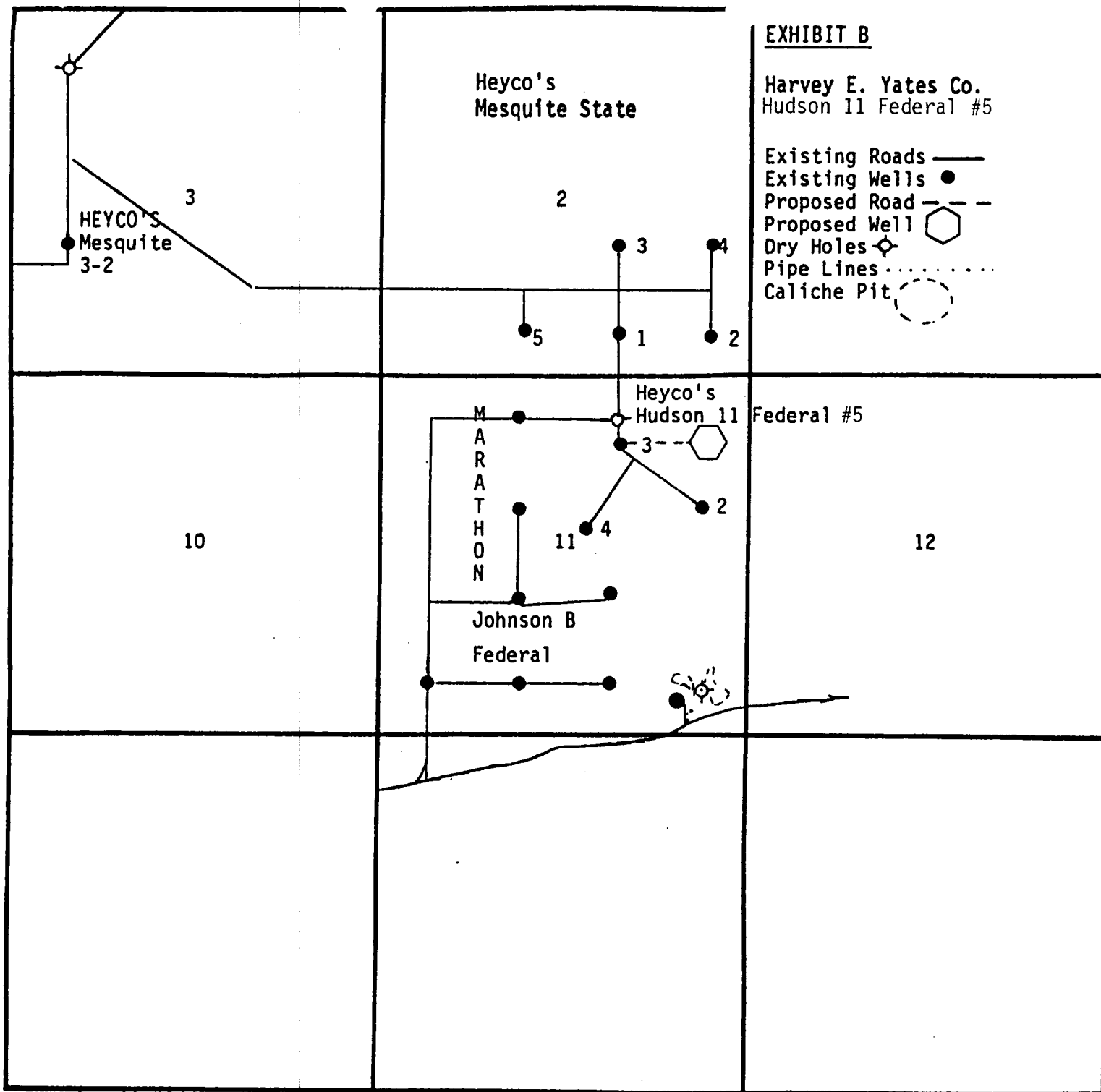

SECTION 11 TOWNSHIP 18 S RANGE 31 E

COUNTY Eddy STATE New Mexico

EXHIBIT C

Hudson 11 Federal #5
990' FNL & 760' FEL
Sec. 11 T-18s R-31E
Eddy Co., New Mexico

900 Series

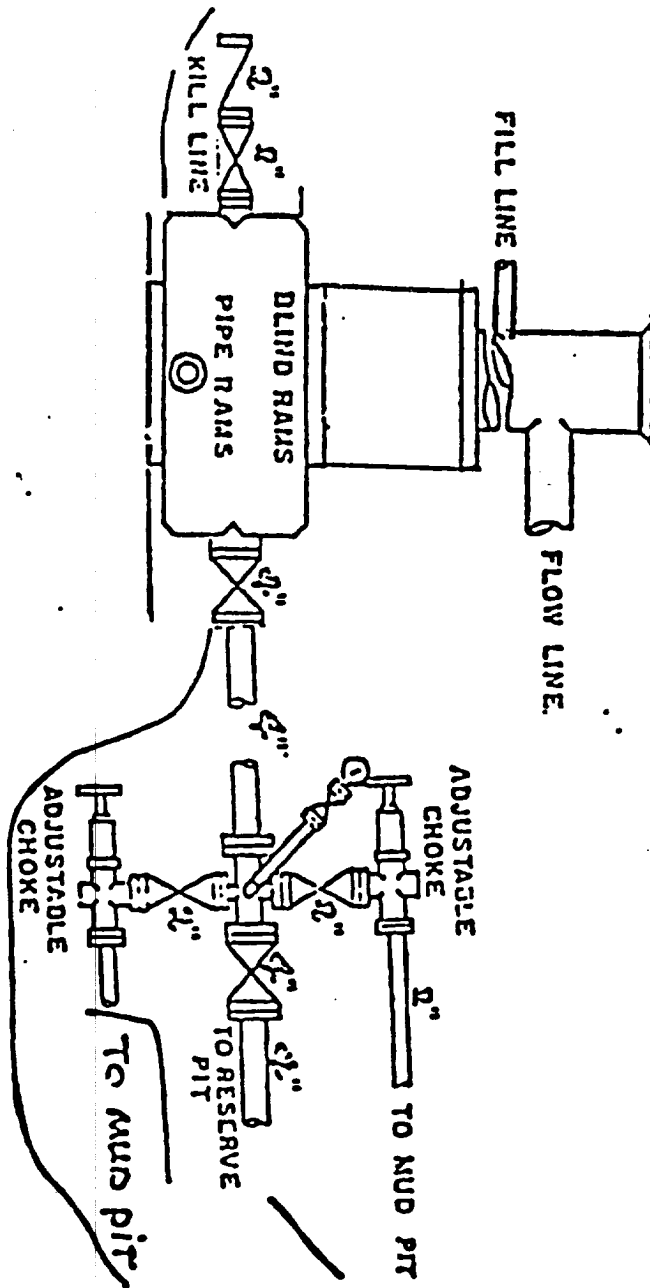

EXHIBIT D

Harvey E. Yates Co.
Hudson 11 Federal #5
990' FNL & 760' FEL
Sec. 11 T-18S R-31E
Eddy Co., New Mexico

