

Submit to Appropriate  
District Office  
State Lease - 6 copies  
Fee Lease - 5 copies

State of New Mexico  
Energy, Minerals and Natural Resources Department

Form C-101  
Revised 1-1-89

OIL CONSERVATION DIVISION

DISTRICT I  
P.O. Box 1980, Hobbs, NM 88240

DISTRICT II  
P.O. Drawer DD, Artesia, NM 88210

DISTRICT III  
1000 Rio Brazos Rd., Aztec, NM 87410

P.O. Box 800  
Santa Fe, New Mexico 87504-2088

MAR 15 '90

API NO. (assigned by OCD on New Wells)

30-015-26306

5. Indicate Type of Lease

STATE ☒

FEE ☐

6. State Oil & Gas Lease No.

6-2634

APPLICATION FOR PERMIT TO DRILL, DEEPEN, OR PLUG BACK

1a. Type of Work:

ARTESIA, OFFICE

DRILL ☒

RE-ENTER ☐

DEEPEN ☐

PLUG BACK ☐

b. Type of Well:

OIL

WELL ☒

GAS

WELL ☐

OTHER ☐

SINGLE

ZONE ☒

MULTIPLE

ZONE ☒

7. Lease Name or Unit Agreement Name

Schoonmaker State

8. Well No.

3

9. Pool name or Wildcat

Turkey Track, 7R, QN, GB, S.A.

2. Name of Operator

Aceco Petroleum

3. Address of Operator

2106 Richey, Artesia, New Mexico 88210

4. Well Location

Unit Letter K : 1760 Feet From The South Line and 1760 Feet From The West Line

Section 12 Township 19 South, Range 29 East NMPM Eddy County

10. Proposed Depth

3,000

11. Formation

SR, QN, GB, SA

12. Rotary or C.T.

Cable Tool

13. Elevations (Show whether DF, RT, GR, etc.)

3,378

14. Kind & Status Plug Bond

State Wide

15. Drilling Contractor

Vintage Drlg. Co.

16. Approx. Date Work will start

Immediately

17.

PROPOSED CASING AND CEMENT PROGRAM

SIZE OF HOLE	SIZE OF CASING	WEIGHT PER FOOT	SETTING DEPTH	SACKS OF CEMENT	EST. TOP
15"	10 3/4"	34	300	Circulated	
10"	7"	26	1950	Circulated	
6 1/2"	4 1/2"	9.5	3000	Circulated	

We propose to drill a Seven Rivers, Queens, Grayburg, San Andres well with approximately 300 ft. 10 3/4" casing to shut off surface water with cement circulated. Will set approximately 1950 ft. 7" Intermediate casing with cement circulated to seal off salt and possible water. Will run 4 1/2" casing and circulate with cement for oil string.

Part ID-1  
3-23-90  
New Line + API

APPROVAL VALID FOR 180 DAYS

PERMIT EXPIRES 9/16/90

UNLESS DRILLING UNDERWAY

IN ABOVE SPACE DESCRIBE PROPOSED PROGRAM: IF PROPOSAL IS TO DEEPEN OR PLUG BACK, GIVE DATA ON PRESENT PRODUCTIVE ZONE AND PROPOSED NEW PRODUCTIVE ZONE. GIVE BLOWOUT PREVENTER PROGRAM, IF ANY.

I hereby certify that the information above is true and complete to the best of my knowledge and belief.

SIGNATURE

*Harold D. Parrish Sr.*

TITLE

Partner

DATE 3-14-90

TYPE OR PRINT NAME

Aceco Petroleum - Harold D. Parrish, Sr.

Dwane Parrish -746-4651

TELEPHONE NO. 746-5156

(This space for State Use)

ORIGINAL SIGNED BY

MIKE WILLIAMS

SUPERVISOR, DISTRICT II

APPROVED BY

TITLE

DATE

MAR 16 1990

CONDITIONS OF APPROVAL, IF ANY:

103 1/4 + 17"

**NEW MEXICO OIL CONSERVATION COMMISSION  
WELL LOCATION AND ACREAGE DEDICATION PLAT**

Form C-102  
Supersedes C-128  
Effective 1-1-65

All distances must be from the outer boundaries of the Section.

Operator <b>ACECO PETROLEUM</b>			Lease <b>Schoonmaker State</b>		Well No. <b>3</b>
Unit Letter <b>"K"</b>	Section <b>12</b>	Township <b>19 South</b>	Range <b>29 East</b>	County <b>Eddy</b>	
Actual Footage Location of Well: <b>1760</b> feet from the <b>South</b> line and <b>1760</b> feet from the <b>West</b> line					
Ground Level Elev. <b>3378.0</b>	Producing Formation <b>S.A., QNS, GRB.</b>		Pool <b>Turkey Tract</b>		Dedicated Acreage: <b>40</b> Acres

1. Outline the acreage dedicated to the subject well by colored pencil or hachure marks on the plat below.
2. If more than one lease is dedicated to the well, outline each and identify the ownership thereof (both as to working interest and royalty).
3. If more than one lease of different ownership is dedicated to the well, have the interests of all owners been consolidated by communitization, unitization, force-pooling, etc?

☐ Yes ☐ No . If answer is "yes," type of consolidation \_\_\_\_\_

If answer is "no," list the owners and tract descriptions which have actually been consolidated. (Use reverse side of this form if necessary.) \_\_\_\_\_

No allowable will be assigned to the well until all interests have been consolidated (by communitization, unitization, forced-pooling, or otherwise) or until a non-standard unit, eliminating such interests, has been approved by the Commission.

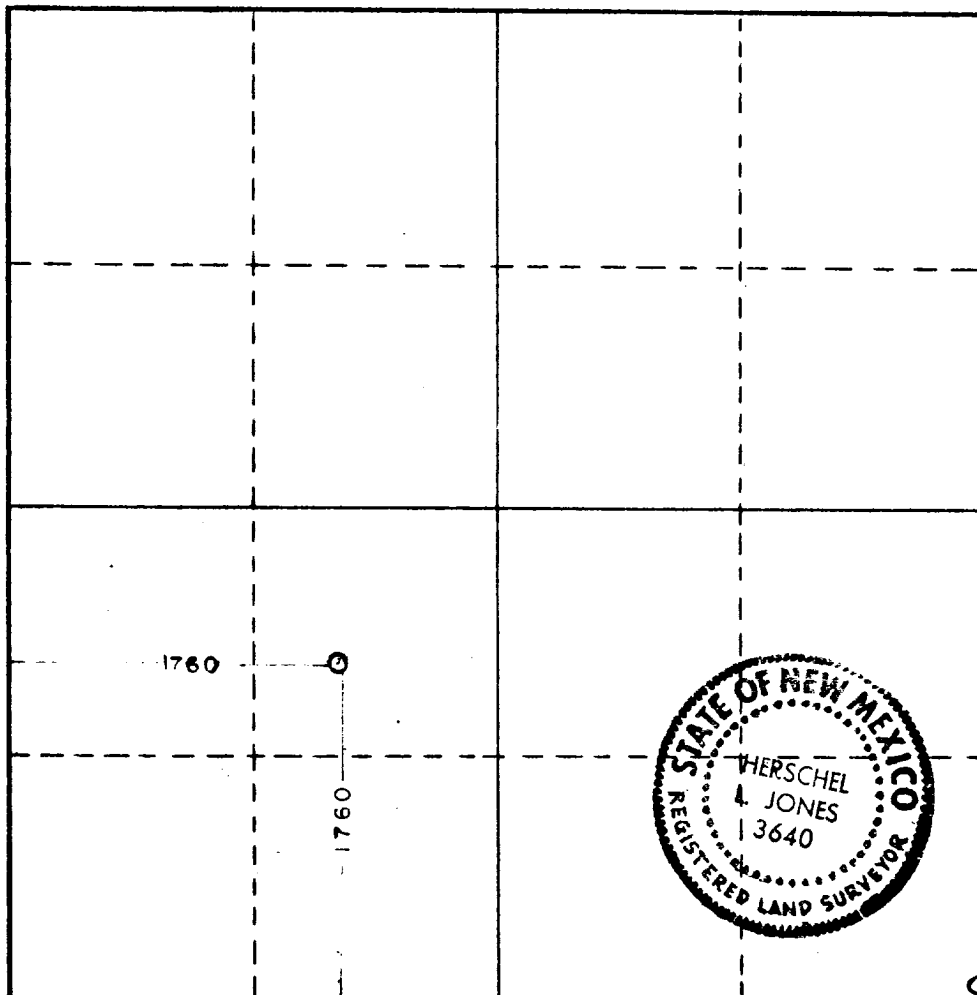

**CERTIFICATION**

I hereby certify that the information contained herein is true and complete to the best of my knowledge and belief.

*Harold D. Parrish, Sr.*

Name

**Harold D. Parrish, Sr.**

Position

**Partner**

Company

**ACECO PETROLEUM**

Date

**February 17, 1990**

I hereby certify that the well location shown on this plat was plotted from field notes of actual surveys made by me or under my supervision, and that the same is true and correct to the best of my knowledge and belief.

Date Surveyed

**July 29, 1989**

Registered Professional Engineer and/or Land Surveyor

*Herschel A. Jones*

Certificate No.

**3640**

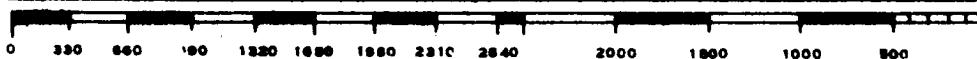

MAX Potash Corp.  
Box 279  
Artsbad, NM 88220

March 7, 1990

To Whom It May Concern :

MAX Potash Corporation will not object to a drilling located  
1,760' FSL, 1,760' FWL in Section 12, T19S, R29E.

Robert F. Kirby  
  
Chief Mine Engineer  
MAX Potash Corp.

Silberman ST 53

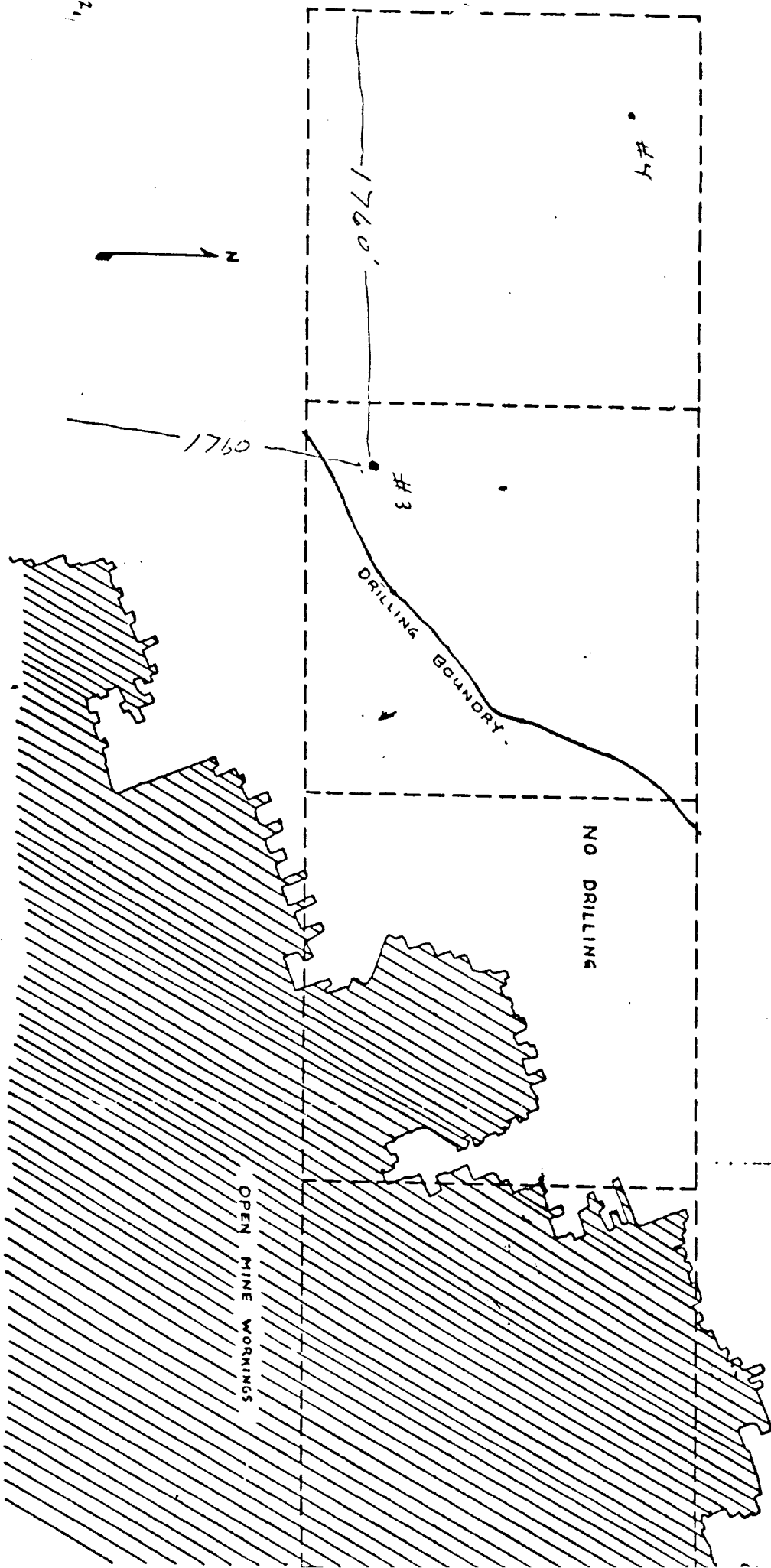

AMAX POTASH CORP.  
CARLSBAD, NM  
DRILLING BOUNDARY  
N ½, S ½, SECT. 12, T 19S, R 29E, NMPM  
DRWN.: 11-11-88 RFK  
SCALE: 1"=500'