

PROPOSED WELL PLAN OUTLINE

WELL NAME: Dagger Draw No. 9

COUNTY: Eddy STATE: NM

LOCATION: 1980' FNL & 660' FWL

EST. KB: 3602'

Section 30, T19S, R25E

EST. GL: 3587'

DEPTH	FORMATION TOPS & TYPE	DRILLING PROBLEMS	TYPE OF FORMATION EVALUATION	HOLE SIZE	CASING SIZE-DEPTH	FRAC GRAD	FORM PRESS GRAD	(PPG) MUD WT & TYPE	DAYS
1000	Surface water 300'	Possible waterflow to 900'	0'-1200' Deviation survey each 250' not to exceed 3°	14 3/4"				Spud 8.33	
2000	Glorieta 1989'	Known lost circulation from 0-1100'	Install H2S monitor @1200'	12 1/4"	9-5/8 @1200'		<8.33	Cut Brine 8.8- 9.2	4
3000	Yeso 2145'	H2S poss. to TD	Install a 2- man mudlogger 1200' - TD 1200'-3000'		w/2000 sx "lite" & "C" (to protect from surface waterflows and severe lost circ.)				6
4000	Abo 4198'	Deviations from 4-6° likely from 3000'-6000' (ZW#1 & Parish IV #1)	Deviation survey each 250' not to exceed 5° 3000'-6000' Deviation survey each 100' - 150' not to exceed 5°					pH>10 to TD	8 10
5000	Wolfcamp 5100'				DV Tool above lower Abo LC zone (if nec.) 4500'				13
6000			6000'-TD Deviation survey each 250' not to exceed 5°						17
7000	Cisco 7600'	H2S possible in Cisco						Mud up with salt gel and starch @7500'	20
8000	Target TD 8100'			8-3/4"					
9000			GR-CNL-LDT- DLL-MSFL-CAL from 8100' - 1200'		7" @8100'	>15	8.3- 9.0		25
10000			Image Log from 8100'-7600'		w/2100 sx "H" & "C" lite				

ATTACHMENT TO FORM 9-331 C
APPLICATION FOR PERMIT TO DRILL

Conoco Inc.

Lease/Well:	Dagger Draw No. 9
Location:	Sec. 30, T-19S, R-25E 1980' FNL & 660' FWL
County:	Eddy County, New Mexico

1. The estimated tops of important geologic markers are shown on the attached Proposed Well Plan Outline.
2. The estimated depths at which anticipated water, oil, gas or other mineral-bearing formations to be encountered are shown on the attached Proposed Well Plan Outline.
3. A drawing of an API Series 900 Blowout Preventer Specification is attached. Pipe rams and blinds will be checked to the working pressure of the stack or 70% of the minimum internal yield strength of the casing whichever is less. BOPE will be checked when casing string is set.
4. The proposed casing program is as follows:

0'-1200': 9-5/8", 36#, K-55
0'-8100': 7", 26#, K-55
5. The proposed mud program is as follows:

0'-1200': 8.33# Fresh Water
1200'-7300': 8.8-9.2# Brine
7300'-8100': 8.8-9.2# Salt Gel
6. Run open-hole logs from 1200'-TD. The log suite will include the following:
1) GR-CNL-LDT-CAL, 2) GR-DLL-MSFL. A temperature survey will be run to determine the top of cement on each casing string where cement is not circulated.
7. Possible concentrations of H₂S in excess of 50 ppm from 1200' - TD.
8. The anticipated starting date is 10-01-90 with a duration of approximately 20 days.

**SURFACE USE PLAN
Conoco Inc.**

Barbara Federal No. 10

The following is the required information concerning the possible effect which the proposed drilling of this well may have on the environment, existing road sites, and surrounding acreage. A copy will be posted on the derrick floor so all contractors and sub-contractors will be aware of all items of this plan.

1. Existing Roads

- A. The proposed well site is 1650' FNL & 660' FWL, Section 17, T-19S, R-25E, Eddy County, New Mexico.
- B. Exhibit "A" is a portion of a New Mexico road map showing existing roads. Directions to the location are as follows:
From the junction of U.S. 285 and 82 go South on U.S. 285 13.1 miles. Turn West on County Road 21 and go 7.1 miles. Turn North through cattleguard and go .4 miles. Bear left at fork in road and go .2 miles. Turn right and go .2 miles to location.
- C. Access roads are shown on Exhibits "A" and "B".
- D. The last .2 mile of lease road will be improved.

2. Planned Access Roads

- A. None
- B. No turnout will be required.
- C. No culverts, or fills will be required.
- D. No gates, cattleguards, or fences will be required.

3. Location of Existing Wells

See Exhibit "B".

4. Location of Proposed Facilities if Well is Productive

Existing producing facilities are shown on Exhibit "B".

5. Water Supply

Water will be trucked in.

6. Source of Construction Materials

Caliche from pit located in SW/4 of SW/4, Sec. 17, T-19S, R-25E

7. Methods of Handling Waste Disposal

Well cuttings will be disposed in reserve pit. Barrel trash containers to be in accessible locations within drill site area during drilling and completion procedures. All detrimental waste will be hauled away, burned or buried with a minimum cover of 24" of dirt. See Exhibit "C" for location of pits. If well is productive, maintenance waste will be placed in special trash cans and hauled away periodically. Any produced water will be collected in tanks until hauled to an approved disposal system, or separate disposal applications will be submitted to survey for appropriate approval.

8. Ancillary Facilities

None.

9. Wellsite Layout

See Exhibit "C". The reserve pit will be lined with plastic. The pad and pits are staked.

10. Plans for Restoration of Surface

Pits will be backfilled and leveled as soon as practical to original condition. Commencement of rehabilitation operations will immediately follow removal of drilling and completion equipment from location and rehabilitation of the surface is planned to be completed within 45 days from commencement.

11. Surface Ownership

Federal

12. Other Information

An archaeological survey has been completed and filed by Pecos Archaeological Consultants.

13. Operator's Representative and Certification

Personnel who can be contacted concerning compliance of this Surface Use Plan are as follows:

**Gary L. Smith
10 Desta Drive West
Midland, Texas 79705
(915)686-5471**

I hereby certify that I, or persons under my direct supervision, have inspected the proposed drilling site; that I am familiar with the conditions which currently exist; that the statements made in this plan, are, to the best of my knowledge, true and correct; and that the work associated with operations proposed herein will be performed by Conoco Inc. and its contractors and subcontractors in conformity with this plan and the terms and conditions under which it is approved. This statement is subject to the provisions of 18 U.S.C. 1001 for the filing of a false statement.

8/27/90
Date

Gary L. Smith
Gary L. Smith
Drilling Superintendent

JWH/tm

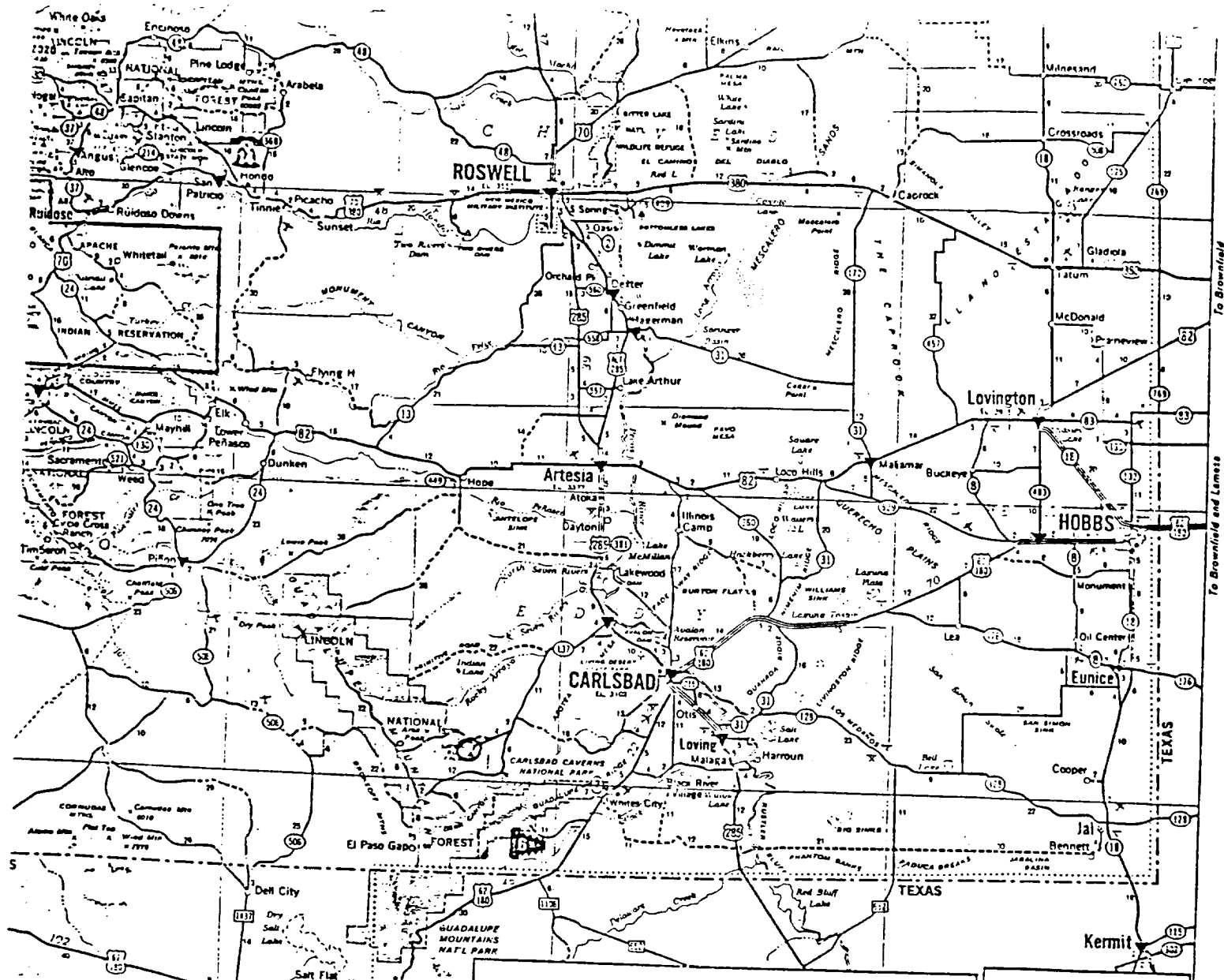

LOCATIONS WHERE CONOCO PRODUCTS ARE SOLD

- ▼ Locations on Interstate Highways, toll roads or major limited access highways where CONOCO PRODUCTS are sold.
- ▼ Other CONOCO station locations.
- ▼ Locations of CONOCO Travel Shoppes.



- ▼ Locations where CONOCO DEALERS provide Trailer Travelers with Sanitary Disposal Facilities. Look for this sign:



TOURAIDE ATTRACTIONS

- HISTORICAL
- SCENIC
- GENERAL

Attraction points described on reverse side

NEW MEXICO

SCALE IN MILES AND KILOMETERS
ONE INCH 22 MILES 0 5 10 20 30
ONE INCH 35 KILOMETERS 0 5 10 20 30 40

HIGHWAY MARKERS

INTERSTATE (I) UNITED STATES (55) STATE (41) TEXAS (139)

ROAD CLASSIFICATIONS

CONTROLLED ACCESS DIVIDED HIGHWAYS

OTHER DIVIDED HIGHWAYS

PRINCIPAL THROUGH HIGHWAYS

OTHER THROUGH HIGHWAYS

CONNECTING HIGHWAYS

LOCAL ROADS IN UNINCORPORATED AREAS INCLUDE NECESSARY

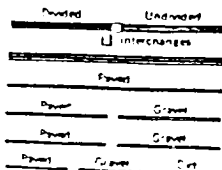

MILEAGES

MILEAGE BETWEEN TOWNS AND JUNCTIONS LONG DISTANCE MILEAGES SHOWN IN RED

ONE MILE EQUALS 1.6 KILOMETERS ONE KILOMETER EQUALS .6 MILES

SPECIAL FEATURES

- STATE PARKS
- RECREATION AREAS
- PORTS OF ENTRY
- POINTS OF INTEREST
- SCHEDULED AIRLINE STOPS
- MILITARY AIRPORTS
- OTHER AIRPORTS
- TOURIST INFORMATION
- SKI AREAS
- SELECTED REST AREAS
- BOAT RAMPS
- TIME ZONE BOUNDARY

POPULATION SYMBOLS

- State Capital
- Under 1,000
- 1,000 to 2,500
- 2,500 to 5,000
- 5,000 to 10,000
- 10,000 to 25,000
- 25,000 to 50,000
- 50,000 to 100,000
- 100,000 and over

© 1974 by THE M. J. COLEMAN COMPANY ALL RIGHTS RESERVED

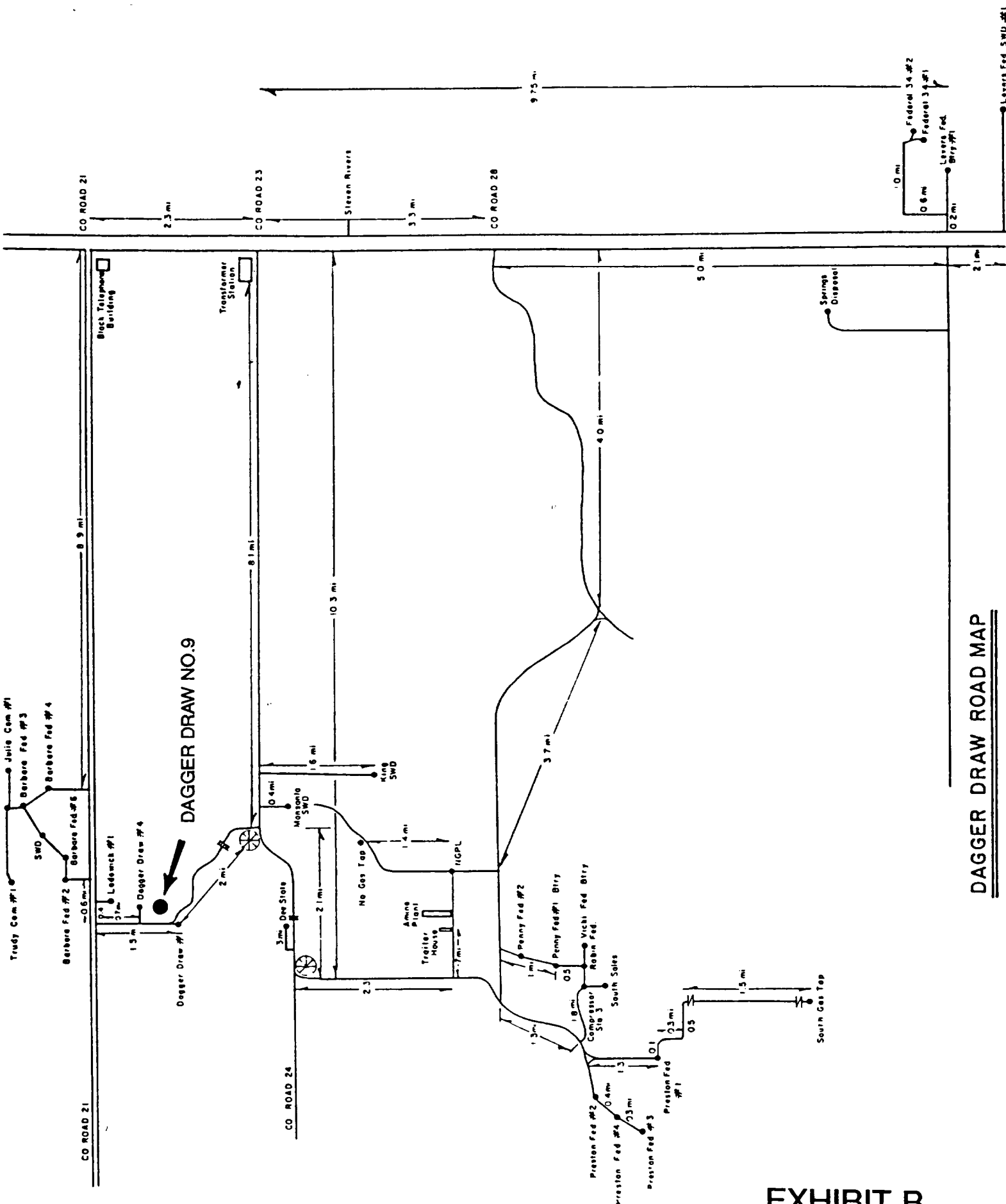

DAGGER DRAW ROAD MAP

EXHIBIT B

SECTIONS 30 & 19, TOWNSHIP 19 SOUTH, RANGE 25 EAST, N. M. P. M.,
EDDY COUNTY, NEW MEXICO

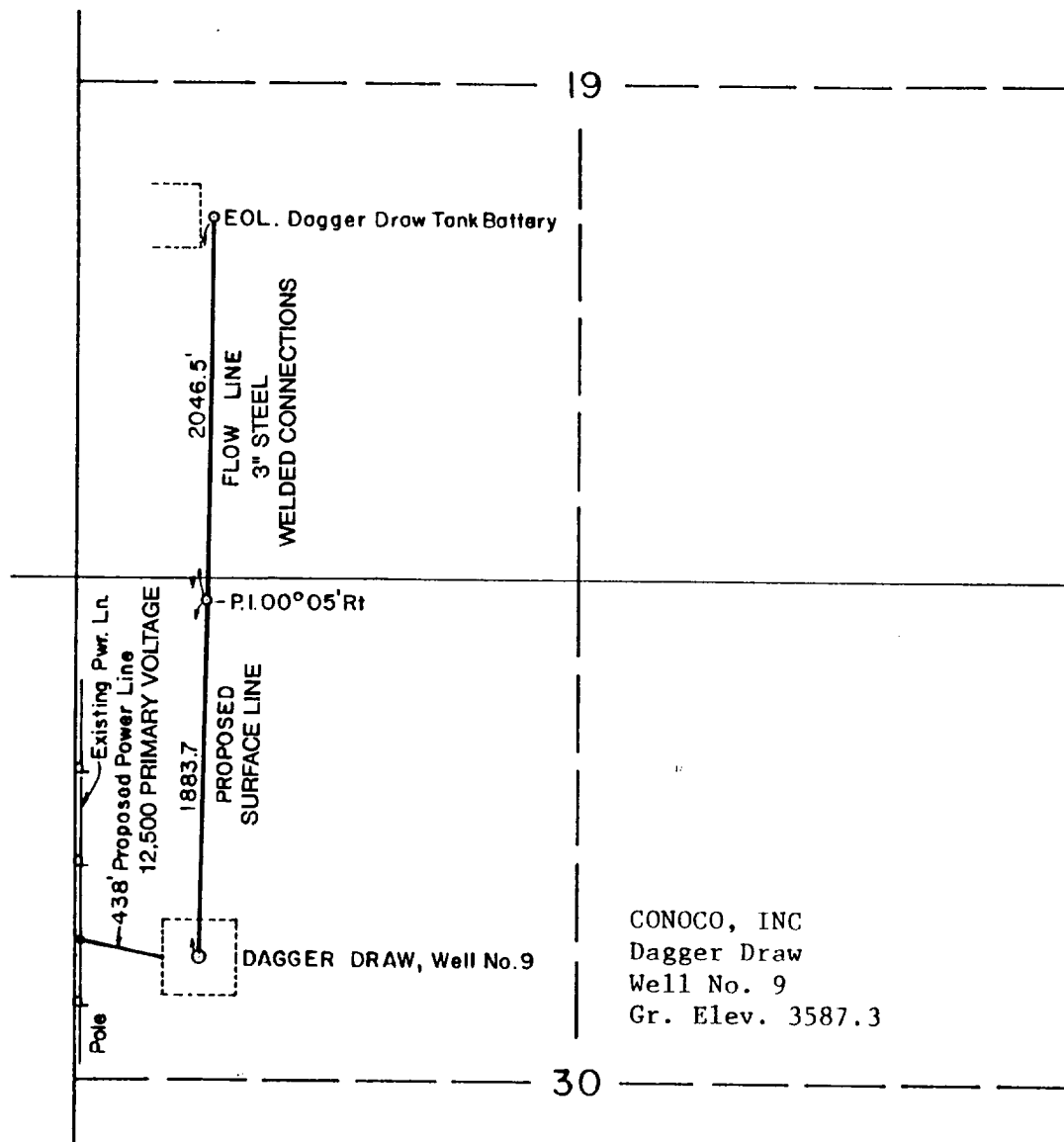

CONOCO, INC
Dagger Draw
Well No. 9
Gr. Elev. 3587.3

I HEREBY CERTIFY THAT THIS PLAT
WAS MADE FROM NOTES TAKEN IN THE FIELD
IN A BONA FIDE SURVEY MADE UNDER MY
SUPERVISION, AND THAT THE SAME IS TRUE
AND CORRECT TO THE BEST OF MY KNOWL-
EDGE AND BELIEF.

John W. West

JOHN W. WEST, N.M. P.E. & L.S. No. 676
TEXAS R.P.S. No. 1138
RONALD J. EIDSON, N.M. L.S. No. 3239
TEXAS R.P.S. No. 1883

CONOCO, INC.

A proposed Powerline and Flowline located in
Section 30 & 19, Township 19 South, Range 25
East, N.M.P.M., Eddy County, New Mexico.

JOHN W. WEST ENGINEERING COMPANY
CONSULTING ENGINEERS HOBBS, NEW MEXICO

Scale: 1"=1000'

Drawn By: Presley

Date: 8/13/90

Ck. *CS*

Sheet 1 of 1 Sheets

EXHIBIT B.1

DAGGER DRAW NO. 9 RIG LAYOUT

