

Submit 3 Copies
to Appropriate
District Office

State of New Mexico
Energy, Minerals and Natural Resources Department

Form C-103
Revised 1-1-89

DISTRICT I
P.O. Box 1980, Hobbs, NM 88240

DISTRICT II
P.O. Drawer DD, Artesia, NM 88210

DISTRICT III
1000 Rio Brazos Rd., Aztec, NM 87410

OIL CONSERVATION DIVISION
P.O. Box 2088
Santa Fe, New Mexico 87504-2088

WELL API NO.
30-015-26498

5. Indicate Type of Lease
STATE ☐ FEE ☒

6. State Oil & Gas Lease No.

JAN 10 '91

SUNDRY NOTICES AND REPORTS ON WELLS
(DO NOT USE THIS FORM FOR PROPOSALS TO DRILL OR TO DEEPEN OR PLUG BACK TO A
DIFFERENT RESERVOIR. USE "APPLICATION FOR PERMIT" (FORM C-101) FOR SUCH PROPOSALS.)

1. Type of Well:
OIL WELL ☐ GAS WELL ☒ OTHER

2. Name of Operator
YATES PETROLEUM CORPORATION (505) 748-1471

3. Address of Operator
105 South 4th St., Artesia, New Mexico 88210

7. Lease Name or Unit Agreement Name

Winston All

8. Well No.
1

9. Pool name or Wildcat
Undes. Boyd Morrow Gas

4. Well Location
Unit Letter E : 1980 Feet From The North Line and 660 Feet From The West Line
Section 14 Township 19S Range 24E NMPM Eddy County

10. Elevation (Show whether DF, RKB, RT, GR, etc.)
3657' GR

11. Check Appropriate Box to Indicate Nature of Notice, Report, or Other Data

NOTICE OF INTENTION TO:

PERFORM REMEDIAL WORK ☐ PLUG AND ABANDON ☐
TEMPORARILY ABANDON ☐ CHANGE PLANS ☐
PULL OR ALTER CASING ☐

OTHER: Request permission to produce well pending NSL approval. ☒

SUBSEQUENT REPORT OF:

REMEDIAL WORK ☐ ALTERING CASING ☐
COMMENCE DRILLING OPNS. ☐ PLUG AND ABANDONMENT ☐
CASING TEST AND CEMENT JOB ☐

OTHER: ☐

12. Describe Proposed or Completed Operations (Clearly state all pertinent details, and give pertinent dates, including estimated date of starting any proposed work) SEE RULE 1103.

1-9-91. Well is unorthodox location for Morrow completion. A hearing has been set for January 24, 1991 in Santa Fe, 1991 for NSL approval. Well was frac'd 1-8-91. Verbal permission obtained from Mike Williams, Supervisor, NMOCD, Artesia, NM to connect well to pipeline 1-10-91 to get well cleaned up and not leave frac water in well. If NSL is not approved at hearing on January 24th, will shut well in.

Perforations open: 8658-8710' Morrow.

I hereby certify that the information above is true and complete to the best of my knowledge and belief.

SIGNATURE: Juanita Goodlett TITLE: Production Supervisor DATE: 1-9-91
TYPE OR PRINT NAME: Juanita Goodlett TELEPHONE NO.: 505/748-1471

(This space for State Use)

ORIGINAL SIGNED BY
MIKE WILLIAMS
SUPERVISOR, DISTRICT II

JAN 15 1991

APPROVED BY: _____ TITLE: _____ DATE: _____

CONDITIONS OF APPROVAL, IF ANY:

Submit to Appropriate
District Office
State Lease - 4 copies
Fee Lease - 3 copies

State of New Mexico
Energy, Minerals and Natural Resources Department

RECEIVED

Form C-102
Revised 1-1-89

OIL CONSERVATION DIVISION

P.O. Box 2088
Santa Fe, New Mexico 87504-2088

JAN 10 1991

DISTRICT I
P.O. Box 1980, Hobbs, NM 88240

DISTRICT II
P.O. Drawer DD, Artesia, NM 88210

DISTRICT III
1000 Rio Brazos Rd., Aztec, NM 87410

WELL LOCATION AND ACREAGE DEDICATION PLAT

All Distances must be from the outer boundaries of the section

O. C. D.
ARTESIA, OFFICE

Operator YATES PETROLEUM CORPORATION			Lease Winston All		Well No. 1
Unit Letter E	Section 14	Township 19 South	Range 24 East	County NMPM	Eddy
Actual Footage Location of Well: 1980 feet from the North line and 660 feet from the East line					
Ground level Elev. 3657'	Producing Formation Morrow		Pool Undes. Boyd Morrow Gas		Dedicated Acreage: 320 Acres

1. Outline the acreage dedicated to the subject well by colored pencil or hatchure marks on the plat below.

2. If more than one lease is dedicated to the well, outline each and identify the ownership thereof (both as to working interest and royalty).

3. If more than one lease of different ownership is dedicated to the well, have the interest of all owners been consolidated by communitization, unitization, force-pooling, etc.?

☐ Yes ☐ No If answer is "yes" type of consolidation

If answer is "no" list the owners and tract descriptions which have actually been consolidated. (Use reverse side of this form if necessary.)

No allowable will be assigned to the well until all interests have been consolidated (by communitization, unitization, forced-pooling, or otherwise) or until a non-standard unit, eliminating such interest, has been approved by the Division.

OPERATOR CERTIFICATION

I hereby certify that the information contained herein in true and complete to the best of my knowledge and belief.

Signature

Printed Name

JUANITA GOODLETT

Position

PRODUCTION SUPERVISOR

Company

YATES PETROLEUM CORPORATION

Date

1-9-91

SURVEYOR CERTIFICATION

I hereby certify that the well location shown on this plat was plotted from field notes of actual surveys made by me or under my supervision, and that the same is true and correct to the best of my knowledge and belief.

Date Surveyed

Refer to original plat

Signature & Seal of dated 10-13-90
Professional Surveyor

Certificate No.

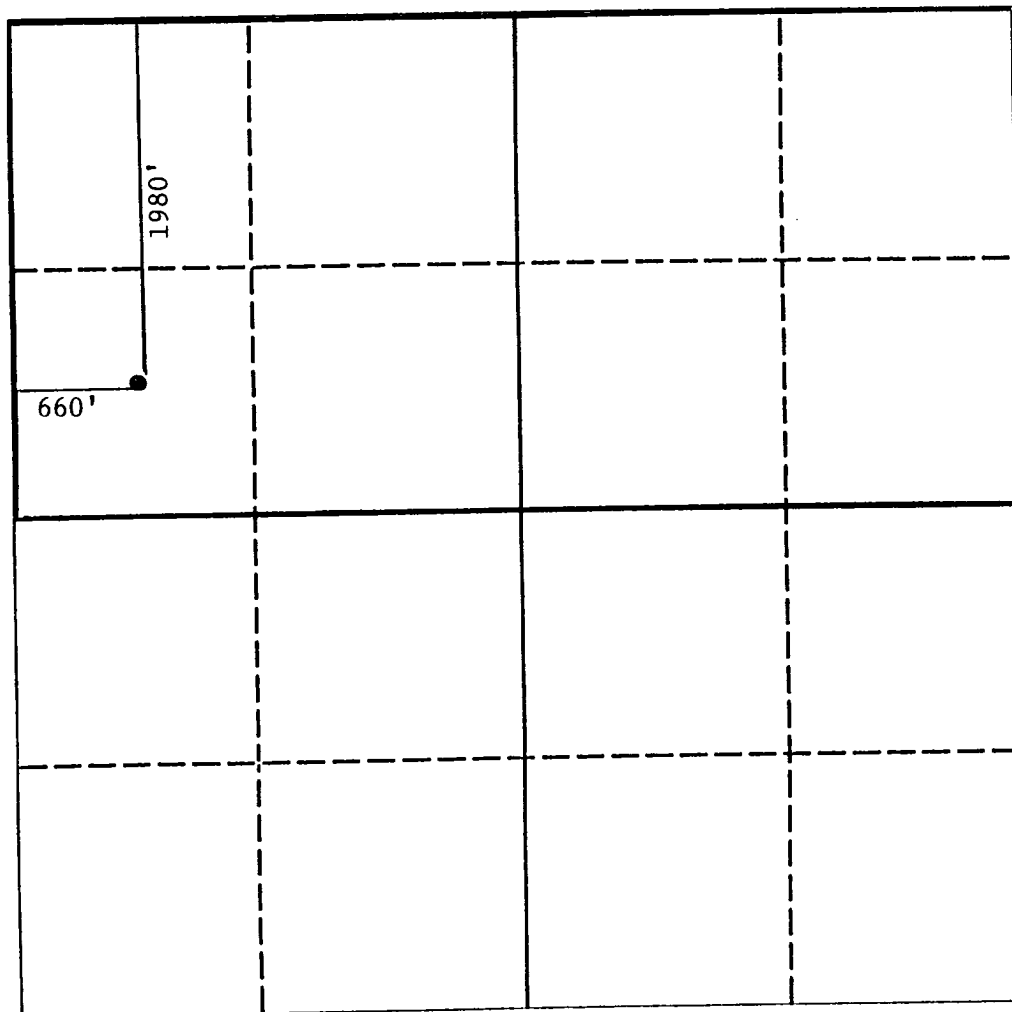

0 330 660 990 1320 1650 1980 2310 2640 2000 1500 1000 500 0