

DISTRICT I
P. O. Box 1980
Hobbs, NM 88240

OIL CONSERVATION DIVISION
P. O. Box 2088
Santa Fe, New Mexico 87504-2088

DISTRICT II
P. O. Drawer DD
Artesia, NM 88210

DISTRICT III
1000 Rio Brazos Rd
Aztec, NM 87410

WELL LOCATION AND ACREAGE DEDICATION PLAT
All distances must be from the outer boundaries of the section

Operator DAVID H. ARRINGTON OIL & GAS, INC.			Lease ARRINGTON FEDERAL		Well No. 1
Unit Letter C	Section 14	Township 19-SOUTH	Range 31-EAST	NMPM	EDDY COUNTY
Actual Footage Location of Well 330 feet from the NORTH line and 2310 feet from the WEST line					
Ground Level Elev. 3559'	Producing Formation Seven Rivers		Pool Shugart Y, 7R, Q, G		40 Acres

1. Outline the acreage dedicated to the subject well by colored pencil or hachure marks on the plat below.
2. If more than one lease is dedicated to the well, outline each and identify the ownership thereof (both as to working interest and royalty).
3. If more than one lease of different ownership is dedicated to the well, have the interest of all the owners been consolidated by communitization, unitization, forced-pooling, etc.?
☐ Yes ☐ No If answer is "yes", type of consolidation _____
If the answer is "no", list the owners and tract descriptions which have actually been consolidated. (Use the reverse side of this form if necessary.) _____
No allowable will be assigned to the well until all interests have been consolidated (by communitization, unitization, forced-pooling, or otherwise) or until a non-standard unit, eliminating such interest, has been approved by the division.

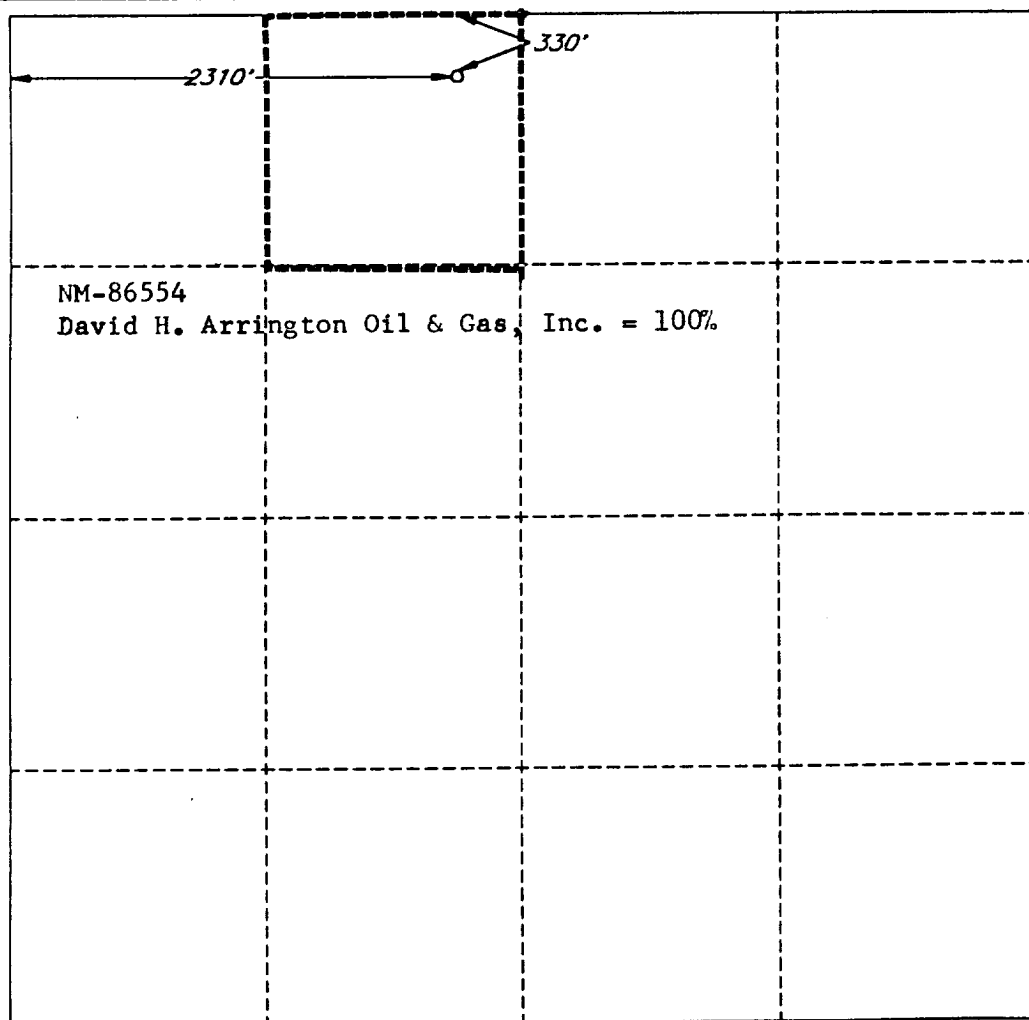

OPERATOR CERTIFICATION

I hereby certify that the information herein is true and complete to the best of my knowledge and belief.

Signature
George R. Smith

Printed Name
George R. Smith

Position
Agent for:

Company
David H. Arrington Oil & Gas, Inc.

Date
May 2, 1991

SURVEYOR CERTIFICATION

I hereby certify that the well location shown on this plat was plotted from field notes of actual surveys made by me or under my supervision, and that the same is true and correct to the best of my knowledge and belief.

Date Surveyed
APRIL 23, 1991

Signature and Seal of Professional Surveyor
V. LYNN BEZNER
NO. 7920

Certified by LAND SURVEYOR
V. LYNN BEZNER, R.L.S. #7920