

Submit to Appropriate
District Office
State Lease - 6 copies
Fee Lease - 5 copies

State of New Mexico
Energy, Minerals and Natural Resources Department

Form C-101
Revised 1-1-89

OIL CONSERVATION DIVISION

DISTRICT I
P.O. Box 1980, Hobbs, NM 88240

DISTRICT II
P.O. Drawer DD, Artesia, NM 88210

DISTRICT III
1000 Rio Brazos Rd., Aztec, NM 87410

P.O. Box 2088
Santa Fe, New Mexico 87504-2088

AUG 0 8 1991

O. C. D.
ARTESIA, OFFICE

API NO. (assigned by OCD on New Wells)

30-015-26818

5. Indicate Type of Lease

STATE ☐

FEE ☒

6. State Oil & Gas Lease No.

7. Lease Name or Unit Agreement Name

Covert Com

8. Well No.

2

9. Pool name or Wildcat

Dagger Draw Upper Pennsylvanian, N.

4. Well Location

Unit Letter

D

660
564

Feet From The

north

Line and

564

Feet From The

west

Line

Section

6

Township

20
30S

Range

25E

NMPM

Eddy

County

10. Proposed Depth

8,500'

11. Formation

Cisco/Canyon

12. Rotary or C.T.

Rotary

13. Elevations (Show whether DF, RT, GR, etc.)

3,575.4' GR 2572.4'

14. Kind & Status Plug Bond

Blanket

15. Drilling Contractor

Peterson Drilg. Co.

16. Approx. Date Work will start

August 24, 1991

17.

PROPOSED CASING AND CEMENT PROGRAM

SIZE OF HOLE	SIZE OF CASING	WEIGHT PER FOOT	SETTING DEPTH	SACKS OF CEMENT	EST. TOP
17-1/2"	13-3/8"	48#	450'	475	Circulate
14-1/4" 12 1/4"	9-5/8"	36#	1,300'	775	Circulate
8-3/4"	7"	23# & 26#	8,100'	950	Tie back to 9-5/8"

Propose to drill the well to sufficient depth to evaluate the Cisco/Canyon formation. After reaching TD, logs will be run and casing set if the evaluation is positive. Perforate, test, and stimulate as necessary to establish production.

BOP Program attached.

APPROVAL VALID FOR 180 DAYS

PERMIT EXPIRES 2/14/92

UNLESS DRILLING UNDERWAY

NOTE: We plan to drill a 12-1/4" hole to equal 450'. If hole conditions permit, we will then continue drilling a 12-1/4" hole from 450'-1,350' and run 9-5/8" casing and circulate cement. If hole conditions do not allow us to drill on from 450', we will open the surface hole to 17-1/2", run 13-3/8" casing to 450' and cement to surface, and drill a 12-1/4" hole to 1,300' and run and cement 9-5/8" casing.

IN ABOVE SPACE DESCRIBE PROPOSED PROGRAM: IF PROPOSAL IS TO DEEPEN OR PLUG BACK, GIVE DATA ON PRESENT PRODUCTIVE ZONE AND PROPOSED NEW PRODUCTIVE ZONE. GIVE BLOWOUT PREVENTER PROGRAM, IF ANY.

I hereby certify that the information above is true and complete to the best of my knowledge and belief.

SIGNATURE

Eddie J. Gelwick

TITLE

Operations Coordinator

DATE

7/29/91

TYPE OR PRINT NAME

Eddie J. Gelwick

TELEPHONE NO 214/739-1778

(This space for State Use)

ORIGINAL SIGNED BY
MIKE WILLIAMS

APPROVED BY

SUPERVISOR, DISTRICT II

TITLE

DATE

AUG 2 8 1991

CONDITIONS OF APPROVAL, IF ANY:

NOTIFY N.M.O.C.D. IN SUFFICIENT
TIME TO WITNESS CEMENTING THE
13 3/8 - 9 5/8 CASING

Submit to Appropriate
District Office
State Lease - 4 copies
Fee Lease - 3 copies

State of New Mexico
Energy, Minerals and Natural Resources Department

Form C-102
Revised 1-1-89

OIL CONSERVATION DIVISION

DISTRICT I
P.O. Box 1980, Hobbs, NM 88240

P.O. Box 2088
Santa Fe, New Mexico 87504-2088

DISTRICT II
P.O. Drawer DD, Artesia, NM 88210

AMENDED

DISTRICT III
1000 Rio Brazos Rd., Aztec, NM 87410

WELL LOCATION AND ACREAGE DEDICATION PLAT

All Distances must be from the outer boundaries of the section

Operator NEARBURG PRODUCING CO.			Lease COVERT COM		Well No. 2
Unit Letter D	Section 6	Township 20 SOUTH	Range 25 EAST	County EDDY	

Actual Footage Location of Well:

660 feet from the WEST line and		660 feet from the NORTH line	
Ground level Elev. 3573.4	Producing Formation Cisco Canyon	Pool Dagger Draw Upper Pennsylvanian, <u>South</u>	Dedicated Acreage: 160.00 Acres

- Outline the acreage dedicated to the subject well by colored pencil or hatchure marks on the plat below.
- If more than one lease is dedicated to the well, outline each and identify the ownership thereof (both as to working interest and royalty).
- If more than one lease of different ownership is dedicated to the well, have the interest of all owners been consolidated by communitization, unitization, force-pooling, etc.?
☒ Yes ☐ No If answer is "yes" type of consolidation Communitization if productive
If answer is "no" list the owners and tract descriptions which have actually been consolidated. (Use reverse side of this form if necessary).
No allowable will be assigned to the well until all interests have been consolidated (by communitization, unitization, forced-pooling, or otherwise) or until a non-standard unit, eliminating such interest, has been approved by the Division.

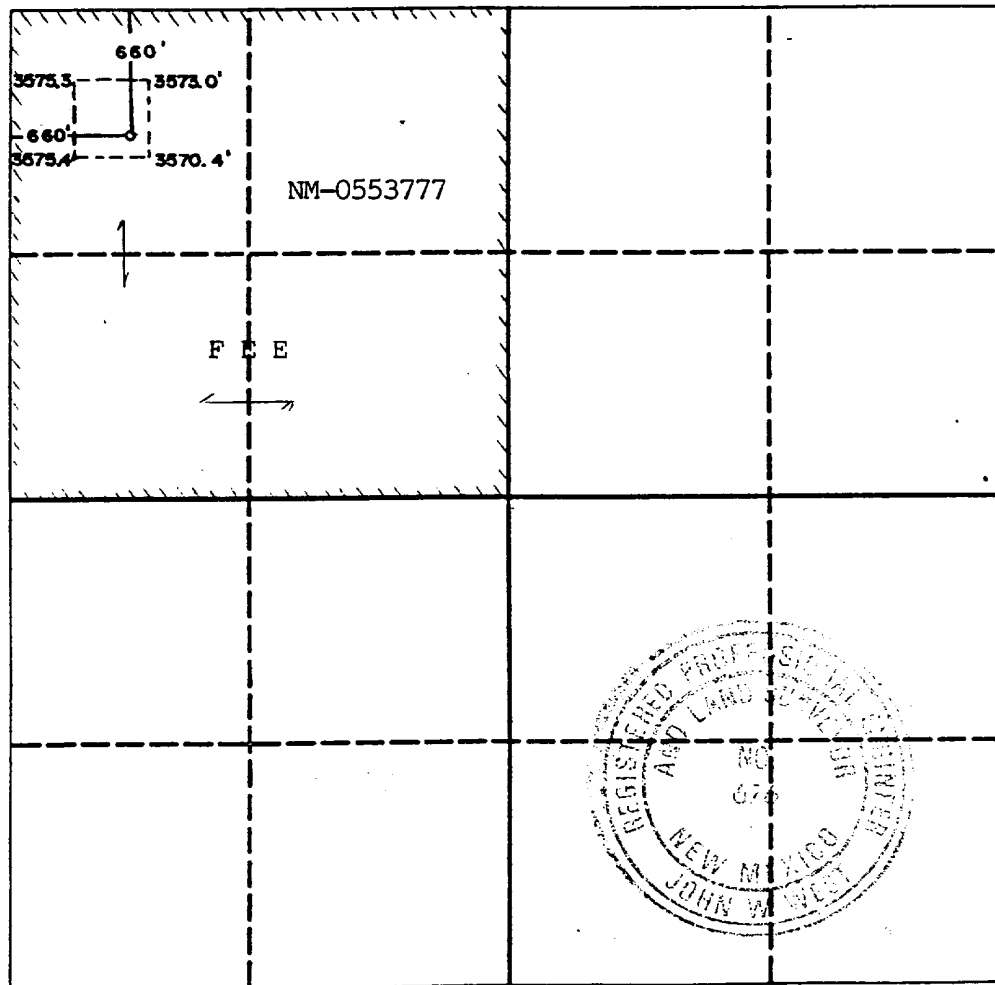

OPERATOR CERTIFICATION

I hereby certify that the information contained herein is true and complete to the best of my knowledge and belief.

Signature
Kathie Craft
Printed Name
Kathie Craft
Position
Land Administrator
Company
Nearburg Producing Co.
Date
August 26, 1991

SURVEYOR CERTIFICATION

I hereby certify that the well location shown on this plat was plotted from field notes of actual surveys made by me or under my supervision, and that the same is true and correct to the best of my knowledge and belief.

Date Surveyed
5-4-91
Signature & Seal of Professional Surveyor
Ronald J. Eidson
Certificate No. JOHN W. WEST, 676
RONALD J. EIDSON, 3239

Submit to Appropriate
District Office
State Lease - 4 copies
Fee Lease - 3 copies

State of New Mexico
Energy, Minerals and Natural Resources Department

Form C-102
Revised 1-1-89

OIL CONSERVATION DIVISION

DISTRICT I
P.O. Box 1980, Hobbs, NM 88240

P.O. Box 2088
Santa Fe, New Mexico 87504-2088

DISTRICT II
P.O. Drawer DD, Artesia, NM 88210

DISTRICT III
1000 Rio Brazos Rd., Aztec, NM 87410

WELL LOCATION AND ACREAGE DEDICATION PLAT

All Distances must be from the outer boundaries of the section

Operator NEARBURG PRODUCING CO.			Lease COVERT COM		Well No. 2
Unit Letter D	Section 6	Township 20 SOUTH	Range 25 EAST	County EDDY	
Actual Footage Location of Well: 554 feet from the WEST line and 554 feet from the NORTH line					
Ground level Elev. 3575.4	Producing Formation Cisco-Canyon		Pool Dagger Draw North-Upper Penn		Dedicated Acreage: 160.0 Acres

- Outline the acreage dedicated to the subject well by colored pencil or hatchure marks on the plat below.
- If more than one lease is dedicated to the well, outline each and identify the ownership thereof (both as to working interest and royalty).
- If more than one lease of different ownership is dedicated to the well, have the interest of all owners been consolidated by communitization, unitization, force-pooling, etc.?
☐ Yes ☐ No If answer is "yes" type of consolidation Communitize if productive
If answer is "no" list the owners and tract descriptions which have actually been consolidated. (Use reverse side of this form if necessary.)
No allowable will be assigned to the well until all interests have been consolidated (by communitization, unitization, forced-pooling, or otherwise) or until a non-standard unit, eliminating such interest, has been approved by the Division.

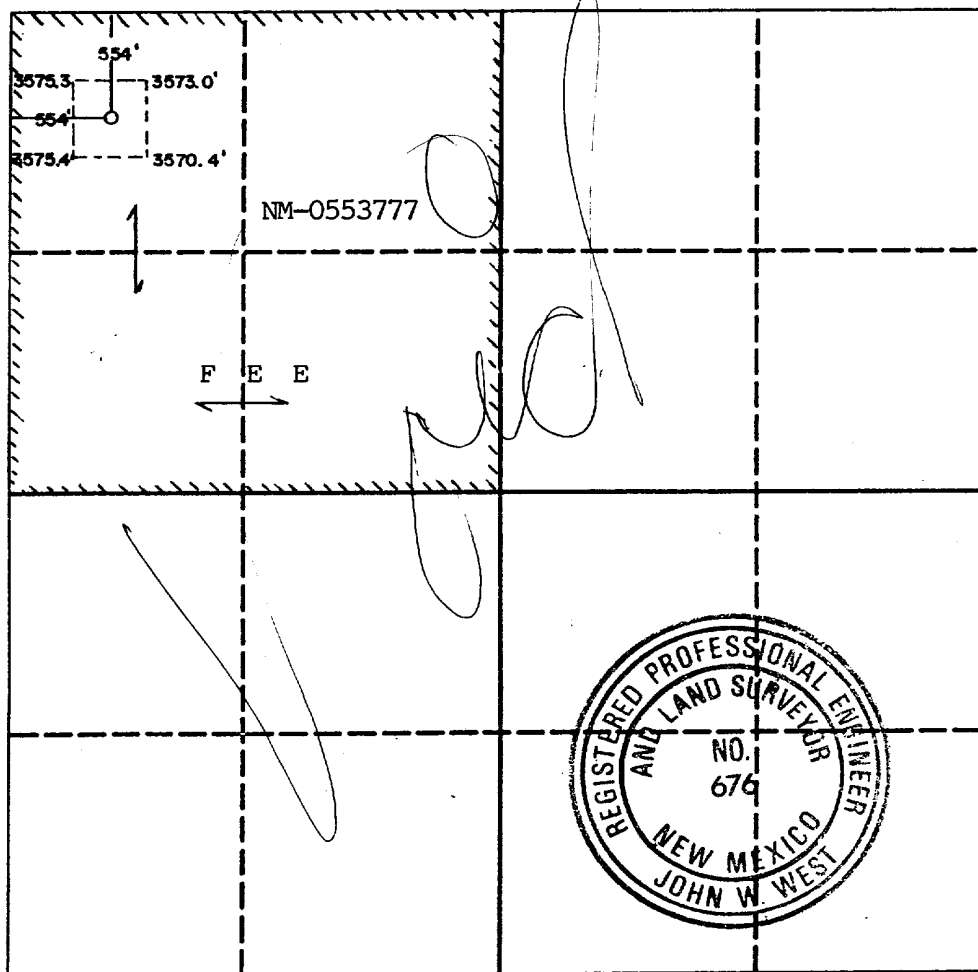

OPERATOR CERTIFICATION

I hereby certify that the information contained herein is true and complete to the best of my knowledge and belief.

Signature
Mark K. Nearburg
Printed Name
Mark K. Nearburg
Position
Vice President
Company
Nearburg Producing Co.
Date
5-9-91

SURVEYOR CERTIFICATION

I hereby certify that the well location shown on this plat was plotted from field notes of actual surveys made by me or under my supervision, and that the same is true and correct to the best of my knowledge and belief.

Date Surveyed
5-4-91
Signature & Seal of
Professional Surveyor
John W. West
Certificate No. JOHN W. WEST, 676
RONALD J. EIDSON, 3239

BLOWOUT PREVENTER SKETCH
Nearburg Producing Company
COVERT COM WELL NO. 2

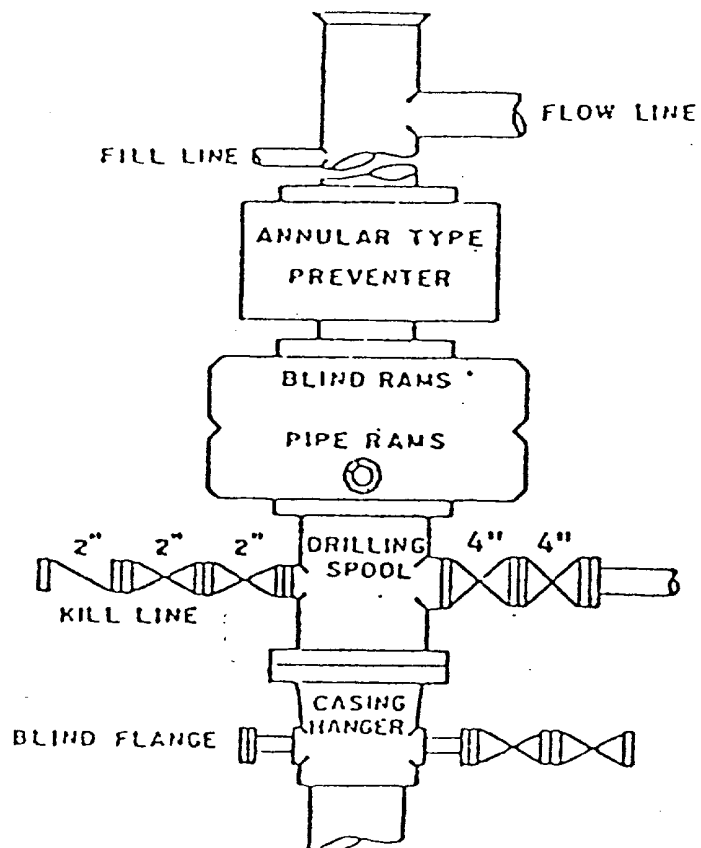

NC Topo DBM 1/22/92

San Andres	596
Glorieta	2204
Bone Spring	3688
Wolfcamp	5542
Canyon	7590