

Submit to: Appropriate  
District Office  
State Lease - 6 copies  
Fee Lease - 5 copies

State of New Mexico  
Energy, Minerals and Natural Resources Department

Form C-101  
Revised 1-1-89

OIL CONSERVATION DIVISION

P.O. Box 2088  
Santa Fe, New Mexico 87504-2088

DISTRICT I  
P.O. Box 1980, Hobbs, NM 88240

DISTRICT II  
P.O. Drawer DD, Artesia, NM 88210

DISTRICT III  
1000 Rio Brazos Rd., Aztec, NM 87410

SEP - 9 1992

API NO. (assigned by OCD on New Wells)

30-015-27124

5. Indicate Type of Lease

STATE ☒ FEE ☐

6. State Oil & Gas Lease No.

648

APPLICATION FOR PERMIT TO DRILL, DEEPEN, OR PLUG BACK

1a. Type of Work:

DRILL ☒ RE-ENTER ☐ DEEPEN ☐ PLUG BACK ☐

b. Type of Well:

OIL WELL ☒ GAS WELL ☐ OTHER ☐ SINGLE ZONE ☒ MULTIPLE ZONE ☐

2. Name of Operator

Harvard Petroleum Corporation ✓

3. Address of Operator

P. O. Box 936 Roswell, New Mexico 88202-0936

7. Lease Name or Unit Agreement Name

Netherlin state

8. Well No.

#1

9. Pool name or Wildcat

X Millman-Grayburg

4. Well Location

Unit Letter C : 330 Feet From The North Line and 2310 Feet From The West Line

Section 24 Township 19 South Range 27 East NMPM Eddy County

10. Proposed Depth

2200'

11. Formation

Grayburg

12. Rotary or C.T.

Rotary

13. Elevations (Show whether DF, RT, GR, etc.)

3487' GR

14. Kind & Status Plug Bond

Blanket

15. Drilling Contractor

United Drilling

16. Approx. Date Work will start

9/23/92

17. PROPOSED CASING AND CEMENT PROGRAM

SIZE OF HOLE	SIZE OF CASING	WEIGHT PER FOOT	SETTING DEPTH	SACKS OF CEMENT	EST. TOP
12 1/4"	8 5/8"	24#	310'	200	Surf.
7 7/8"	4 1/2"	10.50#	2200'	375	Surf.

Propose to drill 12 1/4" hole to 310'

Run 310' 8 5/8" 24# casing

Cement with 200 sks Class "C" with 2% CaCl

Circ. cmt. to surface

W.O.C. 18 hrs.

Nipple up and pressure test, BOP to 1000# for 30 minutes

Drill 7 7/8" hole to 2200'

Run 2200' 4 1/2" 10.50# casing

Cement with 200 sks Class "C" with 2% CaCl and 175 sks HLC

Circ. cmt. to surface

Completion to be determined

APPROVAL VALID FOR 180 DAYS

PERMIT EXPIRES 3/10/93

UNLESS DRILLING UNDERWAY

IN ABOVE SPACE DESCRIBE PROPOSED PROGRAM: IF PROPOSAL IS TO DEEPEN OR PLUG BACK, GIVE DATA ON PRESENT PRODUCTIVE ZONE AND PROPOSED NEW PRODUCTIVE ZONE. GIVE BLOWOUT PREVENTER PROGRAM, IF ANY.

I hereby certify that the information above is true and complete to the best of my knowledge and belief.

SIGNATURE

TITLE Vice President

DATE September 9, 1992

TYPE OR PRINT NAME

Jeff Harvard

TELEPHONE NO. (505) 623-158

(This space for State Use)

ORIGINAL SIGNED BY

MIKE WILLIAMS

APPROVED BY

SUPERVISOR, DISTRICT II

TITLE

DATE

SEP 10 1992

CONDITIONS OF APPROVAL, IF ANY:

NOTIFY N.M. O.C.D. IN SUFFICIENT  
TIME TO ALLOW CEMENTING THE

8 5/8"

CASING

Submit to Appropriate  
District Office  
State Lease - 4 copies  
Fee Lease - 3 copies

State of New Mexico  
Energy, Minerals and Natural Resources Department

Form C-102  
Revised 1-1-89

**OIL CONSERVATION DIVISION**

P.O. Box 2088  
Santa Fe, New Mexico 87504-2088

**DISTRICT I**  
P.O. Box 1980, Hobbs, NM 88240

**DISTRICT II**  
P.O. Drawer DD, Artesia, NM 88210

**DISTRICT III**  
1000 Rio Brazos Rd., Aztec, NM 87410

**WELL LOCATION AND ACREAGE DEDICATION PLAT**

All Distances must be from the outer boundaries of the section

Operator <b>HARVARD PETROLEUM CORPORATION</b>			Lease <b>NETHERLIN STATE</b>		Well No. <b>1</b>
Unit Letter <b>C</b>	Section <b>24</b>	Township <b>19 SOUTH</b>	Range <b>27 EAST</b>	County <b>EDDY COUNTY, NM</b>	
Actual Footage Location of Well: <b>2310</b> feet from the <b>WEST</b> line and <b>330</b> feet from the <b>NORTH</b> line					
Ground level Elev. <b>3487.</b>		Producing Formation		Pool	Dedicated Acreage: Acres

1. Outline the acreage dedicated to the subject well by colored pencil or hatchure marks on the plat below.
2. If more than one lease is dedicated to the well, outline each and identify the ownership thereof (both as to working interest and royalty).
3. If more than one lease of different ownership is dedicated to the well, have the interest of all owners been consolidated by communitization, unitization, force-pooling, etc.?  
☐ Yes ☐ No If answer is "yes" type of consolidation \_\_\_\_\_  
If answer is "no" list the owners and tract descriptions which have actually been consolidated. (Use reverse side of this form if necessary.) \_\_\_\_\_  
No allowable will be assigned to the well until all interests have been consolidated (by communitization, unitization, forced-pooling, or otherwise) or until a non-standard unit, eliminating such interest, has been approved by the Division.

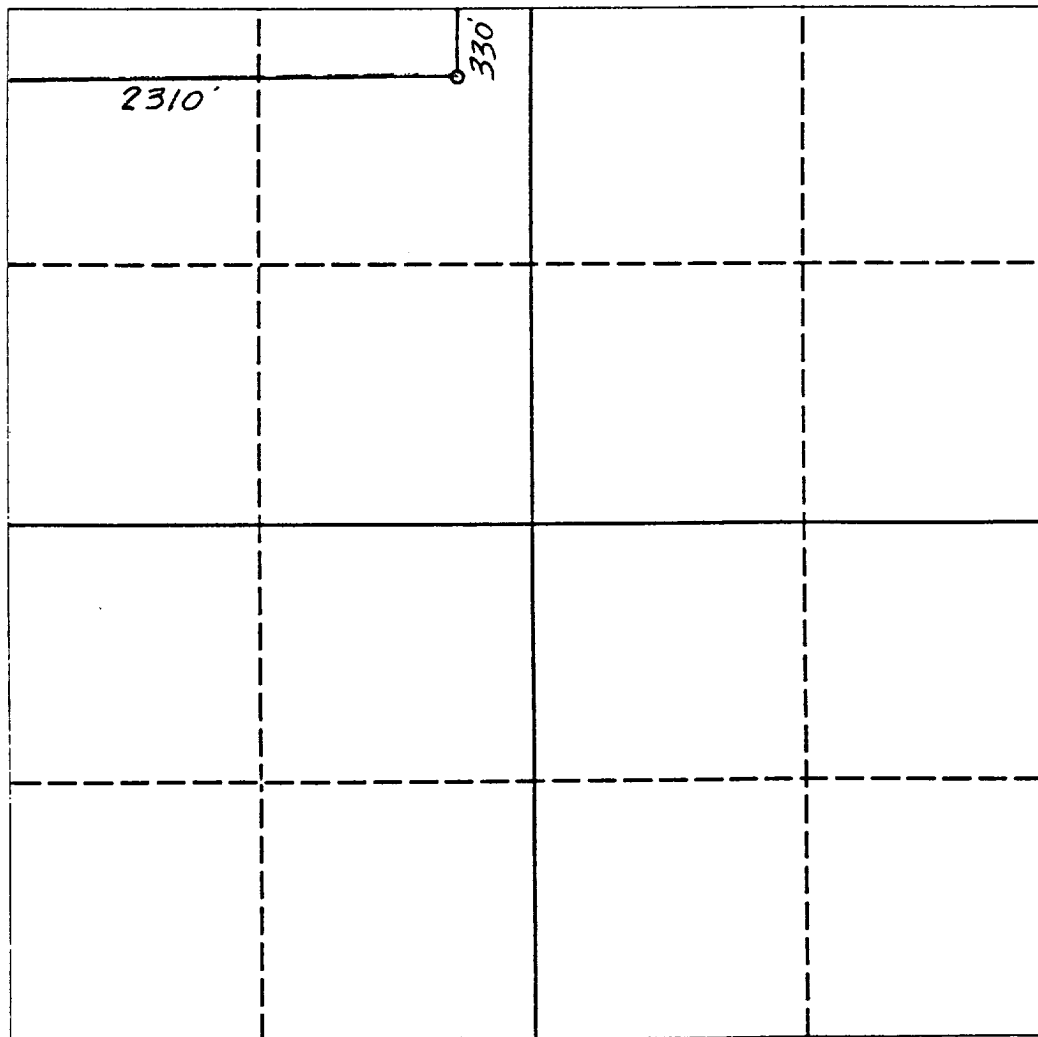

**OPERATOR CERTIFICATION**

I hereby certify that the information contained herein is true and complete to the best of my knowledge and belief.

Signature  
Jeff Harvard  
Printed Name  
Vice President  
Position  
Harvard Petroleum Corporation  
Company  
09-09-92  
Date

**SURVEYOR CERTIFICATION**

I hereby certify that the well location shown on this plat was plotted from field notes of actual surveys made by me or under my supervision, and that the same is true and correct to the best of my knowledge and belief.

Date Surveyed  
SEPTEMBER 3, 1992

Signature & Seal of Professional Surveyor  
NEW MEXICO  
5412  
NM E&PS NO. 5412  
PROFESSIONAL SURVEYOR

0 330 660 990 1320 1650 1980 2310 2640 2000 1500 1000 500 0