

Submit to Appropriate  
District Office  
State Lease - 4 copies  
Fee Lease - 3 copies

State of New Mexico  
Energy, Minerals and Natural Resources Department

Form C-102  
Revised 1-1-89

OIL CONSERVATION DIVISION

RECEIVED

DISTRICT I  
P.O. Box 1960, Hobbs, NM 88240

P.O. Box 2088  
Santa Fe, New Mexico 87504-2088

SEP 19 1992

DISTRICT II  
P.O. Drawer DD, Artesia, NM 88210

O. C. D.

DISTRICT III  
1000 Rio Brazos Rd., Artec, NM 87410

WELL LOCATION AND ACREAGE DEDICATION PLAT

All Distances must be from the outer boundaries of the section

Operator SOUTHWEST ROYALTIES			Lease DAGGER DRAW A		Well No. 1
Unit Letter G	Section 17	Township 19 SOUTH	Range 25 EAST	County EDDY	
Actual Footage Location of Well: 1650 feet from the NORTH line and 1880 feet from the EAST line					
Ground Level Elev. 3533.4	Producing Formation	Pool		Dedicated Acreage: Acres	

- Outline the acreage dedicated to the subject well by colored pencil or hachure marks on the plat below.
- If more than one lease is dedicated to the well, outline each and identify the ownership thereof (both as to working interest and royalty).
- If more than one lease of different ownership is dedicated to the well, have the interest of all owners been consolidated by communitization, unitization, force-pooling, etc.?
 

Yes     No    If answer is "yes" type of consolidation \_\_\_\_\_

If answer is "no" list of owners and tract descriptions which have actually been consolidated. (Use reverse side of this form necessary.)

No allowable will be assigned to the well unit all interests have been consolidated (by communitization, unitization, forced-pooling, otherwise) or until a non-standard unit, eliminating such interest, has been approved by the Division.

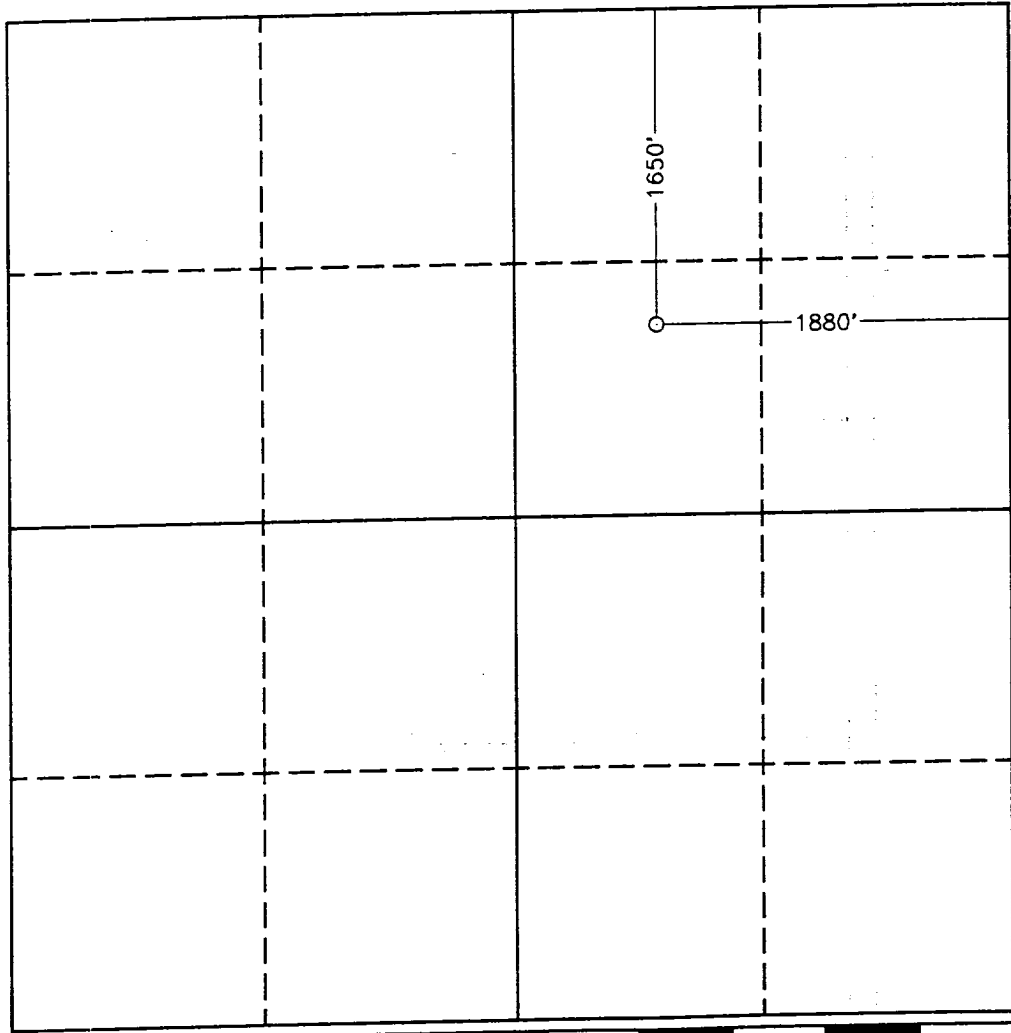

OPERATOR CERTIFICATION

I hereby certify the the information contained herein is true and complete to the best of my knowledge and belief.

Signature: *Ann E. Ritchie*

Printed Name: Ann E. Ritchie

Position: Agent

Company: Southwest Royalties, Inc.

Date: 10-21-92

SURVEYOR CERTIFICATION

I hereby certify that the well location shown on this plat was plotted from field notes of actual surveys made by me or under my supervision, and that the same is true and correct to the best of my knowledge and belief.

Date Surveyed: SEPTEMBER 28, 1992

Signature & Seal of Professional Surveyor

Certificate No. JOHN W. JONES 676  
RONALD J. BRIDGES 3288  
GARY L. JONES 7977

