

Submit to Appropriate
District Office
State Lease - 6 copies
Fee Lease - 3 copies

State of New Mexico
Minerals and Natural Resources Department

Form C-101
Revised 1-1-89

OIL CONSERVATION DIVISION

P.O. Box 2088
Santa Fe, New Mexico 87504-2088

DISTRICT I

P.O. Box 1980, Hobbs, NM 88240

DISTRICT II

P.O. Drawer DD, Artesia, NM 88210

DISTRICT III

1000 Rio Brazos Rd., Aztec, NM 87410

MAR 11 1993

API NO. (assigned by OCD on New Wells)

30-015-27355

5. Indicate Type of Lease

STATE ☒ FEE ☐

6. State Oil & Gas Lease No.
E-10167

APPLICATION FOR PERMIT TO DRILL, DEEPEN, OR PLUG BACK

1a. Type of Work:

DRILL ☒ RE-ENTER ☐ DEEPEN ☐ PLUG BACK ☐

b. Type of Well:

OIL WELL ☒ GAS WELL ☐ OTHER ☐

SINGLE ZONE ☐ MULTIPLE ZONE ☐

7. Lease Name or Unit Agreement Name

Boyd "X" State

2. Name of Operator

Yates Petroleum Corporation

8. Well No.

4.

3. Address of Operator

105 South Fourth Street, Artesia, New Mexico 88210

9. Pool name or Wildcat

N. Dagger Draw Upper Penn

4. Well Location

Unit Letter K : 1980 Feet From The South Line and 1980 Feet From The West Line
Section 29 Township 19 South Range 25 East NMPM Eddy County

10. Proposed Depth
8300'

11. Formation
Cisco-Canyon

12. Rotary or C.T.
Rotary

13. Elevations (Show whether DF, RT, GR, etc.)
3521

14. Kind & Status Plug. Bond
Blanket

15. Drilling Contractor
Undesignated

16. Approx. Date Work will start
ASAP

17.

PROPOSED CASING AND CEMENT PROGRAM

SIZE OF HOLE	SIZE OF CASING	WEIGHT PER FOOT	SETTING DEPTH	SACKS OF CEMENT	EST. TOP
14 3/4"	9 5/8"	36# J-55	1100'	1100 sacks	Circulated
8 3/4"	7"	23-26#	TD	As warranted	
		J-55 & N-80			

Yates Petroleum Corporation proposes to drill and test the Canyon and intermediate formations. Approximately 1100' of surface casing will be set and cement circulated to shut off gravel and cavings. If commercial, production casing will be run and cemented, will perforate and stimulate as needed for production.

MUD PROGRAM: FW gel/LCM to 1100'; FW to 5000'; cut Brine to 7200'; SW gel/Starch to TD.

BOP PROGRAM: BOP's and hydril will be installed on the 9 5/8' casing and tested daily.

IN ABOVE SPACE DESCRIBE PROPOSED PROGRAM: IF PROPOSAL IS TO DEEPEN OR PLUG BACK, GIVE DATA ON PRESENT PRODUCTIVE ZONE AND PROPOSED NEW PRODUCTIVE ZONE. GIVE BLOWOUT PREVENTER PROGRAM, IF ANY.

I hereby certify that the information above is true and complete to the best of my knowledge and belief.

SIGNATURE

Ken Beardemphl

Landman

TITLE

2/17/93

DATE

TYPE OR PRINT NAME

Ken Beardemphl

748-1471

TELEPHONE NO.

(This space for State Use)

APPROVED BY

Mark Bailey

TITLE

Geologist

DATE

3-16-93

CONDITIONS OF APPROVAL, IF ANY:

NOTICE: MUST BE IN SUFFICIENT
TIME TO COMPLETE CEMENTING THE
Casing

APPROVAL FOR 180 DAYS
3-16-93
Casing Installation Underway

Submit to Appropriate
District Office
State Lease - 4 copies
Fee Lease - 3 copies

State of New Mexico
Energy, Minerals and Natural Resources Department

Form C-102
Revised 1-1-89

OIL CONSERVATION DIVISION

DISTRICT I
P.O. Box 1980, Hobbs, NM 88240

P.O. Box 2088
Santa Fe, New Mexico 87504-2088

DISTRICT II
P.O. Drawer DD, Artesia, NM 88210

DISTRICT III
1000 Rio Brazos Rd., Aztec, NM 87410

WELL LOCATION AND ACREAGE DEDICATION PLAT

All Distances must be from the outer boundaries of the section

Operator YATES PETROLEUM CORPORATION			Lease BOYD X STATE COM		Well No. 4
Unit Letter K	Section 29	Township 19 SOUTH	Range 25 EAST	County EDDY COUNTY, NM	

Actual Footage Location of Well:

1980 feet from the SOUTH line and 1980 feet from the WEST line	Ground level Elev. 3521	Producing Formation Cisco Canyon	Pool N. Dagger Draw Upper Penn	Dedicated Acreage: 160 Acres
--	-----------------------------------	--	--	--

1. Outline the acreage dedicated to the subject well by colored pencil or hachure marks on the plat below.
2. If more than one lease is dedicated to the well, outline each and identify the ownership thereof (both as to working interest and royalty).
3. If more than one lease of different ownership is dedicated to the well, have the interest of all owners been consolidated by communitization, unitization, force-pooling, etc?
☒ Yes ☐ No If answer is "yes" type of consolidation Communitization
If answer is "no" list the owners and tract descriptions which have actually been consolidated. (Use reverse side of this form if necessary).
No allowable will be assigned to the well until all interests have been consolidated (by communitization, unitization, forced-pooling, or otherwise) or until a non-standard unit, eliminating such interest, has been approved by the Division.

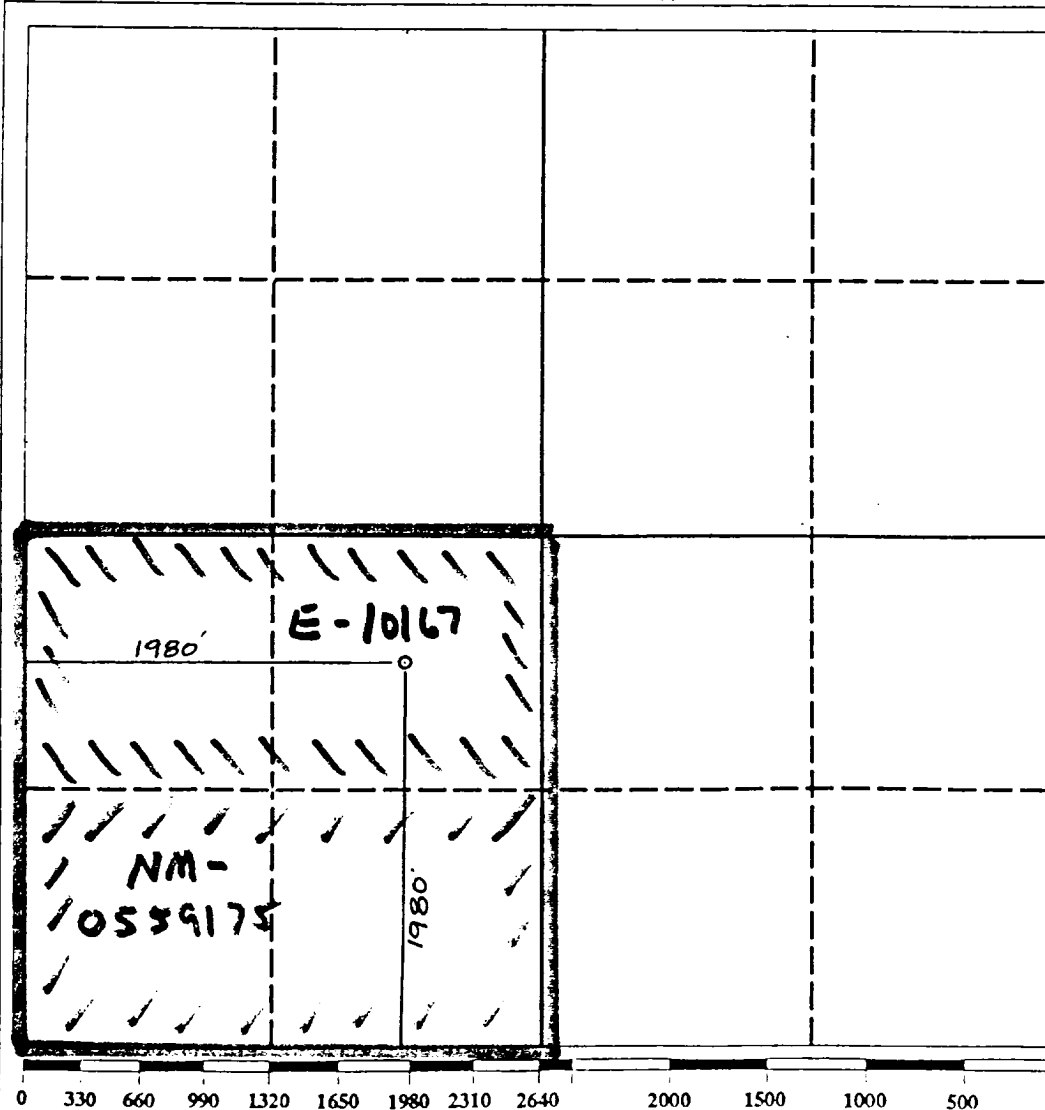

OPERATOR CERTIFICATION

I hereby certify that the information contained herein in true and complete to the best of my knowledge and belief.

Signature <i>Ken Beardemph</i>
Printed Name Ken Beardemph
Position landman
Company Yates Pet. Corp.
Date 2-17-93

SURVEYOR CERTIFICATION

I hereby certify that the well location shown on this plat was plotted from field notes of actual surveys made by me or under my supervision, and that the same is true and correct to the best of my knowledge and belief.

Date Surveyed FEBRUARY 13, 1993
Signature & Seal of Professional Surveyor <i>Ken Beardemph</i>
Certificate No. 5412
Professional Surveyor NEW MEXICO

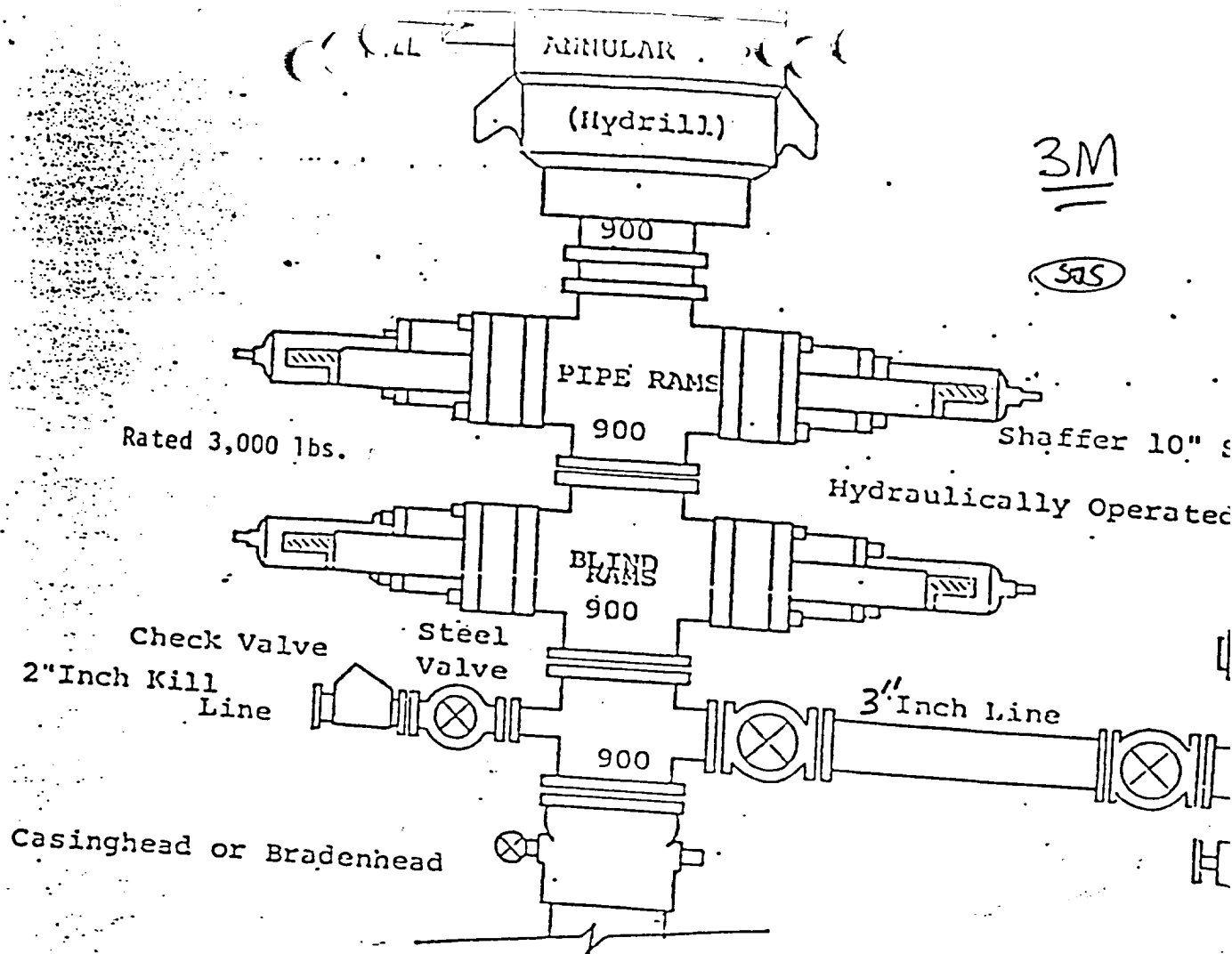

THE FOLLOWING CONSTITUTE MINIMUM BLOWOUT PREVENTER REQUIREMENTS

1. All preventers to be hydraulically operated with secondary manual installed prior to drilling out from under casing.
2. Choke outlet to be a minimum of 3" diameter.
3. Kill line to be of all steel construction of 2" minimum diameter.
4. All connections from operating manifolds to preventers to be all hole or tube a minimum of one inch in diameter.
5. The available closing pressure shall be at least 15% in excess of required with sufficient volume to operate the B.O.P.'s.
6. All connections to and from preventer to have a pressure rating to that of the B.O.P.'s.
7. Inside blowout preventer to be available on rig floor.
8. Operating controls located a safe distance from the rig floor.
9. Hole must be kept filled on trips below intermediate casing.

EXHIBIT
B