

DISTRICT I
1625 N. French Dr., Hobbs, NM 88240

DISTRICT II
811 South First, Artesia, NM 88210

DISTRICT III
1000 Rio Brazos Rd., Aztec, NM 87410

DISTRICT IV
2040 South Pacheco, Santa Fe, NM 87501

State of New Mexico
Energy, Minerals and Natural Resources Department

OIL CONSERVATION DIVISION
PO BOX 2088
Santa Fe, NM 87504-2088

Form C-101
Revised March 17, 1999
Instructions on back

Submit to appropriate District Office

State Lease - 6 Copies
Fee Lease - 5 Copies

☐ AMENDED REPORT

APPLICATION FOR PERMIT TO DRILL, RE-ENTER, DEEPEN, PLUGBACK, OR ADD A ZONE

¹ Operator Name and Address Yates Petroleum Corporation 105 South Fourth Street Artesia, New Mexico 88210		² OGRID Number 025575
⁴ Property Code 14393		³ API Number 015-28371
⁵ Property Name Boyd X State		⁶ Well No. 7

7 Surface Location									
UL or lot no. P	Section 28	Township 19S	Range 25E	Lot Idn	Feet from the 660'	North/South Line South	Feet from the 660'	East/West Line East	County Eddy

8 Proposed Bottom Hole Location If Different From Surface									
UL or lot no.	Section	Township	Range	Lot Idn	Feet from the	North/South Line	Feet from the	East/West Line	County
9 Proposed Pool 1 Dagger Draw Upper Penn, North 15472					10 Proposed Pool 2				

¹¹ Work Type Code N	¹² Well Type Code O	¹³ Cable/Rotary R	¹⁴ Lease Type Code S	¹⁵ Ground Level Elevation 3505' GR
¹⁶ Multiple No	¹⁷ Proposed Depth 8300'	¹⁸ Formation Canyon	¹⁹ Contractor Not Determined	²⁰ Spud Date ASAP

21 Proposed Casing and Cement Program					
Hole Size	Casing Size	Casing weight/feet	Setting Depth	Sacks of Cement	Estimated TOC
14 3/4"	9 5/8"	36# J-55	1150'	1100 sx	Surface
8 3/4"	7"	23# & 26#	TD	1350 sx	Surface
		J-55 & L-80			

²² Describe the proposed program. If this application is to DEEPEN or PLUG BACK give the data on the present productive zone and proposed new production. Describe the blowout prevention program, if any. Use additional sheets if necessary.

Yates Petroleum Corporation proposes to drill and test the Canyon and intermediate formations. Approximately 1150' of surface casing will be set and cement circulated to shut off gravel and cavings. If commercial, production casing will be run and cemented, will perforate and stimulate as needed for production.

MUD PROGRAM: 0-1150' FWGel/LCM; 1150'-5200' FW: 5200'-7200' Cut Brine/KCL; 7200'-TD Cut Brine/Starch.

BOPE PROGRAM: BOP's will be installed on the 9 5/8" casing and tested daily for operational.

²³ I hereby certify that the information given above is true and complete to the best of my knowledge and belief.

Signature: 
Printed name: Cy Cowan

Title: Regulatory Agent

Date: 02/05/01

Phone:

(505) 748-1471

OIL CONSERVATION DIVISION

Approved by:

ORIGINAL SIGNED BY TIM W. GUM

Title:

DISTRICT IV SUPERVISOR

Approval Date:

FEB 16 2001

Expiration Date:

FEB 16 2002

Conditions of Appr

Attached ☐

NOTIFY OCD SPUD & TIME TO WITNESS
CEMENTING WATER PROTECTION STRING

District I
PO Box 1980, Hobbs, NM 88241-1980
District II
PO Drawer DD, Artesia, NM 88211-0719
District III
1000 Rio Brazos Rd., Aztec, NM 87410
District IV
PO Box 2088, Santa Fe, NM 87504-2088

State of New Mexico
Energy, Minerals & Natural Resources Department

OIL CONSERVATION DIVISION
PO Box 2088
Santa Fe, NM 87504-2088

RECEIVED
OIL CONSERVATION DIVISION
SANTA FE, NM

Form C-102
Revised February 10, 1994
Instructions on back
Submit to Appropriate District Office
State Lease - 4 Copies
Fee Lease - 3 Copies

☐ AMENDED REPORT

WELL LOCATION AND ACREAGE DEDICATION PLAT

API Number 30-015-28371		Pool Code 15472	Pool Name Dagger Draw; Upper Penn, North
Property Code 14393	Property Name Boyd X State		Well Number 7
OGRID No. 025575	Operator Name YATES PETROLEUM CORPORATION		Elevation 3505.

¹⁰ Surface Location

UL or lot no.	Section	Township	Range	Lot Idn	Feet from the	North/South line	Feet from the	East/West line	County
P	29	19S	25E		660'	South	660'	East	Eddy

¹¹ Bottom Hole Location If Different From Surface

UL or lot no.	Section	Township	Range	Lot Idn	Feet from the	North/South line	Feet from the	East/West line	County

¹² Dedicated Acres 160	¹³ Joint or Infill	¹⁴ Consolidation Code	¹⁵ Order No.
--------------------------------------	-------------------------------	----------------------------------	-------------------------

NO ALLOWABLE WILL BE ASSIGNED TO THIS COMPLETION UNTIL ALL INTERESTS HAVE BEEN CONSOLIDATED
OR A NON-STANDARD UNIT HAS BEEN APPROVED BY THE DIVISION

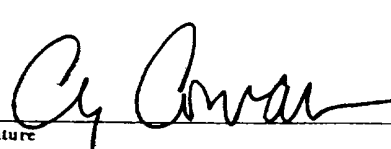
16				17 OPERATOR CERTIFICATION I hereby certify that the information contained herein is true and complete to the best of my knowledge and belief.  Signature Cy Cowan Printed Name Regulatory Agent Title 2-5-01 Date
				18 SURVEYOR CERTIFICATION I hereby certify that the well location shown on this plat was plotted from field notes of actual surveys made by me or under my supervision, and that the same is true and correct to the best of my belief. <u>Refer to Original Plat</u> Date of Survey Signature and Seal of Professional Surveyer: Certificate Number

E-10167

660'
660'

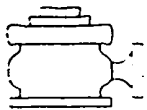

Yates Petroleum Corporation

BOP-3

Typical 3,000 psi Pressure System Schematic Annular with Double Ram Preventer Stack

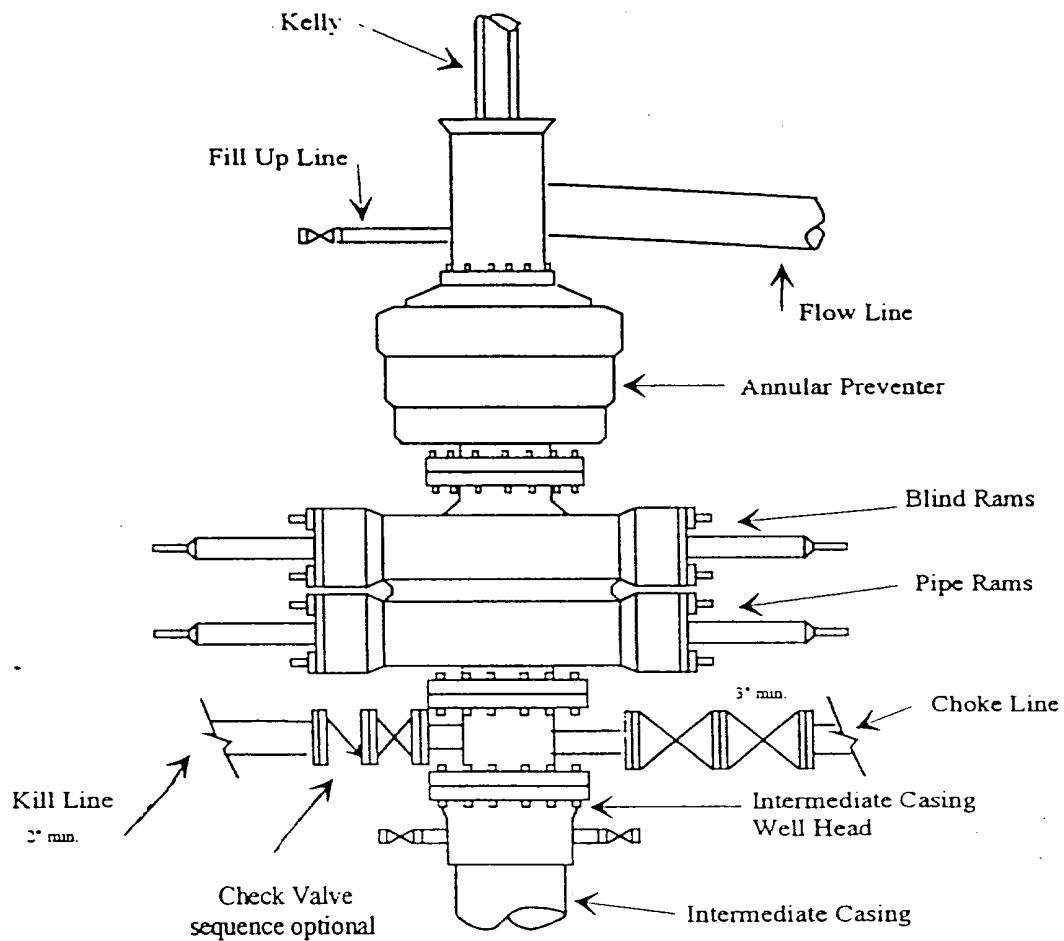

Typical 3,000 psi choke manifold assembly with at least these minimum features

