

District I  
PO Box 1980, Hobbs, NM 88241-1980  
District II  
PO Drawer DD, Artesia, NM 88211-0719  
District III  
1000 Rio Brazos Rd., Aztec, NM 87410  
District IV  
PO Box 2088, Santa Fe, NM 87504-2088

State of New Mexico  
Energy, Minerals & Natural Resources Department

OIL CONSERVATION DIVISION  
PO Box 2088  
Santa Fe, NM 87504-2088

Form C-101  
Revised February 10, 1994  
Instructions on back  
Submit to Appropriate District Office  
State Lease - 6 Copies  
Fee Lease - 5 Copies

RECEIVED

AMENDED REPORT

APPLICATION FOR PERMIT TO DRILL, RE-ENTER, DEEPEN, PLUGBACK, OR ADD A ZONE

Operator Name and Address. <b>MARALO, INC.</b> P. O. BOX 832 MIDLAND, TX 79702		OIL CON. DIV. DIST. 2		GRID Number 014007	
Property Code 17151		Property Name MILLMAN "3" STATE COM		API Number 30-015-28528	
				Well No. 1	

Surface Location									
UL or lot no.	Section	Township	Range	Lot Idn	Feet from the	North/South line	Feet from the	East/West line	County
F	3	19S	28E		1980	NORTH	2280	WEST	EDDY

Proposed Bottom Hole Location If Different From Surface									
UL or lot no.	Section	Township	Range	Lot Idn	Feet from the	North/South line	Feet from the	East/West line	County
Eddy									
Proposed Pool 1 UNDESIGNATED (MORROW) GAS 90622					Proposed Pool 2				

Work Type Code M	Well Type Code G	Cable/Rotary C	Lease Type Code S	Ground Level Elevation 3522'
Multiple S	Proposed Depth 11,300'	Formation MORROW	Contractor UNK	Spud Date 06/01/95

Proposed Casing and Cement Program					
Hole Size	Casing Size	Casing weight/foot	Setting Depth	Sacks of Cement	Estimated TOC
17-1/2"	13-3/8"	54.50#	400'	500 CL. "C"	CIRC TO SURF.
12-1/4"	8-5/8"	32#	2700'	700 HOWCO LCM + 250 SXS PREM.	CIRC TO SURF.
7-7/8"	5-1/2"	17#	11,300'	1000 SXS PREM.	

Describe the proposed program. If this application is to DEEPEN or PLUG BACK give the data on the present productive zone and proposed new productive zone. Describe the blowout prevention program, if any. Use additional sheets if necessary.

DRILL 17-1/2" HOLE TO  $\pm$  400'. RUN 13-3/8" 54.50# SURFACE CSG & CMT. CIRC TO SURFACE W/500 SXS CLASS "C", 2% CACL<sub>2</sub>. NU BOP. WOC MINIMUM 12 HRS BEFORE DRILLING OUT W/12-1/4" BIT.

DRILL 12-1/4" HOLE TO 2700' AND SET 8-5/8" 32# CSG. CMT W/700 SXS HOWCO LCM & TAIL IN W/250 SXS PREM NEAT CMT & CIRC TO SURFACE. WOC 12 HRS. TEST 8-5/8" CSG TO 2000#. TEST BOP & CHOKE TO 3000#.

DRILL 7-7/8" HOLE TO 11,300' AND LOG WELL.

SET 5-1/2" 17# CSG. CMT W/1000 SXS PREMIUM 50/50 POZ MIX CMT. VOLUME TO FULL UP TO 4600' W/25% EXCESS. SET 5-1/2" CSG SLIPS. RELEASE RIG. CLEAN UP LOCATION.

I hereby certify that the information given above is true and complete to the best of my knowledge and belief.

Signature:

Printed name:

Title:

Date:

*Dorothea Logan*  
DOROTHEA LOGAN  
REGULATORY ANALYST  
MAY 23, 1995  
Phone: (915) 684-7441

OIL CONSERVATION DIVISION

Approved by:

Title:

Approval Date:

Conditions of Approval:

Attached ☐

ORIGINAL SIGNED BY TIM W. GUM  
DISTRICT II SUPERVISOR

Expiration Date:

MAY 26 1995  
11-26-95

C/SF  
B/M  
SL  
OP

NSC 4 3541

DISTRICT I  
P.O. Box 1980, Hobbs, NM 88240

DISTRICT II  
P.O. Drawer DD, Artesia, NM 88210

DISTRICT III  
1000 Rio Brazos Rd., Aztec, NM 87410

DISTRICT IV  
PO BOX 2088, SANTA FE, NM 87504-2088

State of New Mexico  
Energy, Minerals and Natural Resources Department

Form C-102  
Revised February 10, 1994  
Instruction on back  
Submit to Appropriate District Office  
State Lease - 4 Copies  
Fee Lease - 3 Copies

OIL CONSERVATION DIVISION  
P.O. Box 2088

Santa Fe, New Mexico 87504-2088

☐ AMENDED REPORT

WELL LOCATION AND ACREAGE DEDICATION PLAT

API Number <b>30-015-28528</b>	Pool Code <b>90622</b>	Pool Name <b>UNDESIG. (MORROW) GAS</b>
Property Code	Property Name <b>MILLMAN '3' STATE COM.</b>	Well Number <b>1</b>
OGRID No. <b>014007</b>	Operator Name <b>MARALO, INC.</b>	Elevation <b>3522</b>

Surface Location

UL or lot No. <b>F</b>	Section <b>3</b>	Township <b>19 S</b>	Range <b>28 E</b>	Lot Idn	Feet from the <b>1980</b>	North/South line <b>NORTH</b>	Feet from the <b>2280</b>	East/West line <b>WEST</b>	County <b>EDDY</b>
---------------------------	---------------------	-------------------------	----------------------	---------	------------------------------	----------------------------------	------------------------------	-------------------------------	-----------------------

Bottom Hole Location If Different From Surface

UL or lot No.	Section	Township	Range	Lot Idn	Feet from the	North/South line	Feet from the	East/West line	County
Dedicated Acres <b>320</b>	Joint or Infill	Consolidation Code	Order No.						

NO ALLOWABLE WILL BE ASSIGNED TO THIS COMPLETION UNTIL ALL INTERESTS HAVE BEEN CONSOLIDATED  
OR A NON-STANDARD UNIT HAS BEEN APPROVED BY THE DIVISION

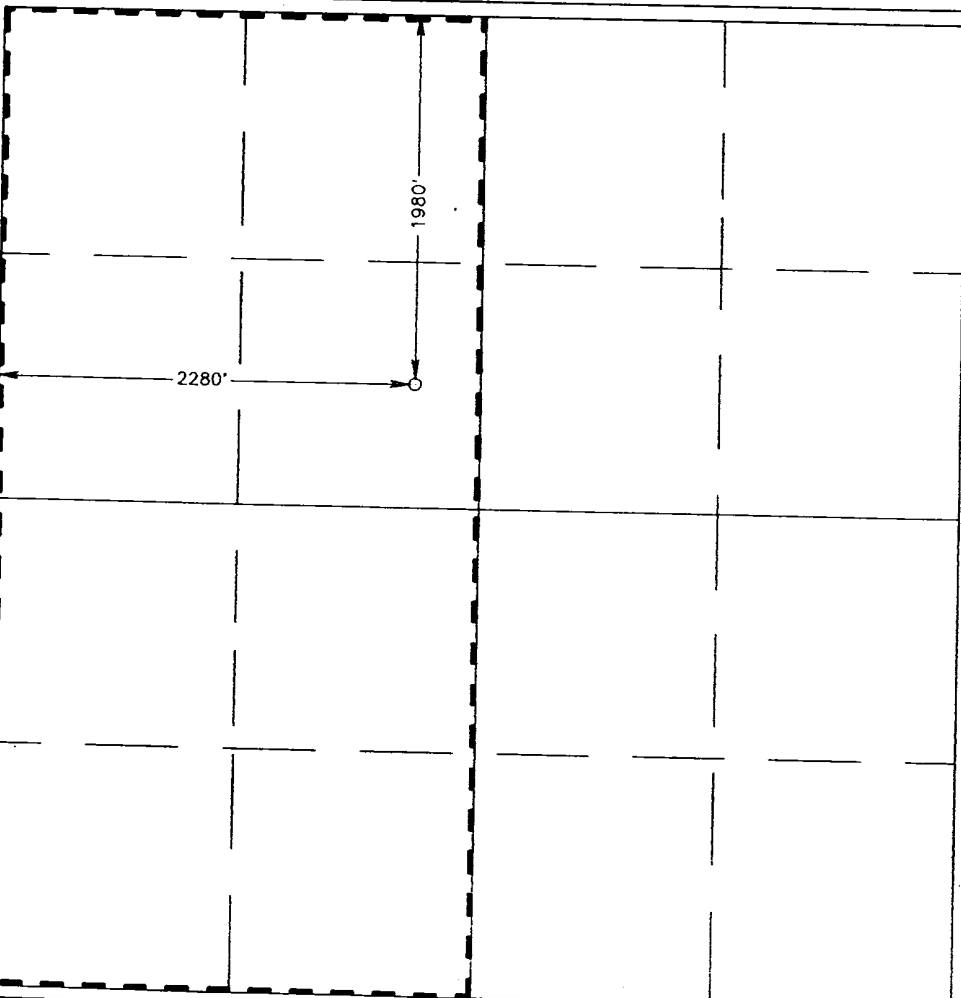
	<p><b>OPERATOR CERTIFICATION</b></p> <p>I hereby certify the the information contained herein is true and complete to the best of my knowledge and belief.</p> <p><i>Dorothea Logan</i> Signature <b>DOROTHEA LOGAN</b> Printed Name <b>REGULATORY ANALYST</b> Title <b>MAY 5, 1995</b> Date</p> <p><b>SURVEYOR CERTIFICATION</b></p> <p>I hereby certify that the well location shown on this plat was plotted from field notes of actual surveys made by me or under my supervision, and that the same is true and correct to the best of my belief.</p> <p><b>APRIL 28, 1995</b></p> <p>Date Surveyed Signature <i>Ronald E. Eidson</i> Professional Surveyor NEW MEXICO State Seal Num. 95-120681 Date No. <b>JOHN W. WEST</b> 676 <b>RONALD E. EIDSON</b> 3239 Certified Professional Surveyor <b>EIDSON</b> 12641</p>
--	---

# VICINITY MAP

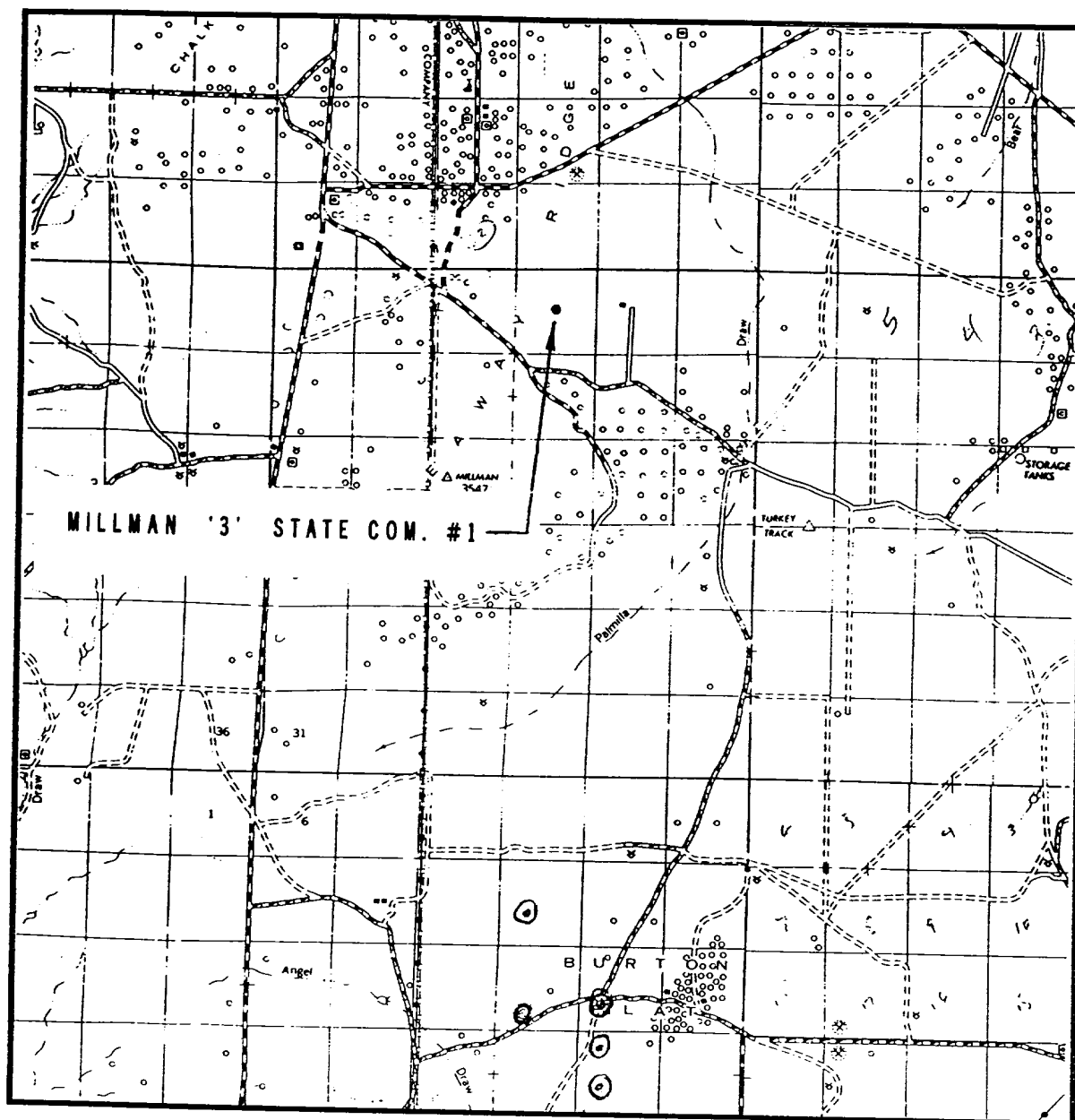

SCALE: 1" = 2 MILES

SEC. 3 TWP. 19-S RGE. 28-E

SURVEY N.M.P.M.

COUNTY EDDY

DESCRIPTION 1980' FNL & 2280' FWL

ELEVATION 3522

OPERATOR MARALO INC.

LEASE MILLMAN '3' STATE COM. #1

**JOHN WEST ENGINEERING  
HOBBS, NEW MEXICO**

**(505) 393-3117**

## LOCATION VERIFICATION MAP



SCALE: 1" = 2000'

CONTOUR INTERVAL - 10'

SEC. 3 TWP. 19-S RGE. 28-E

SURVEY \_\_\_\_\_ N.M.P.M.

COUNTY EDDY

DESCRIPTION 1980' FNL & 2280' FWL

ELEVATION 3522

OPERATOR MARALO INC.

LEASE HILLMAN '3' STATE COM. #1

U.S.G.S. TOPOGRAPHIC MAP

ILLINOIS CAMP, ILLINOIS CAMP N.E., N.M.

**JOHN WEST ENGINEERING  
HOBBS, NEW MEXICO  
(505) 393-3117**

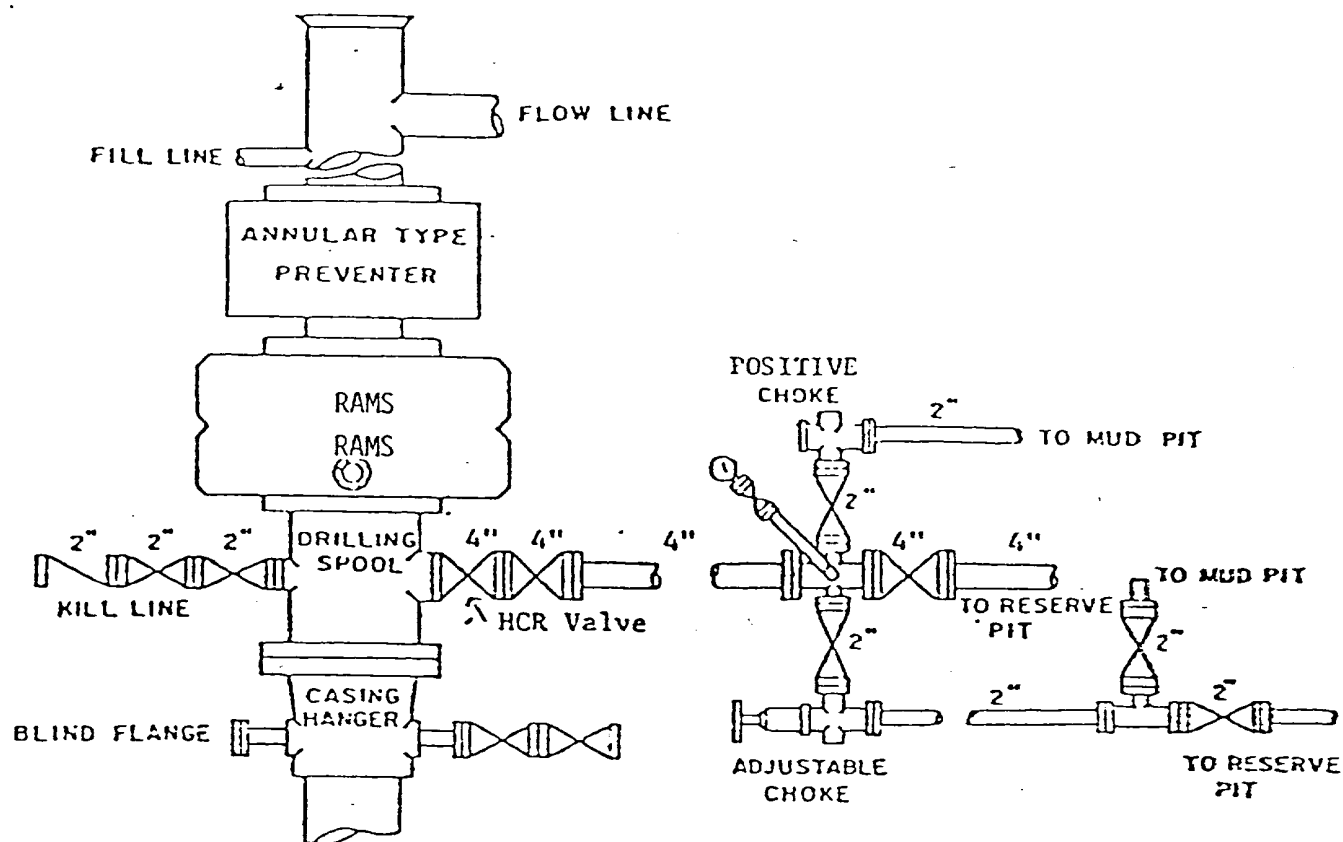

### BOP STACK

3000 PSI WORKING PRESSURE

BOP ARRANGEMENT