

District I
PO Box 1980, Hobbs, NM 88241-1980

District II
811 South First, Artesia, NM 88210

District III
1000 Rio Brazos Rd., Aztec, NM 87410

District IV
2040 South Pacheco, Santa Fe, NM 87505

State of New Mexico
Energy, Minerals & Natural Resources Department

OIL CONSERVATION DIVISION
2040 South Pacheco
Santa Fe, NM 87505

Form C-101
Revised October 18, 1994
Instructions on back
Submit to Appropriate District Office
State Lease - 6 Copies
Fee Lease - 5 Copies

AMENDED REPORT

APPLICATION FOR PERMIT TO DRILL, RE-ENTER, DEEPEN, PLUG BACK OR ADD A ZONE

Operator Name and Address Nearburg Producing Company 3300 N A St., Bldg 2, Suite 120 Midland, TX 79705		OGRID Number 015742
Property Code 25860		API Number 30-0 15-31126
Property Name Hubble 21 State Com		Well No. 1

Surface Location

UL or lot no.	Section	Township	Range	Lot Idn	Feet from the	North/South line	Feet from the	East/West Line	County
O	21	19S	28E		660	South	1650	East	Eddy

Proposed Bottom Hole Location If Different From Surface

UL or lot no.	Section	Township	Range	Lot Idn	Feet from the	North/South line	Feet from the	East/West Line	County
Proposed Pool 1					Proposed Pool 2				
Burton Estate Morrow (Gas)					Undes. Winchester; Morrow (GAS)				

Work Type Code N	Well Type Code G	Cable/Rotary R	Lease Type Code S	Ground Level Elevation 3405
Multiple No	Proposed Depth 11200	Formation Morrow	Contractor UTI	Spud Date 09-01-00

Minimum WOC time 8 hrs. Proposed Casing and Cement Program

Hole Size	Casing Size	Casing weight/foot	Setting Depth	Sacks of Cement	Estimated TOC
17-1/2"	13-3/8"	48#	400'	300 sx	Circ to surface
11"	8-5/8"	24# & 32 #	2600'	800 sx	Circ to surface
7-7/8"	5-1/2"	17#	11200'	500 sx	
To cover all oil, gas & water bearing zones					

²²Describe the proposed program. If this application is to DEEPEN or PLUG BACK give the data on the present productive zone and proposed new productive zone. Describe the blowout prevention program, if any. Use additional sheets if necessary.

Propose to drill the well to sufficient depth to evaluate the Morrow formation. After reaching TD, logs will be run and casing set if the evaluation is positive. Perforate, test and stimulate as necessary to establish production.

Acreage dedication is 320 acres; S/2 of Section 21.

²³ I hereby certify that the information given above is true and complete to the best of my knowledge and belief. Signature: <i>Kim Stewart</i>		OIL CONSERVATION DIVISION	
Printed name: Kim Stewart		Approved By: ORIGINAL SIGNED BY TIM W. GUM BGA DISTRICT II SUPERVISOR	
Title: Regulatory Analyst		Approval Date: MAY 08 2000 Expiration Date: MAY 08 2001	
Date: 05-03-00	Phone: 915/686-8235	Conditions of Approval: Attached: <input type="checkbox"/>	

DISTRICT I
P.O. Box 1980, Hobbs, NM 88241-1980

State of New Mexico
Energy, Minerals and Natural Resources Department

Form C-102
Revised February 10, 1994
Submit to Appropriate District Office
State Lease - 4 Copies
Fee Lease - 3 Copies

DISTRICT II
P.O. Drawer DD, Artesia, NM 88211-0719

DISTRICT III
1000 Rio Brazos Rd., Aztec, NM 87410

DISTRICT IV
P.O. BOX 2088, SANTA FE, N.M. 87504-2088

OIL CONSERVATION DIVISION

P.O. Box 2088
Santa Fe, New Mexico 87504-2088

☐ AMENDED REPORT

WELL LOCATION AND ACREAGE DEDICATION PLAT

API Number	Pool Code 73280	Pool Name Burton Flats; Morrow (Pro Gas)
Property Code	Property Name HUBBLE 21 STATE COM	Well Number 1
OGRID No. 015742	Operator Name NEARBURG PRODUCING COMPANY	Elevation 3405

Surface Location

UL or lot No.	Section	Township	Range	Lot Idn	Feet from the	North/South line	Feet from the	East/West line	County
0	21	19 S	28 E		660	SOUTH	1650	EAST	EDDY

Bottom Hole Location If Different From Surface

UL or lot No.	Section	Township	Range	Lot Idn	Feet from the	North/South line	Feet from the	East/West line	County
Dedicated Acres 320	Joint or Infill N	Consolidation Code	Order No.						

NO ALLOWABLE WILL BE ASSIGNED TO THIS COMPLETION UNTIL ALL INTERESTS HAVE BEEN CONSOLIDATED
OR A NON-STANDARD UNIT HAS BEEN APPROVED BY THE DIVISION

	OPERATOR CERTIFICATION <i>I hereby certify the the information contained herein is true and complete to the best of my knowledge and belief.</i> Signature Kim Stewart Printed Name Regulatory Analyst Title May 3, 2000 Date
	SURVEYOR CERTIFICATION <i>I hereby certify that the well location shown on this plat was plotted from field notes of actual surveys made by me or under my supervision and that the same is true and correct to the best of my belief.</i> APRIL 11, 2000 Date Surveyed Signature & Seal Professional Surveyor Certificate No. RONALD J. EIDSON 3239 GARY EIDSON 12641 MACOM McDONALD 12185

VICINITY MAP

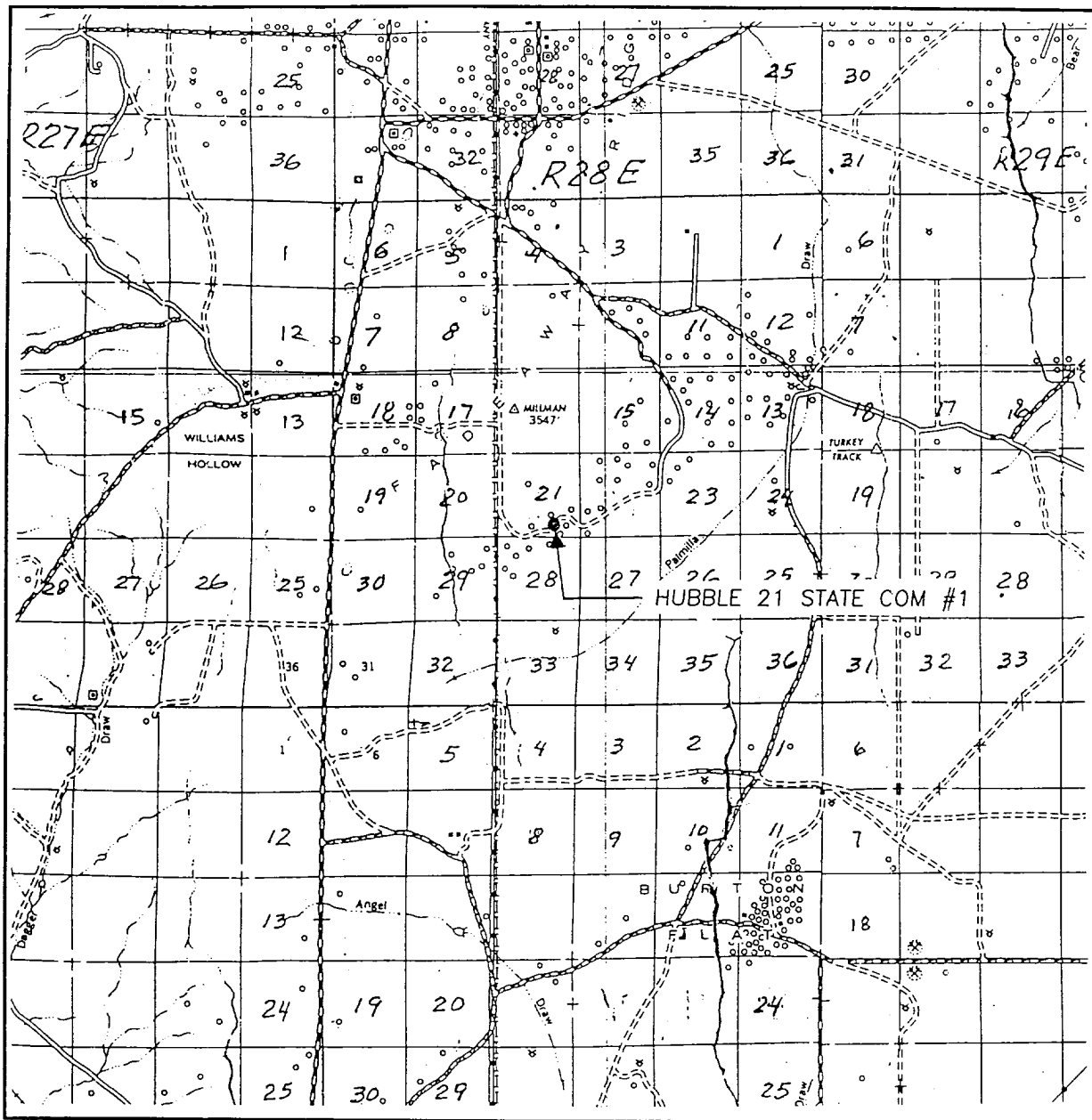

SCALE: 1" = 2 MILES

SEC. 21 TWP. 19-S RGE. 28-E

SURVEY N.M.P.M.

COUNTY EDDY

DESCRIPTION 660' FSL & 1650' FEL

ELEVATION 3405

NEARBURG
OPERATOR PRODUCING COMPANY

LEASE HUBBLE 21 STATE COM

JOHN WEST SURVEYING
HOBBS, NEW MEXICO
(505) 393-3117

CONTOUR INTERVAL:
ILLINOIS CAMP - 10'

ILLINOIS CAMP, N.M.

JOHN WEST SURVEYING
HOBBS, NEW MEXICO
(505) 393-3117

NE. ARBURG PRODUCING COMPAN^{NY}
CHOKE MANIFOLD
5M SERVICE

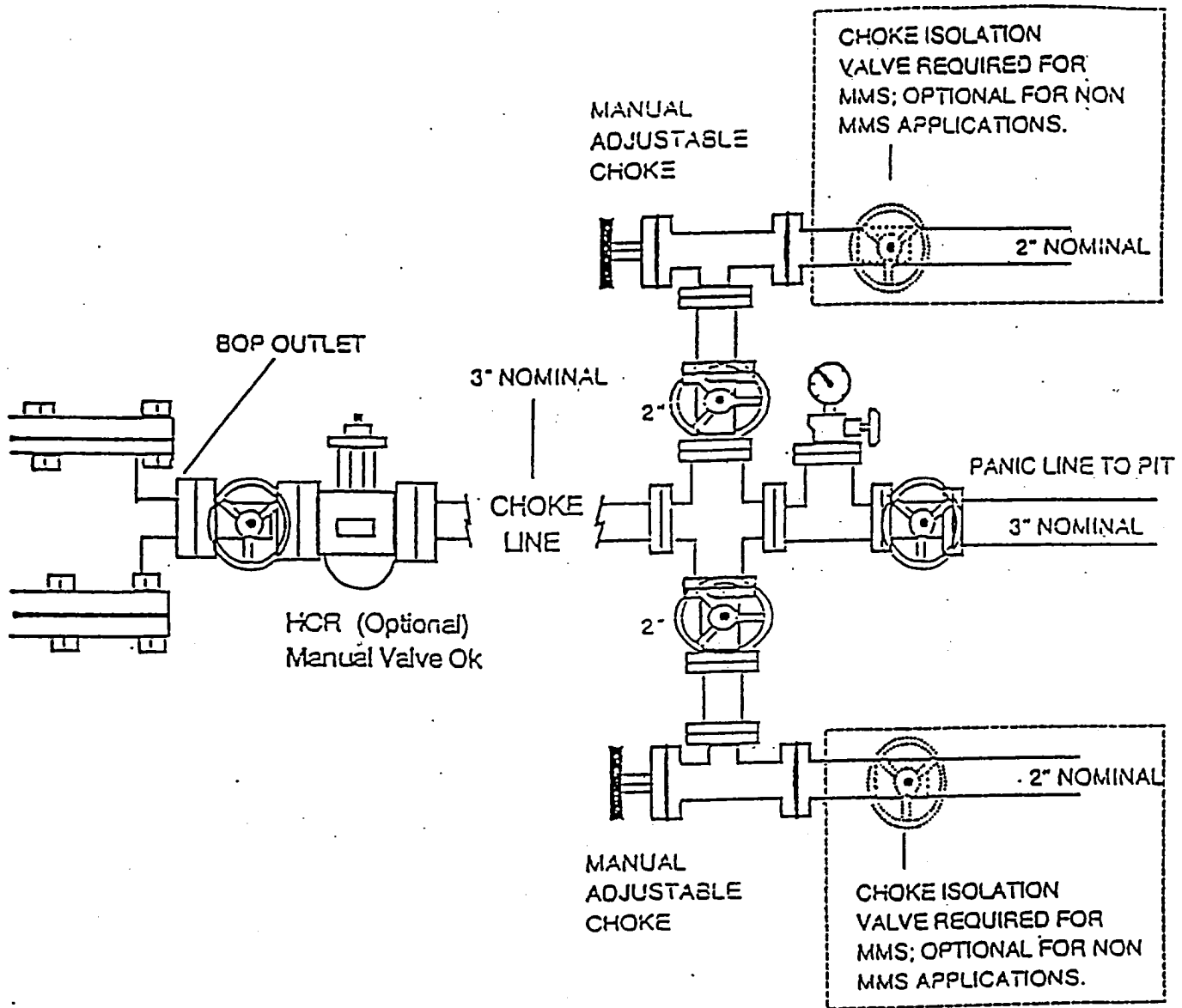

NEARBURG PRODUCING COMPANY
BOPE SCHEMATIC

Rotating Head (Optional)
Drilling Nipple option
must include a fill-up
line. Do not use kill line
for fill up.

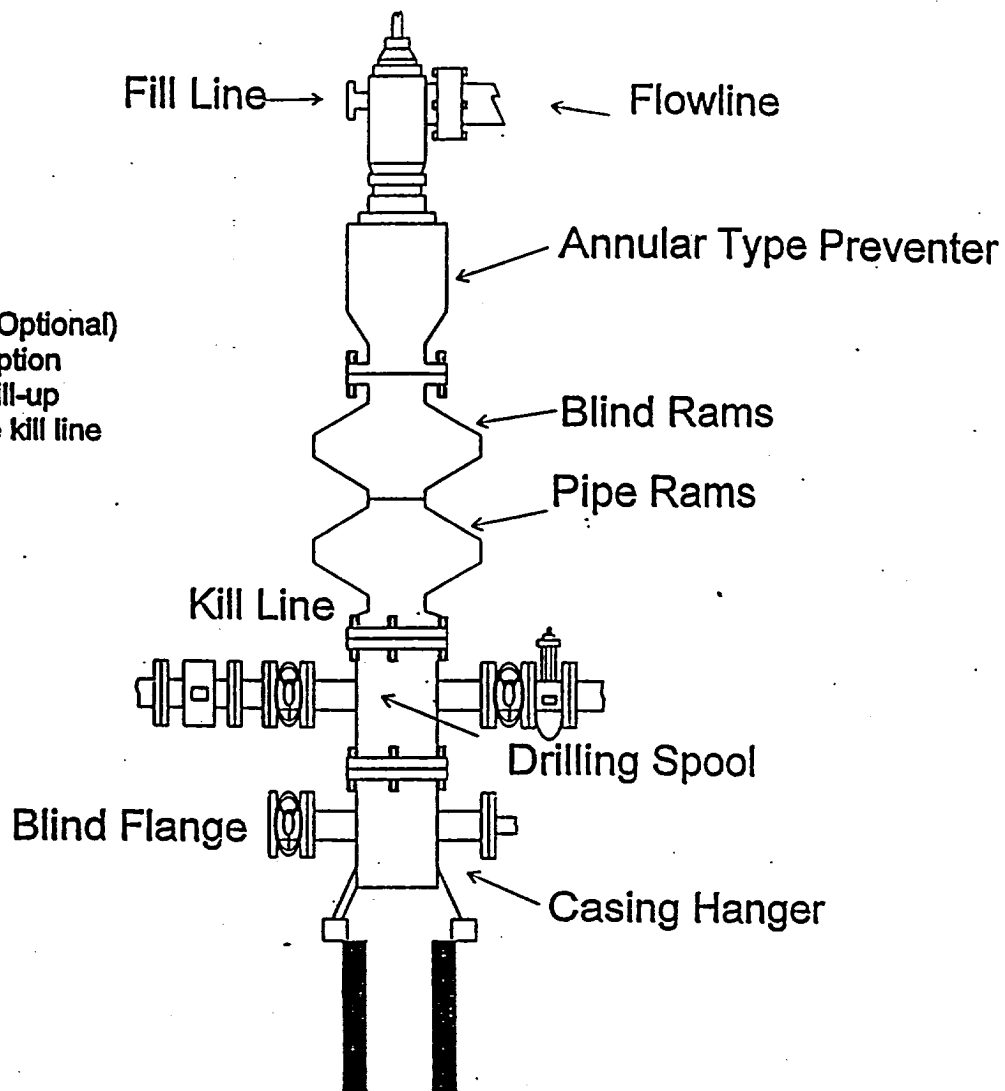

1500 Series