

NEW MEXICO OIL CONSERVATION COMMISSION
Santa Fe, New Mexico

NOTICE OF INTENTION TO DRILL OR RECOMPLETE

Notice must be given to the District Office of the Oil Conservation Commission and approval obtained before drilling or recompletion begins. If changes in the proposed plan are considered advisable, a copy of this notice showing such changes will be returned to the sender. Submit this notice in QUINTUPLICATE. One copy will be returned following approval. See additional instructions in Rules and Regulations of the Commission.

Hobbs, New Mexico
(Place)

May 13, 1963
(Date)

OIL CONSERVATION COMMISSION
SANTA FE, NEW MEXICO

Gentlemen:

You are hereby notified that it is our intention to commence the (Drilling) (Recompletion) of a well to be known as

Gulf Oil Corporation

(Company or Operator)

Block State AT (NCT-A)

(Lease)

Well No. **2**, in **I** (Unit). The well is

located **1650** feet from the **South** line and **330** feet from the

East

line of Section **21**, T. **19-S**, R. **28-E**, NMPM.

(GIVE LOCATION FROM SECTION LINE)

East Millman Pool, **Hobbs** County

If State Land the Oil and Gas Lease is No. **C-7815**

If patented land the owner is

Address

We propose to drill well with drilling equipment as follows: **Cable Tools**

The status of plugging bond is **Blanket**

Drilling Contractor **To be furnished later**

We intend to complete this well in the **Queen** formation at an approximate depth of **1800** feet.

CASING PROGRAM

We propose to use the following strings of Casing and to cement them as indicated:

Size of Hole	Size of Casing	Weight per Foot	New or Second Hand	Depth	Sacks Cement
11"	8-5/8"	24	New	250	Circulate
8"	6-1/2"	9.50	New	1800	200 sacks

If changes in the above plans become advisable we will notify you immediately.

ADDITIONAL INFORMATION (If recompletion give full details of proposed plan of work.)

Approved **MAY 14 1963**, 19
Except as follows:

OIL CONSERVATION COMMISSION

By **M. L. Armstrong**

Title **OIL AND GAS INSPECTOR**

Sincerely yours,

Gulf Oil Corporation
(Company or Operator)

By

Position **Area Production Manager**

Send Communications regarding well to

Name **Gulf Oil Corporation**

Address **Box 2167, Hobbs, New Mexico**

NEW MEXICO OIL CONSERVATION COMMISSION
WELL LOCATION AND ACREAGE DEDICATION PLAT

FORM C-128
Revised 5/1/57

SEE INSTRUCTIONS FOR COMPLETING THIS FORM ON THE REVERSE SIDE

SECTION A

Operator GULF OIL CORP.		Lease EDDY STATE "AV" NCT A		Well No. 2
Unit Letter I	Section 21	Township 19 SOUTH	Range 28 EAST	County EDDY
Actual Footage Location of Well: 1650 feet from the SOUTH line and 330 feet from the EAST line				
Ground Level Elev.	Producing Formation Green		Pool Port William	Dedicated Acreage: 60 Acres

1. Is the Operator the only owner in the dedicated acreage outlined on the plat below? YES ☒ NO ☐ ("Owner" means the person who has the right to drill into and to produce from any pool and to appropriate the production either for himself or for himself and another. (65-3-29 (e) NMSA 1935 Comp.)
2. If the answer to question one is "no," have the interests of all the owners been consolidated by communitization agreement or otherwise? YES ☐ NO ☐ . If answer is "yes," Type of Consolidation _____
3. If the answer to question two is "no," list all the owners and their respective interests below:

Owner	Land Description

SECTION B

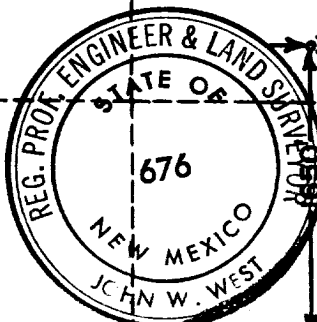

CERTIFICATION

I hereby certify that the information in SECTION A above is true and complete to the best of my knowledge and belief.

Name Ch. Boland
Position Area Production Manager
Company Gulf Oil Corporation
Date May 13, 1963

I hereby certify that the well location shown on the plat in SECTION B was plotted from field notes of actual surveys made by me or under my supervision, and that the same is true and correct to the best of my knowledge and belief.

Date Surveyed 4-17-63
Registered Professional Engineer and/or Land Surveyor, JOHN W. WEST
Certificate No. N.M. - P.E. & L.S. NO. 676

0 330 660 990 1320 1650 1980 2310 2640 2000 1500 1000 500

OIL CONSERVATION		
ARTESIA DISTRICT OFFICE		
No. Copies Required		6
DISTRIBUTION		
	NO. FURNISHED	
OPERATING	1	
STATION	1	
PRODUCTION		
STATE LAND OFFICE	1	
U. S. G. S.	2	
TRANSPORTER		
FILE	1	
BUREAU OF MINES		