

NO. OF COPIES RECEIVED	
DISTRIBUTION	
ALBUQUERQUE	1
EL PASO	1
U.S.G.S.	1
LAND OFFICE	1
OPERATOR	1

NEW MEXICO OIL CONSERVATION COMMISSION

SEP 16 1981

30-015-23924

Form C-101
Revised 1-1-65

5A. Indicate Type of Lease	
STATE <input checked="" type="checkbox"/>	FEE <input type="checkbox"/>
5. State Oil & Gas Lease No. E-7815	

APPLICATION FOR PERMIT TO DRILL, DEEPEN, OR PLUG BACK

6. Type of Work Type of Well OIL WELL <input checked="" type="checkbox"/> GAS WELL <input type="checkbox"/> OTHER <input type="checkbox"/> Name of Operator HARLAN OIL COMPANY ✓ Address of Operator P O Box 668, Artesia, N. M. 88210 Location of Well UNIT LETTER J LOCATED 2305 FEET FROM THE South LINE 1628 FEET FROM THE East LINE OF SEC. 21 TWP. 19 S RGE. 28 E NMPM		7. Unit Agreement Name	
DRILL <input checked="" type="checkbox"/> DEEPEN <input type="checkbox"/> PLUG BACK <input type="checkbox"/> SINGLE ZONE <input type="checkbox"/> MULTIPLE ZONE <input type="checkbox"/>		8. Farm or Lease Name Angell State	
		9. Well No. 6	
		10. Field and Pool, or Wildcat Millman Seven Rivers East	
		12. County Eddy	
18. Proposed Depth 1250		19A. Formation Seven Rivers	20. Rotary or C.T. C T
21A. Kind & Status Plug. Bond statewide active		22. Approx. Date Work will start 9/18/81	

PROPOSED CASING AND CEMENT PROGRAM

SIZE OF HOLE	SIZE OF CASING	WEIGHT PER FOOT	SETTING DEPTH	SACKS OF CEMENT	EST. TOP
12"	8 5/8"	24#	340'	100	circ.
7 7/8"	4 1/2"	10.50#	1250'	300	circ.

We propose to drill to 1250' to test the Seven Rivers formation. We will drill a 12" hole to 340' and set 8 5/8" 24# casing, reduce hole to 7 7/8" and drill on to 1250'. We will set 4 1/2" 10.50# production casing and cement with approximately 300 sx. We do not anticipate gas at this depth and will not set up a blowout preventer program at this time.

APPROVAL VALID FOR 180 DAYS
PERMIT EXPIRES 3-17-82
UNLESS DRILLING UNDERWAY

ABOVE SPACE DESCRIBE PROPOSED PROGRAM: IF PROPOSAL IS TO DEEPEN OR PLUG BACK, GIVE DATA ON PRESENT PRODUCTIVE ZONE AND PROPOSED NEW PRODUCTION ZONE. GIVE BLOWOUT PREVENTER PROGRAM, IF ANY.

I hereby certify that the information above is true and complete to the best of my knowledge and belief.

Signed Norothy Hammond Title Production Clerk Date 9/15/81
(This space for State Use)

APPROVED BY W. A. Gressett TITLE SUPERVISOR, DISTRICT II DATE SEP 17 1981
CONDITIONS OF APPROVAL, IF ANY:

NEW MEXICO OIL CONSERVATION COMMISSION
W. LOCATION AND ACREAGE DEDICATION PLAT

Form C-102
Supersedes C-128
Effective 1-1-85

All distances must be from the outer boundaries of the Section.

Operator HARLAN OIL COMPANY			Lease ANGELL STATE			Well No. 6
Unit Letter J	Section 21	Township 19 South	Range 28 East	County EDDY		
Actual Footage Location of Well: 2305 feet from the South line and 1628 feet from the East line						
Ground Level Elev. 3460	Producing Formation Seven Rivers		Pool Millman Seven Rivers East		Dedicated Acreage: 40 Acres	

1. Outline the acreage dedicated to the subject well by colored pencil or hachure marks on the plat below.
2. If more than one lease is dedicated to the well, outline each and identify the ownership thereof (both as to working interest and royalty).
3. If more than one lease of different ownership is dedicated to the well, have the interests of all owners been consolidated by communization, unitization, force-pooling, etc?

☐ Yes ☐ No If answer is "yes," type of consolidation _____

If answer is "no," list the owners and tract descriptions which have actually been consolidated. (Use reverse side of this form if necessary.) _____

No allowable will be assigned to the well until all interests have been consolidated (by communization, unitization, forced-pooling, or otherwise) or until a non-standard unit, eliminating such interests, has been approved by the Commission.

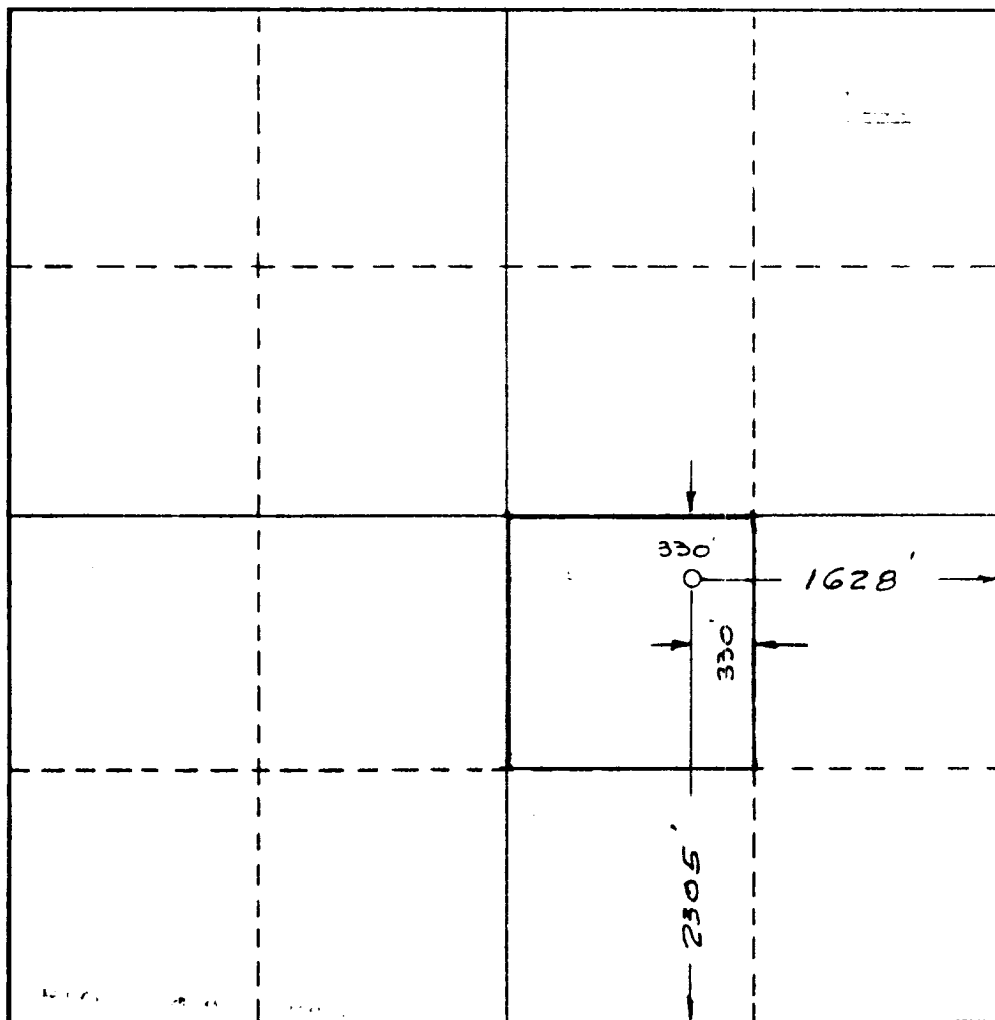

CERTIFICATION

I hereby certify that the information contained herein is true and complete to the best of my knowledge and belief.

Name
Dorothy Hammond

Position
Production Clerk

Company
Harlan Oil Company

Date
9/15/81

I hereby certify that the well location shown on this plat was plotted from field notes of actual surveys made by me or under my supervision, and that the same is true and correct to the best of my knowledge and belief.

Date Surveyed
March 25 & 26, 1981

Registered Professional Engineer and/or Land Surveyor

Certificate No.
1559