

NEW MEXICO OIL CONSERVATION COMMISSION
WELL LOCATION AND ACREAGE DEDICATION

Form C-102
Supersedes C-128
Effective 1-1-65

All distances must be from the outer boundaries of the Section

Operator Southland Royalty Company			Lease State 18 Comm.		Well No. 1
Unit Letter K	Section 18	Township 19 South	Range 28 East	County Eddy	
Actual Footage Location of Well: 1980 feet from the West line and 1810 feet from the South line					
Ground Level Elev. 3508.5	Producing Formation Strawn		Pool Millman (Strawn)		Dedicated Acreage: 326.12 Acres

- Outline the acreage dedicated to the subject well by colored pencil or hachure marks on the plat below.
- If more than one lease is dedicated to the well, outline each and identify the ownership (include all working interest and royalty).
- If more than one lease of different ownership is dedicated to the well, have the interests of all owners been consolidated by communitization, unitization, force-pooling, etc?

☒ Yes ☐ No If answer is "yes," type of consolidation Communitization **O. C. C. ARTEBIA, OFFICE**

If answer is "no," list the owners and tract descriptions which have actually been consolidated. (Use reverse side of this form if necessary.)

No allowable will be assigned to the well until all interests have been consolidated (by communitization, unitization, forced-pooling, or otherwise) or until a non-standard unit, eliminating such interests, has been approved by the Commission.

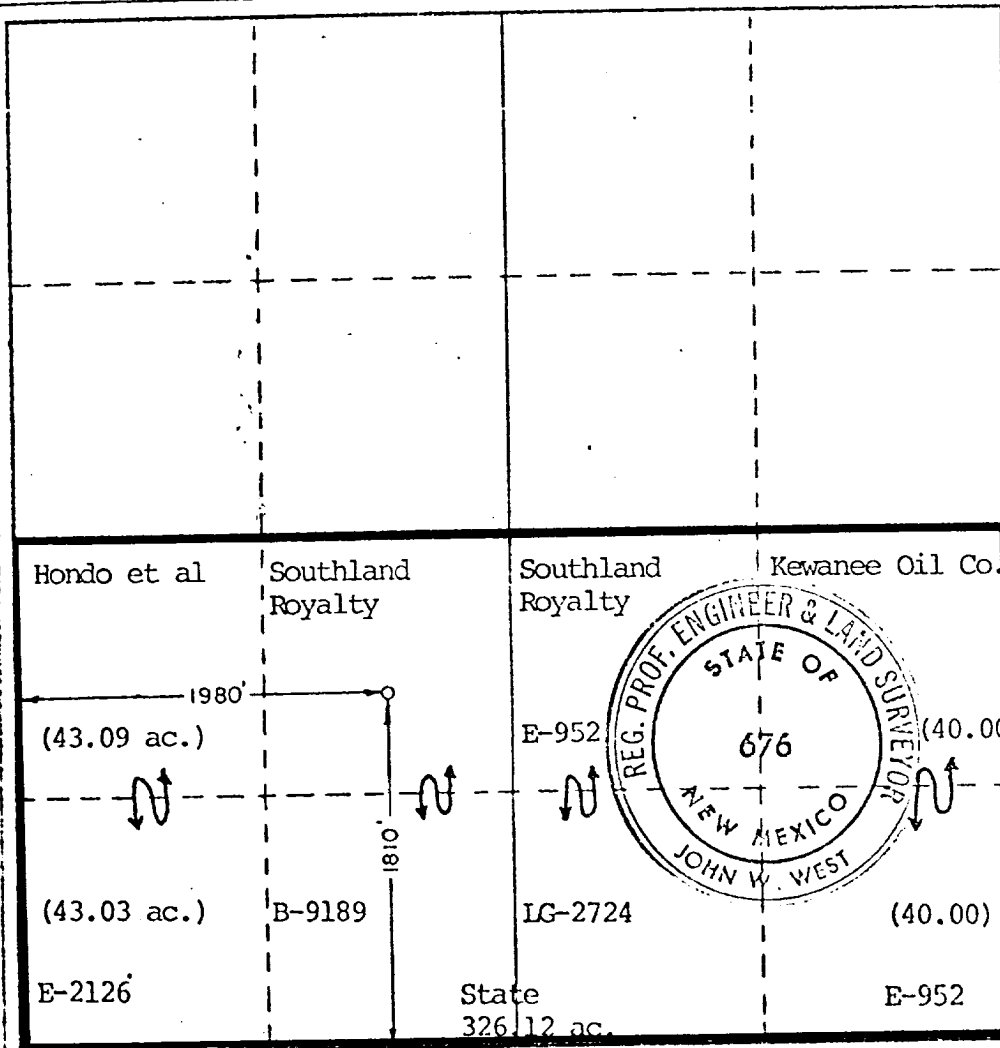

CERTIFICATION

I hereby certify that the information contained herein is true and complete to the best of my knowledge and belief.

Name
Donald R. Craig
Position
Petroleum Engineer
Company
SOUTHLAND ROYALTY COMPANY
Date
March 20, 1978

I hereby certify that the well location shown on this plat was plotted from field notes of actual surveys made by me or under my supervision, and that the same is true and correct to the best of my knowledge and belief.

Date Surveyed
3/18/78
Registered Professional Engineer and/or Land Surveyor
John W. West
Certificate No. **John W. West 676**
Ronald J. Eidson 3232