

NUMBER OF COPIES RECEIVED <b>6</b>	
DISTRIBUTION	
SANTA FE	1
FILE	1
U.S.G.S.	1
LAND OFFICE	1
TRANSPORTER	
OIL GAS	
PROBATION OFFICE	
OPERATOR	1

NEW MEXICO OIL CONSERVATION COMMISSION  
Santa Fe, New Mexico

Form C-101  
Revised 12/1/55

30-015-20062

NOTICE OF INTENTION TO DRILL

Notice must be given to the District Office of the Oil Conservation Commission and approval obtained before drilling or recompletion begins. If changes in the proposed plan are considered advisable, a copy of this notice showing such changes will be returned to the sender. Submit this notice in QUINTUPPLICATE. One copy will be returned following approval. See additional instructions in Rules and Regulations of the Commission. If State Land submit 6 Copies. Attach Form C-128 in triplicate to first 3 copies of Form C-101.

ROSWELL, NEW MEXICO

JUNE 8, 1967

(Place)

(Date)

OIL CONSERVATION COMMISSION  
SANTA FE, NEW MEXICO

Gentlemen:

You are hereby notified that it is our intention to commence the Drilling of a well to be known as

**JACK L. MCCLELLAN**

(Company or Operator)

**MARK STATE**

, Well No. **1000 3**, in **3** The well is

located **2200** feet from the **NORTH** line and **1650** feet from the **EAST** line of Section **18**, T. **19-S**, R. **28-C**, NMPM.

(GIVE LOCATION FROM SECTION LINE)

**MILLMAN** Pool, **OG - 648** County

D	C	B	A
E	F	G	H
L	K	J	I
M	N	O	P

If State Land the Oil and Gas Lease is No. \_\_\_\_\_

If patented land the owner is \_\_\_\_\_

Address \_\_\_\_\_

We propose to drill well with drilling equipment as follows:

**SURFACE TO A TOTAL DEPTH OF APPROX. 2000 FEET.**

**STATEWIDE**

The status of plugging bond is \_\_\_\_\_

**CORTES DRILLING COMPANY, ARTESIA, N. M.**

Drilling Contractor \_\_\_\_\_

We intend to complete this well in the **GRAYSBURG** formation at an approximate depth of **2000** feet.

CASING PROGRAM

We propose to use the following strings of Casing and to cement them as indicated:

Size of Hole	Size of Casing	Weight per Foot	New or Second Hand	Depth	Sacks Cement
<b>10-3/4</b>	<b>8-5/8</b>	<b>20 LB.</b>	<b>USED</b>	<b>400</b>	<b>50 SX</b>
<b>7-7/8</b>	<b>4-1/2</b>	<b>9 1/2 LB.</b>	<b>NEW</b>	<b>2000</b>	<b>100 SX</b>

If changes in the above plans become advisable we will notify you immediately.

ADDITIONAL INFORMATION (If recompletion give full details of proposed plan of work.)

Calculated volume of cement sufficient to circulate must be used in cementing surface casing.

Approved **JUN 12 1967**, 19\_\_\_\_  
Except as follows:

APPROVAL VALID  
FOR 90 DAYS UNLESS  
DRILLING COMMENCED,

EXPIRES **9-9-67**

OIL CONSERVATION COMMISSION

By

Sincerely yours,

**JACK L. MCCLELLAN**

(Company or Operator)

By

**OPERATOR**

Position

Send Communications regarding well to

Name **JACK L. MCCLELLAN**  
Address **BOX 843, ROSWELL, N. M. 88201**

RECEIVED

JUN 9 1967

O. C. C.  
ARTESIA, OFFICE

NEW MEXICO OIL CONSERVATION COMMISSION  
WELL LOCATION AND ACREAGE DEDICATION PLAT

Form C-102  
Supersedes C-128  
Effective 1-1-65

All distances must be from the outer boundaries of the Section.

Operator <b>Jack L. McClellan</b>			Lease <b>Mark - State</b>		Well No. <b>XXX 3</b>
Unit Letter <b>G</b>	Section <b>18</b>	Township <b>T-19-S</b>	Range <b>R-28-E</b>	County <b>Eddy</b>	
Actual Footage Location of Well: <b>2260</b> feet from the <b>North</b> line and <b>1650</b> feet from the <b>East</b> line					
Ground Level Elev. <b>3522 3513</b>	Producing Formation <b>Grayburg</b>	Pool <b>Millman</b>		Dedicated Acreage: <b>40</b> Acres	

1. Outline the acreage dedicated to the subject well by colored pencil or hatchure marks on the plat below.
2. If more than one lease is dedicated to the well, outline each and identify the ownership thereof (both as to working interest and royalty).
3. If more than one lease of different ownership is dedicated to the well, have the interests of all owners been consolidated by communitization, unitization, force-pooling, etc?

☐ Yes ☐ No If answer is "yes," type of consolidation UNIT 9 1967

If answer is "no," list the owners and tract descriptions which have actually been consolidated (On the reverse side of this form if necessary.) ARLESIA OFFICE

No allowable will be assigned to the well until all interests have been consolidated (by communitization, unitization, forced-pooling, or otherwise) or until a non-standard unit, eliminating such interests, has been approved by the Commission.

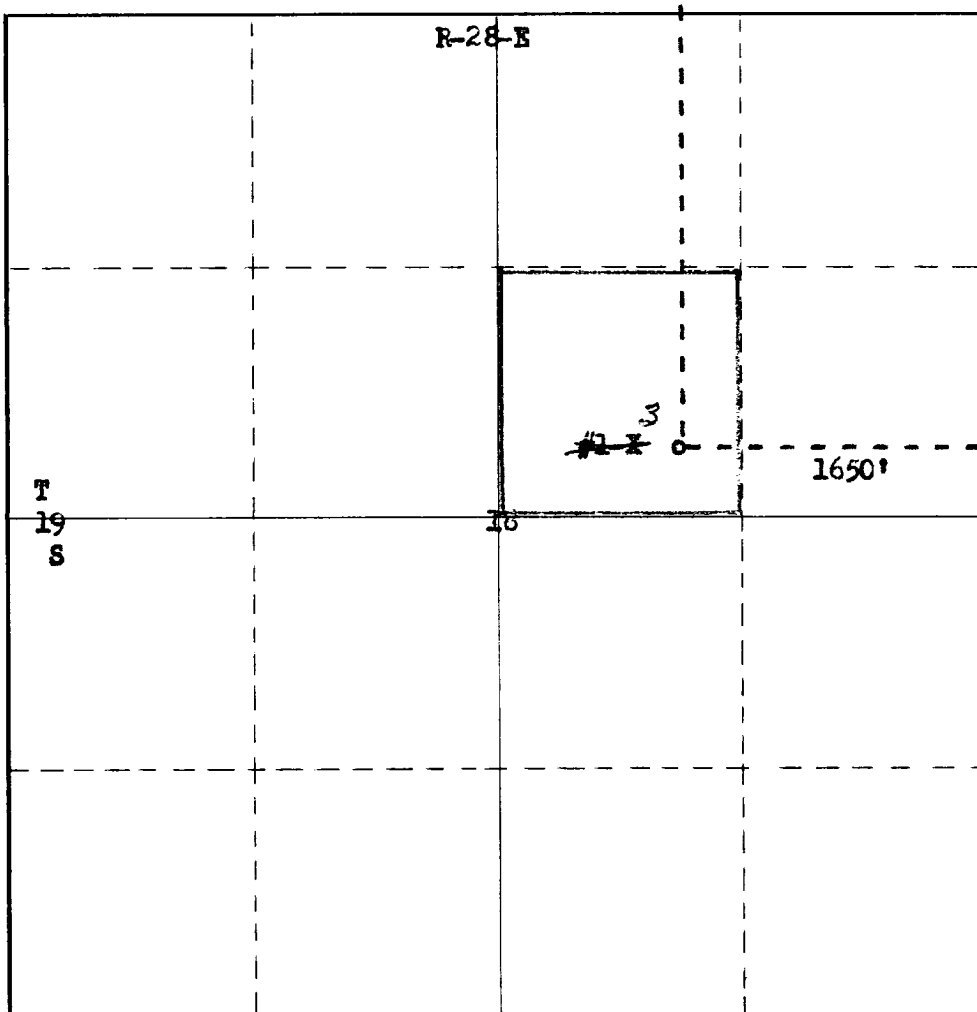

**CERTIFICATION**

*I hereby certify that the information contained herein is true and complete to the best of my knowledge and belief.*

Name Jack L. McClellan  
 Position OPERATOR  
 Company JACK L. MCCLELLAN  
 Date JUNE 3, 1967

*I hereby certify that the well location shown on this plat was plotted from field notes of actual surveys made by me or under my supervision, and that the same is true and correct to the best of my knowledge and belief.*

Date Surveyed June 6, 1967  
 Registered Professional Engineer and/or Land Surveyor  
James H. Brown  
 Certificate No. 542

