

|                        |                                     |
|------------------------|-------------------------------------|
| NO. OF COPIES RECEIVED |                                     |
| DISTRIBUTION           |                                     |
| SANTA FE               | <input checked="" type="checkbox"/> |
| FILE                   | <input checked="" type="checkbox"/> |
| U.S.G.S.               | <input checked="" type="checkbox"/> |
| LAND OFFICE            | <input checked="" type="checkbox"/> |
| OPERATOR               | <input checked="" type="checkbox"/> |

MAR 07 1983

O. C. D.

5A. Indicate Type of Lease  
STATE ☒ FEE ☐  
5. State Oil & Gas Lease No.  
E-648

APPLICATION FOR PERMIT TO DRILL, DEEPEN OR PLUG BACK

Type of Work Deepen  
Type of Well DRILL ☒ DEEPEN ☐ PLUG BACK ☐  
OIL WELL ☒ GAS WELL ☐ OTHER ☐ SINGLE ZONE ☒ MULTIPLE ZONE ☐  
Name of Operator C.E. LaRue & B.N. Muncy Jr.  
Address of Operator c/o Ruth Henry, Henry & Ross, 512 W. Texas, Artesia, N.M. 88210  
Location of Well UNIT LETTER H LOCATED 2299 FEET FROM THE North LINE  
973 FEET FROM THE East LINE OF SEC. 18 TWP. 19 RGE. 28 NMPM

7. Unit Agreement Name  
8. Farm or Lease Name  
State  
9. Well No.  
1  
10. Field and Pool, or Wildcat  
Millman Grayburg  
12. County  
Eddy

19. Proposed Depth 2300 19A. Formation Grayburg 20. Rotary or C.T.  
Cable tools  
Elevations (Show whether DF, KT, etc.) 3519 gr. 21A. Kind & Status Plug. Bond Blanket-Current 21B. Drilling Contractor Paul Hegwer 22. Approx. Date Work will start  
3-4-83

PROPOSED CASING AND CEMENT PROGRAM

| SIZE OF HOLE | SIZE OF CASING   | WEIGHT PER FOOT | SETTING DEPTH | SACKS OF CEMENT | EST. TOP  |
|--------------|------------------|-----------------|---------------|-----------------|-----------|
| 10"          | 8 5/8"           | 20#             | 415           | 200             | Circulate |
| 8"           | 4 1/2" or 5 1/2" | 9.5 or 14#      | 2300          | 500             | Circulate |

*Posted a pg  
10-1-83  
3-11-83*

APPROVAL VALID FOR 180 DAYS  
PERMIT EXPIRES 9/9/83  
UNLESS DRILLING UNDERWAY

ABOVE SPACE DESCRIBE PROPOSED PROGRAM: IF PROPOSAL IS TO DEEPEN OR PLUS BACK, GIVE DATA ON PRESENT PRODUCTIVE ZONE AND PROPOSED NEW PRODUCTION ZONE. GIVE BLOWOUT PREVENTER PROGRAM, IF ANY.

I hereby certify that the information above is true and complete to the best of my knowledge and belief.

by W. G. Gressett Title Consultant Date 3-4-83  
(This space for State Use)

PROVED BY Mike Walker TITLE OIL AND GAS INSPECTOR DATE MAR 09 1983  
CONDITIONS OF APPROVAL, IF ANY:

**NEW MEXICO OIL CONSERVATION COMMISSION  
WELL LOCATION AND ACREAGE DEDICATION PLAT**

Form C-102  
Supersedes C-128  
Effective 1-1-65

All distances must be from the outer boundaries of the Section

|  |  |                                 |                                       |                       |                      |
|--|--|---------------------------------|---------------------------------------|-----------------------|----------------------|
| Operator<br><b>C.E. LaRue &amp; B.N. Muncy Jr.</b>   |  |                                 | Lease<br><b>State</b>                 |                       | Well No.<br><b>1</b> |
| Section Letter<br><b>H</b>   | Section<br><b>18</b>                   | Township<br><b>19 South</b>     | Range<br><b>28 East</b>               | County<br><b>Eddy</b> |                      |
| Approximate Location of Well:<br><div style="display: flex; justify-content: space-between;"> <span>2299 feet from the</span> <span><b>north</b> line and</span> <span>973 feet from the</span> <span><b>east</b> line</span> </div> |  |                                 |                                       |                       |                      |
| Well Depth Elev.<br><b>3519.0'</b>   | Producing Formation<br><i>Grayburg</i> | Pool<br><i>millman Grayburg</i> | Dedicated Acreage:<br><b>40</b> Acres |                       |                      |

1. Outline the acreage dedicated to the subject well by colored pencil or hatchure marks on the plat below.
2. If more than one lease is dedicated to the well, outline each and identify the ownership thereof (both as to working interest and royalty).
3. If more than one lease of different ownership is dedicated to the well, have the interests of all owners been consolidated by communitization, unitization, force-pooling, etc?

☐ Yes    ☐ No    If answer is "yes," type of consolidation \_\_\_\_\_

If answer is "no," list the owners and tract descriptions which have actually been consolidated. (Use reverse side of this form if necessary.) \_\_\_\_\_

No allowable will be assigned to the well until all interests have been consolidated (by communitization, unitization, forced-pooling, or otherwise) or until a non-standard unit, eliminating such interests, has been approved by the Commission.

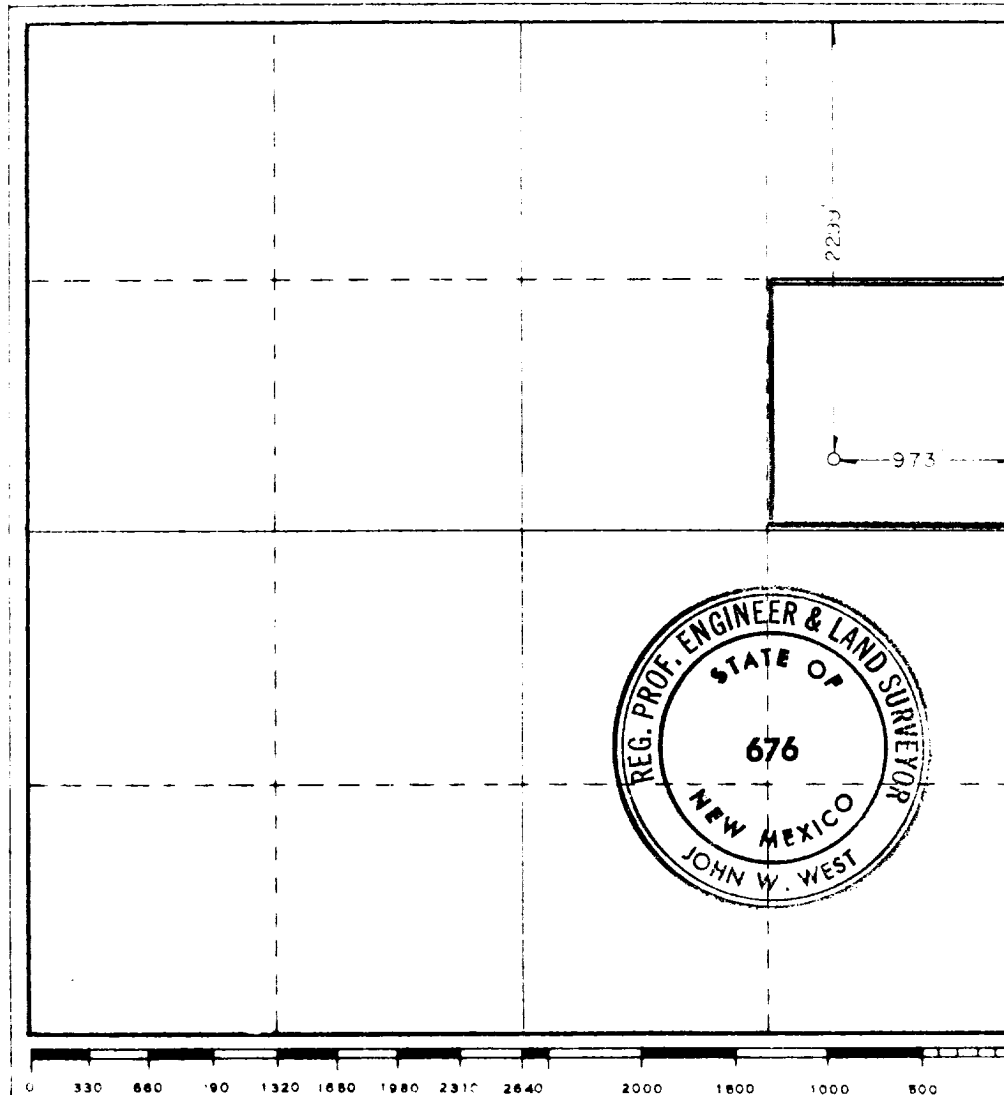

**CERTIFICATION**

I hereby certify that the information contained herein is true and complete to the best of my knowledge and belief.

Signature: *W.A. Grossert*  
 Title: *Consultant*  
 For: *C.E. LaRue & B.N. Muncy Jr.*  
 Date: *3-4-83*

I hereby certify that the well location shown on this plat was plotted from field notes of actual surveys made by me or under my supervision, and that the same is true and correct to the best of my knowledge and belief.

Date Surveyed:  
**Feb. 26, 1983**  
 Registered Professional Engineer  
 and/or Land Surveyor

Certificate No.  
**John W. West, NM L.S. 676**