

SECTION 1, TOWN IP 19 SOUTH, RANGE 28 EAST, N.M.P.M.,
 EDDY COUNTY, NEW MEXICO.

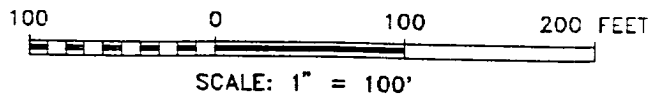
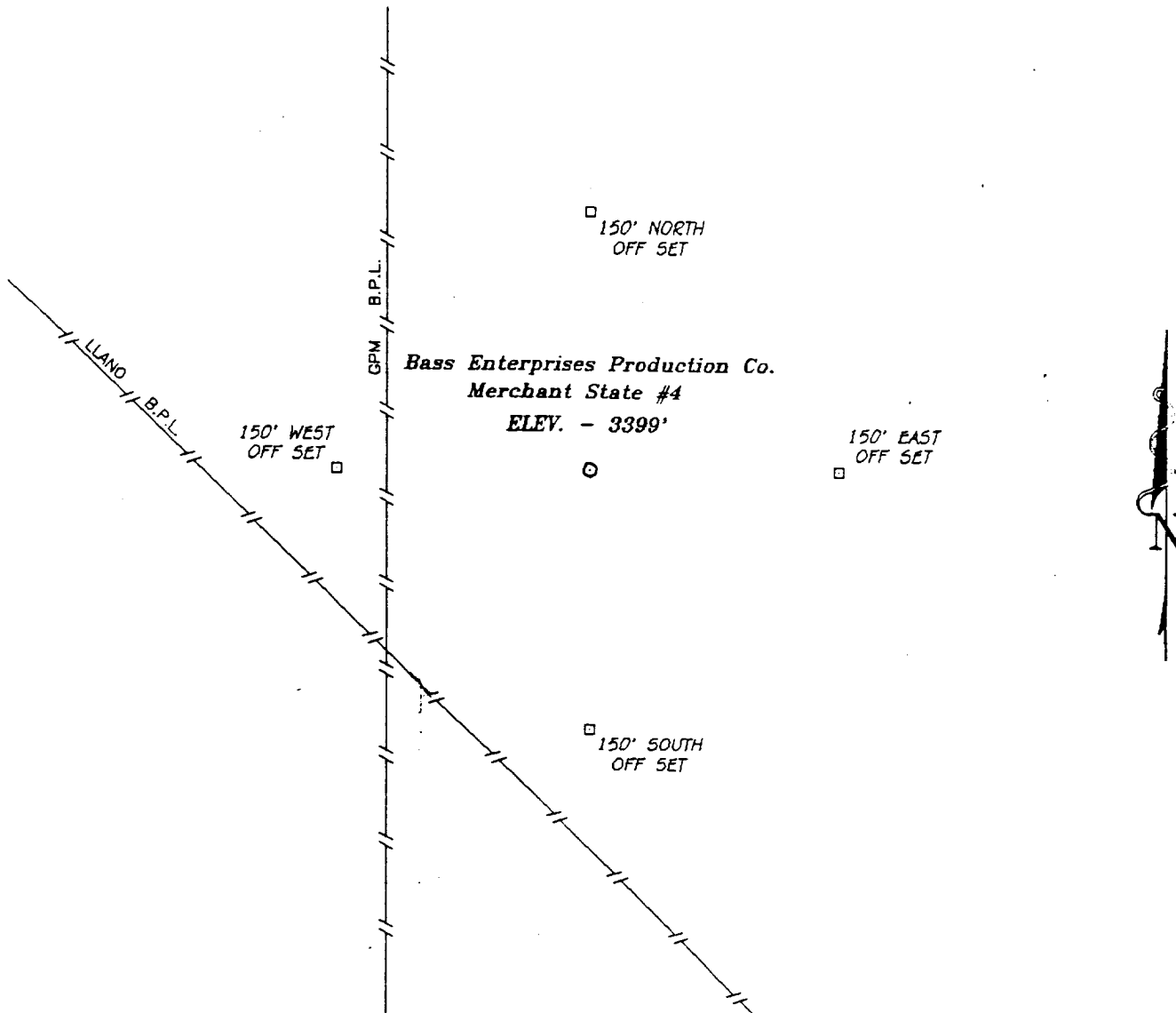

BASS ENTERPRISES PRODUCTION CO.
 REF: Merchant State No. 4 / Well Pad Topo
 THE MERCHANT STATE No. 4 LOCATED 660' FROM THE
 NORTH LINE AND 2080' FROM THE WEST LINE OF
 SECTION 1, TOWNSHIP 19 SOUTH, RANGE 28 EAST,
 N.M.P.M., EDDY COUNTY, NEW MEXICO.

BASIN SURVEYS P.O. BOX 1786-HOBBS, NEW MEXICO

W.O. Number: 6590 Drawn By: S.C. NICHOLS

Date: 12-24-96 Disk: SCN #33 - BAS6591B.DWG Survey Date: 12-23-96 Sheet 1 of 1 Sheets