

District I
PO Box 1980, Hobbs, NM 88241-1980

District II
811 South First, Artesia, NM 88210

District III
1000 Rio Brazos Rd., Aztec, NM 87410

District IV
2040 South Pacheco, Santa Fe, NM 87505

State of New Mexico
Energy, Minerals & Natural Resources Department

OIL CONSERVATION DIVISION
2040 South Pacheco
Santa Fe, NM 87505

Form C-101

Revised October 18, 1994

Instructions on back

Submit to Appropriate District Office

State Lease - 6 Copies

Fee Lease - 5 Copies

☐ AMENDED REPORT

APPLICATION FOR PERMIT TO DRILL, RE-ENTER, DEEPEN, PLUG BACK, OR ADD A ZONE

Operator Name and Address Mewbourne Oil Company PO Box 5270 Hobbs, N. Mx. 88241		OGRID Number 14744
Property Name S. P. Johnson		API Number 30 - 0 15 - 29993
Property Code 22249	Well No. 2	

Surface Location

UL or lot no.	Section	Township	Range	Lot Idn	Feet from the	North/South line	Feet from the	East/West Line	County
G	5	20S	25E		1650	North	1980	East	Eddy

Proposed Bottom Hole Location If Different From Surface

UL or lot no.	Section	Township	Range	Lot Idn	Feet from the	North/South line	Feet from the	East/West Line	County
Proposed Pool 1 Dagger Draw; Upper Penn., North (15472)					Proposed Pool 2				

Work Type Code N	Well Type Code O	Cable/Rotary R	Lease Type Code S	Ground Level Elevation 3499'
Multiple No	Proposed Depth 8100	Formation Upper Penn.	Contractor Unknown	Spud Date AFTER APPROVAL

Proposed Casing and Cement Program

Hole Size	Casing Size	Casing weight/foot	Setting Depth	Sacks of Cement	Estimated TOC
14 3/4"	9 5/8"	36#	1200	800	Circulate
8 3/4"	7"	23# & 26#	8100	950	Tie Back
				Part ID-1	
				1-16-98	
				API & LAC	

Describe the proposed program. If this application is to DEEPEN or PLUG BACK give the data on the present productive zone and proposed new productive zone. Describe the blowout prevention program, if any. Use additional sheets if necessary.

BOP PROGRAM: Schaffer LWS or equivalent (double-ram hydraulic) 900 series w/hydril, bag-type hydraulic, from surface casing to total depth.

MUD PROGRAM: 0' to 1200': Fresh water, spud mud & LCM as needed.

1200' to 7500' cut brine, lime, & LCM as needed

7500' to TD: Cut brine / drispac, salt gel, starch, soda ash, caustic soda, Wt: 9.0 - 9.8, WL 10cc or less viscosity: 32 - 40 cp.

I hereby certify that the information given above is true and complete to the best of my knowledge and belief.

Signature:

Printed name: Steve Matthews

Title: Drilling Superintendent

OIL CONSERVATION DIVISION

Approved By:

ORIGINAL SIGNED BY TIM W. GUM
DISTRICT II SUPERVISOR

Title:

Approval Date:

JAN 8 1998

Expiration Date:

1-8-99

DISTRICT I
P.O. Box 1980, Hobbs, NM 88240

DISTRICT II
P.O. Drawer DD, Artesia, NM 88210

DISTRICT III
1000 Rio Brazos Rd., Aztec, NM 87410

State of New Mexico
Energy, Minerals and Natural Resources Department

Form O-102
Revised February 10, 1994
Instruction on back
Submit to Appropriate District Office
State Lease - 4 Copies
Fee Lease - 3 Copies

OIL CONSERVATION DIVISION
P.O. Box 2088
Santa Fe, New Mexico 87504-2088

JAN 1998
RECEIVED
OCD - ARTESIA

☐ AMENDED REPORT

WELL LOCATION AND ACREAGE DEDICATION PLAT

API Number	Pool Code	Pool Name
Property Code	Property Name S.P. JOHNSON	Well Number 2
OGRID No.	Operator Name MEWBOURNE OIL COMPANY	Elevation 3499



Surface Location

UL or lot No.	Section	Township	Range	Lot Idn	Feet from the	North/South line	Feet from the	East/West line	County
G	5	20S	25E		1650	NORTH	1980	EAST	EDDY

Bottom Hole Location If Different From Surface

UL or lot No.	Section	Township	Range	Lot Idn	Feet from the	North/South line	Feet from the	East/West line	County
Dedicated Acres	Joint or Infill	Consolidation Code	Order No.						

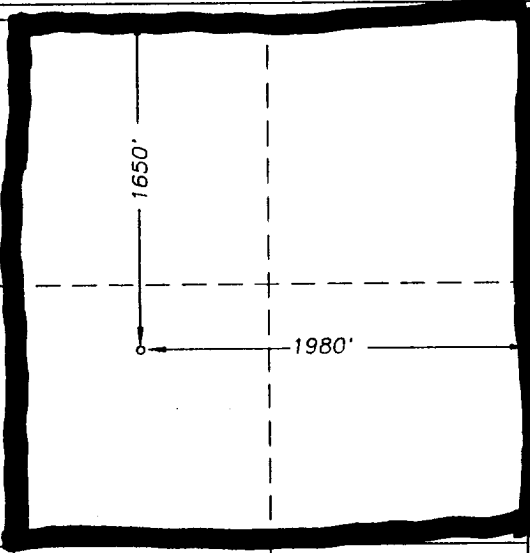
NO ALLOWABLE WILL BE ASSIGNED TO THIS COMPLETION UNTIL ALL INTERESTS HAVE BEEN CONSOLIDATED
OR A NON-STANDARD UNIT HAS BEEN APPROVED BY THE DIVISION

	OPERATOR CERTIFICATION I hereby certify the the information contained herein is true and complete to the best of my knowledge and belief.  Signature STEVE MATTHEWS Printed Name DRILLING SUPERINTENDENT Title 01-07-98 Date
	SURVEYOR CERTIFICATION I hereby certify that the well location shown on this plat was plotted from field notes of actual surveys made by me or under my supervision, and that the same is true and correct to the best of my belief. 10/22/97 Date Surveyed  Signature Professional Surveyor HERSCHEL L. JONES NEW MEXICO 3640 Certificate No. 3640 JOHN PROFESSIONAL GENERAL SURVEYING COMPANY

DISTRICT I
P.O. Box 1980, Hobbs, NM 88240

State of New Mexico
Energy, Minerals and Natural Resources Department

Form C-102
Revised February 10, 1994
Instruction on back
Submit to Appropriate District Office
State Lease - 4 Copies
Fee Lease - 3 Copies

DISTRICT II
P.O. Drawer DD, Artesia, NM 88210

DISTRICT III
1000 Rio Brazos Rd., Aztec, NM 87410

OIL CONSERVATION DIVISION
P.O. Box 2088
Santa Fe, New Mexico 87504-2088

☐ AMENDED REPORT

WELL LOCATION AND ACREAGE DEDICATION PLAT

API Number	Pool Code	Pool Name
Property Code	Property Name S.P. JOHNSON	Well Number 2
OGRID No.	Operator Name MEWBOURNE OIL COMPANY	Elevation 3499

Surface Location

UL or lot No.	Section	Township	Range	Lot Idn	Feet from the	North/South line	Feet from the	East/West line	County
G	5	20S	25E		1650	NORTH	1980	EAST	EDDY

Bottom Hole Location If Different From Surface

UL or lot No.	Section	Township	Range	Lot Idn	Feet from the	North/South line	Feet from the	East/West line	County
Dedicated Acres	Joint or Infill	Consolidation Code	Order No.						

NO ALLOWABLE WILL BE ASSIGNED TO THIS COMPLETION UNTIL ALL INTERESTS HAVE BEEN CONSOLIDATED
OR A NON-STANDARD UNIT HAS BEEN APPROVED BY THE DIVISION

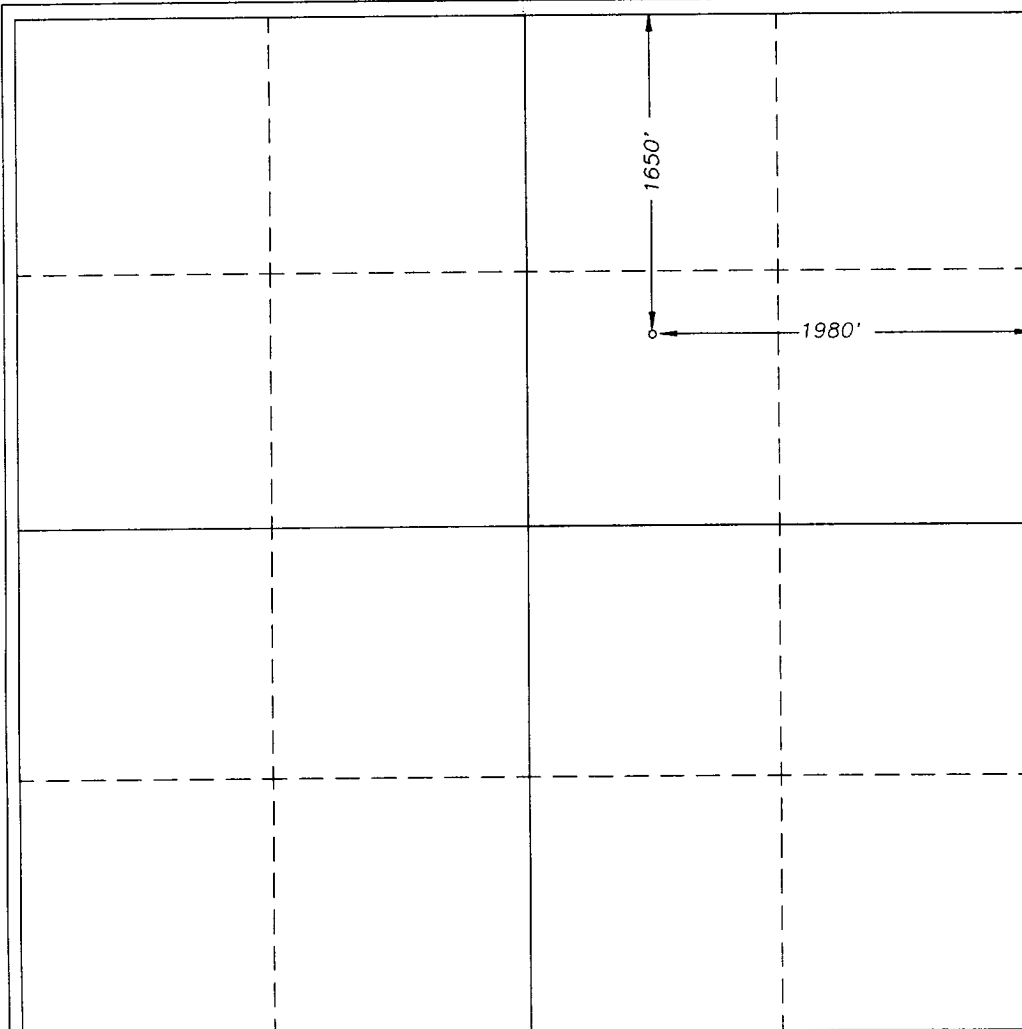

OPERATOR CERTIFICATION

I hereby certify the the information
contained herein is true and complete to the
best of my knowledge and belief.

Signature

Printed Name

Title

Date

SURVEYOR CERTIFICATION

I hereby certify that the well location shown
on this plat was plotted from field notes of
actual surveys made by me or under my
supervision, and that the same is true and
correct to the best of my belief.

10/22/97

Date Surveyed

Signature

Professional Seal

Professional Seal

Professional Seal

Professional Seal

Professional Seal

Professional Seal

Professional Seal

Professional Seal

Professional Seal

Professional Seal

Professional Seal

Professional Seal

Professional Seal

BOP SCHEMATIC
PRODUCTION HOLE

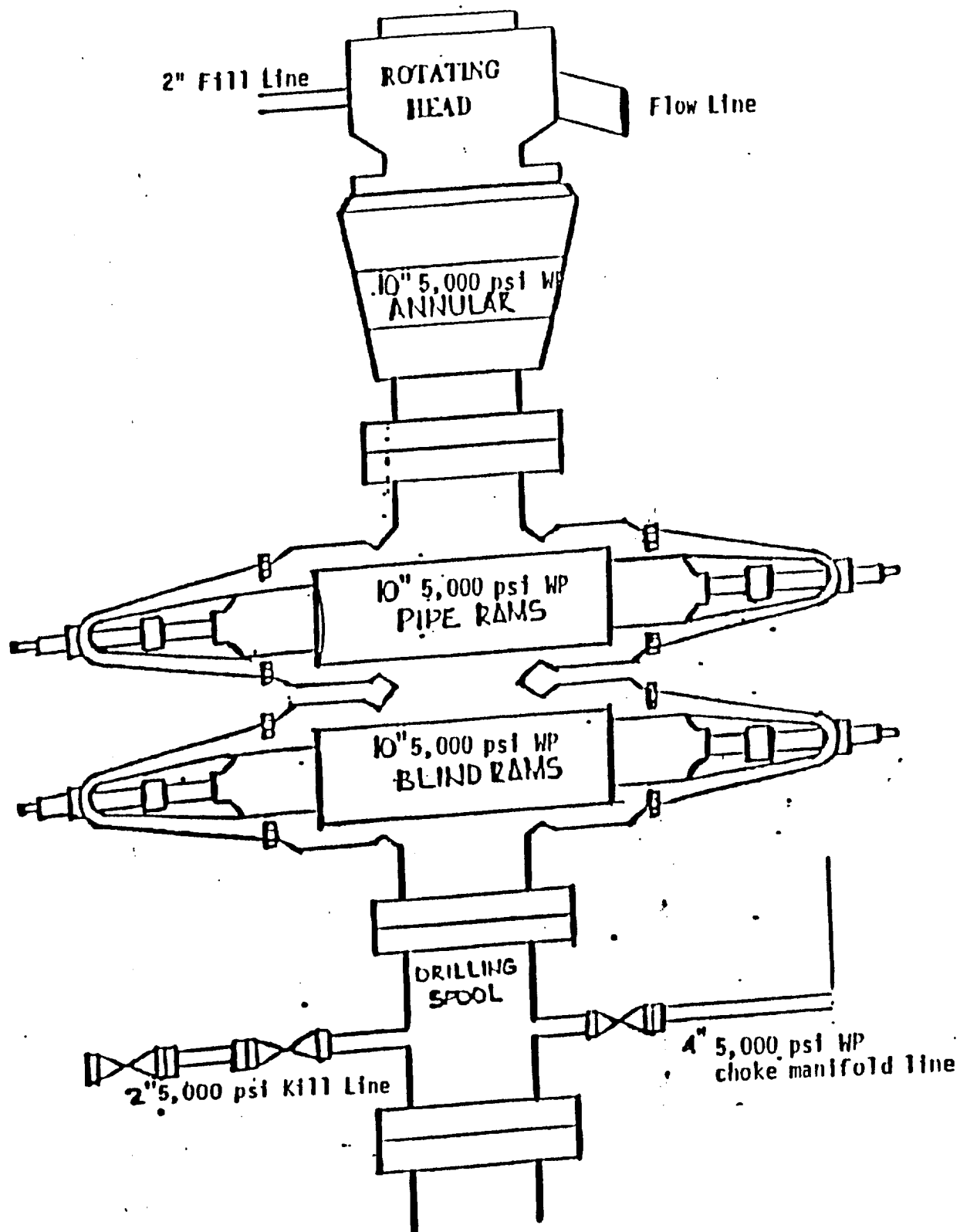

CHOKE MANIFOLD

(5,000 psi upstream WP)

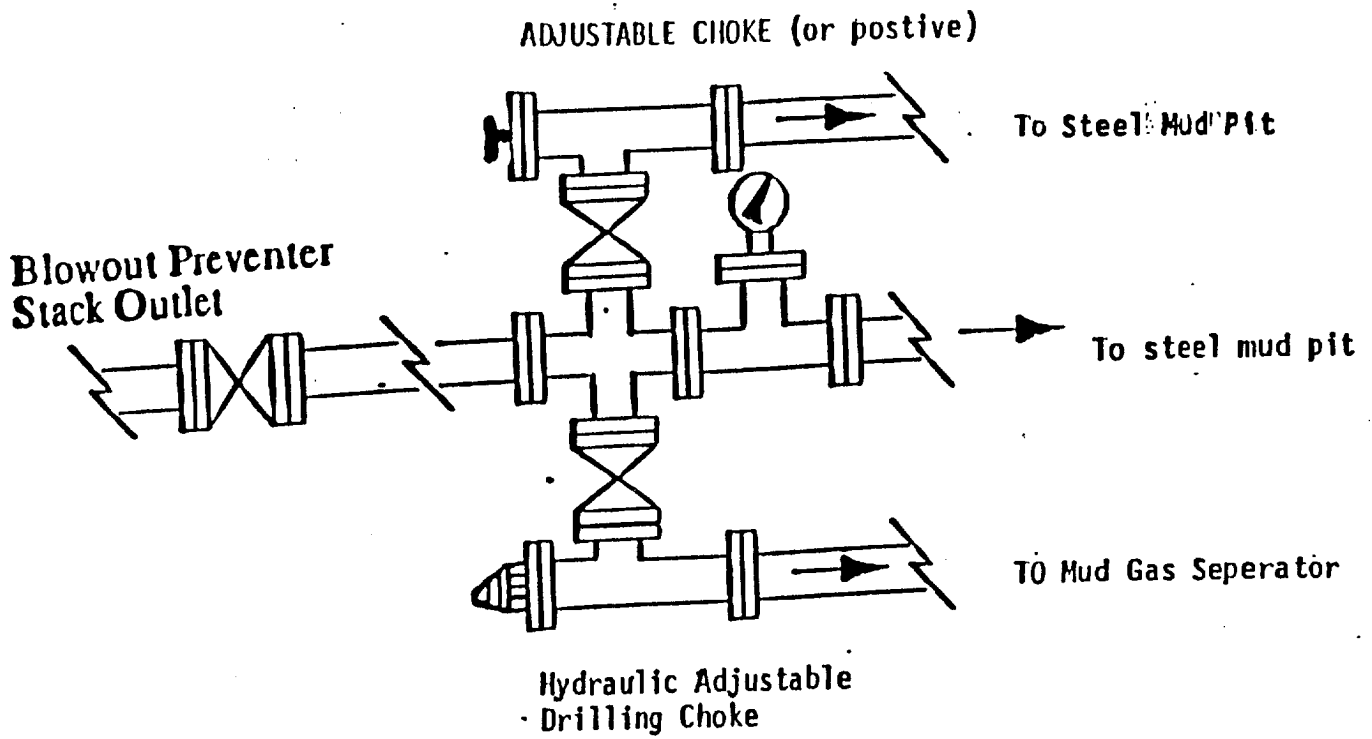

Oxford[®]

NO. R753 1/3

10% 

 LSSI LITE

Geol. Top. per 1364
San Aninos 644
Charlotte 2254
Braz. Spring 3662
W. H. Camp 5764
Canyon 7613