

District I
PO Box 1.80, Hobbs, NM 88241-1980
District II
811 South First, Artesia, NM 88210
District III
1000 Rio Brazos Rd., Aztec, NM 87410
District IV
2040 South Pacheco, Santa Fe, NM 87505

State of New Mexico
Energy, Minerals & Natural Resources Department

OIL CONSERVATION DIVISION
2040 South Pacheco
Santa Fe, NM 87505

Form C-101
Revised October 18, 1994
Instructions on back
Submit to Appropriate District Office
State Lease - 6 Copies
Fee Lease - 5 Copies

☐ AMENDED REPORT

APPLICATION FOR PERMIT TO DRILL, RE-ENTER, DEEPEN, PLUG BACK, OR ADD A ZONE

¹ Operator Name and Address. Yates Petroleum Corporation 105 S. 4th Street Artesia, New Mexico 88210		² OGRID Number 025575
		³ API Number 30-015-30230
⁴ Property Code 12625	⁵ Property Name Parish IV Com	⁶ Well No. 6

⁷ Surface Location

UL or lot no.	Section	Township	Range	Lot Idn	Feet from the	North/South line	Feet from the	East/West line	County
H	26	19S	24E		1880'	North	800'	East	Eddy

⁸ Proposed Bottom Hole Location If Different From Surface

UL or lot no.	Section	Township	Range	Lot Idn	Feet from the	North/South line	Feet from the	East/West line	County
⁹ Proposed Pool 1 Hogg Tank Morrow GAS 78560					¹⁰ Proposed Pool 2				

¹¹ Work Type Code N	¹² Well Type Code G	¹³ Cable/Rotary Rotary	¹⁴ Lease Type Code P	¹⁵ Ground Level Elevation 3624'
¹⁶ Multiple No	¹⁷ Proposed Depth 9300'	¹⁸ Formation Morrow	¹⁹ Contractor Undesignated	²⁰ Spud Date ASAP

²¹ Proposed Casing and Cement Program

Hole Size	Casing Size	Casing weight/foot	Setting Depth	Sacks of Cement	Estimated TOC
14 3/4"	9 5/8"	36#	1150'	1000 sx	Circulate
8 3/4"	7"	23# & 26#	TD	1250 sx	As warranted
				Post TD-1	
				5-5-98	
				API + LOC	

²² Describe the proposed program. If this application is to DEEPEN or PLUG BACK give the data on the present productive zone and proposed new productive zone. Describe the blowout prevention program, if any. Use additional sheets if necessary.

Yates Petroleum Corporation proposes to drill and test the Morrow and intermediate formations. Approximately 1150' of surface casing will be set and cement circulated to shut off gravel and cavings. If commercial, production casing will be run and cemented, will perforate and stimulate as needed for production. 18 Hours woc BOO

MUD PROGRAM: 0-1150' FW Gel/LCM; 1150'-5200' FW; 5200'-7200' Cut Brine; Starch/KCL.

BOPE PROGRAM: BOPE and hydrill will be installed on 9 5/8" casing and tested daily for operational.

²³ I hereby certify that the information given above is true and complete to the best of my knowledge and belief.

Signature:

Printed name:

KEN BEARDEMPH

Title:

LANDMAN

Date:

January 19, 1998

Phone:

505-748-4348

OIL CONSERVATION DIVISION

Approved by:

Jim W. Green
District Supervisor

BGA

Title:

Approval Date:

4-30-98

Expiration Date:

4-30-99

Conditions of Approval:

Attached ☐

NSL — 3997

District I
PO Box 1980, Hobbs, NM 88241-1980
District II
PO Drawer DD, Artesia, NM 88211-0719
District III
1000 Rio Brazos Rd., Aztec, NM 87410
District IV
PO Box 2088, Santa Fe, NM 87504-2088

State of New Mexico
Energy, Minerals & Natural Resources Department

OIL CONSERVATION DIVISION
PO Box 2088
Santa Fe, NM 87504-2088

Form C-102
Revised February 10, 1994
Instructions on back
Submit to Appropriate District Office
State Lease - 4 Copies
Fee Lease - 3 Copies

☐ AMENDED REPORT

WELL LOCATION AND ACREAGE DEDICATION PLAT

API Number		Pool Code		Pool Name Morrow	
Property Code	Property Name PARISH IV COM				Well Number 6
GRID No. 025575	Operator Name YATES PETROLEUM CORPORATION				Elevation 3624.

Surface Location

UL or lot no.	Section	Township	Range	Lot Idn	Feet from the	North/South line	Feet from the	East/West line	County
H	26	19-S	24-E		1880	NORTH	800	EAST	EDDY

Bottom Hole Location If Different From Surface

UL or lot no.	Section	Township	Range	Lot Idn	Feet from the	North/South line	Feet from the	East/West line	County

Dedicated Acres 320	Joint or Infill	Consolidation Code	Order No.
------------------------	-----------------	--------------------	-----------

NO ALLOWABLE WILL BE ASSIGNED TO THIS COMPLETION UNTIL ALL INTERESTS HAVE BEEN CONSOLIDATED
OR A NON-STANDARD UNIT HAS BEEN APPROVED BY THE DIVISION

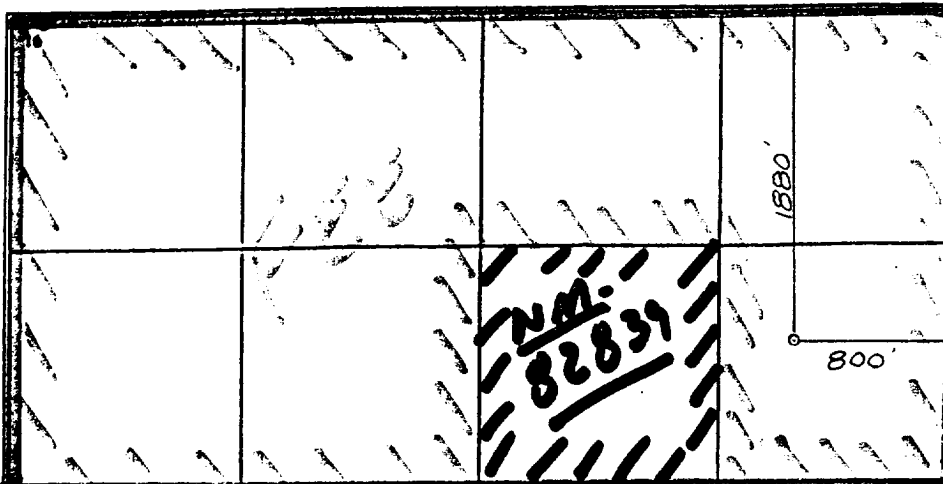

OPERATOR CERTIFICATION

I hereby certify that the information contained herein is true and complete to the best of my knowledge and belief.

Signature: *Ken Beardemphl*
Printed Name: Ken Beardemphl
Title: Landman
Date: January 19, 1998

SURVEYOR CERTIFICATION

I hereby certify that the well location shown on this plat was plotted from field notes of actual surveys made by me or under my supervision, and that the same is true and correct to the best of my belief.

Date of Survey: JANUARY 18, 1997
Signature and Seal of Professional Surveyor:
A circular seal for a Registered Professional Engineer, License No. 5412, is stamped over the signature.
Certificate Number: NM PE&PS NO. 5412

YATES PETROLEUM CORPORATION

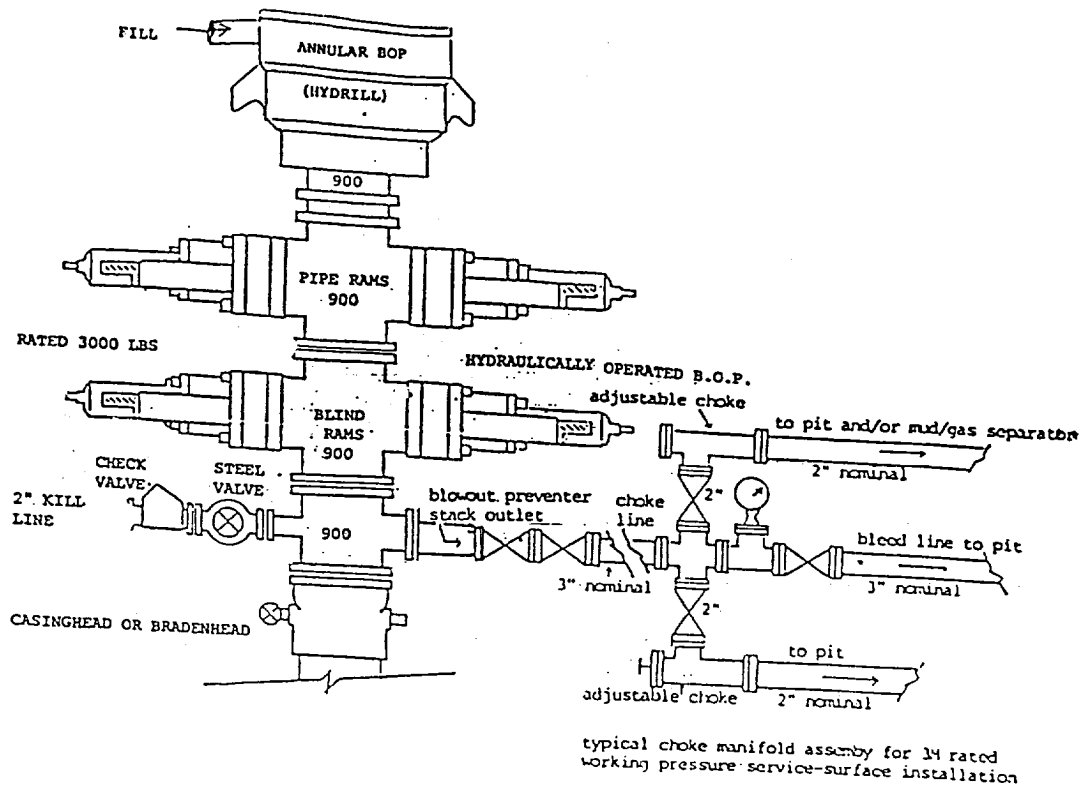

EXHIBIT B

THE FOLLOWING CONSTITUTES THE MINIMUM BLOWOUT PREVENTER
REQUIREMENTS FOR 3000 PSI WP SYSTEMS

1. All preventers to be hydraulically operated with secondary manual controls installed prior to drilling out from under casing.
2. Choke outlet to be a minimum of 3" diameter.
3. Kill line to be of all steel construction of 3" minimum diameter.
4. All connections from operating manifolds to preventers to be all steel. Hole or tube to be a minimum of one inch in diameter.
5. The available closing pressure shall be at least 15% in excess of that required with sufficient volume to operate the B.O.P.'s.
6. All connections to and from preventer to have a pressure rating equivalent to that of the B.O.P.'s.
7. Inside blowout preventer to be available on rig floor.
8. Operating controls to be located a safe distance from the rig floor.
9. Hole must be kept filled on trips below intermediate casing.