

N. M. Oil Cons. Division

911 S. 1ST ST.
ARTESA, N.M. 87003

Form 3160-3
(August 1999)

UNITED STATES DEPARTMENT OF THE INTERIOR BUREAU OF LAND MANAGEMENT

APPLICATION FOR PERMIT TO DRILL OR REENTER

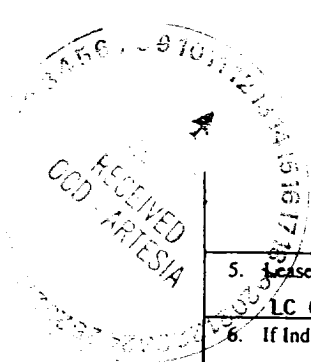

FORM APPROVED
OMB No. 1004-0136
Expires November 30, 2000

1a. Type of Work: <input checked="" type="checkbox"/> DRILL <input type="checkbox"/> REENTER			5. Lease Serial No. LC 029389 (A)	
1b. Type of Well: <input checked="" type="checkbox"/> Oil Well <input type="checkbox"/> Gas Well <input type="checkbox"/> Other <input type="checkbox"/> Single Zone <input type="checkbox"/> Multiple Zone			6. If Indian, Allottee or Tribe Name	
2. Name of Operator ANADARKO PETROLEUM CORPORATION 817			7. If Unit or CA Agreement, Name and No.	
3a. Address P O BOX 2497, MIDLAND TX 79702			8. Lease Name and Well No. BALSH FEDERAL NO. 8 1239	
3b. Phone No. (include area code) 915/682-1666			9. API Well No. 30-015-30837	
4. Location of Well (Report location clearly and in accordance with any State requirements. *) At surface 1930' FSL & 2030' FEL U.L. J At proposed prod. zone SAME			10. Field and Pool, or Exploratory NORTH SHUGART - BONE SPRINGS 56405	
14. Distance in miles and direction from nearest town or post office* 7 MILES SOUTHEAST FROM LOCO HILLS			11. Sec., T., R., M., or Blk. and Survey or Area SEC 9 - 18S - 31E	
15. Distance from proposed* location to nearest property or lease line, ft. (Also to nearest drig. unit line, if any) 610' (610')		16. No. of Acres in lease 160	17. Spacing Unit dedicated to this well 40 ACRES	
18. Distance from proposed location* to nearest well, drilling, completed, applied for, on this lease, ft.		19. Proposed Depth 9300	20. BLM/BIA Bond No. on file 153571	
21. Elevations (Show whether DF, KDB, RT, GL, etc.) 3701' GL		22. Approximate date work will start* DECEMBER 1, 1999	23. Estimated duration 30 DAYS	
24. Attachments CAPTAN CONTROLLED WATER BARR				

The following, completed in accordance with the requirements of Onshore Oil and Gas Order No.1, shall be attached to this form:

- | | |
|---|--|
| 1. Well plat certified by a registered surveyor. | 4. Bond to cover the operations unless covered by an existing bond on file (see item 20 above). |
| 2. A Drilling Plan. | 5. Operator certification. |
| 3. A Surface Use Plan (if the location is on National Forest System Lands, the SUPO shall be filed with the appropriate Forest Service Office). | 6. Such other site specific information and/or plans as may be required by the authorized officer. |

25. Signature <i>George R. S. Buehler</i>	Name (Printed/Typed) GEORGE R. S. BUEHLER	Date 10-29-99
Title STAFF DRILLING ENGINEER		
Approved by (Signature) (ORIG. SED.) ARMANDO A. LINDSEY	Name (Printed/Typed)	Date NOV 10 1999
Title Acting Assistant Field Office Manager. Lands and Minerals	Office	APPROVED FOR 1 YEAR

Application approval does not warrant or certify the the applicant holds legal or equitable title to those rights in the subject lease which would entitle the applicant to conduct operations thereon.

Conditions of approval, if any, are attached.

Title 18 U.S.C. Section 1001 and Title 43 U.S.C. Section 1212, make it a crime for any person knowingly and willfully to make to any department or agency of the United States any false, fictitious or fraudulent statements or representations as to any matter within its jurisdiction.

*(Instructions on reverse)

APPROVAL SUBJECT TO
GENERAL REQUIREMENTS AND
SPECIAL STIPULATIONS
ATTACHED

10-10-1999 10:10:10

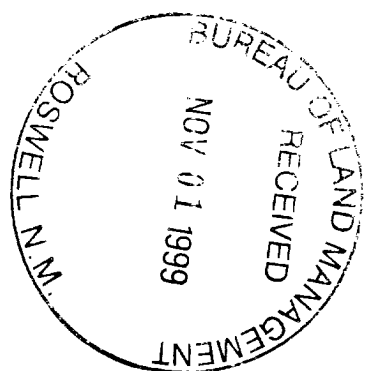

DISTRICT I
P.O. Box 1980, Hobbs, NM 88241-1980

State of New Mexico
Energy, Minerals and Natural Resources Dept

Form C-102
Revised February 10, 1994
Submit to Appropriate District Office
State Lease - 4 Copies
Fee Lease - 3 Copies

DISTRICT II
P.O. Drawer DD, Artesia, NM 88211-0719

DISTRICT III
1000 Rio Brazos Rd., Aztec, NM 87410

DISTRICT IV
P.O. BOX 2088, SANTA FE, N.M. 87504-2088

OIL CONSERVATION DIVISION

P.O. Box 2088
Santa Fe, New Mexico 87504-2088

☐ AMENDED REPORT

WELL LOCATION AND ACREAGE DEDICATION PLAT

API Number	Pool Code 56405	Pool Name SHUGART BONE SPRINGS, NORTH
Property Code	Property Name BAISH FEDERAL	Well Number 8
OGRID No. 000817	Operator Name ANADARKO PETROLEUM CORPORATION	Elevation 3701

Surface Location

UL or lot No. J	Section 9	Township 18 S	Range 31 E	Lot Idn	Feet from the 1930	North/South line SOUTH	Feet from the 2030	East/West line EAST	County EDDY
--------------------	--------------	------------------	---------------	---------	-----------------------	---------------------------	-----------------------	------------------------	----------------

Bottom Hole Location If Different From Surface

UL or lot No.	Section	Township	Range	Lot Idn	Feet from the	North/South line	Feet from the	East/West line	County
Dedicated Acres 40	Joint or Infill N	Consolidation Code	Order No.						

NO ALLOWABLE WILL BE ASSIGNED TO THIS COMPLETION UNTIL ALL INTERESTS HAVE BEEN CONSOLIDATED
OR A NON-STANDARD UNIT HAS BEEN APPROVED BY THE DIVISION

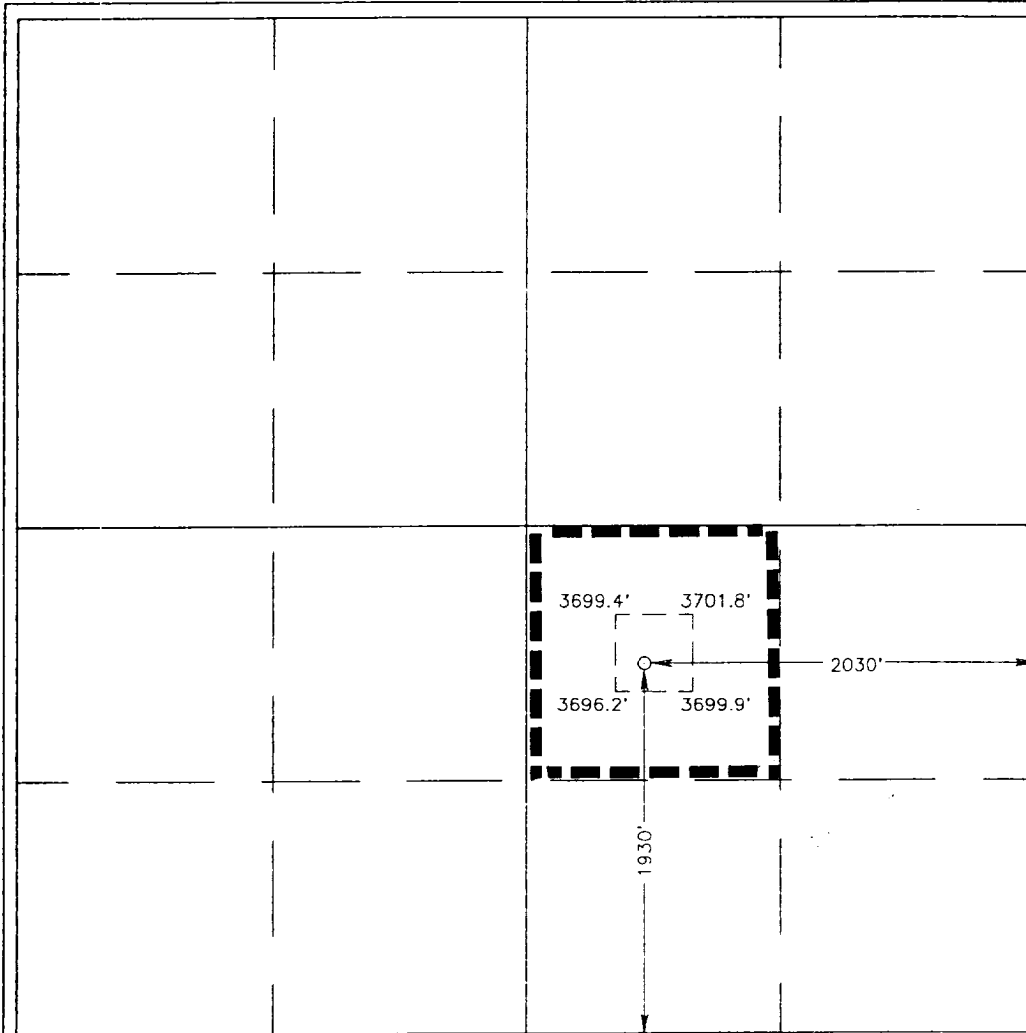

OPERATOR CERTIFICATION

I hereby certify the the information
contained herein is true and complete to the
best of my knowledge and belief.

George R. S. Buehler
Signature

GEORGE R. S. BUEHLER

Printed Name

STAFF DRILLING ENGINEER

Title

OCTOBER 4, 1999

Date

SURVEYOR CERTIFICATION

I hereby certify that the well location shown
on this plat was plotted from field notes of
actual surveys made by me or under my
supervision, and that the same is true and
correct to the best of my belief.

SEPTEMBER 27, 1999

Date Surveyed DMCC

Signature & Seal

Professional Surveyor

RONALD J. EIDSON

3239

9-30-99

89-11-0808

Certified No. RONALD J. EIDSON 3239

McDONALD 12641

McDONALD 12185

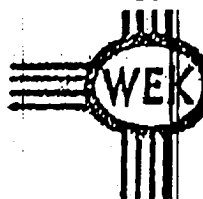

DRILLIN

D., INC. - OIL WELL DRILLING C

FACTORS

P. O. BOX 1498 ROSWELL, NEW MEXICO 88202-1498
505/623-6070 505/746-2719
ROSWELL, NM ARTERIA, NM

EXHIBIT 1

Baish Federal No. 8
Eddy County, New Mexico
Anadarko Petroleum Corporation

BOP & Choke Manifold**BLOWOUT PREVENTOR ARRANGEMENT**

11" SHAFFER TYPE LWS, 5000 psi WP
11" CAMERON SPHERICAL, 5000 psi WP
120 GALLON, 5 STATION KOOMEY ACCUMULATOR
5000 psi WP CHOKE MANIFOLD

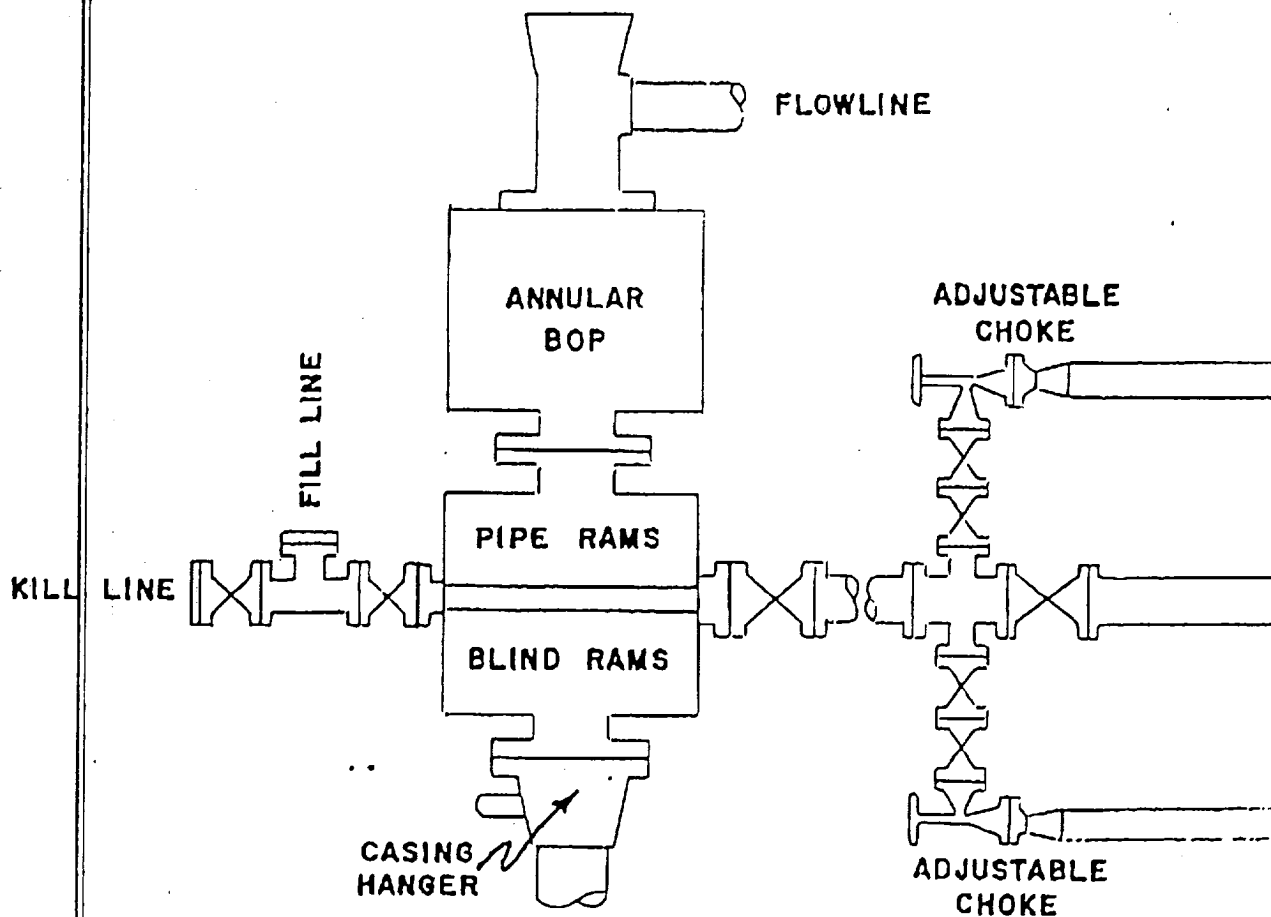

Attachment to Exhibit #1
Attachment to Form 3160-3
Anadarko Petroleum Corporation
Baish Federal No. 8
1930' FSL & 2030' FEL
Section 9, T18S, R31E
Eddy County, New Mexico

1. Drilling nipple will be constructed so it can be removed mechanically without the aid of a welder. The minimum internal diameter will equal BOP bore.
2. Wear ring will be properly installed in head.
3. Blowout preventor and all associated fittings will be in operable condition to withstand a minimum 3000 psi working pressure.
4. All fittings will be flanged.
5. A full bore safety valve tested to a minimum 3000 psi WP with proper thread connections will be available on the rotary rig floor at all times.
6. All BOP equipment will be equal to or larger in bore than the internal diameter of the last casing string.
7. Will maintain a kelly cock attached to the kelly.
8. Hand wheels and wrenches will be properly installed and tested for safe operation.
9. All BOP equipment will meet API standards and include a minimum 40 gallon accumulator having two independent means of power to initiate closing operation.