

DISTRICT I  
P. O. Box 1980  
Hobbs, NM 88241-1980

State of New Mexico  
F gy. Minerals, and Natural Resources Department

Form C-102  
Revised 02-10-94

Instructions on back

DISTRICT II  
P. O. Drawer DD  
Artesia, NM 88211-0719

EXHIBIT # 2

Submit to the Appropriate  
District Office  
State Lease - 4 copies  
Fee Lease - 3 copies

DISTRICT III  
1000 Rio Brazos Rd.  
Aztec, NM 87410

## OIL CONSERVATION DIVISION

P. O. Box 2088  
Santa Fe, New Mexico 87504-2088

☐ AMENDED REPORT

DISTRICT IV  
P. O. Box 2088  
Santa Fe, NM 87507-2088

### WELL LOCATION AND ACREAGE DEDICATION PLAT

|                      |  |  |  |                               |                      |
|----------------------|--|--|--|-------------------------------|----------------------|
| 1 API Number         |  | 2 Pool Code<br>85300                         |  | 3 Pool Name<br>Shugart;Morrow |                      |
| 4 Property Code      |  | 5 Property Name<br>SHUGART '25' FEDERAL CDM  |  |                               | 6 Well Number<br>1   |
| 7 OGRID No.<br>20305 |  | 8 Operator Name<br>DEVON SFS OPERATING, INC. |  |                               | 9 Elevation<br>3673' |

#### 10 SURFACE LOCATION

| UL or lot no. | Section | Township | Range             | Lot Ida | Feet from the | North/South line | Feet from the | East/West line | County |
|---------------|---------|----------|-------------------|---------|---------------|------------------|---------------|----------------|--------|
| K             | 25      | 18 SOUTH | 31 EAST, N.M.P.M. |         | 1980'         | SOUTH            | 1980'         | WEST           | EDDY   |

#### "BOTTOM HOLE LOCATION IF DIFFERENT FROM SURFACE

| UL or lot no. | Section | Township | Range | Lot Ida | Feet from the | North/South line | Feet from the | East/West line | County |
|---------------|---------|----------|-------|---------|---------------|------------------|---------------|----------------|--------|
|               |         |          |       |         |               |                  |               |                |        |

|                           |                    |                       |              |
|---------------------------|--------------------|-----------------------|--------------|
| 12 Dedicated Acres<br>320 | 13 Joint or Infill | 14 Consolidation Code | 15 Order No. |
|---------------------------|--------------------|-----------------------|--------------|

NO ALLOWABLE WELL BE ASSIGNED TO THIS COMPLETION UNTIL ALL INTERESTS HAVE BEEN  
CONSOLIDATED OR A NON-STANDARD UNIT HAS BEEN APPROVED BY THE DIVISION

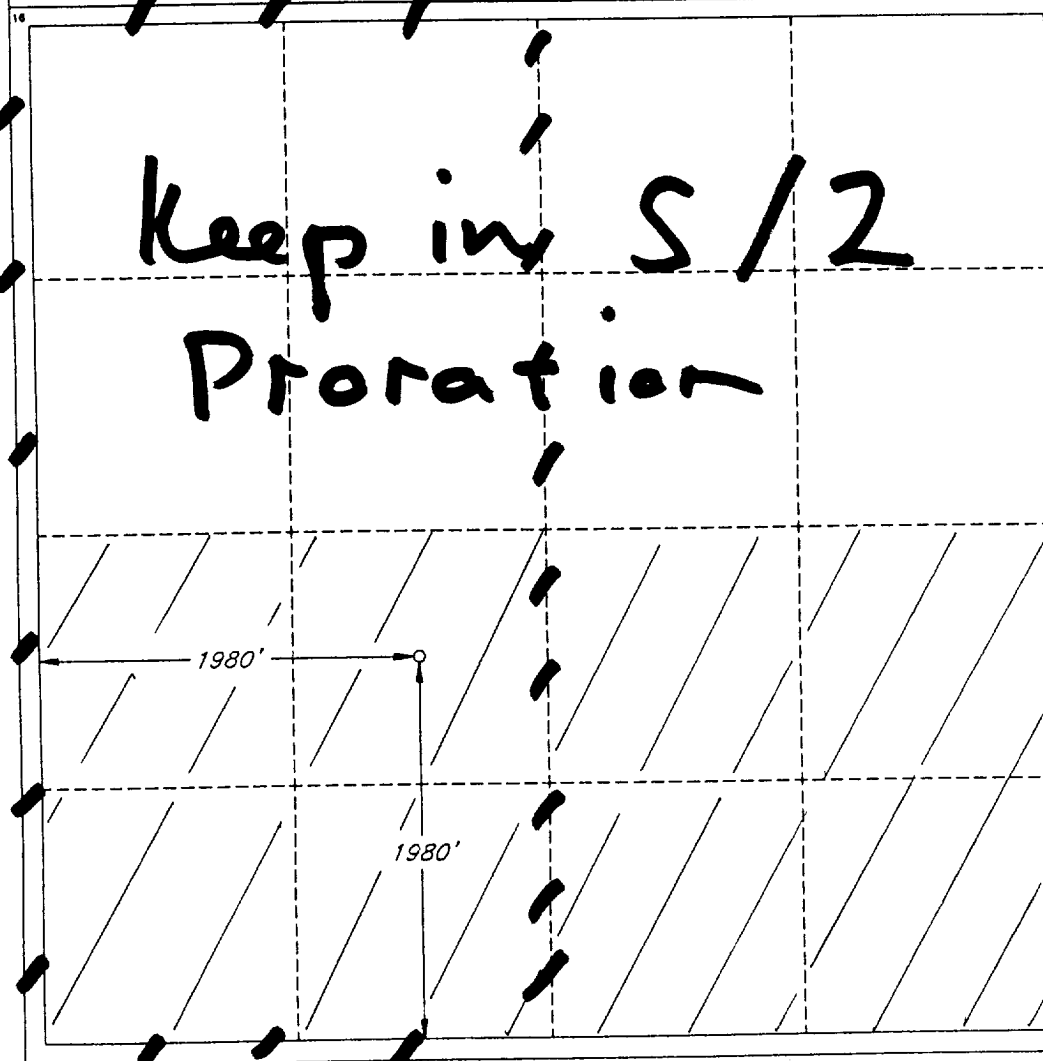

#### OPERATOR CERTIFICATION

I hereby certify that the information  
contained herein is true and complete  
to the best of my knowledge and belief.

Signature  
*E.L. Buttross Jr.*  
Printed Name  
E.L. Buttross, Jr.  
Title  
Operations Engr. Advisor  
Date  
9/20/00

#### SURVEYOR CERTIFICATION

I hereby certify that the well  
location shown on this plat was  
plotted from field notes of actual  
surveys made by me or under  
my supervision, and that the  
same is true and correct to the  
best of my belief.

Date of Survey  
SEPTEMBER 6, 2000

Signature and Seal of  
Professional Surveyor

Certificate No.  
V. L. BEZNER R.P.S. #7920  
JOB #71428 / 73 NE / V.H.B.