

**UNITED STATES  
DEPARTMENT OF THE INTERIOR  
BUREAU OF LAND MANAGEMENT**

**APPLICATION FOR PERMIT TO DRILL OR DEEPEN**

1a. TYPE OF WORK

DRILL ☒DEEPEN ☐

b. TYPE OF WELL

OIL

GAS

SINGLE

MULTIPLE

WELL ☒WELL ☐OTHER ☐ZONE ☒ZONE ☐

2. NAME OF OPERATOR

RAY WESTALL

3. ADDRESS AND TELEPHONE NO.

P.O. BOX 4, LOCO HILLS NM 88255 505.677.2370

4. LOCATION OF WELL (REPORT LOCATION CLEARLY AND IN ACCORDANCE WITH ANY STATE REQUIREMENTS)

AT SURFACE

1980 FNL &amp; 1980 FEL

1830N 1830E

AT PROPOSED PROD. ZONE

SAME

14. DISTANCE IN MILES AND DIRECTION FROM NEAREST TOWN OR POST OFFICE

10 MILES SOUTHEAST OF LOCO HILLS NM

15. DISTANCE FROM PROPOSED

LOCATION TO NEAREST

PROPERTY OR LEASE LINE, FT.

(Also to nearest drlg. unit line, if any)

1980

18. DISTANCE FROM PROPOSED LOCATION

TO NEAREST WELL DRILLING, COMPLETED,

OR APPLIED FOR, ON THIS LEASE, FT.

600

16. NO. OF ACRES IN LEASE

640

19. PROPOSED DEPTH

3800

17. NO. OF ACRES ASSIGNED

TO THIS WELL

40

20. ROTARY OR CABLE TOOLS

ROTARY

21. ELEVATIONS (Show whether DF, RT, GR, etc.)

3734

APPROX. DATE WORK WILL START

ASAP

23.

**PROPOSED CASING AND CEMENTING PROGRAM**

SIZE OF HOLE	GRADE, SIZE OF CASING	WT PER FT	SETTING DEPTH	QUANTITY OF CEMENT
12 1/4"	8 5/8" J-55	32# ST&C 8RD	985' 955'	350 SXS CIRCULATED
7 7/8"	5 1/2" J-55	15# LT&C 8RD	3800	850 SXS EST TOP 300'

ALL CASING WILL BE NEW, OR USED MEETING BLM SPECS.

CEMENT WILL BE CIRCULATED ON 8 5/8" CASING.

CEMENT QUANTITIES AND ADDITIVES ARE SUBJECT TO CHANGE DUE TO HOLE CONDITIONS.

**APPROVAL SUBJECT TO  
GENERAL REQUIREMENTS AND  
SPECIAL STIPULATIONS  
ATTACHED**

**PROPOSED MUD PROGRAM**

0-955	FRESH WATER
955-3800	BRINE WATER

MUD PROGRAM SUBJECT TO CHANGE DUE TO HOLE CONDITIONS

IN ABOVE SPACE DESCRIBE PROPOSED PROGRAM: If proposal is to deepen, give data on present productive zone and proposed new productive zone. If proposal is to drill or deepen directionally, give pertinent data on subsurface locations and measured and true vertical depths. Give blowout preventer program, if any.

24.

SIGNED

TITLE

GEOLOGIST

DATE 01/13/2001

(THIS SPACE FOR FEDERAL OR STATE OFFICE USE)

PERMIT NO.

APPROVAL DATE

APPLICATION APPROVAL DOES NOT WARRANT OR CERTIFY THAT THE APPLICANT HOLDS LEGAL OR EQUITABLE TITLE TO THOSE RIGHTS IN THE SUBJECT LEASE WHICH WOULD ENTITLE THE APPLICANT TO CONDUCT OPERATIONS THEREON.

CONDITIONS OF APPROVAL IF ANY:

APPROVED BY /s/ LESLIE A. THEISS

TITLE

FIELD MANAGER

DATE

OCT 31 2001

TITLE 18 U.S.C. SECTION 1001, MAKES IT A CRIME FOR ANY PERSONS KNOWINGLY AND WILLFULLY TO MAKE TO ANY DEPARTMENT OR AGENCY OF THE UNITED STATES ANY FALSE, FICTITIOUS OR FRAUDULENT STATEMENTS OR REPRESENTATIONS AS TO ANY MATTER WITHIN ITS JURISDICTION

**APPROVAL FOR 1 YEAR**

District I  
PO Box 1900, Hobbs, NM 88241-1900  
District II  
PO Drawer DD, Artesia, NM 88211-0719  
District III  
1000 Rio Brazos Rd., Amec, NM 87410  
District IV  
PO Box 2088, Santa Fe, NM 87504-2088

State of New Mexico  
Energy, Minerals & Natural Resources Department

OIL CONSERVATION DIVISION  
PO Box 2088  
Santa Fe, NM 87504-2088

Form C-102  
Revised February 10, 1994  
Instructions on back  
Submit to Appropriate District Office  
State Lease - 4 Copies  
Fee Lease - 3 Copies

☐ AMENDED REPORT

WELL LOCATION AND ACREAGE DEDICATION PLAT

* API Number		* Pool Code		* Pool Name	
* Property Code		* Property Name Taylor Unit Federal			* Well Number 29
* OGRID No.		* Operator Name Ray Westall, Operator			* Elevation 3737

10 Surface Location

UL or lot no. G	Section 13	Township 18s	Range 31e	Lot Idn	Feet from the 1830	North/South line North	Feet from the 1830	East/West line East	County Eddy
--------------------	---------------	-----------------	--------------	---------	-----------------------	---------------------------	-----------------------	------------------------	----------------

11 Bottom Hole Location If Different From Surface

UL or lot no.	Section	Township	Range	Lot Idn	Feet from the	North/South line	Feet from the	East/West line	County
---------------	---------	----------	-------	---------	---------------	------------------	---------------	----------------	--------

12 Dedicated Acres 40	13 Joint or Infill	14 Consolidation Code	15 Order No.
--------------------------	--------------------	-----------------------	--------------

NO ALLOWABLE WILL BE ASSIGNED TO THIS COMPLETION UNTIL ALL INTERESTS HAVE BEEN CONSOLIDATED  
OR A NON-STANDARD UNIT HAS BEEN APPROVED BY THE DIVISION

16						17 OPERATOR CERTIFICATION I hereby certify that the information contained herein is true and complete to the best of my knowledge and belief.  Signature: <u>[Signature]</u> Printed Name: <u>RANDALL HARRIS</u> Title: <u>Geologist</u> Date: <u>10/24/01</u>
						18 SURVEYOR CERTIFICATION I hereby certify that the well location shown on this plat was plotted from field notes of actual surveys made by me or under my supervision, and that the same is true and correct to the best of my belief.  May 2, 2001 Date of Survey Signature and Seal of Professional Surveyor: <u>[Signature]</u> 8112 Certificate Number

RECEIVED  
2001 OCT 26 PM 1 14  
BUREAU OF LAND MGMT.  
CARLSBAD FIELD OFFICE

RECEIVED  
2001 MAY 10 P 2:18

ENVIRONMENTAL  
PROTECTION AREA

Centerline 567' Long  
Well Pad Access Road

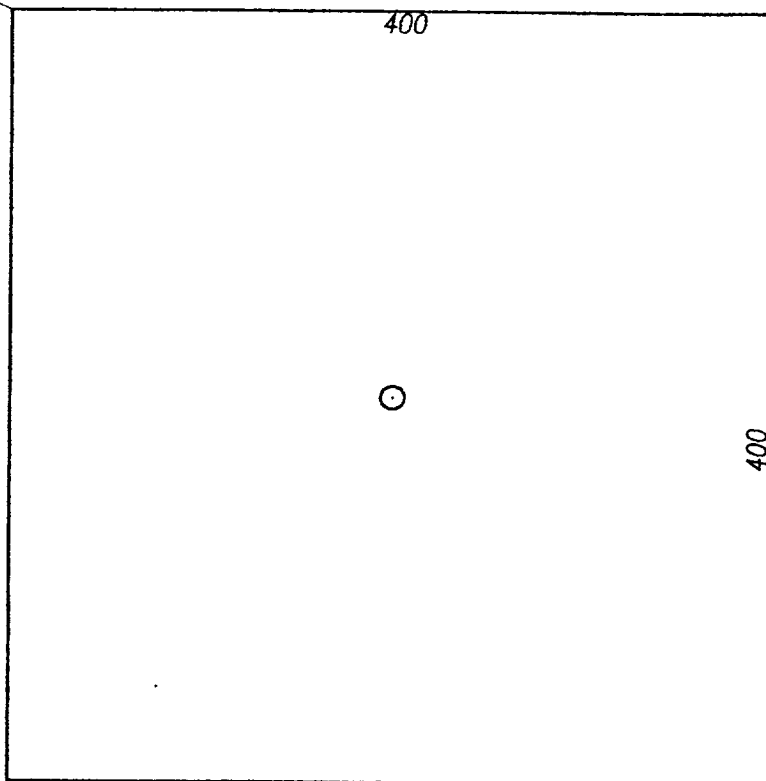
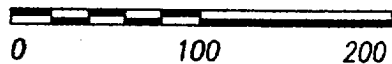

SITE PLAN  
RAY WESTALL OPERATING  
TAYLOR UNIT FEDERAL WELL No. 29  
1830 FNL 1830 FEL  
SEC. 13, T18S, R31E  
EDDY Co., NM

## APPLICATION FOR DRILLING

Ray Westall  
Taylor Unit #29  
1980 FNL & 1980 FEL  
Section 13  
Township 18 South, Range 31 East  
Eddy County, New Mexico

In conjunction with Form 3160-3, Application for Permit to Drill, Ray Westall submits the following ten items of pertinent information in accordance with BLM requirements:

1. The geological surface formation is Quaternary.
2. The estimated tops of geologic markers are as follows:  
Base Salt 2110'  
Yates 2390'  
Queen 3520'
3. The estimated depths at which anticipated water, oil & gas formations are expected to be encountered:  
Water 0-180'  
Oil & Gas Zones 3520-3600
4. Proposed casing program: See 3160-3
5. Pressure Control Equipment:  
A 900s BOP will be installed on the 8 5/8" casing and tested prior to drill out.
6. Mud Program:  
Fresh water in surface hole.  
Brine in production hole.
7. Auxiliary Equipment: None
8. Logging Program: CNL/FDC/GR, DLL.
9. No abnormal pressures or temperatures are anticipated. Estimated BHP is 2100#, Estimated BHT is 110 F.
10. Anticipated Starting date: 01/01/01  
Duration: 7 Days drilling  
5 Days completion

## **MULTI-POINT SURFACE USE AND OPERATIONS PLAN**

### **RAY WESTALL TAYLOR UNIT #29**

This plan is submitted with form 3160-3, Application for Permit to Drill, covering the above described well. The purpose of this plan is to describe the location of the proposed well, the proposed construction activities and operations plan, the magnitude of surface disturbance involved, and the procedures to be followed in rehabilitating the surface after completion of the operations, so that a complete appraisal can be made of the environmental effect associated with the operation.

1. Existing Roads.  
Exhibit A is a portion of a USGS topographic map showing the wells and roads in the vicinity of the proposed location.
2. Planned Access Road.  
Approximately 1060 feet of new road from the west.
3. Location of Existing Wells.  
Exhibit B is a topo map showing the existing wells.
4. Location of existing/or proposed facilities:  
If productive a 3" SDR 7 poly line will be laid along existing ROW located on the Taylor Unit Facility located in the NWSE of section 12. A 3 phase power line and poles will be routed along the existing ROW paralleling the road.
5. Location and Type of Water Supply.  
It is planned to drill the proposed well with fresh and brine water system. The water will be obtained from commercial sources and will be hauled to the location by truck.
6. Source of Construction Materials.  
The location and road will be from pit excavation and or will be hauled in from an approved caliche pit.
7. Methods of Handling Waste Disposal.
  - A. Drill cuttings will be disposed of in the reserve pit.
  - B. Drilling fluids will be allowed to evaporate in the reserve pits until the pits are dry.
  - C. Produced water during operations will be stored in reserve pits until dry.
  - D. Oil produced during operations will be stored in tanks until sold.
  - E. Current laws and regulations pertaining to the disposal of human waste will be complied with.

- F. Trash, waste paper, garbage and junk will be stored in a wire cage preventing blowing or scattering by the wind. After drilling and completion all waste will be removed to an approved site.

8. Ancillary Facilities  
None required.

9. Wellsite Layout.  
Exhibit C shows the relative location and dimensions of the well pad, the reserve pit, a 400' X 400' area has been staked and flagged.

10. Plans For Restoration of The Surface.

- A. After finishing drilling and completion operations all equipment and other material not needed for further operations will be removed. The location will be cleaned of all trash and junk to leave the Wellsite in as aesthetically pleasing a condition as possible.
- B. Unguarded pits, if any containing fluids will be fenced until they have been filled.
- C. If the proposed well is non-productive, all rehabilitation and or vegetation requirements of the BLM and USGS will be complied with and will be accomplished as expeditiously as possible. All pits will be filled and leveled within 90 days after abandonment.

11. Other Information:

- A. Topography: The land surface in the vicinity of the Wellsite is sandy loam with caliche hills and outcrops.
- B. Flora and Fauna: the vegetation cover consists of prairie grass, greasewood and miscellaneous desert growth. No wildlife was observed, but wildlife in the area probably includes those typical of semi-arid desert land. The area is used for cattle grazing.
- C. There are no ponds, lakes or rivers in the area.
- D. There are no inhabited dwellings in the vicinity of the proposed well.
- E. Surface ownership is federal.
- F. Evidence of archeological sites has been reported and previously filed by Archaeological Survey Consultants.

12. Operator's Representative:

Ray Westall  
P.O. Box 4  
Loco Hills, NM 88255  
(505) 677-2370

13. Certification:

I hereby certify that I, or persons under my direct supervision, have inspected the proposed drillsite and access route, that I am familiar with the conditions which presently exist; that the statements made in this plan are to the best of my knowledge true and correct; and that the work associated with the operation proposed herein will be performed by the operator and its' subcontractors in conformity with this plan and the terms and conditions under which is approved

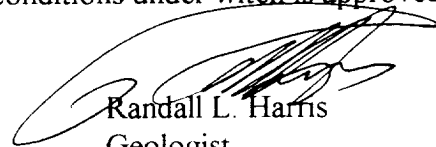
A handwritten signature in black ink, appearing to read "Randall L. Harris", is written over the printed name.

Randall L. Harris  
Geologist

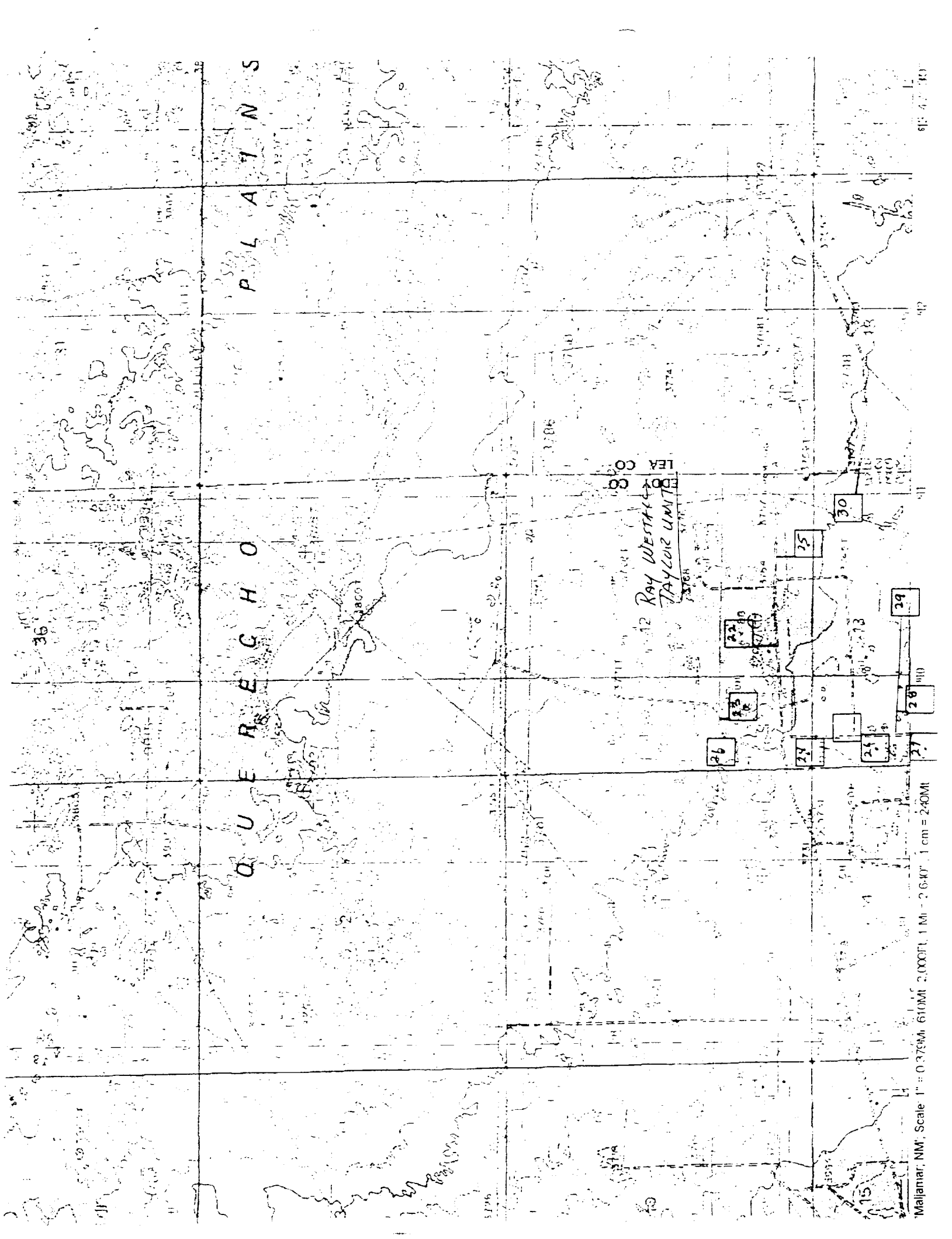

QUE RECH O

PLA 7 N S

12 Ray West  
Taylor Unit  
LEA CO

Maljanar, NM, Scale 1" = 0.375 miles, 610 meters, 2,000 feet, 1 mile = 2.64 kilometers, 1 centimeter = 2.40 miles



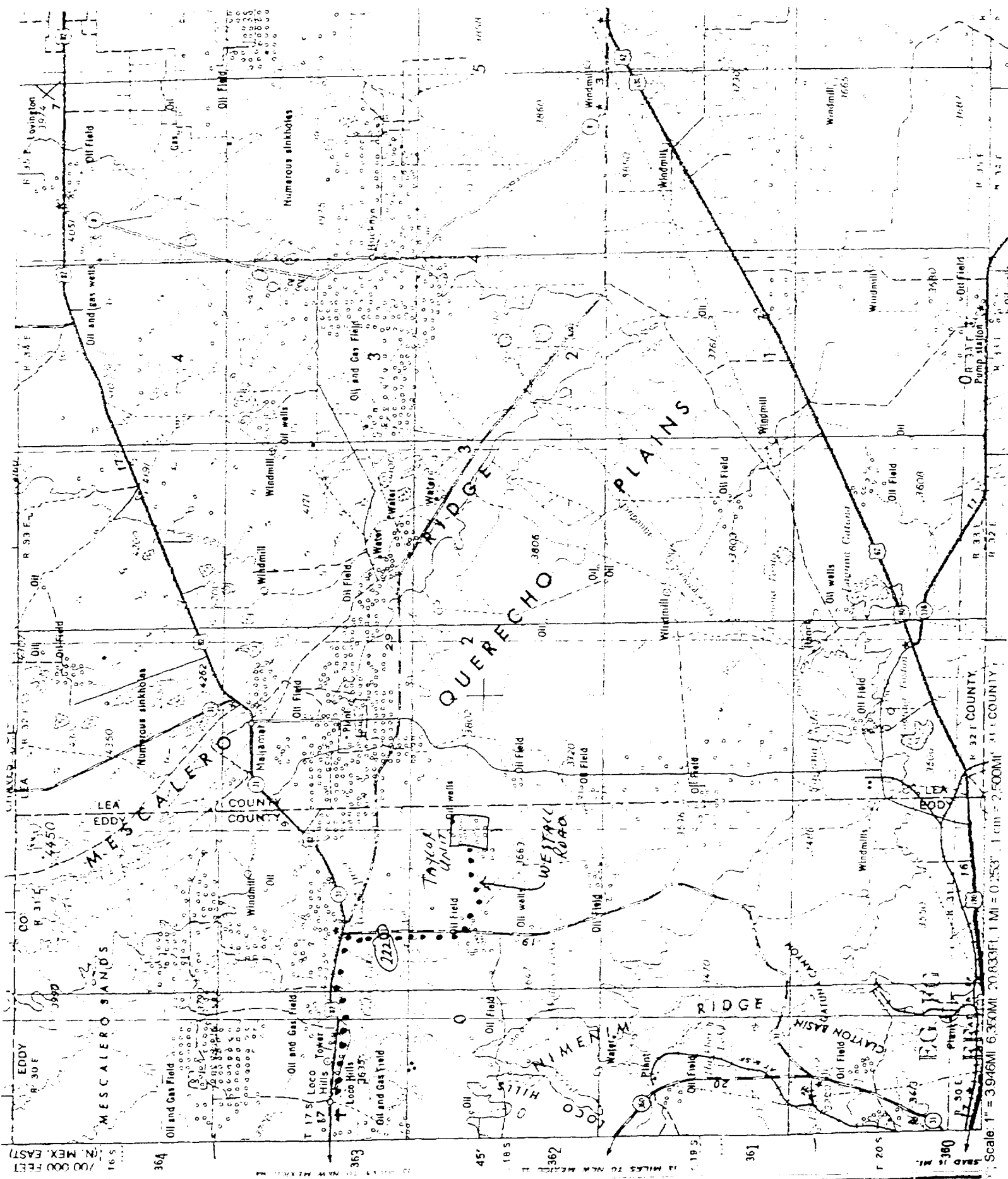

Scale: 1" = 3.94 MI 6.30 KI 1 MI = 0.253" 1 CM = 2.54 CM

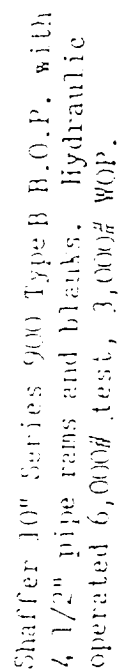

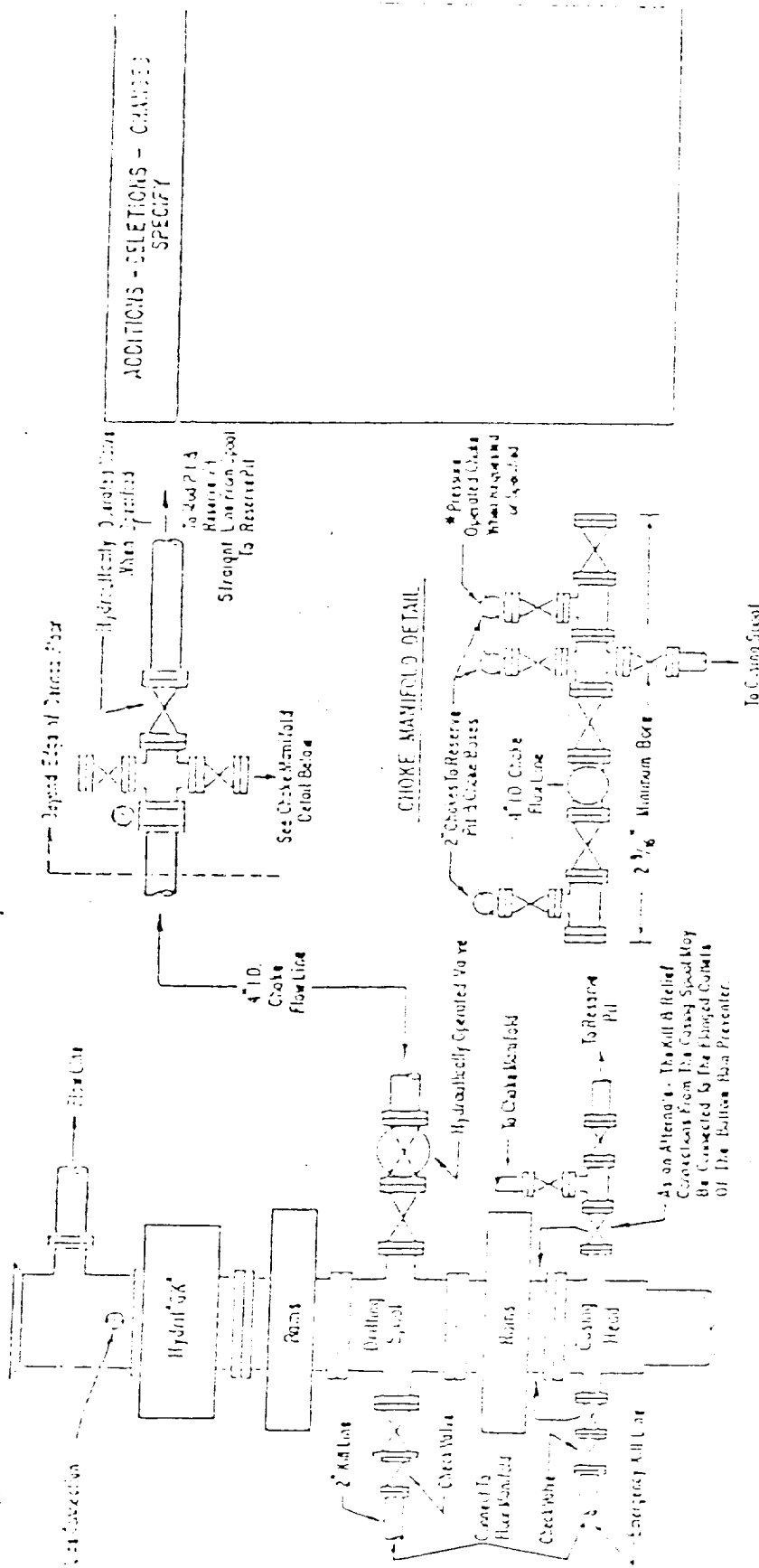

2500 PSI WORKING PRESSURE  
BLOWOUT PREVENTER

The blood pressure can be easily affected by one blind non-preventer and one pipe non-preventer, both physically separated, a blind non-preventer, valves, chokes and connections as illustrated. If a trapped drill string is used, a non-preventer must be provided for each side of the pipe. Casing and tubing must be able to fit the preventer as a blow-out is needed. If correct in size, the trapped portion of the non-preventer can be used for connecting to the fourth L.O. choke flow line and kill line, except when air or gas drilling. The additional hose might be utilized to install a rotating blowout preventer.

Minimum operating equipment for the presenters of hydraulically operated valves shall be as follows: (1) Multiple pumps, driven by a common source of power, capable of fluid coupling the total accumulator volume from the nitrogen gas-charge pressure to its rated pressure within 10 minutes. Also, the pumps are to be connected to the hydraulic operating system which is to be a closed system. (2) Accumulators with a rated volume of not less than 750 psi and connected to us to receive the dominating oil flow charge. With the charging ports shut down, the pressurized fluid volume stored in the accumulator is used to maintain the accumulator at least 10 percent of the oilproof. (3) When operated, an additional source of power, separate and independent, shall be available to operate the drive pump. (4) There shall be additional pumps operated by separate power and equal in performance capabilities.

The sliding manifold and remote-acting manifold shall have a separate control for each pressure-operated device. Controls are to be fail-safe, with control handles indicating open and closed position. A pressure indicator and regulator must be provided for operating the hydraulic pressure. When required, a second pressure reduction shall be available for fluid operating fluid pressure to non-pressure areas. The hydraulic manifold will, an equivalent or better, be used as the fluid to operate the hydraulic equipment.

[illegible]