

**SECTION 7, TOWNSHIP 19 SOUTH, RANGE 31 EAST, N.M.P.M.,  
EDDY COUNTY, NEW MEXICO.**

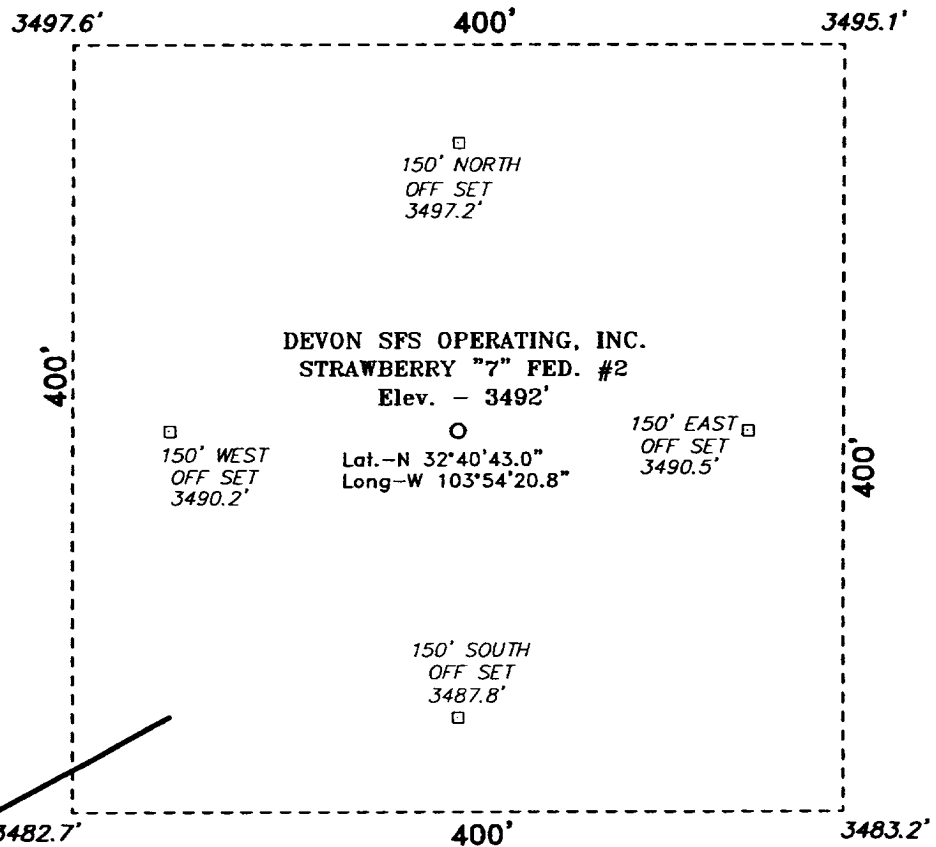

DEVON SFS OPERATING, INC.

STRAWBERRY "7" FED. #2

Elev. - 3492'

Lat. -N 32°40'43.0"  
Long -W 103°54'20.8"

**Directions to Location:**

FROM THE JUNCTION OF CO. RD. 222 AND CO. RD. 248, GO NORTHERLY ON CO. RD. 222 FOR APPROX. 2.0 MILES TO A LEASE ROAD; THENCE WEST ON LEASE ROAD FOR APPROX. 2.5 MILES TO A LEASE ROAD; THENCE SOUTHEASTERLY ON LEASE ROAD FOR APPROX. 0.25 MILE TO PROPOSED LEASE ROAD.

**Basin Surveys** P.O. BOX 1786 - HOBBS, NEW MEXICO

W.O. Number: 2416

Drawn By: K. GOAD

Date: 04-09-2002 | Disk: KJG CD#4 - 2416A.DWG

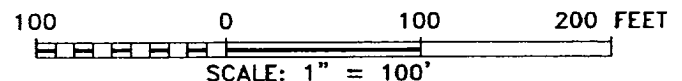

**DEVON SFS OPERATING, INC.**

REF: STRAWBERRY "7" FED. No. 2 / Well Pad Topo

THE STRAWBERRY "7" FED. No. 2 LOCATED 1300' FROM

THE NORTH LINE AND 1750' FROM THE EAST LINE OF

SECTION 7, TOWNSHIP 19 SOUTH, RANGE 31 EAST,

N.M.P.M., EDDY COUNTY, NEW MEXICO.

Survey Date: 04-08-2002 | Sheet 1 of 1 Sheets