

(SUBMIT IN TRIPLICATE)

UNITED STATES  
DEPARTMENT OF THE INTERIOR  
GEOLOGICAL SURVEY

Land Office NEW MEXICO  
Lease No. 04219  
Unit JUL 12 1961

APPROVED: JUL 11 1961  
James A. Knapp  
JAMES A. KNAPP, DISTRICT ENGINEER.  
SUBJECT TO LIKE APPROVAL BY STATE ENGINEER.  
NEER, P. O. BOX 810, ROSWELL, NEW MEXICO

*Provided that no cementing operations shall be performed without first the approval of this office*

SUNDRY NOTICES AND REPORTS ON WELLS

NOTICE OF INTENTION TO DRILL.....	<input checked="" type="checkbox"/>	SUBSEQUENT REPORT OF WATER SHUT-OFF.....
NOTICE OF INTENTION TO CHANGE PLANS.....	<input type="checkbox"/>	SUBSEQUENT REPORT OF SHOOTING OR ACIDIZING.....
NOTICE OF INTENTION TO TEST WATER SHUT-OFF.....	<input type="checkbox"/>	SUBSEQUENT REPORT OF ALTERING CASING.....
NOTICE OF INTENTION TO RE-DRILL OR REPAIR WELL.....	<input type="checkbox"/>	SUBSEQUENT REPORT OF RE-DRILLING OR REPAIR.....
NOTICE OF INTENTION TO SHOOT OR ACIDIZE.....	<input type="checkbox"/>	SUBSEQUENT REPORT OF ABANDONMENT.....
NOTICE OF INTENTION TO PULL OR ALTER CASING.....	<input type="checkbox"/>	SUPPLEMENTARY WELL HISTORY.....
NOTICE OF INTENTION TO ABANDON WELL.....	<input type="checkbox"/>	

(INDICATE ABOVE BY CHECK MARK NATURE OF REPORT, NOTICE, OR OTHER DATA)

April 20, 1961

Federal 'N'  
Well No. 1 is located 1650 ft. from S line and 1650 ft. from E line of sec. 11  
N of SE J. Sec. 11 20-S 26-E N H P N  
(1/4 Sec. and Sec. No.) (Twp.) (Range) (Meridian)  
Undesignated Eddy New Mexico  
(Field) (County or Subdivision) (State or Territory)

The elevation of the derrick floor above sea level is \_\_\_\_\_ ft.

DETAILS OF WORK

(State names of and expected depths to objective sands; show sizes, weights, and lengths of proposed casings; indicate mudding jobs, cementing points, and all other important proposed work)

Will set 425' of 3-5/8" OD 28# new casing or sufficient amount to shut off fresh surface water.

Will set 1500' of 4-1/2" OD 9.5# new casing with 100 sks.

APPROVAL IS HEREBY GIVEN TO STATE ENGINEER TO DRILL AND CEMENT REQUIRED ON "APPROVED" PLAN TO DRILL FOR WATER IN CASING. BOX 810, ROSWELL, NEW MEXICO

APR 20 1961  
U. S. G. S.  
ARTESIA, N. M.

I understand that this plan of work must receive approval in writing by the Geological Survey before operations may be commenced.

Company Hondo Oil & Gas Company

Address Box 129, Artesia, New Mexico

By [Signature]

Title Dist. Prod. Supt.

NUMBER OF COPIES RECEIVED	
DISTRIBUTION	
SANTA FE	
FILE	
U.S.G.S.	
LAND OFFICE	
TRANSPORTER	OIL GAS
PRODUCTION OFFICE	
OPERATOR	

**NEW MEXICO OIL CONSERVATION COMMISSION**  
**WELL LOCATION AND ACREAGE DEDICATION PLAT**  
 SEE INSTRUCTIONS FOR COMPLETING THIS FORM ON THE REVERSE SIDE

FORM C-128  
 Revised 5/1/57

**RECEIVED**  
**JUL 12 1961**

**SECTION A**

Operator <b>Hondo Oil &amp; Gas Company</b>		Lease <b>Federal #</b>		WELLING OFFICE <b>1</b>	
Unit Letter <b>J</b>	Section <b>11</b>	Township <b>7-20-S</b>	Range <b>R-26-E</b>	County <b>Eddy</b>	
Actual Footage Location of Well: <b>1650</b> feet from the <b>South</b> line and <b>1650</b> feet from the <b>East</b> line					
Ground Level Elev. <b>3250</b>	Producing Formation <b>Queen</b>	Pool <b>Wildcat</b>	Dedicated Acreage: <b>40</b> Acres		

1. Is the Operator the only owner in the dedicated acreage outlined on the plat below? YES ☒ NO ☐ ("Owner" means the person who has the right to drill into and to produce from any pool and to appropriate the production either for himself or for himself and another. (65-3-29 (e) NMSA 1935 Comp.)
2. If the answer to question one is "no," have the interests of all the owners been consolidated by communitization agreement or otherwise? YES ☐ NO ☐ . If answer is "yes," Type of Consolidation \_\_\_\_\_
3. If the answer to question two is "no," list all the owners and their respective interests below:

Owner	Land Description
	<b>JUL 11 1961</b>

**SECTION B**

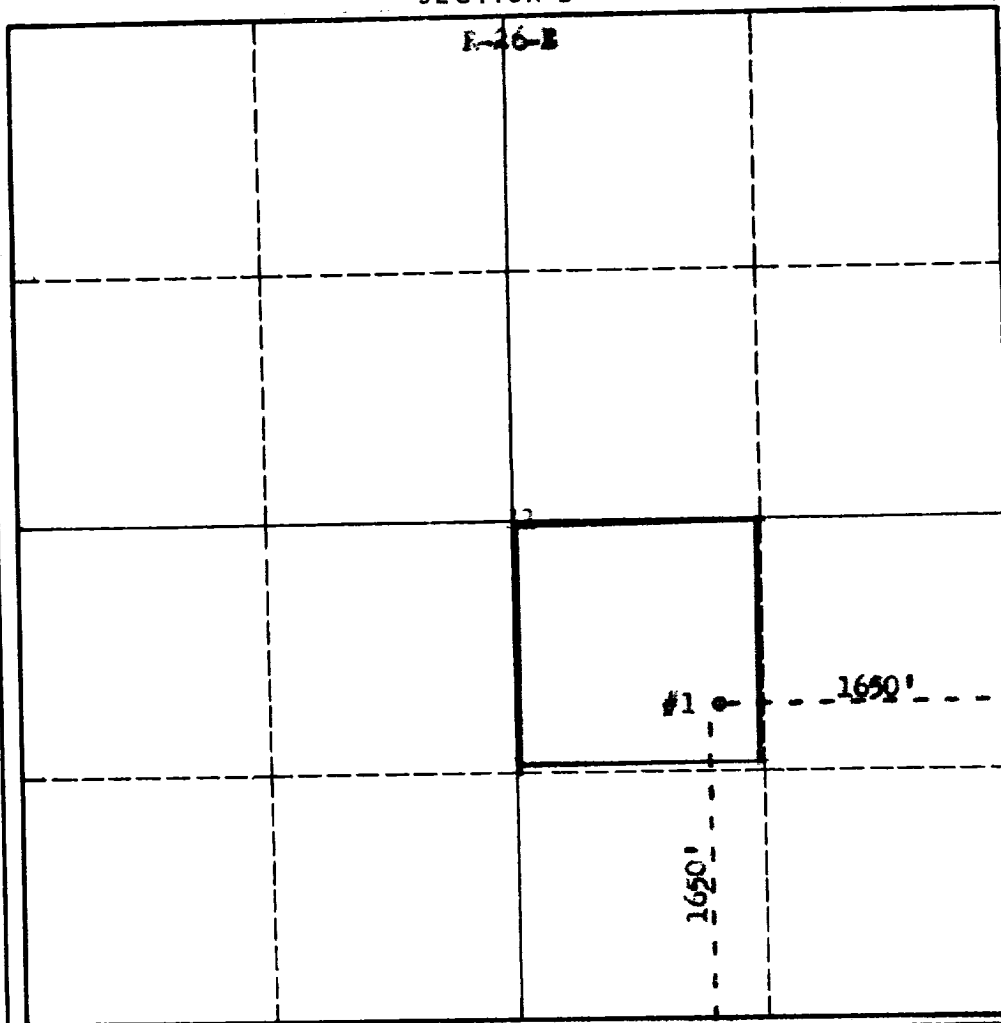

**CERTIFICATION**

I hereby certify that the information in SECTION A above is true and complete to the best of my knowledge and belief.

Name <i>[Signature]</i>
Position <b>Dist. Prod. Supt.</b>
Company <b>Hondo Oil &amp; Gas Company</b>
Date <b>7-10-61</b>

I hereby certify that the well location shown on the plat in SECTION B was plotted from field notes of actual surveys made by me or under my supervision, and that the same is true and correct to the best of my knowledge and belief.

Date Surveyed <b>July 6, 1961</b>
Registered Professional Engineer and/or Land Surveyor <i>[Signature]</i>
Certificate No. <b>3280</b>

0 330 660 990 1320 1650 1980 2310 2640 2000 1500 1000 500 0

## INSTRUCTIONS FOR COMPLETION OF FORM C-128

1. Operator shall furnish and certify to the information called for in Section A.
2. Operator shall outline the dedicated acreage for *both* oil and gas wells on the plat in Section B.
3. A registered professional engineer or land surveyor registered in the State of New Mexico or approved by the Commission shall show on the plat the location of the well and certify this information in the space provided.
4. All distances shown on the plat must be from the outer boundaries of the Section.
5. If additional space is needed for listing owners and their respective interests as required in question 3 of Section A, please use space below.