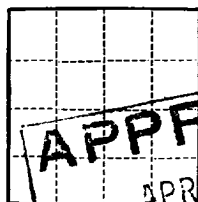

(SUBMIT IN TRIPLICATE)

Land Office Santa Fe
Lease No. LC 050797
Unit _____UNITED STATES
DEPARTMENT OF THE INTERIOR
GEOLOGICAL SURVEY

c o p y

RECEIVED

SUNDRY NOTICES AND REPORTS ON WELLS

APR 30 1962

NOTICE OF INTENTION TO DRILL	<input checked="" type="checkbox"/>	SUBSEQUENT REPORT OF WATER SHUT-OFF	<input type="checkbox"/>
NOTICE OF INTENTION TO CHANGE PLANS	<input type="checkbox"/>	SUBSEQUENT REPORT OF SHOOTING OR ACIDIZING	<input type="checkbox"/>
NOTICE OF INTENTION TO TEST WATER SHUT-OFF	<input type="checkbox"/>	SUBSEQUENT REPORT OF ALTERING CASING	<input type="checkbox"/>
NOTICE OF INTENTION TO RE-DRILL OR REPAIR WELL	<input type="checkbox"/>	SUBSEQUENT REPORT OF RE-DRILLING OR REPAIR	<input type="checkbox"/>
NOTICE OF INTENTION TO SHOOT OR ACIDIZE	<input type="checkbox"/>	SUBSEQUENT REPORT OF ABANDONMENT	<input type="checkbox"/>
NOTICE OF INTENTION TO PULL OR ALTER CASING	<input type="checkbox"/>	SUPPLEMENTARY WELL HISTORY	<input type="checkbox"/>
NOTICE OF INTENTION TO ABANDON WELL	<input type="checkbox"/>		<input type="checkbox"/>

(INDICATE ABOVE BY CHECK MARK NATURE OF REPORT, NOTICE, OR OTHER DATA)

c o p y

April 27, 1962

Well No. 10-X is located 2222 ft. from S line and 1005 ft. from E line of sec. 13
SW¹/₄ Sec. 13 20 S. 28 E. N.M.P.M.
(¹/₄ Sec. and Sec. No.) (Twp.) (Range) (Meridian)
Russell Eddy New Mexico
(Field) (County or Subdivision) (State or Territory)

The elevation of the derrick floor above sea level is _____ ft.

DETAILS OF WORK

(State names of and expected depths to objective sands; show sizes, weights, and lengths of proposed casings; indicate mudding jobs, cementing points, and all other important proposed work)

Packer stuck in Input well #10 - unable to remove, so will drill 10 X exactly 100' south of #10. With rotary, will set approximately 3 joints of 8 5/8" csng. Then drill 6 3/4" rotary hole to a point 5' or so above Russell Sand expected at 775'. Russell Sand will be cored and hole reamed if necessary to cement to surface if possible the 4" casing on top or in the Russell Sand. After completion of 10 X - Well #10 will be plugged.

RECEIVED

APR 30 1962

I understand that this plan of work must receive approval in writing by the Geological Survey before operations may be commenced.

Company Neil H. Wills
Address Box 529
Carlsbad, New Mexico
By orig. /s/ Neil H. Wills
Title Owner

NEW MEXICO OIL CONSERVATION COMMISSION
Well Location and Acreage Dedication Plat

Section A.

Date 4-28-62

Operator Neil H. Wills Lease Federal #LC-050797
Well No. 10-1 Unit Letter L Section 13 Township 20 S Range 28 E NMPM
Located 2222 Feet From South Line, 1005 Feet From West Line
County Rddy G. L. Elevation 3249 Dedicated Acreage 40 Acres
Name of Producing Formation Iates Pool Russell

1. Is the Operator the only owner* in the dedicated acreage outlined on the plat below?
Yes X No .
2. If the answer to question one is "no," have the interests of all the owners been consolidated by communitization agreement or otherwise? Yes No . If answer is "yes," Type of Consolidation
3. If the answer to question two is "no," list all the owners and their respective interests below:

Owner

Land Description

RECEIVED

MAY 8 1962

ADDITIONAL SURVEY
N.A. NEW MEXICO

Section B

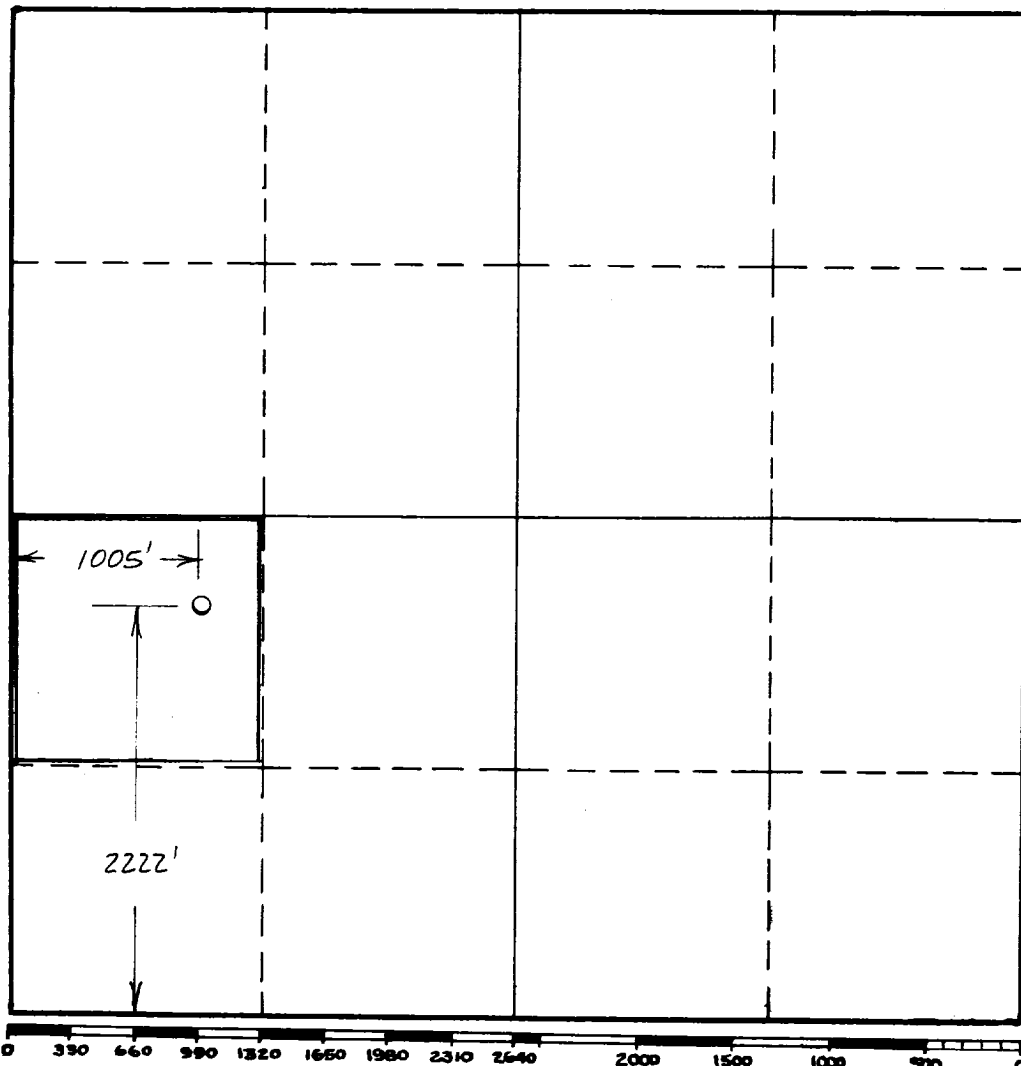

This is to certify that the information in Section A above is true and complete to the best of my knowledge and belief.

Neil H. Wills
(Operator)

(Representative)

Box 529 Carlsbad, N. M.
Address

This is to certify that the well location shown on the plat in Section B was plotted from field notes of actual surveys made by me or under my supervision and that the same is true and correct to the best of my knowledge and belief.

Date Surveyed 4-28-62

Neil H. Wills
Registered Professional
Engineer and/or Land Surveyor.

Certificate No. 771

(See instructions for completing this form on the reverse side)

INSTRUCTIONS FOR COMPLETION :

1. Operator shall furnish and certify to the information called for in Section A.
2. Operator shall outline the dedicated acreage for both oil and gas wells on the plat in Section B.
3. A registered professional engineer or land surveyor registered in the State of New Mexico or approved by the Commission shall show on the plat the location of the well and certify this information in the space provided.
4. All distances shown on the plat must be from the outer boundaries of Section.
5. If additional space is needed for listing owners and their respective interests as required in question 3, Section A, please use space below

* "Owner" means the person who has the right to drill into and to produce from any pool and to appropriate the production either for himself or for himself and another. (65-3-29 (e) NMSA 1953 Comp.)