

WELL LOCATION

SURVEY
for

Geo. E. Conley

#1 Conley - Fedral

1650 feet from south line

2310 feet from east line

Sec. 33, T 20 S, R 28 E
N.M.P.M.P.

Eddy Co., New Mexico

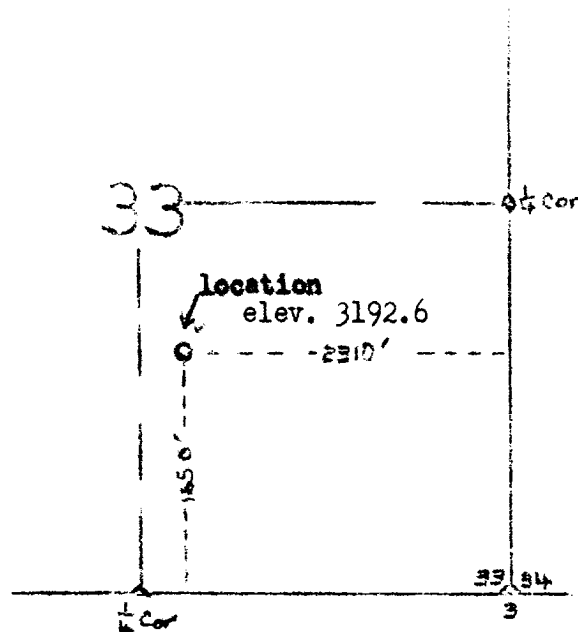

Scale 4" = 1 mile

This is to certify that the above plat is
a correct representation of the survey as
made by me in the field.

Geo. D. Riggs June 26, 1956
Geo. D. Riggs