

NEW MEXICO OIL CONSERVATION COMMISSION  
Santa Fe, New Mexico

Form C-101  
Revised (12/1/55)

NOTICE OF INTENTION TO DRILL

Notice must be given to the District Office of the Oil Conservation Commission and approval obtained before drilling or recompletion begins. If changes in the proposed plan are considered advisable, a copy of this notice showing such changes will be returned to the sender. Submit this notice in QUINTUPPLICATE. One copy will be returned following approval. See additional instructions in Rules and Regulations of the Commission. If State Land submit 6 Copies Attach Form C-128 in triplicate to first 3 copies of form C-101

Fort Worth, Texas

(Place)

November 30, 1956

(Date)

OIL CONSERVATION COMMISSION  
SANTA FE, NEW MEXICO

Gentlemen:

You are hereby notified that it is our intention to commence the Drilling of a well to be known as  
**Wilson Exploration Company**

State

(Company or Operator)

(Lease)

Well No. 1

0

The well is

located 660

feet from the

South

line and

1980

feet from the

East

line of Section 2

T 20S.

R. 29E.

NMPM.

(GIVE LOCATION FROM SECTION LINE)

Wildcat

Pool,

Eddy

County

If State Land the Oil and Gas Lease is No.

E 7729

If patented land the owner is

Address

We propose to drill well with drilling equipment as follows:

Cable Tools

The status of plugging bond is Pacific Service Co. of

Albuquerque, New Mexico

Drilling Contractor H-W Drilling Company

We intend to complete this well in the Yates

formation at an approximate depth of 1500

feet.

CASING PROGRAM

We propose to use the following strings of Casing and to cement them as indicated:

Size of Hole	Size of Casing	Weight per Foot	New or Second Hand	Depth	Sacks Cement
10"	8-5/8"	28#	Used	500	Mudded

If changes in the above plans become advisable we will notify you immediately.

ADDITIONAL INFORMATION (If recompletion give full details of proposed plan of work.)

Approved \_\_\_\_\_, 19\_\_\_\_  
Except as follows:

OIL CONSERVATION COMMISSION

By M. L. Armstrong

Sincerely yours,

Wilson Exploration Company

(Company or Operator)

By

Position Operator

Send Communications regarding well to

Name Wilson Exploration Company

Address Sinclair Bldg., Ft. Worth, Texas

NEW MEXICO  
OIL CONSERVATION COMMISSION

Well Location and/or Gas Production Plat

Date Nov. 30, 1956

Operator Wilson Exploration Co. lease State

Well No. 1 Section 2 Township 20 South Range 29 East NMPM

Located 1980 Feet From East Line, 660 Feet From South line,

Eddy County, New Mexico. G. L. Elevation 3308'

Name of Producing Formation YATES Pool WILDCAT Dedicated Acreage

(Note: All distances must be from outer boundaries of Section)

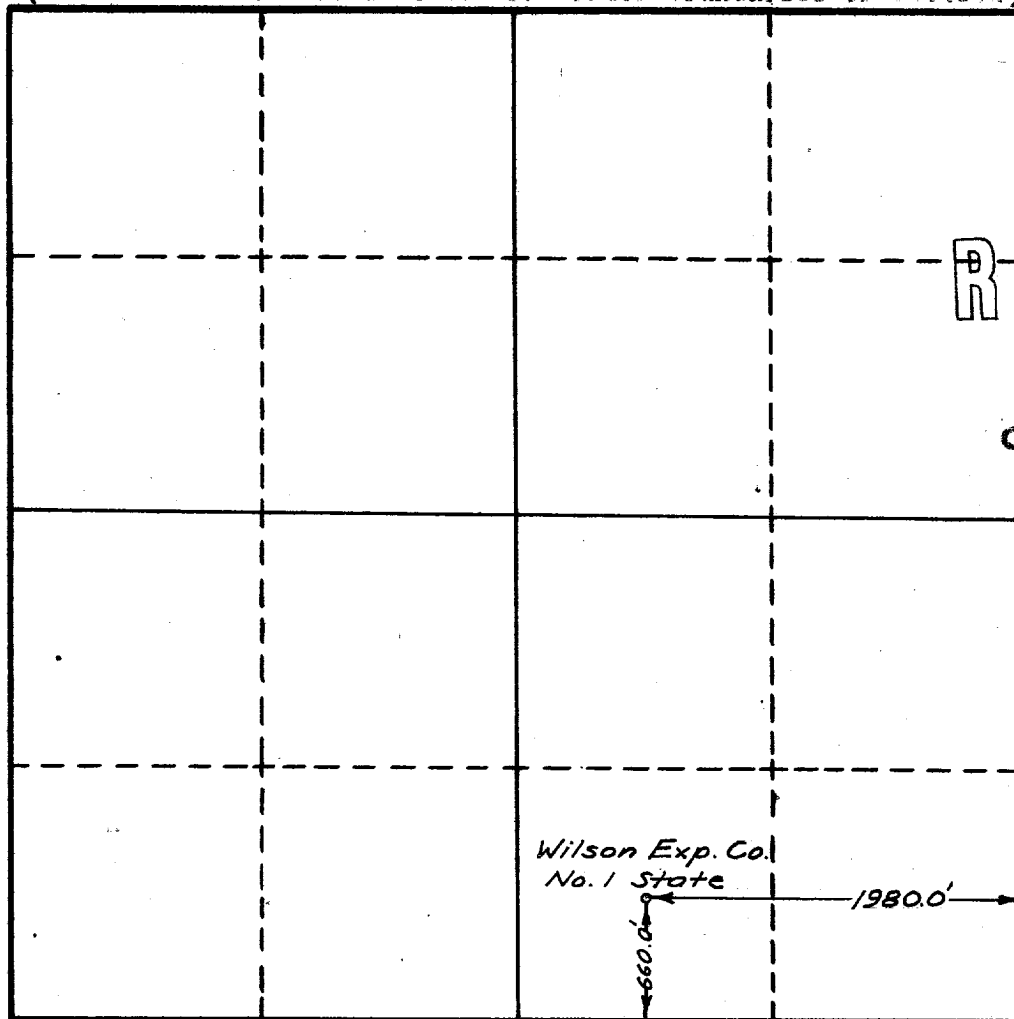

RECEIVED

DEC 4 1956

Oil Cons. Comm.  
ARTESIA OFFICE

Scale: 1" = 1000'

1. Is this well a Dual Comp.? Yes\_\_ No\_\_.
2. If the answer to Question 1 is yes, are there any other dually completed well within the dedicated acreage? Yes\_\_ No\_\_.

This is to certify that the above plat was prepared from field notes of actual surveys made by me or under my supervision and that the same are true and correct to the best of my knowledge and belief.

Name Ben T. Phillips, Jr.  
Position Registered Land Surveyor  
Representing Robert L. Bunnel  
Address 121 N. Margaret St.,  
Carlsbad, N. M.

