

NUMBER OF COPIES RECEIVED	
DISTRIBUTION	
AMOUNT	DATE
FILE	
S.E.G.S.	
AND OFFICE	
TRANSPORTER	OIL GAS
ORATION OFFICE	
PERATOR	

NEW MEXICO OIL CONSERVATION COMMISSION
WELL LOCATION AND ACREAGE DEDICATION PLAT
 SEE INSTRUCTIONS FOR COMPLETING THIS FORM ON THE REVERSE SIDE

FORM C-128
 Revised 5/1/57

RECEIVED

APR 10 1961

SECTION A			
Operator Days Operating Company		Lease Yates-Federal	
Init Letter		Well No. 0.01	
Section 7	Township 20 South	Range 29 East	County Eddy
Actual Footage Location of Well: 660 feet from the South line and 1980 feet from the East line			
Ground Level Elev. 3265	Producing Formation Yates Sand	Pool Wildcat	Dedicated Acreage: 40 Acres

1. Is the Operator the only owner in the dedicated acreage outlined on the plat below? YES _____ NO **X**. ("Owner" means the person who has the right to drill into and to produce from any pool and to appropriate the production either for himself or for himself and another. (65-3-29 (e) NMSA 1935 Comp.)
2. If the answer to question one is "no," have the interests of all the owners been consolidated by communitization agreement or otherwise? YES **X** NO _____. If answer is "yes," Type of Consolidation **Operating Agreement**
3. If the answer to question two is "no," list all the owners and their respective interests below:

Owner Days Operating Company owns rights through the Yates horizon and the Yates Brothers own rights below this horizon.	Land Description
--	------------------

RECEIVED

APR 8 1961

U.S. GEOLOGICAL SURVEY
NEW MEXICO

CERTIFICATION

I hereby certify that the information in SECTION A above is true and complete to the best of my knowledge and belief.

Name <i>[Signature]</i>
Position Superintendent
Company Days Operating Company
Date 4-5-61

I hereby certify that the well location shown on the plat in SECTION B was plotted from field notes of actual surveys made by me or under my supervision, and that the same is true and correct to the best of my knowledge and belief.

Date Surveyed March 31, 1961
Registered Professional Engineer and/or Land Surveyor <i>[Signature]</i>
Certificate No. 1502

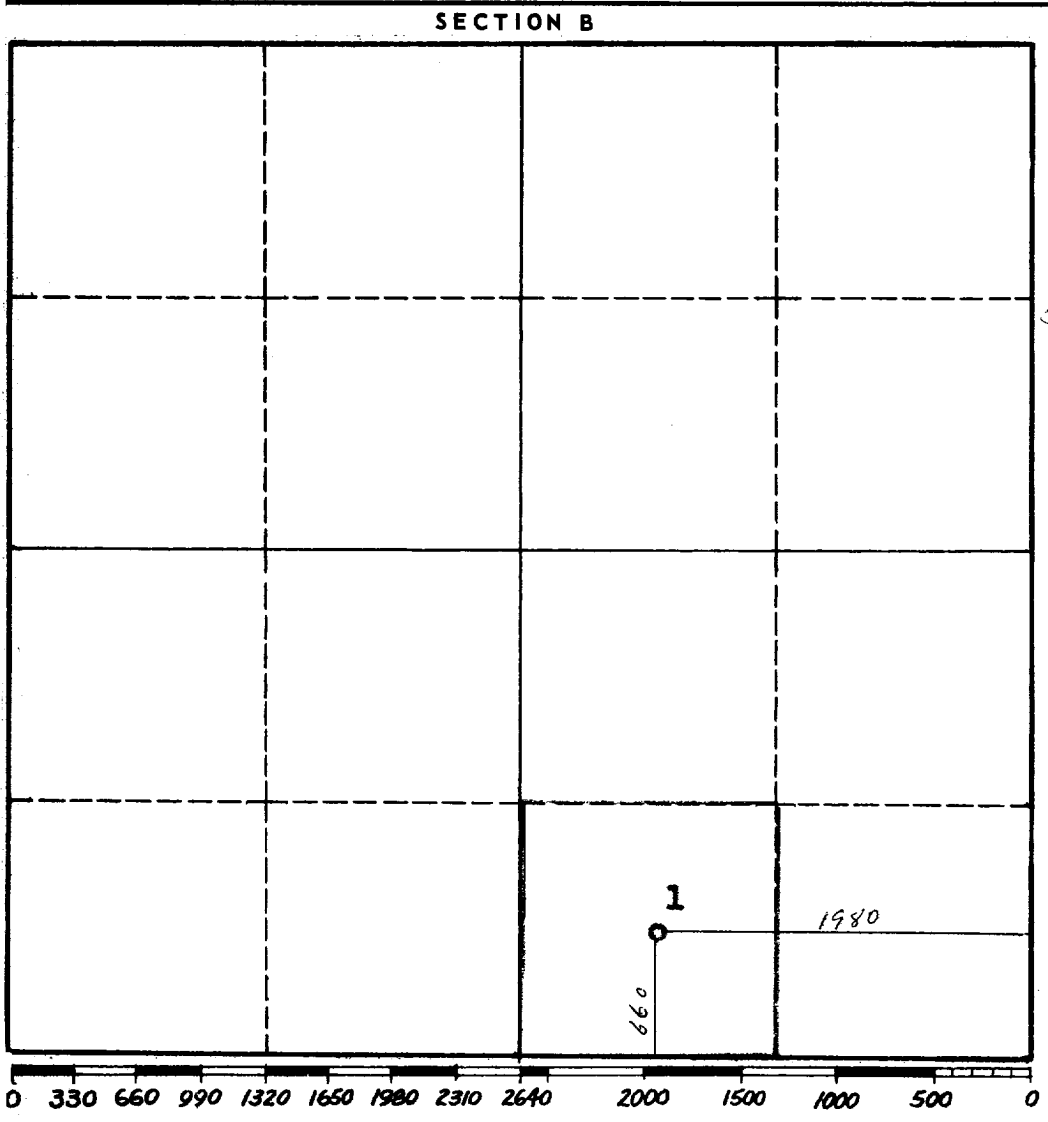

INSTRUCTIONS FOR COMPLETION OF FORM C-128

1. Operator shall furnish and certify to the information called for in Section A.
2. Operator shall outline the dedicated acreage for *both* oil and gas wells on the plat in Section B.
3. A registered professional engineer or land surveyor registered in the State of New Mexico or approved by the Commission shall show on the plat the location of the well and certify this information in the space provided.
4. All distances shown on the plat must be from the outer boundaries of the Section.
5. If additional space is needed for listing owners and their respective interests as required in question 3 of Section A, please use space below.