

NUMBER OF COPIES RECEIVED	
DISTRIBUTION	
SANTA FE	
FILE	
U.S.G.S.	
LAND OFFICE	
TRANSPORTER	OIL GAS
PRODUCTION OFFICE	
OPERATOR	

NEW MEXICO OIL CONSERVATION COMMISSION
WELL LOCATION AND ACREAGE DEDICATION PLAT
 SEE INSTRUCTIONS FOR COMPLETING THIS FORM ON THE REVERSE SIDE

FORM C-128
Revised 5/1/57

SECTION A

Operator Lamb & Ford		Lease McKee-Federal		Well No. 1
Unit Letter K	Section 11	Township 20 South	Range 29 East	County Eddy
Actual Footage Location of Well: 2310 feet from the South line and 2310 feet from the West line				
Ground Level Elev. 3302	Producing Formation Yates Seven Rivers	Pool Getty Pool (Ext)	Dedicated Acreage: 40 Acres	

1. Is the Operator the only owner in the dedicated acreage outlined on the plat below? YES ☒ NO ____ . ("Owner" means the person who has the right to drill into and to produce from any pool and to appropriate the production either for himself or for himself and another. (65-3-29 (e) NMSA 1935 Comp.)
2. If the answer to question one is "no," have the interests of all the owners been consolidated by communitization agreement or otherwise? YES ____ NO ____ . If answer is "yes," Type of Consolidation _____
3. If the answer to question two is "no," list all the owners and their respective interests below:

Owner	Land Description
	NE1/4NE1/4SW1/4

SECTION B

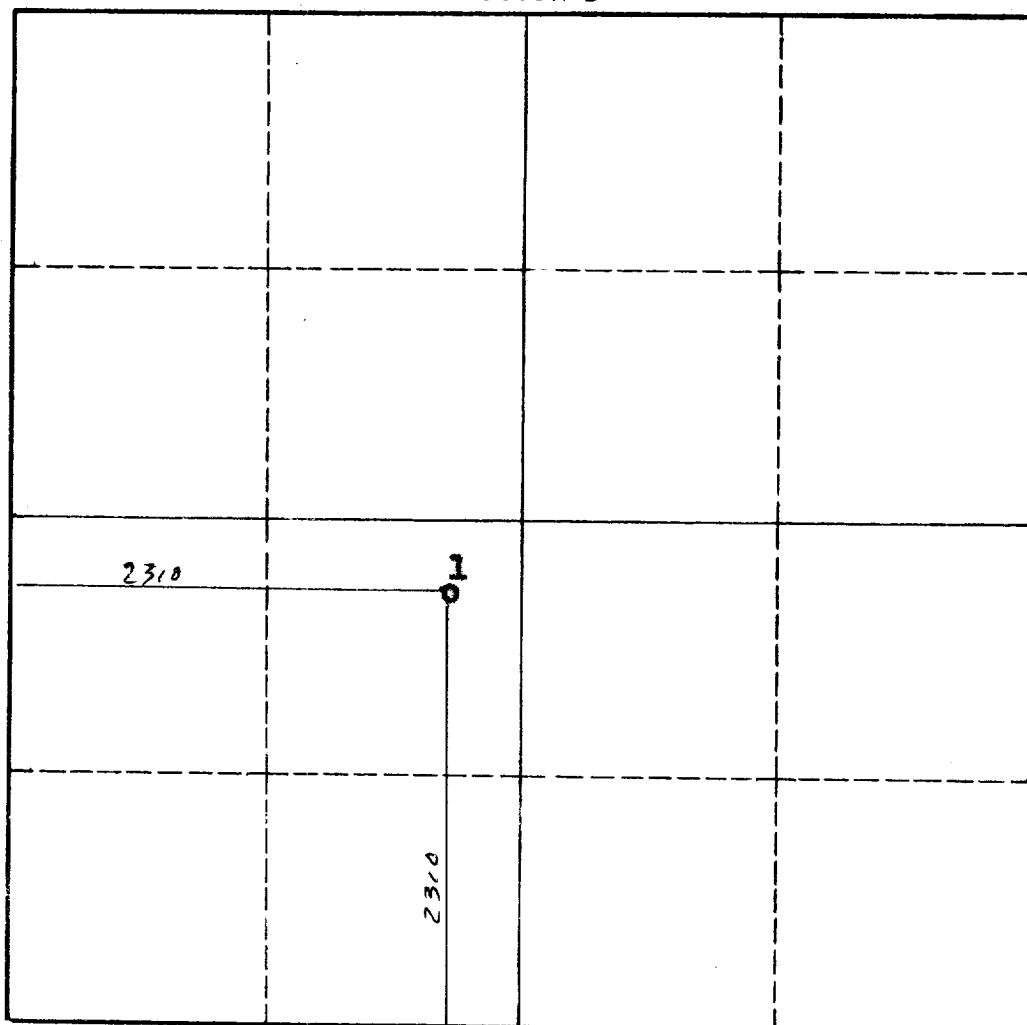

CERTIFICATION

I hereby certify that the information in SECTION A above is true and complete to the best of my knowledge and belief.

Name James Lamb
Position Partner
Company Lamb & Ford
Date August 30, 1962

I hereby certify that the well location shown on the plat in SECTION B was plotted from field notes of actual surveys made by me or under my supervision, and that the same is true and correct to the best of my knowledge and belief.

Date Surveyed August 30, 1962
Registered Professional Engineer and/or Land Surveyor John A. Matheis
Certificate No. 1502



INSTRUCTIONS FOR COMPLETION OF FORM C-128

1. Operator shall furnish and certify to the information called for in Section A.
2. Operator shall outline the dedicated acreage for *both* oil and gas wells on the plat in Section B.
3. A registered professional engineer or land surveyor registered in the State of New Mexico or approved by the Commission shall show on the plat the location of the well and certify this information in the space provided.
4. All distances shown on the plat must be from the outer boundaries of the Section.
5. If additional space is needed for listing owners and their respective interests as required in question 3 of Section A, please use space below.

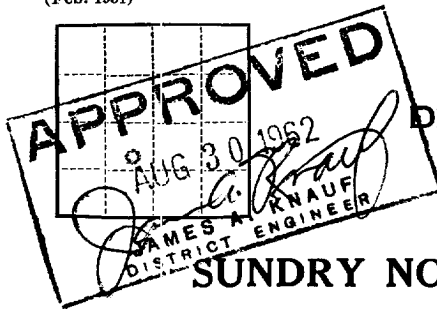

(SUBMIT IN TRIPLICATE) *copy 5 f.*

UNITED STATES
DEPARTMENT OF THE INTERIOR
GEOLOGICAL SURVEY

Land Office _____
Lease No. _____
Unit _____

RECEIVED

SEP 4 1962

SUNDRY NOTICES AND REPORTS ON WELLS

NOTICE OF INTENTION TO DRILL.....	<input checked="" type="checkbox"/>	SUBSEQUENT REPORT OF WATER SHUT-OFF.....	
NOTICE OF INTENTION TO CHANGE PLANS.....		SUBSEQUENT REPORT OF SHOOTING OR ACIDIZING.....	
NOTICE OF INTENTION TO TEST WATER SHUT-OFF.....		SUBSEQUENT REPORT OF ALTERING CASING.....	
NOTICE OF INTENTION TO RE-DRILL OR REPAIR WELL.....		SUBSEQUENT REPORT OF RE-DRILLING OR REPAIR.....	
NOTICE OF INTENTION TO SHOOT OR ACIDIZE.....		SUBSEQUENT REPORT OF ABANDONMENT.....	
NOTICE OF INTENTION TO PULL OR ALTER CASING.....		SUPPLEMENTARY WELL HISTORY.....	
NOTICE OF INTENTION TO ABANDON WELL.....			

(INDICATE ABOVE BY CHECK MARK NATURE OF REPORT, NOTICE, OR OTHER DATA)

Well No. 1 McKee is located 2310 ft. from {N} line and 2310 ft. from {E} line of sec. 11
August 30, 1962

McKee (Section No.) (Twp.) (Range) N.M.P.M. (Meridian)
Gettys Pool (Ext) (County or Subdivision) New Mexico

The elevation of the derrick floor above sea level is _____ ft.

DETAILS OF WORK

(State names of and expected depths to objective sands; show sizes, weights, and lengths of proposed casings; indicate mudlog logs, cementing points, and all other important proposed work)

Prepare to drill to a total depth of approximately 1600 feet. Test the Yates-Seven Rivers formations with cable tools.

8 5/8" set at 375' with 50 sacks of cement
4 1/2" set at TD with 150 sacks of cement

If shallow water is encountered, we will run a water shut off string which will be pulled when the 8 5/8" casing is run.

Drilling Contractor will be Kincaid & Watson of Artesia, New Mexico.
I understand that this plan of work must receive approval in writing by the Geological Survey before operations may be commenced.

Company James L Lamb Jr

Address Box 5265

Midland, Texas

By James L Lamb Jr
Title Partner